

NEW MEXICO OIL CONSERVATION COMMISSION
WELL LOCATION AND ACREAGE DEDICATION PLAT

FORM C-128
Revised 5/1/57

SEE INSTRUCTIONS FOR COMPLETING THIS FORM ON THE REVERSE SIDE

SECTION A

Operator TENNECO OIL COMPANY		Lease Michalis State		Well No. EX 2
Unit Letter A	Section 32	Township 19 SOUTH	Range 31 EAST	County EDDY
Actual Footage Location of Well: 660 feet from the NORTH line and 660 feet from the EAST line				
Ground Level Elev. 3475 feet	Producing Formation Stroman Sand	Pool Wildcat	Dedicated Acreage: 40 Acres	

1. Is the Operator the only owner in the dedicated acreage outlined on the plat below? YES ☒ NO ☐ ("Owner" means the person who has the right to drill into and to produce from any pool and to appropriate the production either for himself or for himself and another. (65-3-29 (c) NMSA 1935 Comp.)
2. If the answer to question one is "no," have the interests of all the owners been consolidated by communication agreement or otherwise? YES ☐ NO ☐ If answer is "yes," Type of Consolidation **RECEIVED**
3. If the answer to question two is "no," list all the owners and their respective interests below:

Owner	Land Description OCT 13 1964
	O. C. C. ARTERIA, OFFICE

SECTION B

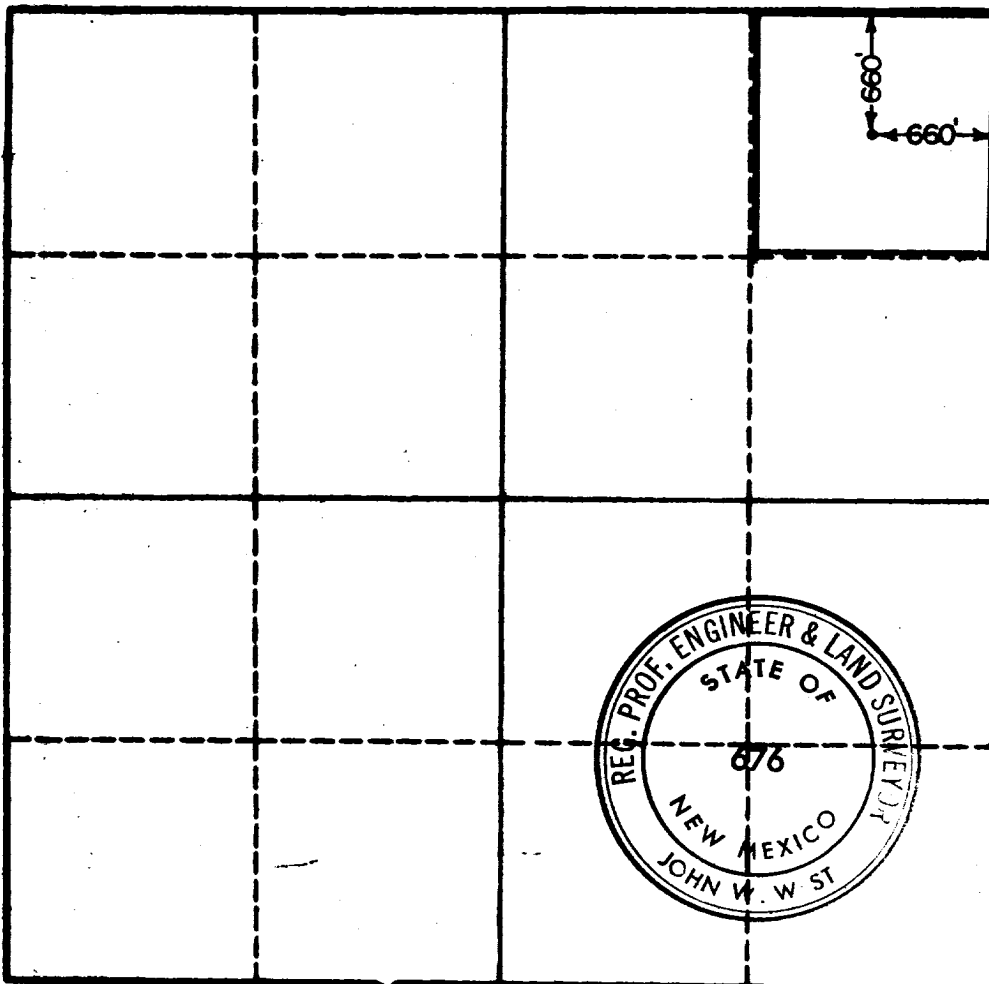

CERTIFICATION

I hereby certify that the information in SECTION A above is true and complete to the best of my knowledge and belief.

Name A.W. Long
Position Dist. Prod. Superintendent
Company Tenneco Oil Company
Date October 8, 1964

I hereby certify that the well location shown on the plat in SECTION B was plotted from field notes of actual surveys made by me or under my supervision, and that the same is true and correct to the best of my knowledge and belief.

Date Surveyed 9-23-64
Registered Professional Engineer and/or Land Surveyor, JOHN W. WEST
Certificate No. N.M. - P.E. & L.S. NO. 676

OIL CONSERVATION COMMISSION		
ARTESIA DISTRICT OFFICE		
No. Copies Received <u>3</u>		
DISTRIBUTION		
	NO. FURNISHED	
OPERATOR		
SANTA FE	1	
PRODUCTION OFFICE		
STATE LAND OFFICE		
U. S. G. S.	1	
TRANSPORTER		
FILE	1-	
BUREAU OF MINES		