

NMAS

New Mexico Archaeological Services, Inc.

P. O. Box 1341

Carlsbad, New Mexico 88220

(505) 887-7646

24 September 1981

Reconnaissance
Excavation
Analysis
Explanation
Curation

Mr. Richard Barton
WESTALL AND MASK
P.O. Box 1477
Roswell, New Mexico 88201

Dear Mr. Barton:

Enclosed please find NMAS' Archaeological Clearance Report for WESTALL AND MASK's proposed power line to Hinkle Federal "F" Well No. 7 in Eddy County, New Mexico. No cultural resources were recorded during this reconnaissance, and hence NMAS is *suggesting* clearance for this project.

If you have any questions pertaining to this report, please call my office. Thank you for asking NMAS to do this reconnaissance.

Yours sincerely,

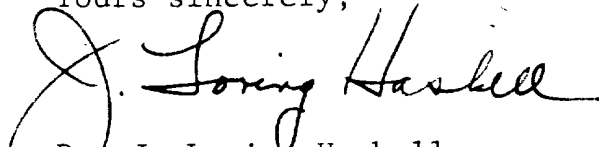

Dr. J. Loring Haskell
Principal Investigator

Enclosure

cc: Mr. Thomas Zale, BLM, Carlsbad
Ms. Ann Ramage, BLM, Roswell
Mr. Curtis Schaafsma, Laboratory of Anthropology,
Santa Fe
Mr. Thomas W. Merlan, SHPO, Santa Fe

as

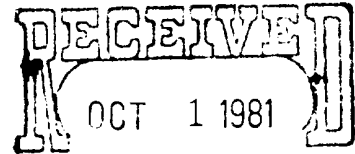

OIL & GAS
U.S. GEOLOGICAL SURVEY
ROSWELL, NEW MEXICO

Archaeological Clearance Report
for
WESTALL AND MASK

Power Line to
Hinkle Federal F Well No. 7

Prepared

By

Dr. J. Loring Haskell

Submitted

By

Dr. J. Loring Haskell
Principal Investigator
New Mexico Archaeological Services, Inc.
Carlsbad, New Mexico

24 September 1981

Permit No. 81-NM-306

ABSTRACT

New Mexico Archaeological Services, Inc., representing WESTALL AND MASK, Roswell, undertook an archaeological reconnaissance of Bureau of Land Management lands scheduled to be impacted by the construction of a power line. The investigated easement will be situated in Sections 27 and 34, T18S, R31E, NMPM, Eddy County, New Mexico. No cultural resources were recorded during this reconnaissance, and hence NMAS is *suggesting* clearance for WESTALL AND MASK's proposed work.

Introduction

On 23 September 1981, New Mexico Archaeological Services, Inc., (NMAS), Carlsbad, undertook for WESTALL AND MASK, Roswell, an archaeological reconnaissance of lands administered by the Bureau of Land Management in Eddy County, New Mexico. The reconnoitered easement will be impacted by the construction of a power line. This project was advanced by Mr. Richard Barton, WESTALL AND MASK, and administered by Dr. J. Loring Haskell, Principal Investigator, NMAS, Inc. This reconnaissance was undertaken by Dr. Haskell.

Survey Technique

For this investigation, WESTALL AND MASK's proposed easement was investigated for evidence of man's past activities by walking it in two, 35 ft wide, close interval (15° or less), zigzag transects. Methodologically, this procedure served to promote optimal conditions for the visual examination of areas to be impacted by construction-related activities.

Power Line
(Hinkle Federal "F" Well No. 7)

Location

As proposed, WESTALL AND MASK's easement will measure 30 X 1320 ft on federal lands and will be situated in the:

SE $\frac{1}{4}$ SW $\frac{1}{4}$, Section 27, T18S, R31E, NMPM, Eddy County, NM
NE $\frac{1}{4}$ NW $\frac{1}{4}$, Section 34, T18S, R31E, NMPM, Eddy County, NM

Map Reference: USGS CLAYTON BASIN QUADRANGLE, 15 Minute Series, 1942.

Terrain

WESTALL AND MASK's proposed power line easement will cross a generally flat landform broken by the occurrence of occasional subsidence structures. These latter features are overlain by a deposit of aeolian material of Pliestocene and Holocene age. Associated soils developing from this parent

material are stable in character being composed of loamy sands and sandy loams. Pedons belong to the Typic Torripsamment subgroup.

Floristics

Local soils are supportive of a mixed overstory of *Quercus havardii*, *Prosopis juliflora*, and *Yucca glauca*. Attendant forbs include *Eriogonum annuum*, *Gutierrezia sarothrae*, *Croton* sp., *Suaeda* sp., and *Dithyrea* sp. The Gramineae is represented by *Andropogon* sp., *Aristida* sp., *Chloris cuculata*, *Munroa squarrosa*, and *Sporobolus flexuosus*.

Cultural Resources

No cultural properties were recorded during the course of this reconnaissance. Reasons cited for their absence include a dearth of potentially knappable material as well as a usual shortage of potable water. Additionally shelter is scarce in the immediate vicinity as well.

Recommendations

NMAS recommends clearance for WESTALL AND MASK's power line (Hinkle Federal "F" Well No. 7) easement and *suggests* that work-related activities proceed in accordance with company plans. Clearance, of course, is granted by the Bureau of Land Management. If cultural resources are encountered during construction, the BLM and NMAS should be notified immediately. Duned settings are notorious for covering and uncovering cultural properties.

R-31-E

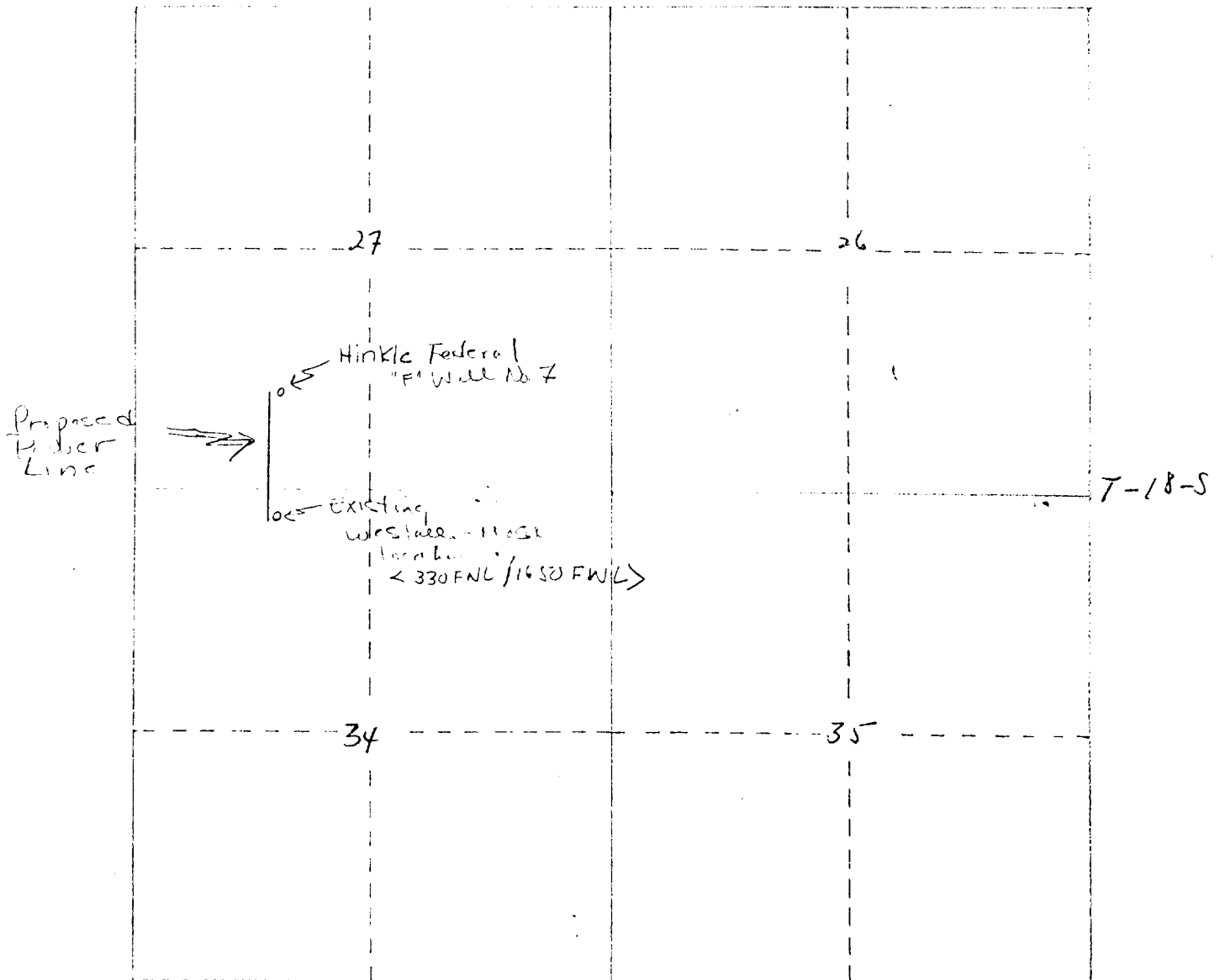

Wetall Model
7 426 OCT 9 1981

STANDARD RIGHT-OF-WAY STIPULATIONS FOR OVERHEAD ELECTRIC DISTRIBUTION LINES IN THE ROSWELL DISTRICT, BLM

U.S. GEOLOGICAL SURVEY
ROSWELL, NEW MEXICO

Grantee agrees to comply with the following stipulations to the satisfaction of BLM's Roswell District Manager.

1. Clearing and blading necessary for construction will be held to the absolute minimum. Without prior agreement, these actions will not exceed those necessary upon at the post-construction inspection. Vegetation removed will be "walked-down" in place.
2. Grantee will post the BLM serial number assigned to this right-of-way in a conspicuous place where the right-of-way intersects existing roads or highways. Along rights-of-way paralleling roads or highways, BLM serial numbers will be posted where the right-of-way first crosses the public lands and where it finally leaves the public lands, unless otherwise agreed upon.
3. Unless otherwise agreed upon in writing, powerlines will be constructed according to standards as outlined in Suggested Practices for Raptor Protection on Powerlines, Raptor Research Foundation, Inc., Department of Zoology - 167 WBS, Brigham Young University, or Rural Electrification Bulletin 61-10, dated September 14, 1973, entitled "Protection of Bald and Golden Eagles from Powerlines." These publications provide sufficient information on phase staging, configuration, and grounding in order to preclude the existence of significant hazards to large perching birds. A copy of these publications may be obtained at the Roswell District Office. However, the BLM reserves the right to require modifications or additions to all powerline structures placed on this right-of-way, should they be determined as necessary to ensure the safety of large perching birds. Such modifications and/or additions will be made by the grantee, without liability or expense to the United States.
4. Industry officials shall assume the burden and expense of proving that the designs not shown in Suggested Practices for Raptor Protection on Powerlines or in Rural Electrification Bulletin 61-10, are "eagle safe." Such proof shall be provided by a raptor expert approved by the BLM State Director.
5. Care will be taken by the grantee to assure that scenic values are not damaged in the disposal of waste materials. Any large rocks which are left in the area as a result of construction activities will be placed so that they do not detract from the scenic view and do not hinder the movement of livestock or of big game animals. These residual rocks will not be piled or left in rows.
6. In those areas where erosion control structures are required to stabilize soil conditions, the grantee will install such structures as are suitable for the specific soil conditions being encountered and which are in accordance with sound resource management practices.
7. To prevent slacking of fence wire, the grantee will brace and tie-off each existing fence to be altered, before cutting. During construction, the opening will be protected to prevent the escape of livestock. Fences which have been cut during construction will be restored to a condition which is equal to or better than the original, by the grantee. Cattleguards and adjacent gates which are of a suitable width will also be installed in any fence where a road created during this construction is to be regularly traveled.
8. If a natural barrier which was being used for livestock control, is broken during construction, the grantee will adequately fence the area to prevent drift of livestock. Such fencing will be at his own expense.
9. Rights-of-way will not be fenced, nor will public access be restricted by the grantee, without specific written approval being granted by BLM's Roswell

ILLECIBLE