

N MEXICO OIL CONSERVATION COMMISSION
WELL LOCATION AND ACREAGE DEDICATION PLAT

Form C-102
Supersedes C-128
Effective 1-1-65

All distances must be from the outer boundaries of the Section.

Operator Yates Petroleum Corporation			Lease Boyd BN		Well No. 1
Unit Letter H	Section 15	Township 19 South	Range 25 East	County Eddy	
Actual Portage Location of Well: 1980 feet from the North line and 660 feet from the East line					
Ground Level Elev. 3455	Producing Formation Upper Canyon Reef		Pool Wildcat	Dedicated Acreage: 40 Acres	

1. Outline the acreage dedicated to the subject well by colored pencil or hachure marks on the plat below.
2. If more than one lease is dedicated to the well, outline each and identify the ownership thereof (both as to working interest and royalty).
3. If more than one lease of different ownership is dedicated to the well, have the interests of all owners been consolidated by communitization, unitization, force-pooling, etc?

☐ Yes ☐ No If answer is "yes," type of consolidation _____

If answer is "no," list the owners and tract descriptions which have actually been consolidated. (Use reverse side of this form if necessary.) _____

No allowable will be assigned to the well until all interests have been consolidated (by communitization, unitization, forced-pooling, or otherwise) or until a non-standard unit, eliminating such interests, has been approved by the Commission.

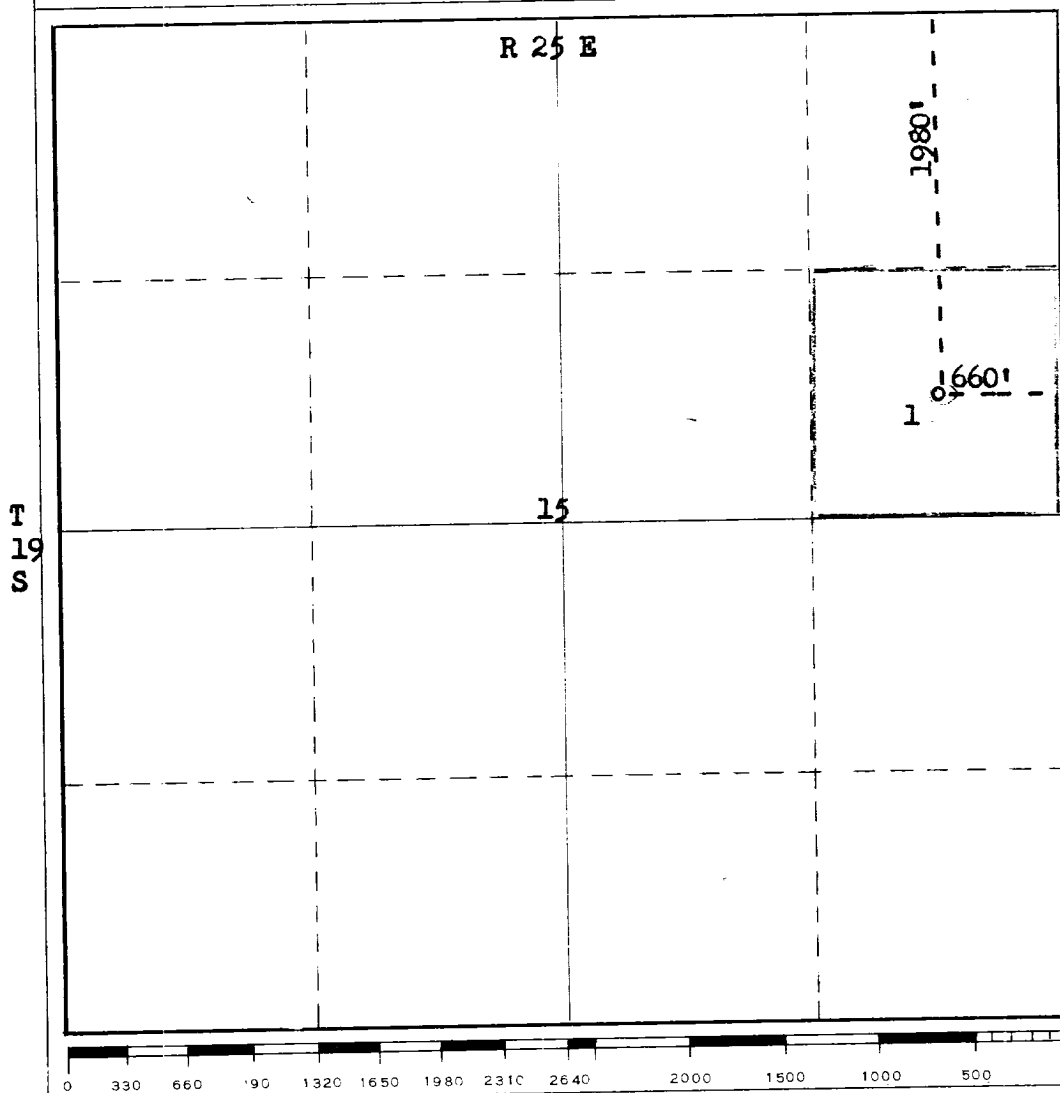

CERTIFICATION

I hereby certify that the information contained herein is true and complete to the best of my knowledge and belief.

Paul W. Hile

Name
Engineer

Position

Company
Yates Petroleum Corp.

Date
7-9-68

I hereby certify that the well location shown on this plat was plotted from field notes of actual surveys made by me or under my supervision, and that the same is true and correct to the best of my knowledge and belief.

Date Surveyed

July, 9, 1968

Registered Professional Land and/or Land Surveyor

James H. Brown

Certificate No.

N.M.L.S. No. 542

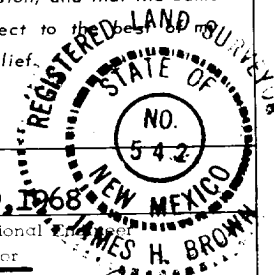

30-015-20155

Rec'd. 9-27-68

- (1) Acoustilog
- (1) Induction Electro-

log

- (1) Minilog

Rec'd. 1-2-67

Form 3-1225 Multipoint (C-1)

Grid - 05575

Prop - 12060

Roll - 72840

2728710-0

2728730-G

2728750-W