

NEW MEXICO OIL CONSERVATION COMMISSION
WELL LOCATION AND ACREAGE DEDICATION PLAT

Form C-102
Supersedes C-128
Effective 1-1-65

All distances must be from the outer boundaries of the Section.

Operator V. S. Welch		Lease Gulf		Well No. 1	
Unit Letter A	Section 28	Township 18 South	Range 31 East	County Eddy	
Actual Footage Location of Well: 990 feet from the North line and 330 feet from the East line					
Ground Level Elev. 3633	Producing Formation Queen - Grayburg		Pool Shugart	Dedicated Acreage: 40 Acres	

1. Outline the acreage dedicated to the subject well by colored pencil or hachure marks on the plat below.
2. If more than one lease is dedicated to the well, outline each and identify the ownership thereof (both as to working interest and royalty).
3. If more than one lease of different ownership is dedicated to the well, have the interests of all owners been consolidated by communitization, unitization, force-pooling, etc?

☐ Yes ☐ No If answer is "yes," type of consolidation SEP 20 1968

If answer is "no," list the owners and tract descriptions which have actually been consolidated. (Use reverse side of this form if necessary.) U.S. ARTEZIA, OFFICE

No allowable will be assigned to the well until all interests have been consolidated (by communitization, unitization, forced-pooling, or otherwise) or until a non-standard unit, eliminating such interests, has been approved by the Commission.

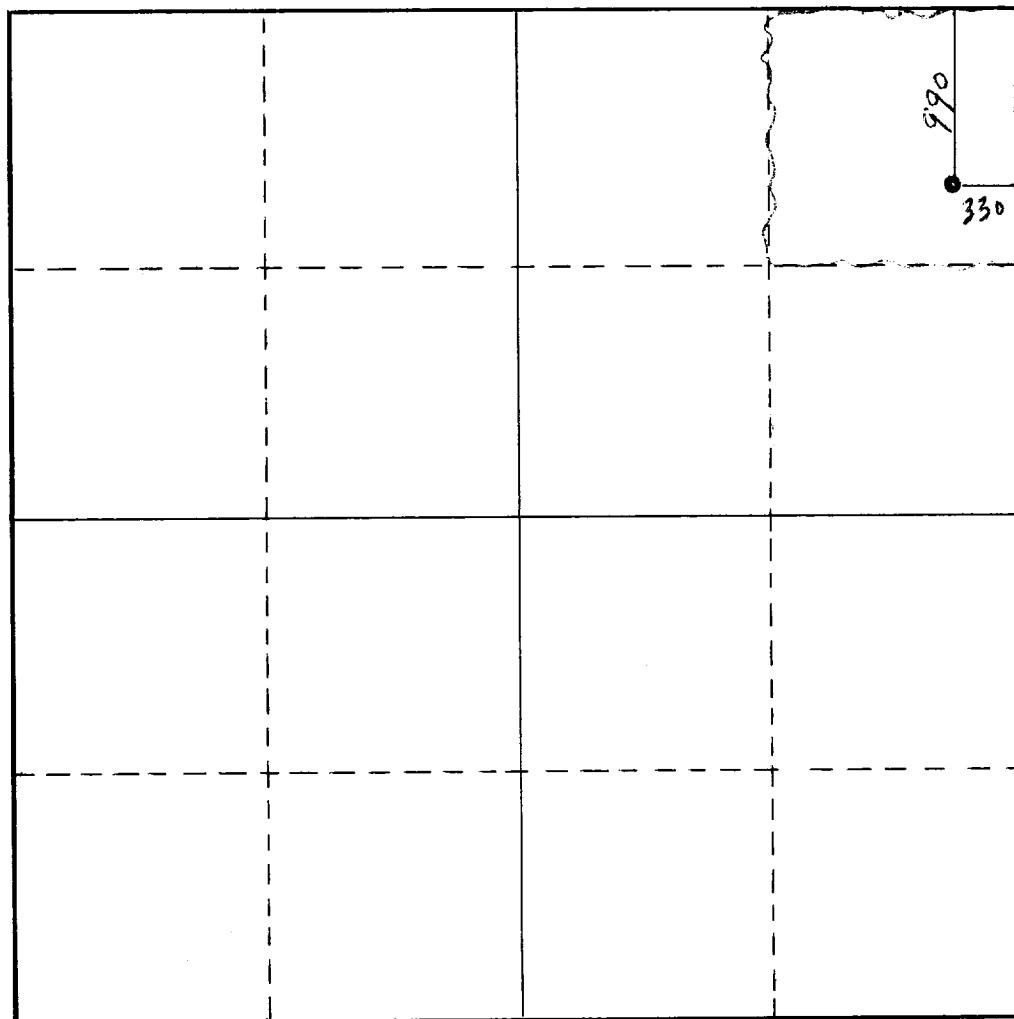

CERTIFICATION

I hereby certify that the information contained herein is true and complete to the best of my knowledge and belief.

Name **V. S. WELCH**
Position **OWNER**
Company **V. S. WELCH**
Date **9/18/68**

I hereby certify that the well location shown on this plat was plotted from field notes actual survey made by me or under my supervision, and that the same is true and correct to the best of my knowledge and belief.

Date Surveyed **September 12, 1968**
Registered Professional Engineer and/or Land Surveyor

John A. Mathis Jr.
Certificate No. **1502**

