

NE MEXICO OIL CONSERVATION COMMISSIC
WELL LOCATION AND ACREAGE DEDICATION PLAT

Form C-102
Supersedes C-128
Effective 1-1-65

All distances must be from the outer boundaries of the Section.

Operator Maxwell Oil Co.		Lease Taylor Unit		Well No. 1
Unit Letter	Section 12	Township 18 South	Range 31 East	County Eddy
Actual Footage Location of Well:				
1080 feet from the South line and 660 feet from the East line				
Ground Level Elev: 3760	Producing Formation Queen Sand	Pool Shugart	Dedicated Acreage: 40 Acres	

- Outline the acreage dedicated to the subject well by colored pencil or hachure marks on the plat below.
- If more than one lease is dedicated to the well, outline each and identify the ownership thereof (both as to working interest and royalty).
- If more than one lease of different ownership is dedicated to the well, have the interests of all owners been consolidated by communitization, unitization, force-pooling, etc?

☐ Yes ☐ No If answer is "yes," type of consolidation _____

If answer is "no," list the owners and tract descriptions which have actually been consolidated. (Use reverse side of this form if necessary.) _____

No allowable will be assigned to the well until all interests have been consolidated (by communitization, unitization, forced-pooling, or otherwise) or until a non-standard unit, eliminating such interests, has been approved by the Commission.

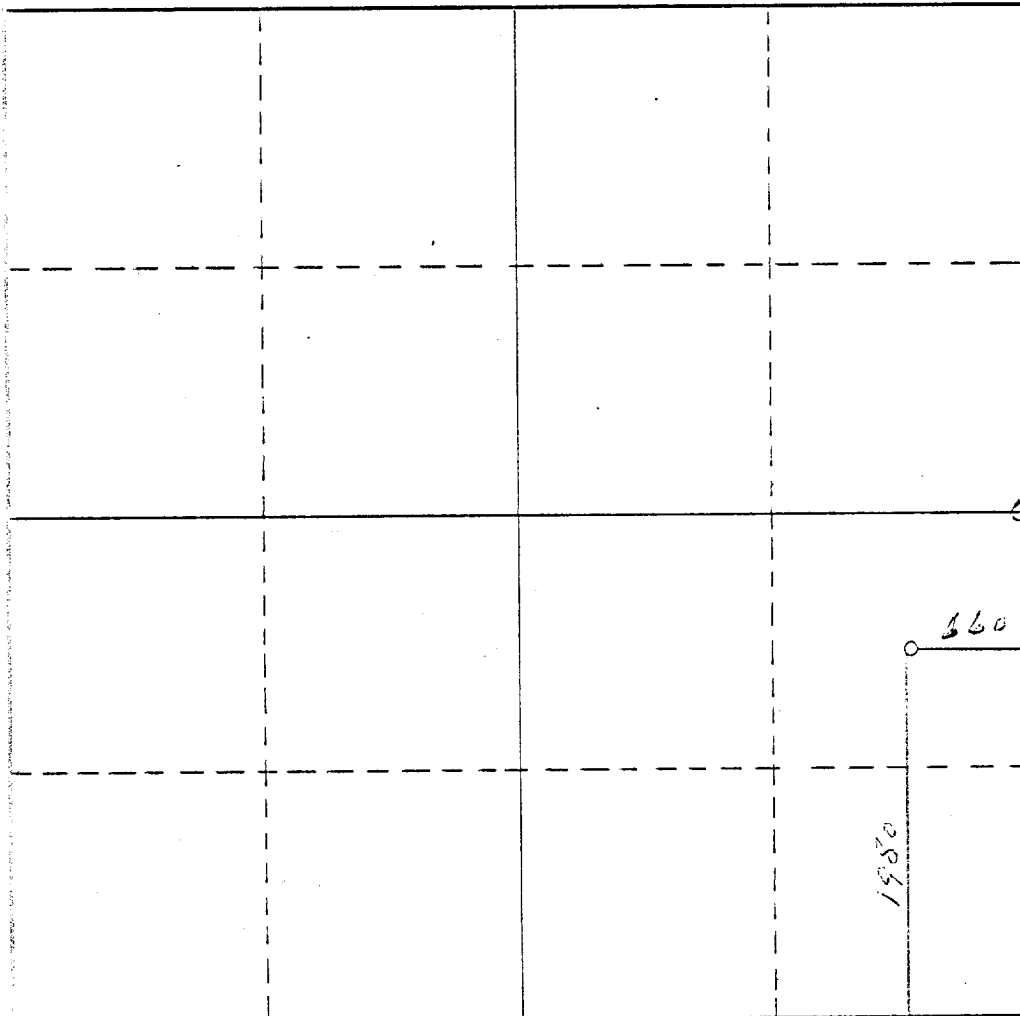

CERTIFICATION

I hereby certify that the information contained herein is true and complete to the best of my knowledge and belief.

Joseph D. Kennedy
Name
Sec'y-Treas.

Position
Maxwell Oil Company

Company
April 17, 1969

Date

050105.

I hereby certify that the well location shown on this plat was plotted from field notes of actual surveys made by me or under my supervision and that the same is true and correct to the best of my knowledge and belief.

Date Surveyed

April 14, 1969

Registered Professional Engineer and/or Land Surveyor

Certificate No.
1502

0 330 660 990 1320 1650 1980 2310 2640 2000 1500 1000 500 0