

NO. OF COPIES RECEIVED	6
DISTRIBUTION	
SANTA FE	
FILE	
U.S.G.S.	
LAND OFFICE	
OPERATOR	

NEW MEXICO OIL CONSERVATION COMMISSION

NOV 2 1969

D. C. ARTESIA

30-015-20267

Form C-101
Revised 1-1-65

5A. Indicate Type of Lease

STATE ☐

FEE ☒

5. State Oil & Gas Lease No.

APPLICATION FOR PERMIT TO DRILL, DEEPEN, OR PLUG BACK

1a. Type of Work		7. Unit Agreement Name	
b. Type of Well OIL WELL <input type="checkbox"/> GAS WELL <input checked="" type="checkbox"/> OTHER <input type="checkbox"/>		8. Farm or Lease Name Ben F. Pearman, Jr., et al	
2. Name of Operator Gulf Oil Corporation - Continental Petroleum Corp.		9. Well No. 1	
3. Address of Operator Box 670, Hobbs, N.M. 88240		10. Field and Pool, or Wildcat Wildcat	
4. Location of Well UNIT LETTER K LOCATED 1980 FEET FROM THE south LINE AND 1980 FEET FROM THE west LINE OF SEC. 32 TWP. 19S RGE. 26E NMPM		12. County Eddy	
19. Proposed Depth 9,700'		19A. Formation Penn Wildcat	
20. Rotary or C.T. Rotary		21. Elevations (Show whether DF, RT, etc.) Furhish later	
21A. Kind & Status Plug. Bond Blanket		21B. Drilling Contractor Cactus Drilling Corp.	
22. Approx. Date Work will start 11-28-69			

23.

PROPOSED CASING AND CEMENT PROGRAM

SIZE OF HOLE	SIZE OF CASING	WEIGHT PER FOOT	SETTING DEPTH	SACKS OF CEMENT	EST. TOP
17-1/2"	13-3/8"	48#	350	Circulate	Circulate
11"	8-5/8"	24#	2500	Circulate	Circulate
7-7/8"	5-1/2"	15.5#	9700	200	8500'

APPROVAL VALID
FOR 90 DAYS UNLESS
DRILLING COMMENCED,
EXPIRES **2-21-70**

IN ABOVE SPACE DESCRIBE PROPOSED PROGRAM; IF PROPOSAL IS TO DEEPEN OR PLUG BACK, GIVE DATA ON PRESENT PRODUCTIVE ZONE AND PROPOSED NEW PRODUCTIVE ZONE. GIVE BLOWOUT PREVENTER PROGRAM, IF ANY.

I hereby certify that the information above is true and complete to the best of my knowledge and belief.

Signed **C. E. MACE** Title **Area Petroleum Engineer** Date **11-21-69**

(This space for State Use)

APPROVED BY **W. A. Gressett** TITLE **Area Petroleum Engineer** DATE **11-21-69**

CONDITIONS OF APPROVAL, IF ANY:

cement must be circulated to surface before 13 3/8" & 8 5/8" casing the 8 5/8" casing

**MEXICO OIL CONSERVATION COMMISSION
WELL LOCATION AND ACREAGE DEDICATION PLAT**

Form C-102
Supersedes C-128
Effective 1-1-65

All distances must be from the outer boundaries of the Section.

Operator GULF OIL CORP. CONFIDENTIAL		Lease BEN S. PEARMAN, JR., ET AL		Well No. 1
Unit Letter K	Section 32	Township 19 SOUTH	Range 26 EAST	County EDDY
Actual Footage Location of Well: <div style="display: flex; justify-content: space-between;"> 1980' feet from the SOUTH line and 1980' feet from the WEST line </div>				
Ground Level Elev. Furnish later	Producing Formation Wildcat	Pool Undesignated	Dedicated Acreage: 320 Acres	

1. Outline the acreage dedicated to the subject well by colored pencil or hachure marks on the plat below.
2. If more than one lease is dedicated to the well, outline each and identify the ownership thereof (both as to working interest and royalty).
3. If more than one lease of different ownership is dedicated to the well, have the interests of all owners been consolidated by communitization, unitization, force-pooling, etc?

☐ Yes ☐ No If answer is "yes," type of consolidation _____

If answer is "no," list the owners and tract descriptions which have actually been consolidated. (Use reverse side of this form if necessary.) _____

No allowable will be assigned to the well until all interests have been consolidated (by communitization, unitization, forced-pooling, or otherwise) or until a non-standard unit, eliminating such interests, has been approved by the Commission.

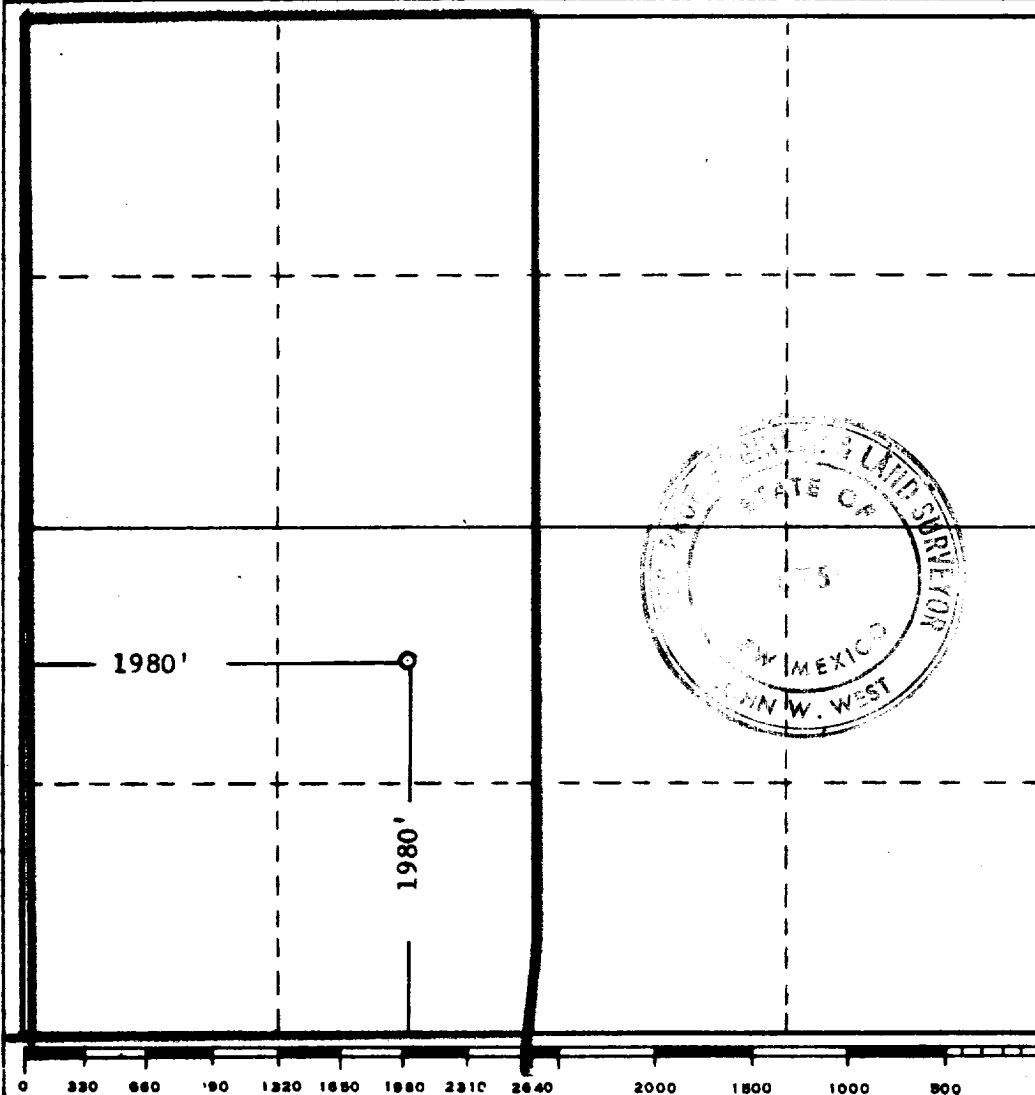

CERTIFICATION

I hereby certify that the information contained herein is true and complete to the best of my knowledge and belief.

Name **C. E. MACE**
 Position **Area Petroleum Engineer**
 Company **Gulf Oil Corporation**
 Date **11-21-69**

I hereby certify that the well location shown on this plat was plotted from field notes of actual surveys made by me or under my supervision, and that the same is true and correct to the best of my knowledge and belief.

NOVEMBER 20, 1969

Date Surveyed

Registered Professional Engineer and/or Land Surveyor

[Signature]
 Certificate No. **676**