

UNITED STATES
DEPARTMENT OF THE INTERIOR
BUREAU OF LAND MANAGEMENT
Artesia, NM 88210

SUBMIT IN COMPLETION
(Other instructions on reverse side)

30-015-22744
Form approved.
Budget Bureau No. 1004-0136
Expires August 31, 1985

APPLICATION FOR PERMIT TO DRILL, DEEPEN, OR PLUG BACK		
1a. TYPE OF WORK DRILL <input checked="" type="checkbox"/> DEEPEN <input type="checkbox"/> PLUG BACK <input type="checkbox"/>		
b. TYPE OF WELL OIL WELL <input type="checkbox"/> GAS WELL <input checked="" type="checkbox"/> OTHER [Re-entry] <input type="checkbox"/> SINGLE ZONE <input type="checkbox"/> MULTIPLE ZONE <input checked="" type="checkbox"/>		
2. NAME OF OPERATOR Yates Petroleum Corporation		
3. ADDRESS OF OPERATOR 105 South Fourth Street - Artesia, New Mexico 88210		
4. LOCATION OF WELL (Report location clearly and in accordance with any State requirements.)* At surface 1980' FNL & 1980' FWL At proposed prod. zone Same		
14. DISTANCE IN MILES AND DIRECTION FROM NEAREST TOWN OR POST OFFICE* Approximately 29 miles SW of Artesia, New Mexico		
10. DISTANCE FROM PROPOSED* LOCATION TO NEAREST PROPERTY OR LEASE LINE, FT. (Also to nearest drlg. unit line, if any)	16. NO. OF ACRES IN LEASE	17. NO. OF ACRES ASSIGNED TO THIS WELL
1980'	594.38	320
18. DISTANCE FROM PROPOSED LOCATION* TO NEAREST WELL, DRILLING, COMPLETED, OR APPLIED FOR, ON THIS LEASE, FT.	19. PROPOSED DEPTH	20. ROTARY OR CABLE TOOLS
	9175	Pulling Unit
21. ELEVATIONS (Show whether DF, RT, GR, etc.) 3939 DF		22. APPROX. DATE WORK WILL START* When Approved

PROPOSED CASING AND CEMENTING PROGRAM				
SIZE OF HOLE	SIZE OF CASING	WEIGHT PER FOOT	SETTING DEPTH	QUANTITY OF CEMENT
17 1/2"	13 3/8"	48#	316'	575 (in place)
12 1/4"	8 5/8"	24#	1990'	825 (in place)
7 7/8"	5 1/2"	15.5 - 17#	9175'	

Yates plans to re-enter the old Allied Chemical Corporation well Gulf-Federal #1 which was P & Aed 12-22-70. Yates proposes to dig out abandonment maker and surface plug, install flange and BOP's on well head, test BOP's and drill out plugs to original TD of 9175'. Then log well and if warranted, run 5 1/2" casing and cement to 500' above top of Abo or approx. 3300'. Selectively perforate and stimulate potential pays as warranted and test.

*MUD: Cased hole: FW
Open hole: Salt Gel.

Post ID-1
3-9-90
Re-entry

RECEIVED

IN ABOVE SPACE DESCRIBE PROPOSED PROGRAM: If proposal is to deepen or plug back, give data on present productive zone and proposed new productive zone. If proposal is to drill or deepen directionally, give pertinent data on subsurface locations and measured and true vertical depths. Give blowout preventer program, if any.

24. SIGNED San Deary TITLE Landman DATE 12-15-89

(This space for Federal or State office use)

PERMIT NO. _____ APPROVAL DATE _____

APPROVED BY Carlssad Resource TITLE AREA MANAGER DATE 1-10-89
CONDITIONS OF APPROVAL, IF ANY: _____

*See Instructions On Reverse Side

OIL CONSERVATION DIVISION

P.O. Box 2088

Santa Fe, New Mexico 87504-2088

DISTRICT I

P.O. Box 1980, Hobbs, NM 88240

DISTRICT II

P.O. Drawer DD, Artesia, NM 88210

DISTRICT III

1000 Rio Brazos Rd., Aztec, NM 87410

WELL LOCATION AND ACREAGE DEDICATION PLAT

All Distances must be from the outer boundaries of the section

Operator Yates Petroleum Corporation			Lease Gulf "AGT" Federal		Well No. 1
Unit Letter F	Section 6	Township 20 South	Range 24 East	County NMPM Eddy	

Actual Footage Location of Well:

1980 feet from the North line and	1980 feet from the West line		
Ground level Elev. 3927.4	Producing Formation Morrow	Pool Wildcat	Dedicated Acreage: 320 Acres

1. Outline the acreage dedicated to the subject well by colored pencil or hatchure marks on the plat below.
2. If more than one lease is dedicated to the well, outline each and identify the ownership thereof (both as to working interest and royalty).
3. If more than one lease of different ownership is dedicated to the well, have the interest of all owners been consolidated by communitization, unitization, force-pooling, etc.?
☐ Yes ☐ No If answer is "yes" type of consolidation _____
If answer is "no" list the owners and tract descriptions which have actually been consolidated. (Use reverse side of this form if necessary.) _____
No allowable will be assigned to the well until all interests have been consolidated (by communitization, unitization, forced-pooling, or otherwise) or until a non-standard unit, eliminating such interest, has been approved by the Division.

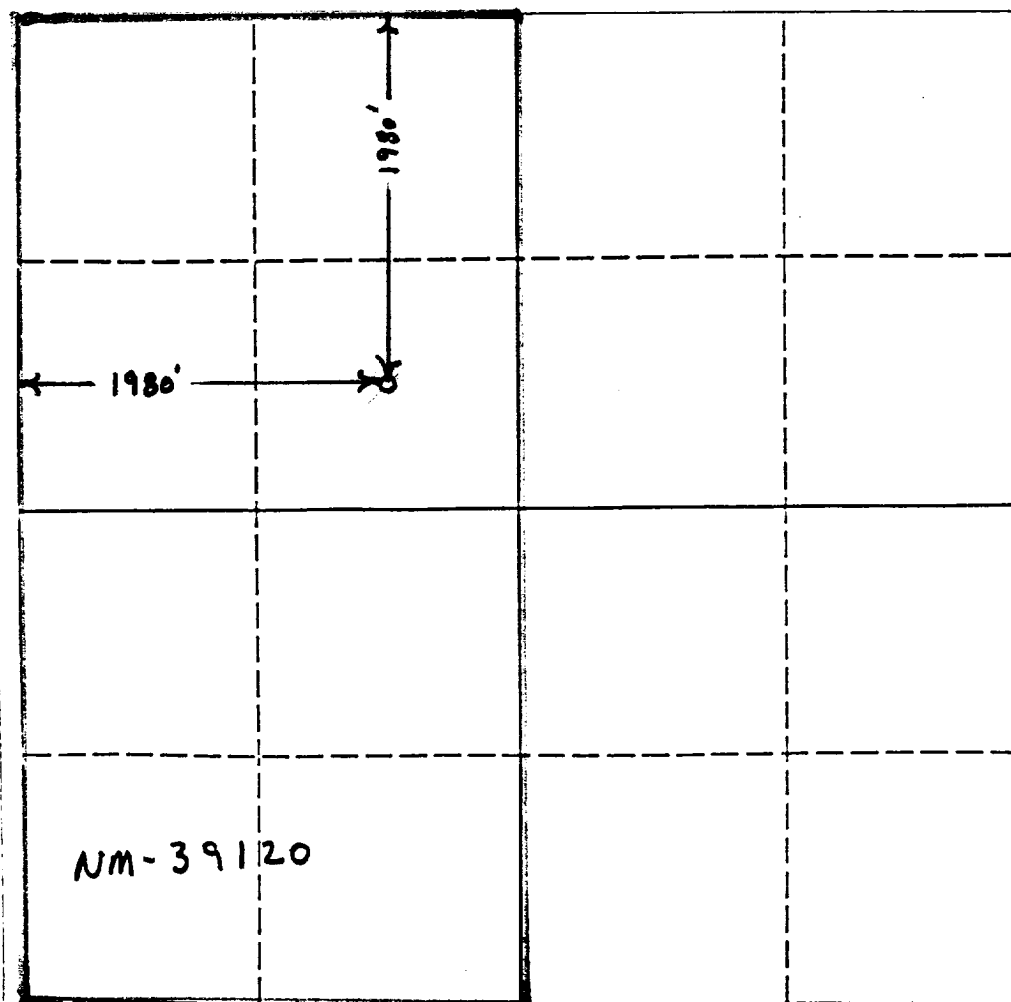

OPERATOR CERTIFICATION

I hereby certify that the information contained herein is true and complete to the best of my knowledge and belief.

Signature <i>Ken Beardemphl</i>
Printed Name Ken Beardemphl
Position Landman
Company Yates Petroleum Corporation
Date 12-18-89

SURVEYOR CERTIFICATION

I hereby certify that the well location shown on this plat was plotted from field notes of actual surveys made by me or under my supervision, and that the same is true and correct to the best of my knowledge and belief.

Date Surveyed
Signature & Seal of Professional Surveyor
Refer to original plat
Certificate No.

MEXICO OIL CONSERVATION COMMISSION
WELL LOCATION AND ACREAGE DEDICATION PLAT

Form C-102
Supersedes C-128
Effective 1-1-65

All distances must be from the outer boundaries of the Section

Operator <u>Allied Chemical Corp.</u> <u>UNION TEXAS PETROLEUM CORP.</u>		Lease <u>GULF FEDERAL</u>		Well No. <u>1</u>
Unit Letter <u>F</u>	Section <u>6</u>	Township <u>20 SOUTH</u>	Range <u>24 EAST</u>	County <u>EDDY</u>
Actual Footage Location of Well: <u>1980</u> feet from the <u>NORTH</u> line and <u>1980</u> feet from the <u>WEST</u> line				
Ground Level Elev. <u>3927.4</u>	Producing Formation <u>Wolfcamp - Atoka</u>	Pool <u>Willcat</u> <u>Undesignated</u>	Dedicated Acreage: <u>320</u> Acres	

1. Outline the acreage dedicated to the subject well by colored pencil or hachure marks on the plat below.
2. If more than one lease is dedicated to the well, outline each and identify the ownership thereof (both as to working interest and royalty).
3. If more than one lease of different ownership is dedicated to the well, have the interests of all owners been consolidated by communitization, unitization, force-pooling, etc?

☒ Yes ☐ No If answer is "yes," type of consolidation will be unitized later by farmout agreement with Gulf Oil Company.

If answer is "no," list the owners and tract descriptions which have actually been consolidated. (Use reverse side of this form if necessary.)

No allowable will be assigned to the well until all interests have been consolidated (by communitization, unitization, forced-pooling, or otherwise) or until a non-standard unit, eliminating such interests, has been approved by the Commission.

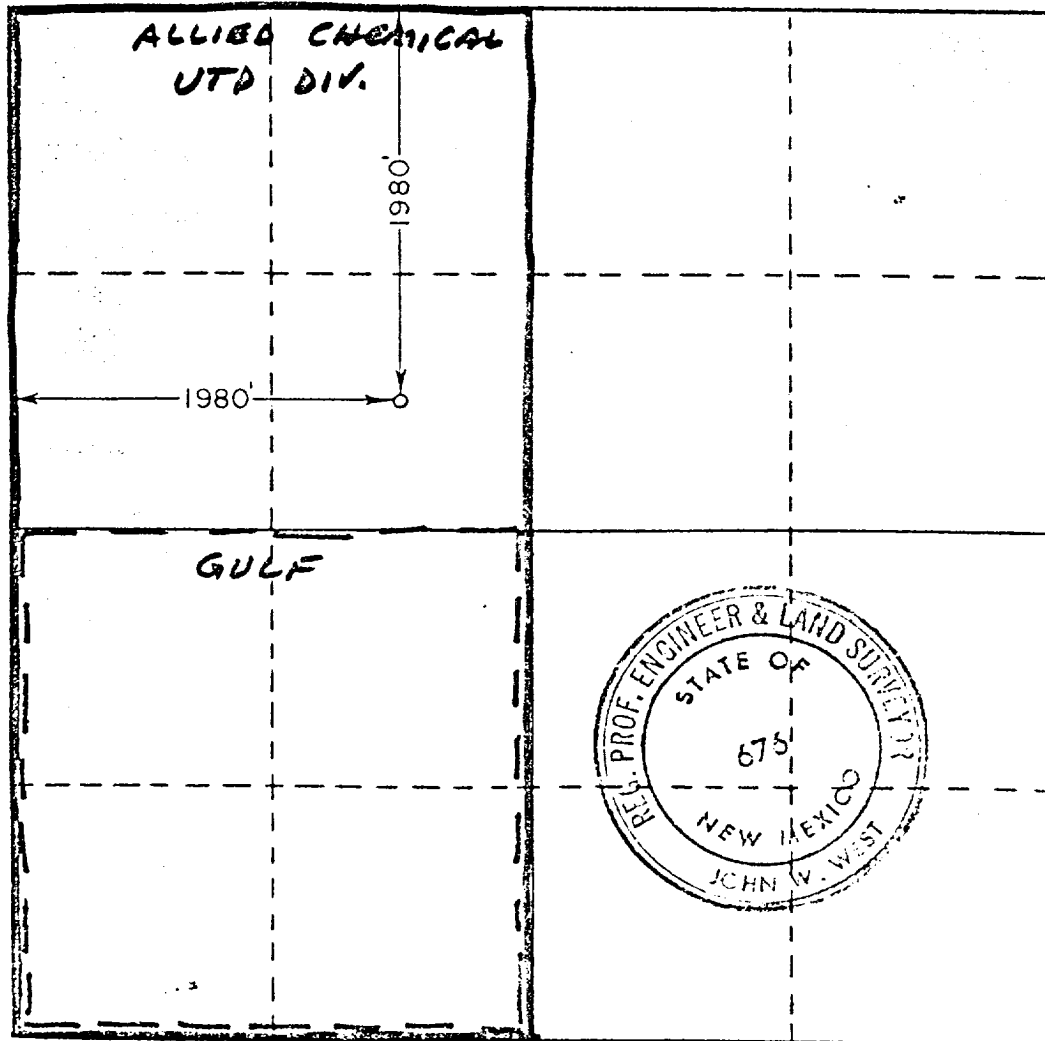

CERTIFICATION

I hereby certify that the information contained herein is true and complete to the best of my knowledge and belief.

Name R. W. Manry
Position Operations Supt. - Western
Company Union Texas Petroleum Corp.
Date October 28, 1970

I hereby certify that the well location shown on this plat was plotted from field notes and/or surveys made by me or under my supervision, and that the same is true to the best of my knowledge and belief.

JOHN W. WEST
DATE OCT 22 1970

Date Surveyed OCTOBER 22, 1970
Registered Professional Engineer and/or Land Surveyor

John W. West
Certificate No. 676

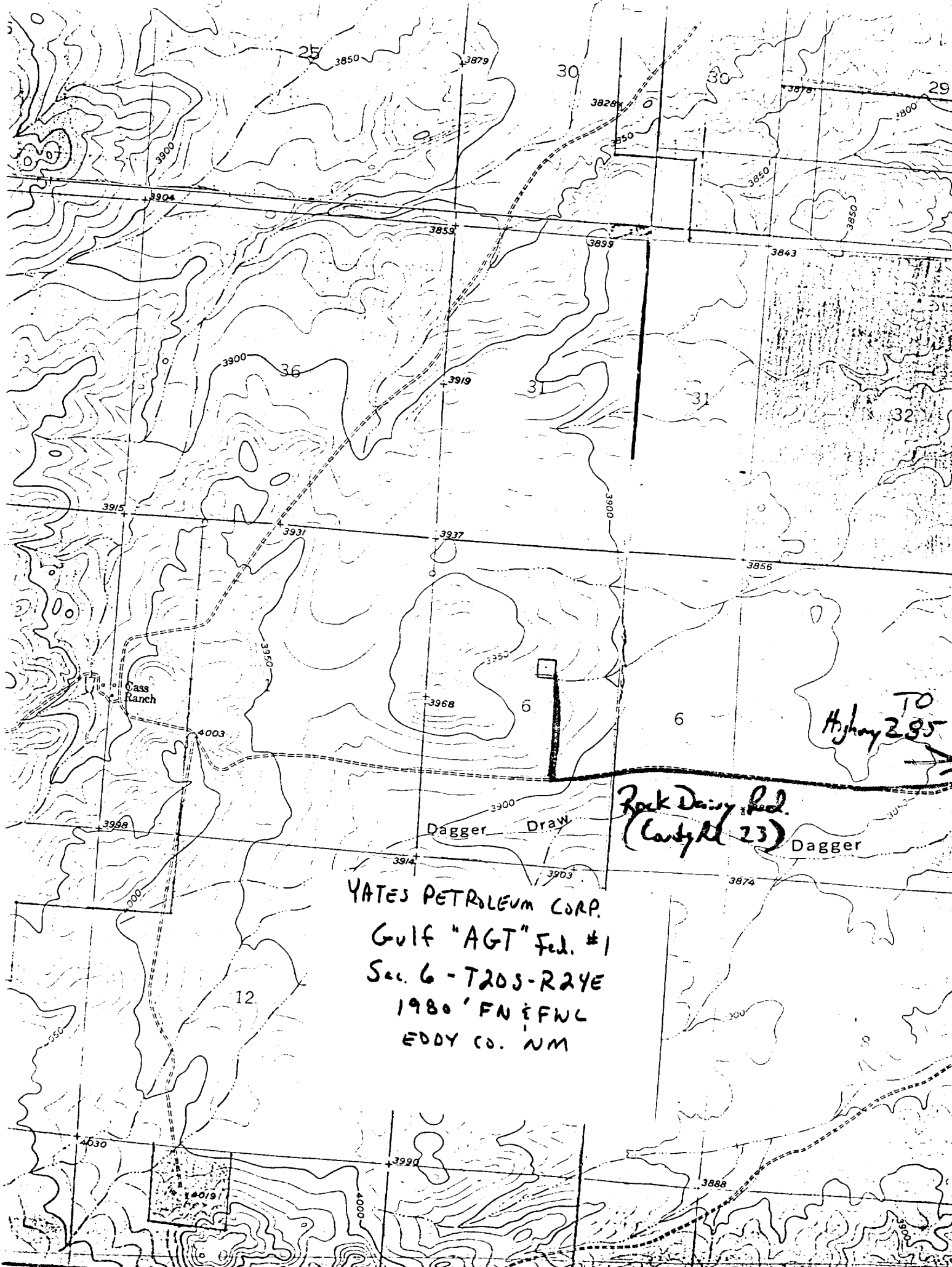

YATES PETROLEUM CORP.
Gulf "AGT" Fed. #1
Sec. 6 - T20S-R24E
1980' FN & FWL
EDDY CO. NM

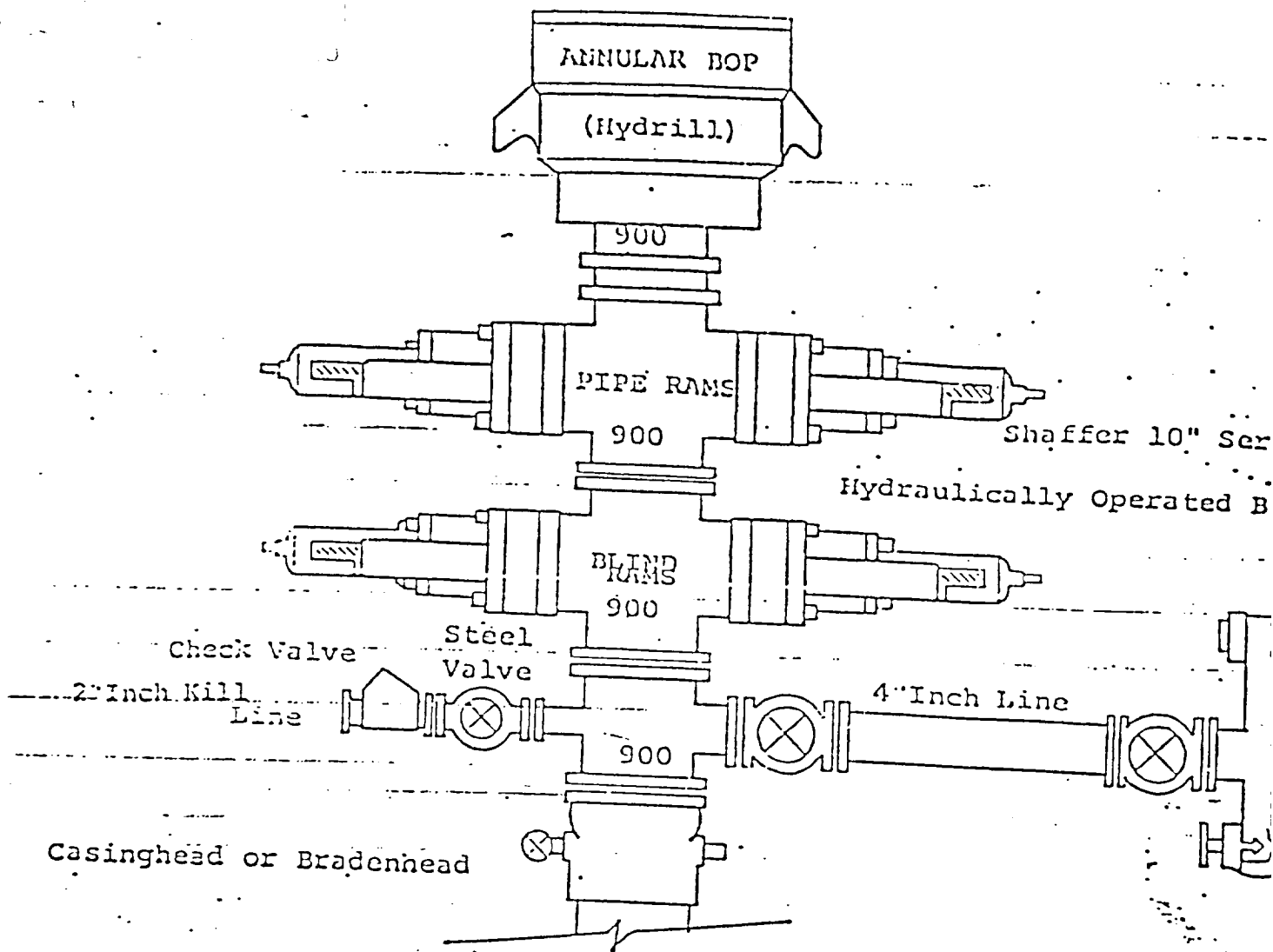

THE FOLLOWING CONSTITUTE MINIMUM BLOWOUT PREVENTER REQUIREMENTS

1. All preventers to be hydraulically operated with secondary manual installed prior to drilling out from under casing.
2. Choke outlet to be a minimum of 2" diameter.
3. Kill line to be of all steel construction of 2" minimum diameter.
4. All connections from operating manifolds to preventers to be all hole or tube a minimum of one inch in diameter.
5. The available closing pressure shall be at least 15% in excess of required with sufficient volume to operate the B.O.P.'s.
6. All connections to and from preventer to have a pressure rating equal to that of the B.O.P.'s.
7. Inside blowout preventer to be available on rig floor.
8. Operating controls located a safe distance from the rig floor.
9. Hole must be kept filled on trips below intermediate casing.

EXHIBIT B

YATES PETROLEUM CORPORATION

Gulf "AGT" Federal #1
1980' FNL & 1980' FWL
Section 6-T20S-R24E
Eddy County, New Mexico

In conjunction with Form 3160-3, Application for Permit to Drill subject well, Yates Petroleum Corporation submits the following ten items of pertinent information in accordance with USGS requirements.

1. The geological surface formation is alluvium.
2. The estimated tops of geologic markers are as follows:

San Andres	3174
Tubb	3819
Abo	5000
Wolfcamp	7320
Penn	8980
U. Miss	9124
TD	9175
3. The estimated depths at which anticipated water, oil or gas formations are expected to be encountered:

Water: Approximately 250' to 300'
Oil or Gas: Cisco and Morrow
4. Proposed Casing Program: See Form 3160-3.
5. Pressure Control Equipment: See Form 3160-3.
6. Mud Program: See Form 3160-3.
7. Auxiliary Equipment: Kelly Cock; sub with full-opening valve on floor, drill pipe connection.
8. Testing, Logging and Coring Program:

Samples: N/A
DST's: N/A
Coring: N/A
Logging: CNL/LTD from TD to casing with GR-CNL to surface; Resistivity Log
9. No abnormal pressures or temperatures are anticipated.
10. Anticipated starting date: As soon as possible after approval.

MULTI-POINT SURFACE USE AND OPERATIONS PLAN
Yates Petroleum Corporation

Gulf "AGT" Federal #1
1980' FNL & 1980' FWL
Section 6-T20S-R24E
Eddy County, New Mexico

This plan is submitted with Form 3160-3, Application for Permit to Drill, covering the above described well. The purpose of this plan is to describe the location of the proposed well, the proposed construction activities and operations plan, the magnitude of surface disturbance involved and the procedures to be followed in rehabilitating the surface after completion of the operations, so that a complete appraisal can be made of the environmental effect associated with the operations.

1. EXISTING ROADS:

Exhibit A is a portion of BLM county map showing the well and roads in the vicinity of the proposed location. The proposed wellsite is located approximately 29 miles southwest of Artesia, New Mexico and the access route to the location is indicated in red and green on Exhibit A.

DIRECTIONS:

1. Go south of Artesia, NM on Highway 285 for approximately 15 miles to the Rock Daisy Road.
2. Turn west on Rock Daisy Road for approximately 13 miles.
3. Turn north on the road old well location road to the existing location.

2. LOCATION OF EXISTING WELL

- A. There is no drilling activity within a one-mile radius of the wellsite.
- B. Exhibit D shows existing wells within a one-mile radius of the proposed wellsite.

3. LOCATION OF EXISTING AND/OR PROPOSED FACILITIES:

- A. There are no production facilities on this lease at the present time.
- B. In the event that the well is productive, the necessary production facilities will be installed on the drilling pad. If the well is productive oil, a gas or diesel self-contained unit will be used to provide the necessary power. No power will be required if the well is productive of gas.

4. LOCATION AND TYPE OF WATER SUPPLY:

- A. It is planned to drill the proposed well with a fresh water system. The water will be obtained from commercial sources and will be hauled to the location by truck over the existing and proposed roads shown in Exhibit A.

5. SOURCE OF CONSTRUCTION MATERIALS:

- A. None needed.

6. METHODS OF HANDLING WASTE DISPOSAL:

- A. Drill cuttings will be disposed of in the reserve pits.
- B. Drilling fluids will be allowed to evaporate in the reserve pits until the pits are dry.
- C. Water produced during operations will be collected in tanks until hauled to an approved disposal system, or separate disposal application will be submitted.
- D. Oil produced during operations will be stored in tanks until sold.
- E. Current laws and regulations pertaining to the disposal of human waste will be complied with.
- F. Trash, waste paper, garbage and junk will be buried in a separate trash pit and covered with a minimum of 24 inches of dirt. All waste material will be contained to prevent scattering by the wind.
- G. All trash and debris will be buried or removed from the wellsite within 30 days after finishing drilling and/or completion operations.

7. ANCILLIARY FACILITIES:

- A. None required.

8. WELLSITE LAYOUT:

- A. Exhibit C shows the relative location and dimensions of the well pad, the reserve pits, the location of the drilling equipment, rig orientation and access road approach. A cross section of drill pad with approximate cuts, fills and pad orientation is shown on Exhibit E.
- B. The reserve pits will be plastic lined.
- C. A 400' X 400' area has been staked and flagged.

9. PLANS FOR RESTORATION OF THE SURFACE:

- A. After finishing drilling and/or completion operations, all equipment and other material not needed for further operations will be removed. The location will be cleaned of all trash and junk to leave the wellsite in as aesthetically pleasing a condition as possible.
- B. Unguarded pits, if any, containing fluids will be fenced until they have dried and been levelled.
- C. If the proposed well is non-productive, all rehabilitation and/or vegetation requirements of the BLM will be complied with and will be accomplished as expeditiously as possible. All pits will be filled level within 90 days after abandonment.

10. SURFACE OWNERSHIP: BLM -- minerals and surface

11. OTHER INFORMATION:

- A. Topography: Refer to the archaeological report for a description of the topography, flora, fauna, soil characteristics, dwellings, historical and cultural sites.
- B. The primary surface use is for grazing.

12. OPERATOR'S REPRESENTATIVE:

A. Through A.P.D. Approval:

Ken Beardemphl, Landman
Yates Petroleum Corporation
105 South Fourth Street
Artesia, New Mexico 88210
Phone (505)-748-1471

B. Through Drilling Operations,
Completions and Production:

Mike Slater, Operations Manager
Yates Petroleum Corporation
105 South Fourth Street
Artesia, New Mexico 88210
Phone (505)-748-1471

13. CERTIFICATION:

I hereby certify that I, or persons under my direct supervision, have inspected the proposed drillsite and access route, that I am familiar with the conditions which presently exist; that the statements made in this plan are to the best of my knowledge, true and correct; and, that the work associated with the operations proposed herein will be performed by Yates Petroleum Corporation and its contractors and subcontractors in conformity with this plan and the terms and conditions under which it is approved. This statement is subject to the provisions of 18 U.S.C. 1001 for the filing of a false statement.

December 15, 1989
Date

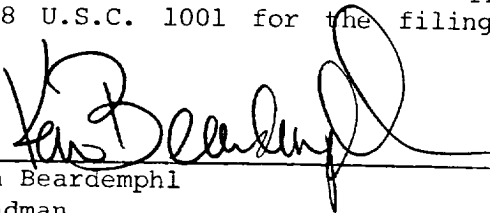

Ken Beardemphl
Landman



LTR



Job separation sheet

UNITED STATES
DEPARTMENT OF THE INTERIOR
GEOLOGICAL SURVEY

SUBMIT IN THE MANNER INDICATED*
(Other instructions on reverse side)

Form approved.
Budget Bureau No. 42-R1424.

5. LEASE DESIGNATION AND SERIAL NO.

N-M-81

6. IF INDIAN, ALLOTTEE OR TRIBE NAME

7. UNIT AGREEMENT NAME

8. FARM OR LEASE NAME

Gulf-Federal

9. WELL NO.

1

10. FIELD AND POOL, OR WILDCAT

Wildcat

11. SEC., T., R., M., OR BLK. AND SURVEY OR AREA

Sec. 6, T-20-S, R-24-E

12. COUNTY OR PARISH

Eddy

13. STATE

New Mexico

1. ☐ OIL WELL ☐ GAS WELL ☒ OTHER

2. NAME OF OPERATOR

Allied Chemical Corporation

3. ADDRESS OF OPERATOR

1300 Wilco Building, Midland, Texas 79701

4. LOCATION OF WELL (Report location clearly and in accordance with any State requirements.* See also space 17 below.)
At surface

1980' FNL & 1980' FWJ

14. PERMIT NO.

15. ELEVATIONS (Show whether DF, RT, GR, etc.)

3939' DF.

16. Check Appropriate Box To Indicate Nature of Notice, Report, or Other Data

NOTICE OF INTENTION TO:

TEST WATER SHUT-OFF

FRACTURE TREAT

SHOOT OR ACIDIZE

REPAIR WELL

(Other)

PULL OR ALTER CASING

MULTIPLE COMPLETE

ABANDON*

CHANGE PLANS

SUBSEQUENT REPORT OF:

WATER SHUT-OFF

FRACTURE TREATMENT

SHOOTING OR ACIDIZING

(Other)

REPAIRING WELL

ALTERING CASING

ABANDONMENT*

(NOTE: Report results of multiple completion on Well Completion or Recompletion Report and Log form.)

17. DESCRIBE PROPOSED OR COMPLETED OPERATIONS (Clearly state all pertinent details, and give pertinent dates, including estimated date of starting any proposed work. If well is directionally drilled, give subsurface locations and measured and true vertical depths for all markers and zones pertinent to this work.)*

1. Spot Cement plugs as follows:

Plug 1 - 35 Sxs. 8850' - 8750'

Plug 2 - 50 Sxs. 7800' - 7650'

Plug 3 - 35 Sxs. 6320' - 6220'

Plug 4 - 35 Sxs. 5450' - 5350'

Plug 5 - 35 Sxs. 3800' - 3700'

Plug 6 - 35 Sxs. 2050' - 1950'

Plug 7 - 10 Sxs. Top of 8 5/8"

2. Weld Steel plate on 8 5/8" Casing.

3. Install Dry Hole Marker.

RECEIVED

FEB 22 1971

U. S. G. S.
ARTESIA, OFFICE

RECEIVED

FEB 16 1971

U. S. GEOLOGICAL SURVEY
ARTESIA, NEW MEXICO

18. I hereby certify that the foregoing is true and correct
Allied Chemical Corp. By Union Texas
SIGNED *[Signature]*

Petroleum Corporation
TITLE Operations Supt.-Western Area DATE 2-12-71

(This space for Federal or State office use)

TITLE DATE

APPROVED

CONDITIONS OF APPROVAL, IF ANY:

FEB 19 1971

R. L. BECKMAN

ACTING DISTRICT ENGINEER

*See Instructions on Reverse Side

Instructions

General: This form is designed for submitting proposals to perform certain well operations, and reports of such operations when completed, as indicated, on Federal and Indian lands pursuant to applicable Federal law and regulations, and, if approved or accepted by any State, on all lands in such State, pursuant to applicable State law and regulations. Any necessary special instructions concerning the use of this form and the number of copies to be submitted, particularly with regard to local, area, or regional procedures and practices, either are shown below or will be issued by, or may be obtained from, the local Federal and/or State office.

Item 4: If there are no applicable State requirements, locations on Federal or Indian land should be described in accordance with Federal requirements. Consult local State or Federal office for specific instructions.

Item 17: Proposals to abandon a well and subsequent reports of abandonment should include such special information as is required by local Federal and/or State offices. In addition, such proposals and reports should include reasons for the abandonment; data on any former or present productive zones, or other zones with present significant fluid contents not sealed off by cement or otherwise; depths (top and bottom) and method of placement of cement plugs; mud or other material placed below, between and above plugs; amount, size, method of parting of any casing, liner or tubing pulled and the depth to top of any left in the hole; method of closing top of well; and date well site conditioned for final inspection looking to approval of the abandonment.