

NO. OF COPIES RECEIVED 5
DISTRIBUTION
SANTA FE
FILE
U.S.G.S.
LAND OFFICE
OPERATOR

RECEIVED
NEW MEXICO OIL CONSERVATION COMMISSION
AUG 15 1972
O.C.C.
ARTESIA, OFFICE

30-015-20727
Form C-101
Revised 1-1-65

5A. Indicate Type of Lease
STATE
FEE
5. State Oil & Gas Lease No.
7. Unit Agreement Name
8. Farm or Lease Name
Red Tank
9. Well No.
1
10. Field and Pool, or Wildcat
Wildcat
12. County
Eddy
19. Proposed Depth
8200
19A. Formation
Miss. Lime
20. Rotary or C.T.
Rotary
21B. Drilling Contractor
ARD Drilling Co.
22. Approx. Date Work will start
10-August-72

APPLICATION FOR PERMIT TO DRILL, DEEPEN, OR PLUG BACK
1a. Type of Work
b. Type of Well
DRILL
DEEPEN
PLUG BACK
2. Name of Operator
Green & Michaelson Producing Co.
3. Address of Operator
314 Building of the Southwest Midland, Texas
4. Location of Well
UNIT LETTER G LOCATED 1980 FEET FROM THE North LINE
AND 1980 FEET FROM THE East LINE OF SEC. 2 TWP. 19S RGE. 23E NMPM
21. Elevations (Show whether DF, RT, etc.)
3855 Gr.
21A. Kind & Status Plug. Bond
Blanket
21B. Drilling Contractor
ARD Drilling Co.

Table with 6 columns: SIZE OF HOLE, SIZE OF CASING, WEIGHT PER FOOT, SETTING DEPTH, SACKS OF CEMENT, EST. TOP. Rows include 1 1/2, 12 1/2, and 7 1/8 inch hole sizes with corresponding casing and cement data.

APPROVAL VALID
FOR 90 DAYS UNLESS
DRILLING COMMENCED,
EXPIRES 11-18-72

Adequate Blowout Preventers be used
Cement must be circulated to
surface behind 13 7/8" & 8 7/8" casing
the 8 7/8" casing

IN ABOVE SPACE DESCRIBE PROPOSED PROGRAM...
I hereby certify that the information above is true and complete to the best of my knowledge and belief.
Signed [Signature] Title Vice-President Date August 7, 1972
APPROVED BY [Signature] TITLE OIL AND GAS INSPECTOR DATE AUG 18 1972
CONDITIONS OF APPROVAL, IF ANY:

NEW MEXICO OIL CONSERVATION COMMISSION  
WELL LOCATION AND ACREAGE DEDICATION PLAT

Form C-102  
Supersedes C-128  
Effective 1-1-65

All distances must be from the outer boundaries of the Section.

Operator <b>Green &amp; Michaelson Producing Co.</b>			Lease <b>Red Tank</b>		Well No. <b>1</b>
Unit Letter <b>G</b>	Section <b>2</b>	Township <b>19S</b>	Range <b>23E</b>	County <b>Eddy</b>	
Actual Footage Location of Well:					
<b>1980</b> feet from the <b>North</b> line and		<b>1980</b> feet from the <b>East</b> line			
Ground Level Elev. <b>3855</b>	Producing Formation <b>Miss. Ls.</b>	Pool <b>Wildcat</b>		Dedicated Acreage: <b>40</b> Acres	

1. Outline the acreage dedicated to the subject well by colored pencil or hachure marks on the plat below.
2. If more than one lease is dedicated to the well, outline each and identify the ownership thereof (both as to working interest and royalty).
3. If more than one lease of different ownership is dedicated to the well, have the interests of all owners been consolidated by communitization, unitization, force-pooling, etc?

☒ Yes ☐ No If answer is "yes," type of consolidation **Communitization**

If answer is "no," list the owners and tract descriptions which have actually been consolidated. (Use reverse side of this form if necessary.) \_\_\_\_\_

No allowable will be assigned to the well until all interests have been consolidated (by communitization, unitization, forced-pooling, or otherwise) or until a non-standard unit, eliminating such interests, has been approved by the Commission.

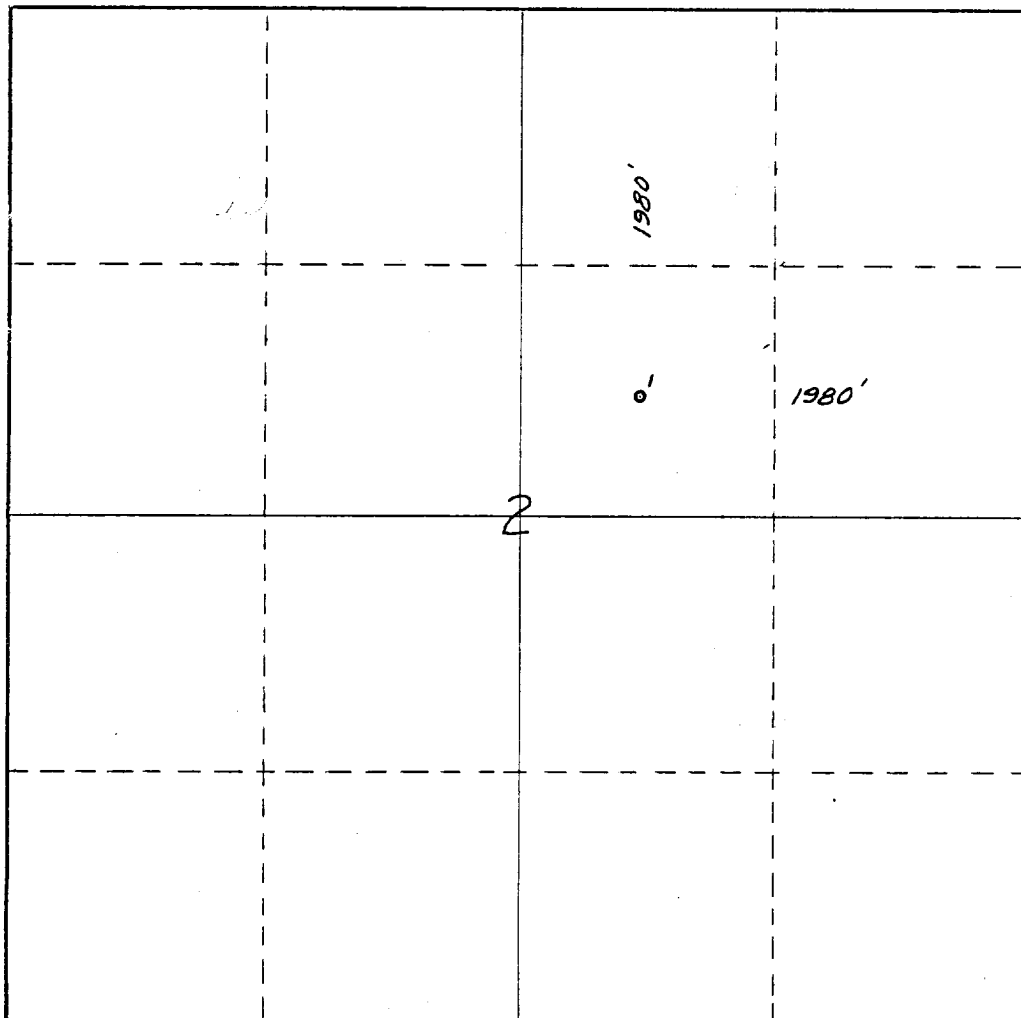

CERTIFICATION

I hereby certify that the information contained herein is true and complete to the best of my knowledge and belief.

Name: *[Signature]*  
Position: **Vice-President**  
Company: **Green & Michaelson Prod. Co.**  
Date: **August 10, 1972**

I hereby certify that the well location shown on this plat was plotted from field notes of actual surveys made by me or under my supervision, and that the same is true and correct to the best of my knowledge and belief.

Date Surveyed: **August 10, 1972**  
Registered Professional Land Surveyor  
*[Signature]*  
Certificate No. **1390**  
**JOHNSON**

0 330 660 990 1320 1650 1980 2310 2640 2000 1500 1000 500 0

## GREEN &amp; MICHAELSON PRODUCING CO.

314 BUILDING OF THE SOUTHWEST  
MIDLAND, TEXAS 79701

RECEIVED

AUG 15 1972

August 14, 1972

O. C. C.  
ARTESIA, OFFICENew Mexico Oil Conservation Committee  
Drawer DD  
Artesia, New Mexico 88210

RE: Green &amp; Michaelson #1 Red Tank

Gentlemen:

Enclosed will be found five copies of the C-101 and  
three copies of the C-102 on the caption well.

Yours truly,

GREEN &amp; MICHAELSON PRODUCING CO.

  
L. H. (Mike) Michaelson

LHM:gb

Encl.

*Called Mr. Michaelson on 8-18-72  
well to be drilled as oil well however.  
if they get gas have other storage to handle  
a standard 320 acres - may also be drilled  
to the Gov.*