

N M E OIL CONSERVATION COMMISS
WELL LOCATION AND ACREAGE DEDICATION PLAT

Form C-102
Supersedes C-128
Effective 1-1-65

All distances must be from the outer boundaries of the Section.

Operator COQUINA OIL CORP.		Lease PAN CANADIAN		Well No. 1
Unit Letter "F"	Section 34	Township 19-S	Range 25-E	County EDDY
Actual Footage Location of Well: <div style="display: flex; justify-content: space-between;"> 1980 feet from the NORTH line and 1980 feet from the WEST line </div>				
Ground Level Elev: 3521	Producing Formation MORROW	Pool ARTESIA <i>wildcat</i>	Dedicated Acreage: 40 320 Acres	

1. Outline the acreage dedicated to the subject well by colored pencil or hachure marks on the plat below.
2. If more than one lease is dedicated to the well, outline each and identify the ownership thereof (both as to working interest and royalty).
3. If more than one lease of different ownership is dedicated to the well, have the interests of all owners been consolidated by communitization, unitization, force-pooling, etc?

(all one lease)
☐ Yes ☐ No If answer is "yes," type of consolidation _____

If answer is "no," list the owners and tract descriptions which have actually been consolidated. (Use reverse side of this form if necessary.) _____

No allowable will be assigned to the well until all interests have been consolidated (by communitization, unitization, forced-pooling, or otherwise) or until a non-standard unit, eliminating such interests, has been approved by the Commission.

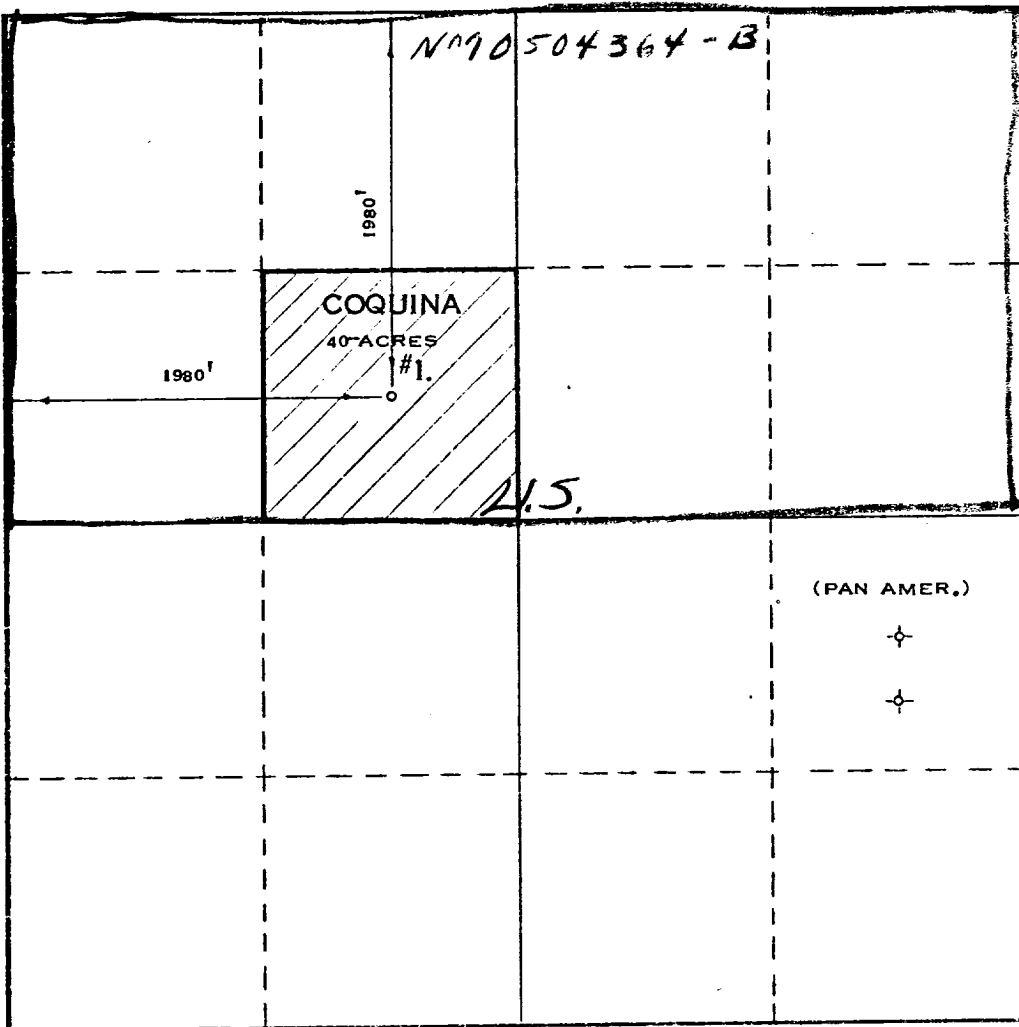

CERTIFICATION

I hereby certify that the information contained herein is true and complete to the best of my knowledge and belief.

Name
J.B. Taylor
 Position
Vice President
 Company
Coquina Oil Corporation
 Date
10-10-73

RECEIVED
 I hereby certify that the well location shown on this plat was plotted from field notes of a legal survey made by me or under my supervision and that the same is true and correct to the best of my knowledge and belief.
NOV 13 1973
WILLIAM A. SCHUMANN JR.

Date Surveyed
OCTOBER 5, 1973
 Registered Professional Engineer and/or Land Surveyor
William A. Schumann Jr.
MAX A SCHUMANN JR
 Certificate No. **1510**