

**NEW MEXICO OIL CONSERVATION COMMISSION
WELL LOCATION AND ACREAGE DEDICATION PLAT**

Form O-102
Supersedes O-120
Effective 1-1-65

All distances shall be from the outer boundaries of the Section

DAVID FASKEN			HOWELL "29"		Well No. 1
Section 0	Section 29	Township 20 South	Range 25 East	County EDDY	
Section Location of Well: 1980 feet from the North line and 2310 feet from the East line Section Level 3542 Producing Formation Narrow Pool Unclassified Cemetery Narrow Dedicated Acreage: 320 Acres					

- Outline the acreage dedicated to the subject well by colored pencil or hachure marks on the plat below.
- If more than one lease is dedicated to the well, outline each and identify the ownership thereof (both as to working interest and royalty).
- If more than one lease of different ownership is dedicated to the well, have the interests of all owners been consolidated by communitization, unitization, force pooling, etc?

Yes ☒ No ☐ If answer is "yes," type of consolidation _____

If answer is "no," list the owners and tract descriptions which have actually been consolidated. (Use reverse side of this form if necessary) STATE, FEDERAL, & Pooling FCC LEASES

No allowable well be assigned to the well until all interests have been consolidated (by communitization, unitization, force pooling or otherwise) or until a non-standard unit, eliminating such interests, has been approved by the Commission.

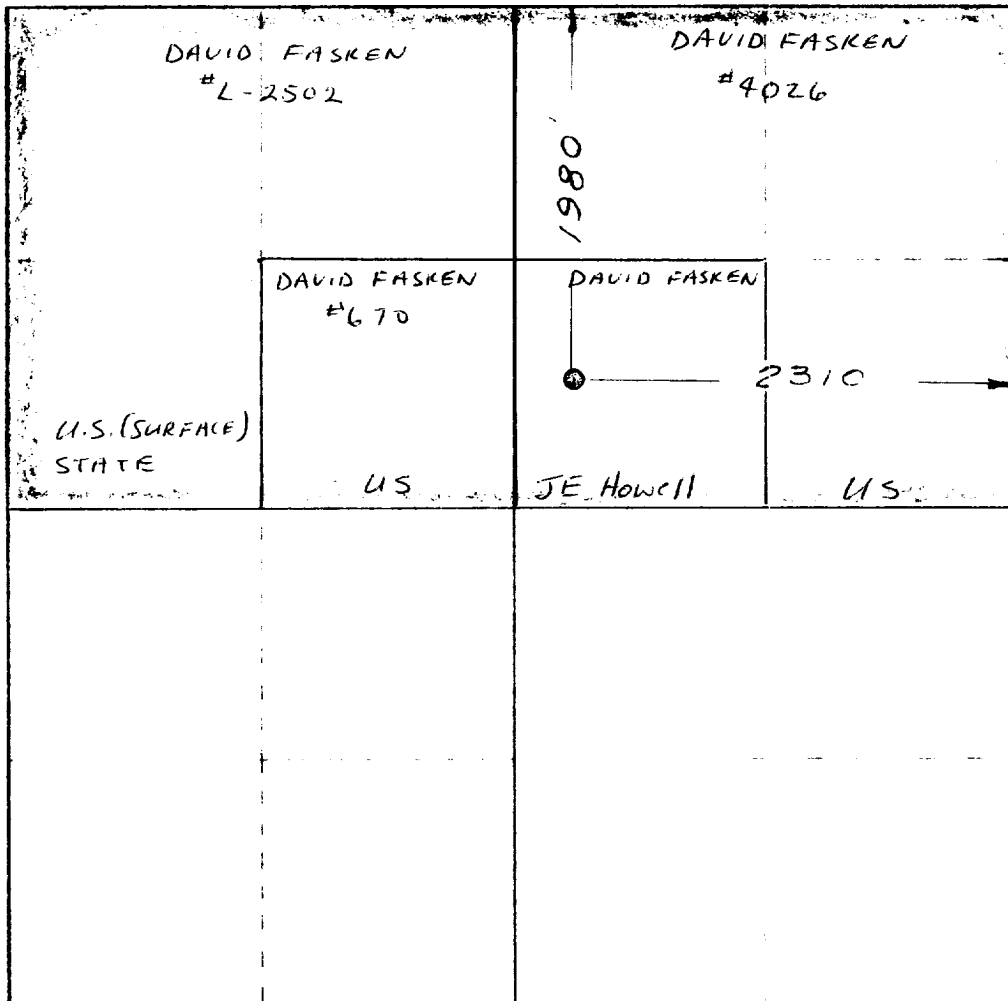

CERTIFICATION

I hereby certify that the information contained herein is true and complete to the best of my knowledge and belief.

Name RON L. MERCER
 Position AGENT
 Company DAVID FASKEN
 Date 3-22-74

I hereby certify that the well location shown on this plat was plotted from field notes of actual surveys made by me or under my supervision, and that the same is true and correct to the best of my knowledge and belief.

Date Surveyed March 22, 1974
 Registered Professional Engineer and/or Land Surveyor

W. W. Stearns
 Certificate No. **1559**