

NO. OF COPIES RECEIVED	5
DISTRIBUTION	
SANTA FE	1
FILE	1 ✓
U.S.G.S.	2
LAND OFFICE	
OPERATOR	1

NEW MEXICO OIL CONSERVATION COMMISSION

MAR 22 1974

D. C. C.
ARTISIA, OFFICE

30-015-21141
Form C-101
Revised 1-1-65

5A. Indicate Type of Lease	
STATE <input type="checkbox"/>	FEE <input checked="" type="checkbox"/>

5. State Oil & Gas Lease No.

APPLICATION FOR PERMIT TO DRILL, DEEPEN, OR PLUG BACK

1a. Type of Work				7. Unit Agreement Name	
b. Type of Well OIL WELL <input type="checkbox"/> GAS WELL <input checked="" type="checkbox"/> OTHER <input checked="" type="checkbox"/> Wildcat				8. Farm or Lease Name Holstun "Com"	
2. Name of Operator Mark Production Company				9. Well No. 1	
3. Address of Operator 330 Citizens Bank Bldg., Tyler, Texas 75701				10. Field and Pool, or Wildcat Undesignated Wildcat	
4. Location of Well UNIT LETTER <u>B</u> LOCATED <u>1980</u> FEET FROM THE <u>East</u> LINE AND <u>660</u> FEET FROM THE <u>North</u> LINE OF SEC. <u>4</u> TWP. <u>20S</u> RGE. <u>25E</u> NMPM				12. County Eddy	
19. Proposed Depth 10,000'				19A. Formation Pennsylvanian	
20. Rotary or C.T. Rotary				21. Elevations (Show whether DF, RT, etc.) 3592.6'	
21A. Kind & Status Plug. Bond \$10,000 Blanket		21B. Drilling Contractor Unknown at this time		22. Approx. Date Work will start May 15, 1974	

23.

PROPOSED CASING AND CEMENT PROGRAM

SIZE OF HOLE	SIZE OF CASING	WEIGHT PER FOOT	SETTING DEPTH	SACKS OF CEMENT	EST. TOP
17-1/2"	12-3/4"	32#	300	350	Circulated
11"	8-5/8"	28#	1,250	375	Circulated
7-7/8"	4-1/2"	10.5# & 11.6#	10,000	375	

10" 900 Series Hydril

Shaffer Model 39 - 3000# Hydraulic Blowout Preventers (see attached plat showing choke manifold and equipment)

Pit volume Totalizer

Flowline sensor

Pumpstroke counter

APPROVAL VALID
FOR 90 DAYS UNLESS
DRILLING COMMENCED,

EXPIRES 6-25-74

IN ABOVE SPACE DESCRIBE PROPOSED PROGRAM; IF PROPOSAL IS TO DEEPEN OR PLUG BACK, GIVE DATA ON PRESENT PRODUCTIVE ZONE AND PROPOSED NEW PRODUCTIVE ZONE. GIVE BLOWOUT PREVENTER PROGRAM, IF ANY.

I hereby certify that the information above is true and complete to the best of my knowledge and belief.

Signed Gaylore Thompson Title Assistant Secretary Date March 19, 1974

(This space for State Use)

APPROVED BY W. A. Gressett
CONDITIONS OF APPROVAL, IF ANY:

TITLE OIL AND GAS INSPECTOR

Cement must be circulated to
surface behind 12 3/4" casing

MAR 25 1974
Notify N.M.O.C.C. in sufficient
time to witness cementing

NE MEXICO OIL CONSERVATION COMMISSION
WELL LOCATION AND ACREAGE DEDICATION PLAT

Form C-102
Supersedes C-128
Effective 1-1-65

All distances must be from the outer boundaries of the Section.

Operator MARK PRODUCTION CO.		Lease HOLSTON TOM		Well No. 1
Unit Letter "B"	Section 4	Township 20 South	Range 25 East	County Eddy
Actual Footage Location of Well: 1980 feet from the East line and 660 feet from the North line				
Ground Level Elev. 3592.6	Producing Formation Pennsylvanian	Pool Undesignated Wildcat	Dedicated Acreage: 22.59 N 1/2 32000	

- Outline the acreage dedicated to the subject well by colored pencil or hachure marks on the plat below.
- If more than one lease is dedicated to the well, outline each and identify the ownership thereof (both as to working interest and royalty).
- If more than one lease of different ownership is dedicated to the well, have the interests of all owners been consolidated by communitization, unitization, force-pooling, etc?

☐ Yes ☒ No If answer is "yes," type of consolidation _____

If answer is "no," list the owners and tract descriptions which have actually been consolidated. (Use reverse side of this form if necessary.) MARK PRODUCTION (N 1/2 SE 1/4 NW 1/4 & W 1/2 SE 1/4 NW 1/4) AND MINORANTS (NE 1/4 & NW 1/4)

No allowable will be assigned to the well until all interests have been consolidated (by communitization, unitization, forced-pooling, or otherwise) or until a non-standard unit, eliminating such interests, has been approved by the Commission.

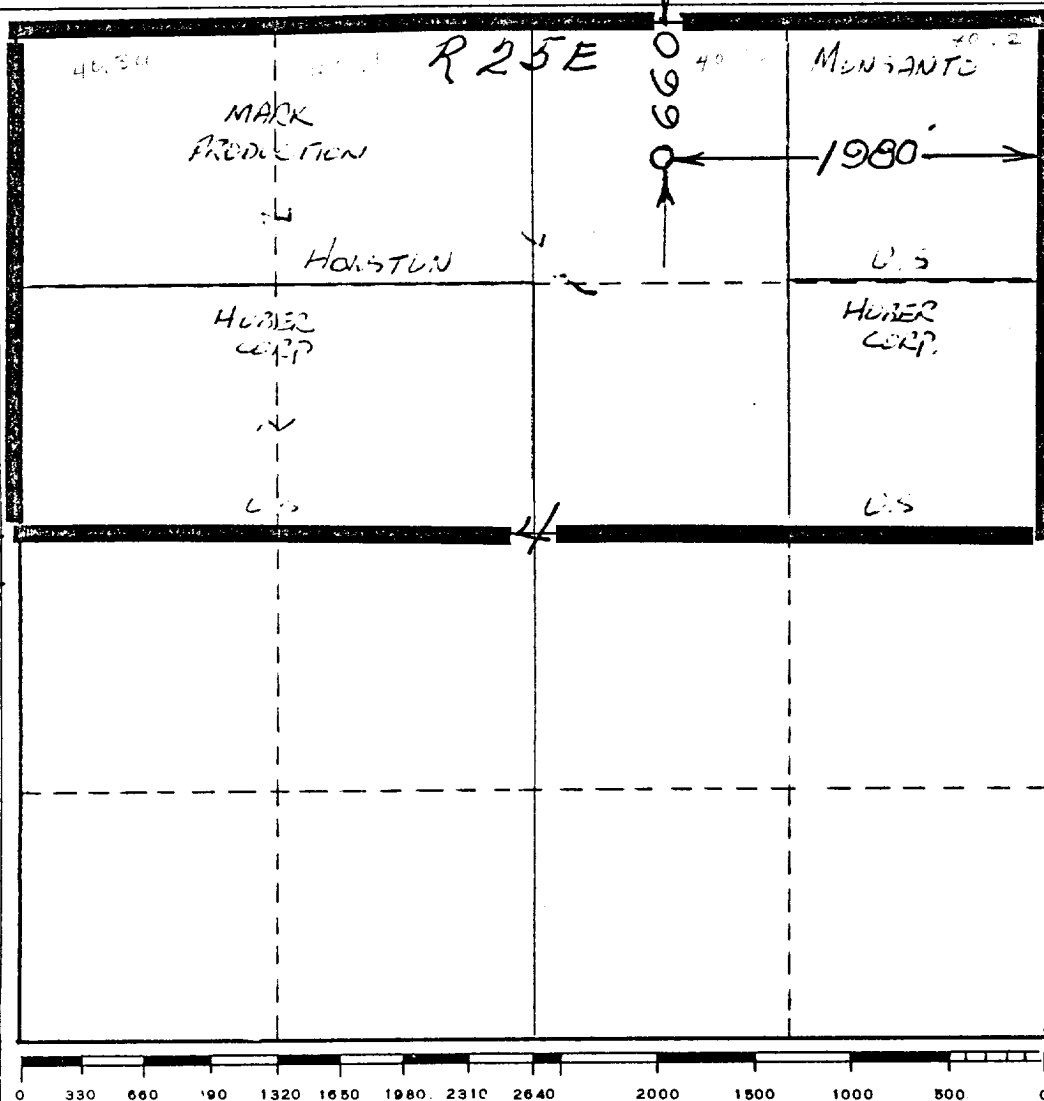

CERTIFICATION

I hereby certify that the information contained herein is true and complete to the best of my knowledge and belief.

Name
Gaylon Thompson

Position
Assistant Secretary

Company
Mark Production Company

Date
March 19, 1974

I hereby certify that the well location shown on this plat was plotted from field notes of actual surveys made by me or under my supervision, and that the same is true and correct to the best of my knowledge and belief.

Date Surveyed
March 9, 1974

Registered Professional Engineer and/or Land Surveyor

James H. Brown
Certificate No. **542**

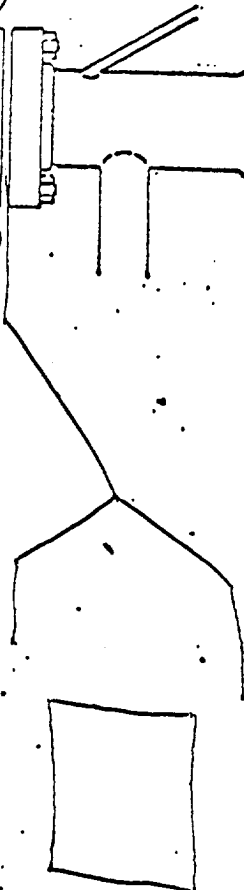

10" 900 SERIES Hyd. 1

Shafter Model 139

3000 # Hyd. BOP

2" check 2" 600

4" 600 SERIES

Spool

3000 # Choke Manifold

Adjustable chokes

2" 600 SERIES

2" 600 SERIES

positive chokes

