

NO. OF COPIES RECEIVED	5
DISTRIBUTION	
SANTA FE	1
FILE	2
U.S.G.S.	2
LAND OFFICE	
OPERATOR	1

NEW MEXICO OIL CONSERVATION COMMISSION
RECEIVED

MAY 13 1974

O. C. C.

30-015-21212
Form C-101
Revised 1-4-65

5A. Indicate Type of Lease
STATE ☐ FEE ☒

5. State Oil & Gas Lease No.

APPLICATION FOR PERMIT TO DRILL, DEEPEN, OR PLUG BACK

1a. Type of Work		7. Unit Agreement Name	
b. Type of Well DRILL <input checked="" type="checkbox"/> DEEPEN <input type="checkbox"/> PLUG BACK <input type="checkbox"/> OIL WELL <input type="checkbox"/> GAS WELL <input checked="" type="checkbox"/> OTHER <input type="checkbox"/> SINGLE ZONE <input checked="" type="checkbox"/> MULTIPLE ZONE <input type="checkbox"/>		8. Farm or Lease Name New Mexico Osage	
2. Name of Operator Mark Production Company		9. Well No. 1	
3. Address of Operator 330 Citizens Bank Bldg., Tyler, Texas 75701		10. Field and Pool, or Willcat Cemetery (Morrow)	
4. Location of Well UNIT LETTER 0 LOCATED 1980 FEET FROM THE East LINE AND 660 FEET FROM THE South LINE OF SEC. 5 TWP. 20S RGE. 25E NMPM		12. County Eddy	
19. Proposed Depth 10,000'		19A. Formation Morrow	
20. Rotary or C.T. Rotary		21. Elevations (Show whether DF, RT, etc.) 3498.6'	
21A. Kind & Status Plug. Bond \$10,000 Blanket		21B. Drilling Contractor Cactus Drilling Co.	
22. Approx. Date Work will start May 14, 1974			

PROPOSED CASING AND CEMENT PROGRAM

SIZE OF HOLE	SIZE OF CASING	WEIGHT PER FOOT	SETTING DEPTH	SACKS OF CEMENT	EST. TOP
17-1/2"	12-3/4"	32#	300	350	Circulated
11"	8-5/8"	32#	1,250	375	Circulated
7-7/8"	4-1/2"	10.5# & 11.6#	10,000	375	

10" 900 Series Hydril

Shaffer Model 39 - 3000# Hydraulic Blowout Preventers (see attached plat showing choke manifold and equipment)

Pit Volume totalizer

Flowline Sensor

Pumpstroke Counter

APPROVAL VALID
FOR 90 DAYS UNLESS
DRILLING COMMENCED,

EXPIRES 8-13-74

IN ABOVE SPACE DESCRIBE PROPOSED PROGRAM: IF PROPOSAL IS TO DEEPEN OR PLUG BACK, GIVE DATA ON PRESENT PRODUCTIVE ZONE AND PROPOSED NEW PRODUCTIVE ZONE. GIVE BLOWOUT PREVENTER PROGRAM, IF ANY.

I hereby certify that the information above is true and complete to the best of my knowledge and belief.

Signed Dayton Thompson Title Assistant Secretary Date 5-9-74

(This space for State Use)

APPROVED BY W. A. Lussert TITLE OIL AND GAS INSPECTOR

CONDITIONS OF APPROVAL, IF ANY:

Cement must be circulated to

surface behind 12 3/4" + 8 5/8" casing

MAY 13 1974
Notify M.M.O.C.C. in sufficient
time to witness cementing

8 5/8"

MEXICO OIL CONSERVATION COMMISSION
WELL LOCATION AND ACREAGE DEDICATION PLAT

Form C-102
 Supersedes C-128
 Effective 1-4-65

All distances must be from the outer boundaries of the Section.

MARK PRODUCTION CO. & M-G-F			Lease NEW MEXICO OSAGE		Well No. 1
Section "0"	Range 5	Township 20 South	Range 25 East	County Eddy	
Section 660 Section to the South line and 1980 feet from the East line Section 3498.6 Producing Formation Morrow Pool Cemetery (Morrow) Dedicated Acreage: 320 Acres					

1. Outline the acreage dedicated to the subject well by colored pencil or hatchure marks on the plat below.
2. If more than one lease is dedicated to the well, outline each and identify the ownership thereof (both as to working interest and royalty).
3. If more than one lease of different ownership is dedicated to the well, have the interests of all owners been consolidated by communitization, unitization, force-pooling, etc?

X Yes No If answer is "yes," type of consolidation _____

If answer is "yes," list the owners and tract descriptions which have actually been consolidated. (Use reverse side of this form if necessary) _____

_____ acreable will be assigned to the well until all interests have been consolidated (by communitization, unitization, force-pooling, or otherwise) or until a non-standard unit, eliminating such interests, has been approved by the Commission.

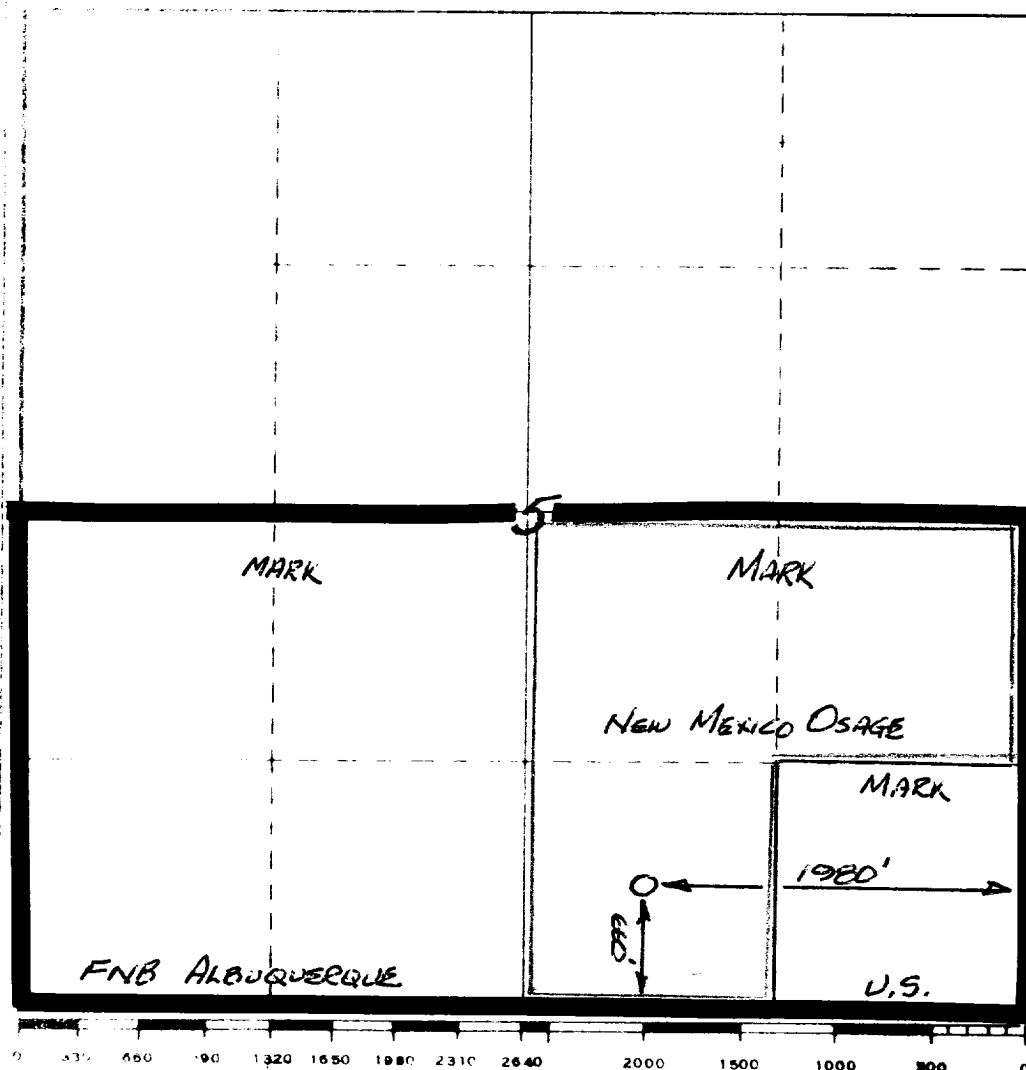

CERTIFICATION

I hereby certify that the information contained herein is true and complete to the best of my knowledge and belief.

Gaylon Thompson
 Name
 Gaylon Thompson

Position
 Assistant Secretary

Company
 Mark Production Company

Date
 May 9, 1974

I hereby certify that the well location shown on this plat was plotted from field notes of actual surveys made by me or under my supervision, and that the same is true and correct to the best of my knowledge and belief.

Date Surveyed
 May 5, 1974

Registered Professional Engineer and/or Land Surveyor

Herschel L. Jones
 Certificate No. _____

 STATE OF NEW MEXICO
 HERSCHEL L. JONES
 3640
 REGISTERED LAND SURVEYOR

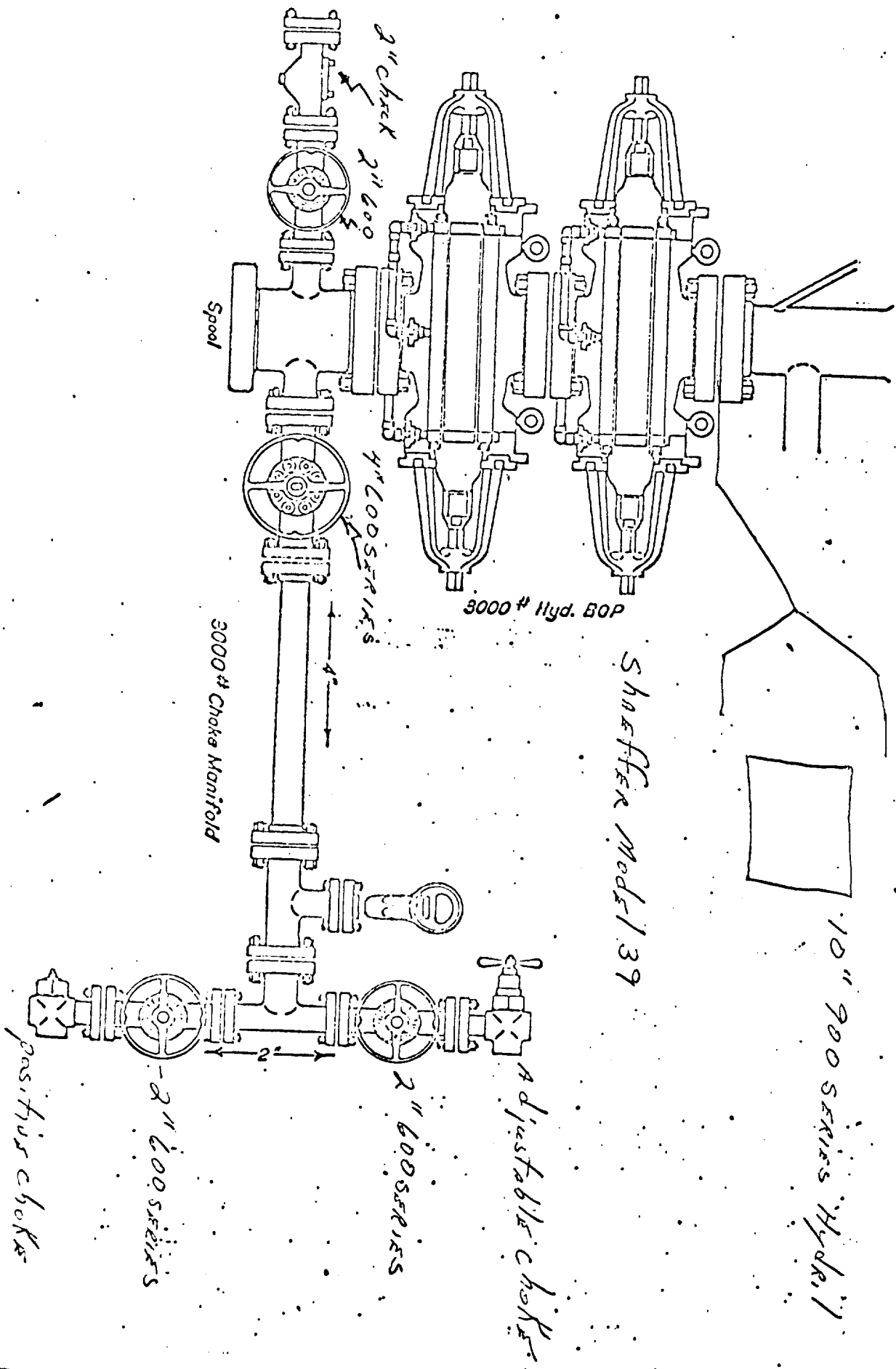

Shaffer Model 139

10" 900 series Hydr.

Adjustable Chokes

2" 600 series

2" 600 series

positive chokes

3000 # Hyd. BOP

4" 600 series

2" Choke

2" 600

3000 # Choke Manifold

Spool