

Form 9-311C
(12-1-73)SUBMIT IN TRIPLICATE*
(Other instructions on
reverse side)Form approved
Bureau Order No. 42 51125.UNITED STATES
DEPARTMENT OF THE INTERIOR
GEOLOGICAL SURVEY

APPLICATION FOR PERMIT TO DRILL, DEEPEN, OR PLUG BACK

1. TYPE OF WORK

DRILL ☒DEEPEN ☐PLUG BACK ☐

2. TYPE OF WELL

OIL WELL ☒GAS WELL ☐OTHER ☐SINGLE ZONE ☒MULTIPLE ZONE ☐

3. NAME OF OPERATOR

Hanagan Petroleum Corporation

4. ADDRESS OF OPERATOR

P. O. Box 1737, Roswell, New Mexico 88201

5. LOCATION OF WELL (Report location clearly and in accordance with any State requirements)

At surface

650' ENL & 1920' FEL

At proposed prod. zone

Same

14. DISTANCE IN MILES AND DIRECTION FROM NEAREST TOWN OR POST OFFICE*

Approx. 10 miles southeast of Artesia

15. DISTANCE FROM PROPOSED*

LOCATION TO NEAREST

PROPERTY OR LEASE LINE, FT.

(Also to nearest dfg. unit line, if any)

650'

18. DISTANCE FROM PROPOSED LOCATION*

TO NEAREST WELL, DRILLING, COMPLETED,

OR APPLIED FOR, ON THIS LEASE, FT.

Approx. 3200'

21. ELEVATIONS (Show whether DF, RT, GR, etc.)

3325' GR

16. NO. OF ACRES IN LEASE

875.53

17. NO. OF ACRES ASSIGNED

TO THIS WELL

40

19. PROPOSED DEPTH

1100' Queen

20. ROTARY OR CABLE TOOLS

Cable Tool

22. APPROX. DATE WORK WILL START*

8/25/74

23.

PROPOSED CASING AND CEMENTING PROGRAM

SIZE OF HOLE	SIZE OF CASING	WEIGHT PER FOOT	SETTING DEPTH	QUANTITY OF CEMENT
15 1/2"	12-3/4"	30	275	Mudded-In (Set)
10 & 8"	4 1/2"	9.5	1100	Circ.

Plan drill w/cable tools (Clyde Tidwell), start out w/15 1/2" hole to 250', run & mud-in 12-3/4" csg. if water is encountered, reduce hole to 10" to approx. 500', reduce from there to total depth to 8". Plan to pull 12-3/4" csg. if well is dry. Any water zone will be protected either by csg. or cementing across water zone if dry hole.

RECEIVED
AUG - 7 1974
U. S. GEOLOGICAL SURVEY
ARTESIA, NEW MEXICO

IN ABOVE SPACE DESCRIBE PROPOSED PROGRAM: If proposal is to deepen or plug back, give data on present productive zone and proposed new productive zone. If proposal is to drill or deepen directionally, give pertinent data on subsurface locations and measured and true vertical depths. Give blowout preventer program, if any.

24.

SIGNED

Hugh C. Hanagan
(This space for Federal or State office use)

TITLE

Vice President

DATE

8/5/74

PERMIT NO. **APPROVED**
APPROVED BY **FILE 151274**
CONTINUED ON APPLICATION IF ANY:
H. E. BECKWITH
ACTING DISTRICT ENGINEER

APPROVATIONS
THIS APPROVAL IS EXTENDED IF OPERATIONS
ARE NOT COMMENCED WITHIN 3 MONTHS.
EXPIRES **NOV 15 1974**
*See Instructions On Reverse Side

NEW MEXICO OIL CONSERVATION COMMISSION
WELL LOCATION AND ACREAGE DEDICATION PLAT

Form C-100
Supersedes C-123
Effective 1-1-65

All distances must be from the outer boundaries of the Section

Owner Hanagan Petroleum Corporation			Location Pecos River		Well No. 2
Section 8	Range 4	Township 19 South	Range 27 East	County Eddy	
Well Location (feet from the North line and East line) 660 1980					
Underlying Formation Queen		Pool Wildcat		Dedicated Acreage 40 Acres	

- Outline the acreage dedicated to the subject well by colored pencil or hatchure marks on the plat below.
- If more than one lease is dedicated to the well, outline each and identify the ownership thereof (both as to working interest and royalty).
- If more than one lease of different ownership is dedicated to the well, have the interests of all owners been consolidated by communitization, unitization, force-pooling, etc?

☐ Yes ☐ No If answer is "yes" type of consolidation _____

If answer is "no," list the owners and tract descriptions which have actually been consolidated. (Use reverse side of this form if necessary.) _____

No allowable will be assigned to the well until all interests have been consolidated (by communitization, unitization, forced-pooling, or otherwise) or until a non-standard unit, eliminating such interests, has been approved by the Commission.

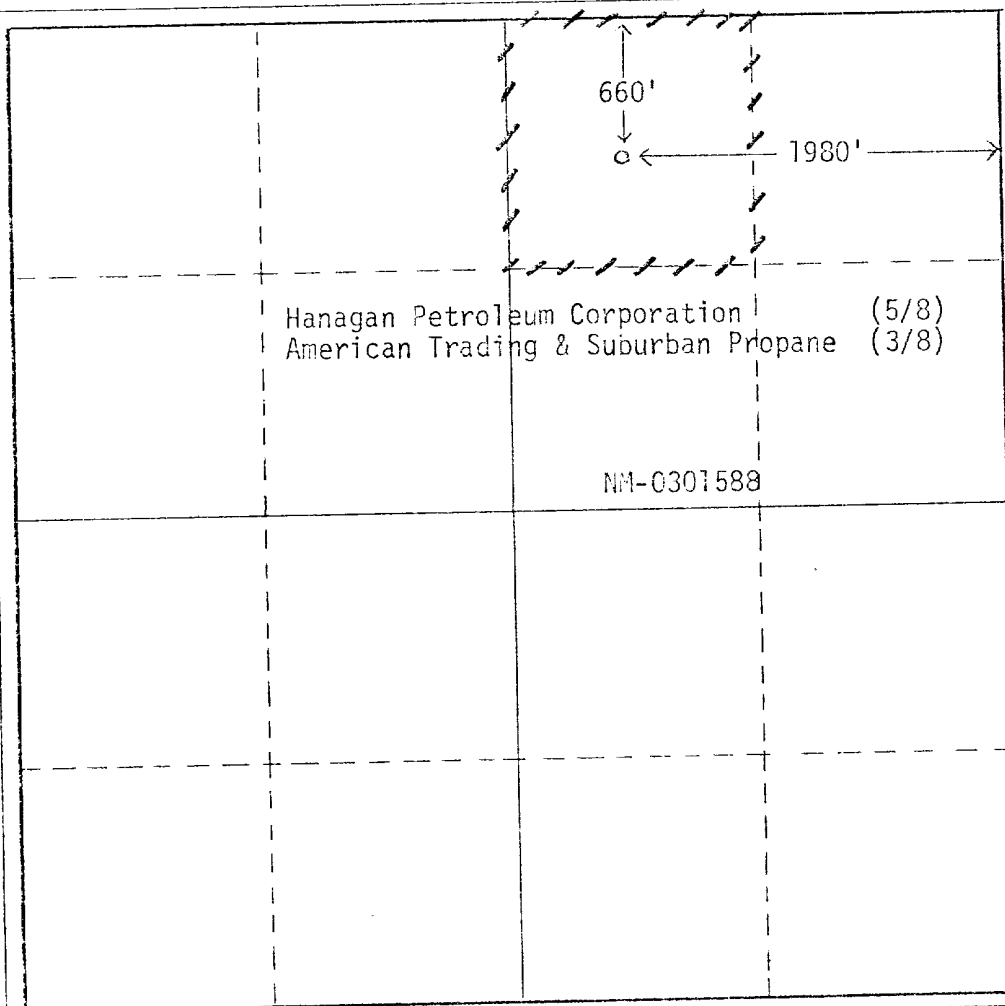

CERTIFICATION

I hereby certify that the information contained herein is true and complete to the best of my knowledge and belief.

Hugh E. Hanagan
Name

Hugh E. Hanagan

Position

Vice President

Company

Hanagan Petroleum Corporation

Date

8/5/74

I hereby certify that the well location shown on this plat was plotted from field notes of actual surveys made by me or under my supervision, and that the same is true and correct to the best of my knowledge and belief.

Aug 2, 1974
Date Surveyed

[Signature]
Registered Professional Engineer and/or Land Surveyor

11-11-220
Certificate No.

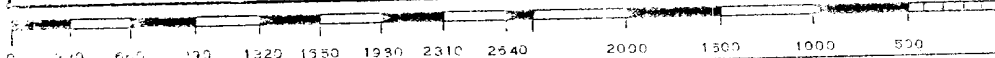

MANAGAN PETROLEUM CONTAMINATION NO. 2 REDDS RIVER

DEVELOPMENT PLAN FOR SURFACE USE

1. Existing Roads - See attached Figure 1.
2. Planned Access Road - See Figures 1 & 2, no new road necessary, only about 100' north of existing road.
3. Location of Tank Battery & Flow Lines - In case of production, run flow line approx. 100' due east to heater/creter, then due south approx. 50' to tank battery.
4. Water Supply - Will haul water.
5. Method Handling Waste - Dispose in small pit 1 blade wide, 4 or 5 feet long, and 3 feet deep located @ end of reserve pit.
6. Location of Camp - None.
7. Location of Airstrip - None.
8. Location of Layout - See Figure 2, no pad will be made, again just the mesquite bushes pushed away and a reserve pit about 40' long and two blades wide (approx. 10' to 12') will be dug along with a small waste pit.
9. Topography, Vegetation, Etc. - Flat area with some local sink holes (none on location) covered with some range grass and scattered mesquite bushes.
10. Plans Restoration of Surface - Fill in and level pit, clean up area.
11. Company Representative Responsible for Compliance to Development Plan - Hugh E. Managan, Roswell, New Mexico, phone 623-6053.

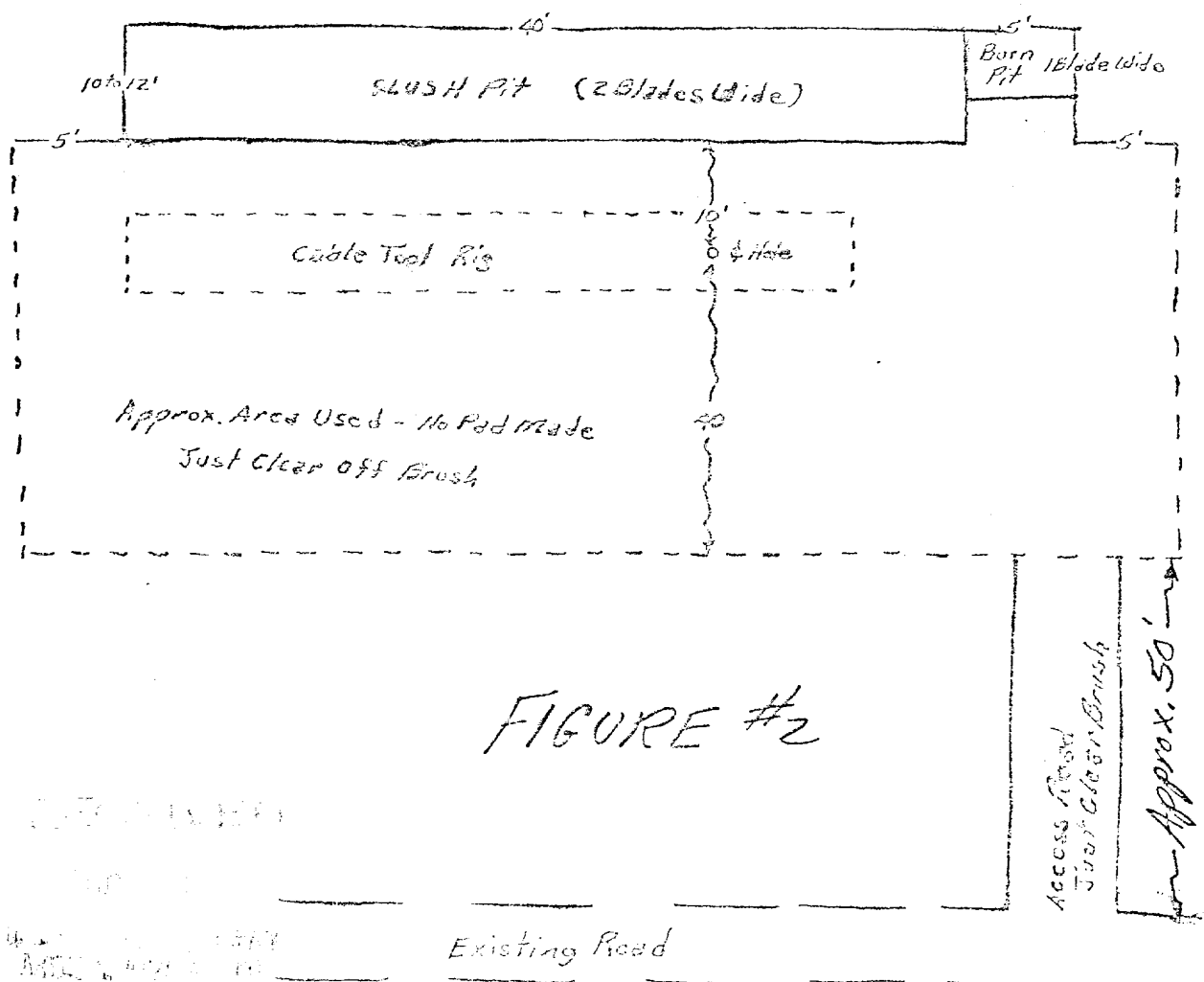

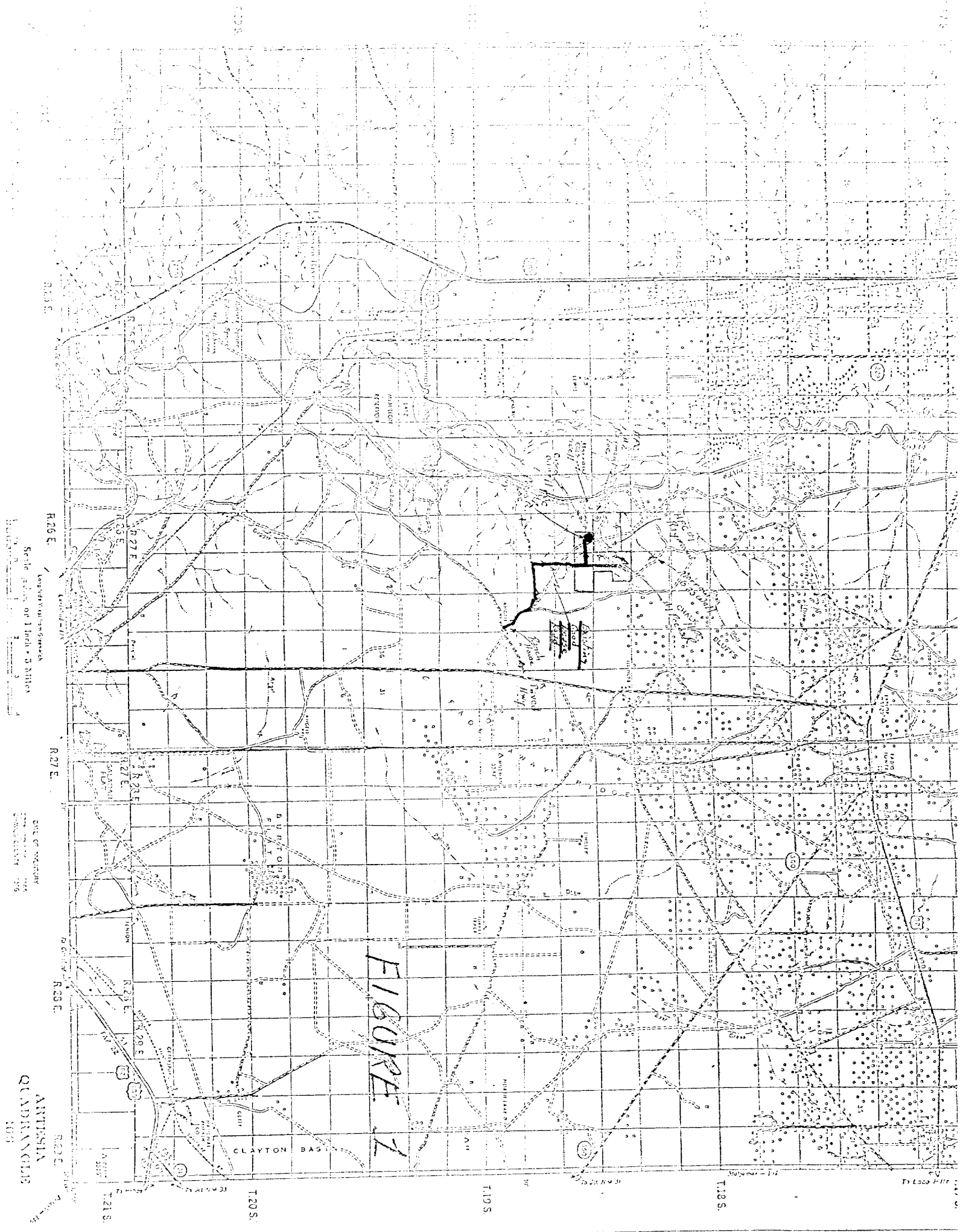

RECEIVED

AUG - 7 1974

U. S. GEOLOGICAL SURVEY
ARTESIA, NEW MEXICO