

NEW MEXICO OIL CONSERVATION ACT
WELL LOCATION AND ACREAGE DEDICATION PLAT

Supersedes C-128
Effective 1-1-65

All distances must be from the outer boundaries of the Section.

Operator R. C. Bennett & J. C. Ryan			Lease EXXON STATE		Well No. 1
Unit Letter N	Section 25	Township 19 S	Range 28 E	County Eddy	
Actual Footage Location of Well: 1930 feet from the West line and 660 feet from the South line					
Ground Level Elev. 3320	Producing Formation Morrow		Pool Winchester Morrow-Undesignated		Dedicated Acreage: S/2 320 Acres

1. Outline the acreage dedicated to the subject well by colored pencil or hachure marks on the plat below.
2. If more than one lease is dedicated to the well, outline each and identify the ownership thereof (both as to working interest and royalty).
3. If more than one lease of different ownership is dedicated to the well, have the interests of all owners been consolidated by communitization, unitization, force-pooling, etc?

☐ Yes ☐ No If answer is "yes," type of consolidation _____

If answer is "no," list the owners and tract descriptions which have actually been consolidated. (Use reverse side of this form if necessary.) _____

No allowable will be assigned to the well until all interests have been consolidated (by communitization, unitization, forced-pooling, or otherwise) or until a non-standard unit, eliminating such interests, has been approved by the Commission.

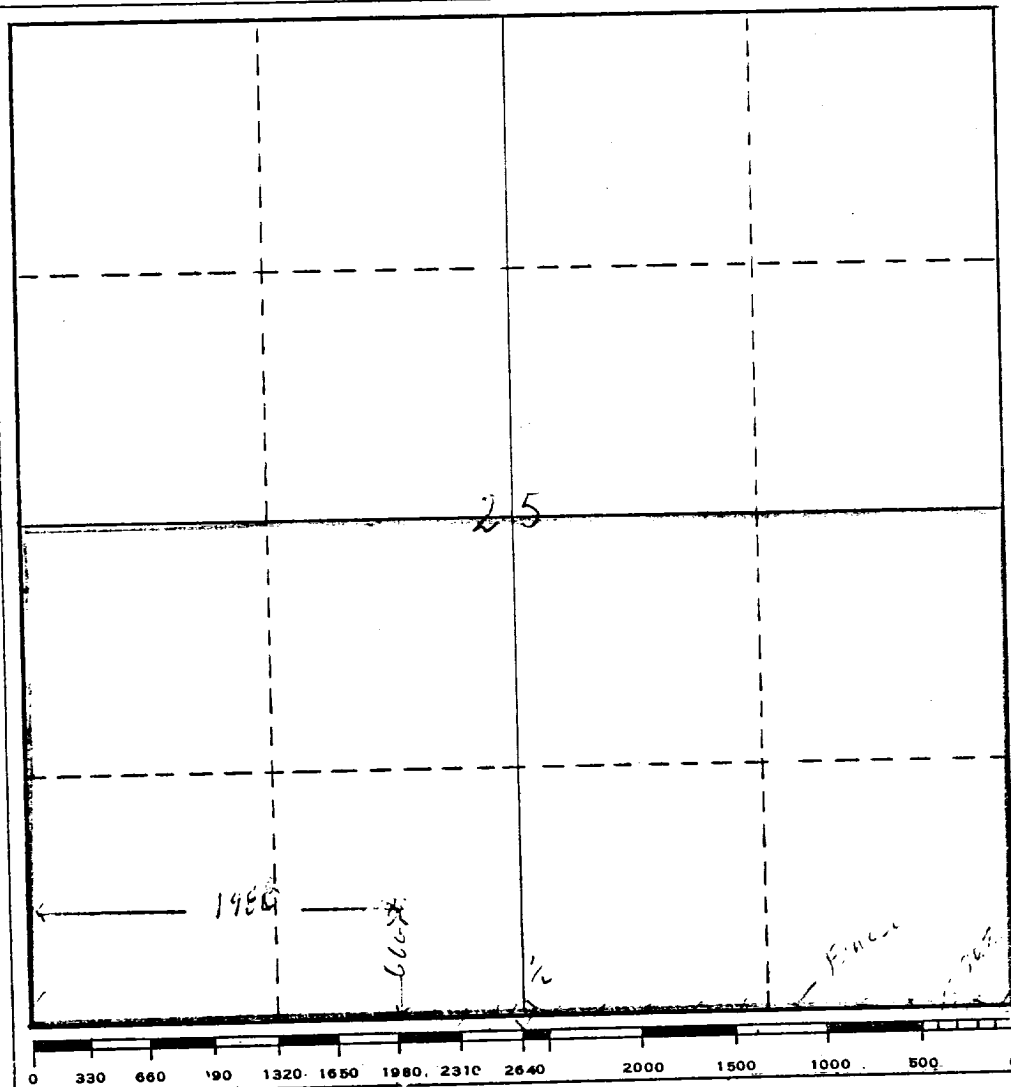

CERTIFICATION

I hereby certify that the information contained herein is true and complete to the best of my knowledge and belief.

Name
R. C. Bennett
Position
Joint Operator
Company
R. C. Bennett & J. C. Ryan
Date
July 3, 1975

I hereby certify that the well location shown on this plat was plotted from field notes of actual surveys made by me or under my supervision, and that the same is true and correct to the best of my knowledge and belief.

Date Surveyed
July 22, 1975
Registered Professional Engineer and/or Land Surveyor
H. K. 220
Certificate No.