

UNITED STATES
DEPARTMENT OF THE INTERIOR
GEOLOGICAL SURVEYCopy to S.F.
30-015-21696

APPLICATION FOR PERMIT TO DRILL, DEEPEN, OR PLUG BACK

1a. TYPE OF WORK

DRILL ☒DEEPEN ☐PLUG BACK ☐

b. TYPE OF WELL

OIL
WELL ☒GAS
WELL ☐

OTHER

SINGLE
ZONE ☒MULTIPLE
ZONE ☐

2. NAME OF OPERATOR

Harensuckle Exploration Corporation ✓

3. ADDRESS OF OPERATOR

450 Petroleum Club Building, Denver, Colorado 80202

4. LOCATION OF WELL (Report location clearly and in accordance with any State requirements.)*

At surface.

220' from South Line & 1980' from East Line

At proposed prod. zone

Queen - Grayburg

14. DISTANCE IN MILES AND DIRECTION FROM NEAREST TOWN OR POST OFFICE*

12 miles SE of Loco Hills

15. DISTANCE FROM PROPOSED*

LOCATION TO NEAREST
PROPERTY OR LEASE LINE, FT.
(Also to nearest drig. unit line, if any)

330'

16. NO. OF ACRES IN LEASE

320

17. NO. OF ACRES ASSIGNED
TO THIS WELL

10

18. DISTANCE FROM PROPOSED LOCATION*

TO NEAREST WELL, DRILLING, COMPLETED,
OR APPLIED FOR, ON THIS LEASE, FT.

1450'

19. PROPOSED DEPTH

1200

20. ROTARY OR CABLE TOOLS

Rotary

21. ELEVATIONS (Show whether DF, RT, GR, etc.)

3453' GR

22. APPROX. DATE WORK WILL START*

On Approval

23.

PROPOSED CASING AND CEMENTING PROGRAM

SIZE OF HOLE	SIZE OF CASING	WEIGHT PER FOOT	SETTING DEPTH	QUANTITY OF CEMENT
12-1/1"	9-5/8"	23	800	300
7-7/8"	1-1/2"	10.5	1200	400

A 10" 900 Series Model E Schaffer Double Gate Flow-out Preventor
3000# WP and 4000# Test

RECEIVED

DEC 9 1975

O. C. C.
ARTESIA, OFFICE

RECEIVED

NOV 14 1975

U. S. GEOLOGICAL SURVEY
ARTESIA, NEW MEXICO

IN ABOVE SPACE DESCRIBE PROPOSED PROGRAM: If proposal is to deepen or plug back, give data on present productive zone and proposed new productive zone. If proposal is to drill or deepen directionally, give pertinent data on subsurface locations and measured and true vertical depths. Give blowout preventer program, if any.

24.

SIGNED

John Yurontka

TITLE

Authorized Agent

DATE

11-10-75

(This space for Federal or State office use)

PERMIT NO.

APPROVAL DATE

APPROVED BY

CONDITIONS OF APPROVAL, IF ANY:

TITLE

THIS APPROVAL IS RECORDED IF OPERATIONS
ARE NOT COMMENCED WITHIN 3 MONTHS.
EXPIRES MAR 8 - 1976
See Instructions On Reverse Side

DATE

APPROVED
DEC 8 - 1975
A. L. BEEKMAN
ACTING DISTRICT ENGINEER

MEXICO OIL CONSERVATION COMMISS.
WELL LOCATION AND ACREAGE DEDICATION PLAT

Form C-102
Supersedes C-128
Effective 1-1-65

All distances must be from the outer boundaries of the Section

Operator Honeysuckle Exploration Corporation			Lease Federal 26		Well No. 1
Tract Letter O	Section 26	Township 18 South	Range 31 East	County Eddy	
Actual Surface Location of Well: 330 feet from the South line and 1980 feet from the East line					
Ground Level Elev 3653.4	Producing Formation Queen - Grayburg		Pool Shugart	Estimated Acreage 40	

1. Outline the acreage dedicated to the subject well by colored pencil or hatchure marks on the plat below.
2. If more than one lease is dedicated to the well, outline each and identify the ownership thereof (both as to working interest and royalty).
3. If more than one lease of different ownership is dedicated to the well, have the interests of all owners been consolidated by communitization, unitization, force-pooling, etc?

☐ Yes ☐ No If answer is "yes," type of consolidation _____

If answer is "no," list the owners and tract descriptions which have actually been consolidated (use reverse side of this form if necessary.) _____

No allowable will be assigned to the well until all interests have been consolidated (by communitization, unitization, forced-pooling, or otherwise) or until a non-standard unit, eliminating such interests, has been approved by the Commission.

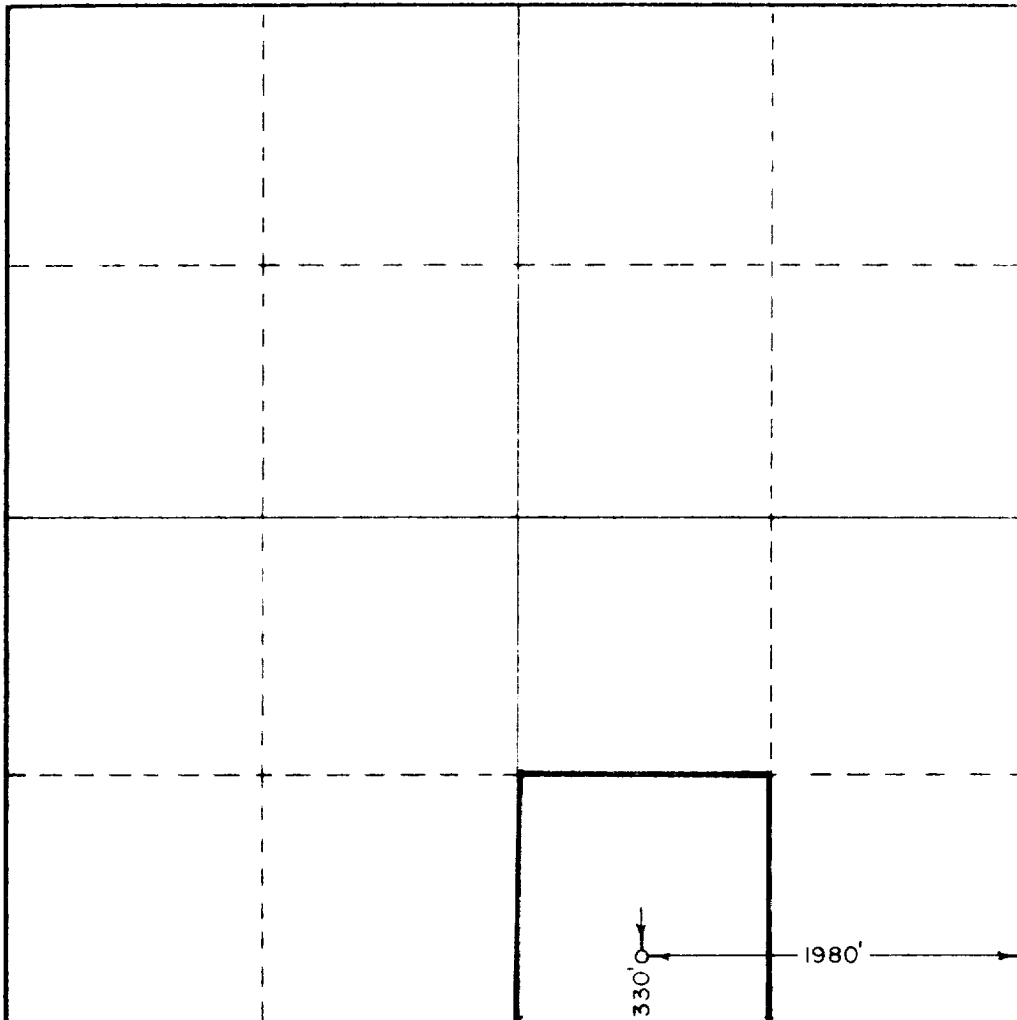

CERTIFICATION

I hereby certify that the information contained herein is true and complete to the best of my knowledge and belief.

Name John Yurouka
Position _____

Authorized Agent

Company
Honeysuckle Exploration Corp.

Date
November 10, 1975

I hereby certify that the well location shown on this plat was plotted from field notes of actual surveys made by me or under my supervision, and that the same is true and correct to the best of my knowledge and belief.

Date Signed **November 3, 1975**
Registered Professional Engineer and Land Surveyor
676

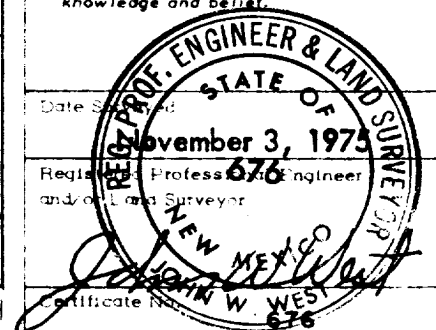

Certificate No. _____

0 330 660 990 1320 1650 1980 2310 2640 2000 1500 1000 500 0

SURFACE USE PLAN

HONEYSUCKLE EXPL. CORP., FEDERAL 26 #1
330' FSL & 1980' FEL of Sec. 26, T18S, R31E
Lease L0029392B, Eddy County, N. M.

This plan is to accompany "Application for Permit to Drill" the subject well which is located approximately 13 miles southeast of Loco Hills, New Mexico. The following is a discussion of pertinent information concerning possible effect which the proposed drilling of the well may have on the environment of the well and road sites and surrounding acreage. A copy will be posted on the derrick floor so that all contractors and subcontractors will be aware of all items of this plan.

1. AREAL ROAD MAP - Exhibit "A" is a portion of a USGS topographic map, Eddy County, New Mexico, showing existing black top roads. Approximately 7 miles south of the intersection of U. S. Highway 82 and N. M. State Highway 31, a lease road colored red on Exhibit "A" goes east to a point approximately 330 feet south of the proposed well site.
2. LOCATION OF EXISTING WELLS - Several shallow wells have been drilled within a two-mile radius and are shown on Exhibit "B" with the proposed location and access road.
3. PROPOSED WELL MAT AND IMMEDIATE AREA - Refer to Exhibit "C" for direction orientation and road access.
 - a. MAT SIZE - 180' X 110"
 - b. SURFACED - Will be topped with 6" of caliche, bladed, watered and compacted. Caliche to be purchased from BLM by dirt contractor.
 - c. RESERVE PIT - 90' X 60' pit lined with plastic, joining mat to the north.
 - d. CUT & FILL - Location is nearly level, only general leveling will be required.
 - e. DRILL SITE LAYOUT - Exhibit "C" shows position of mat, reserve pits, burn pits, trash pits, and mud pits in relation to the well bore. Rig will be erected with the V-Door to the east.
 - f. SETTING AND ENVIRONMENT -
 - (1) TERRAIN - Low rolling sand hills. See Exhibit "A", topographic map of area.
 - (2) SOIL - Sandy soil.
 - (3) VEGETATION - Sparse vegetation, being mostly grease wood, shinnery and other semi-desert plants with sparse grass and small weeds.
 - (4) SURFACE USE - Grazing.

- (5) OTHER - Drill site, which is in nearly flat semi-arid desert country, is in a low environmental risk area. The total effect of drilling and producing this and other wells in this area would be minimal.

f. DISTANCES TO:

- (1) PONDS AND STREAMS - There are no surface waters within 1/2 mile.
- (2) WATER WELLS - No water well or windmill could be seen within 1/2 mile.
- (3) RESIDENCES AND BUILDINGS - There are no houses or buildings within 1/2 mile.
- (4) ARROYOS, CANYONS, ETC. - Outside of low rolling sand hills, there are no surface features within 1/2 mile. See Exhibit "A".

h. WELL SIGN - Sign identifying and locating well will be maintained at drill site with the spudding of the well.

i. OPEN PITS - All pits containing mud or other liquids will be fenced or guarded.

1. ROADS

a. EXISTING ROADS - All existing roads within three miles of the south are shown on Exhibit "A".

b. PLANNED ROADS - Plan to construct 330' of new 12 foot wide road, to be topped with caliche. New road can not be shown on Exhibit "B" but it will come due north from an existing caliche road into the well mat as shown on Exhibit "C".

c. FENCES, GATES AND CATTLEGUARDS - None.

5. TANK BATTERY - If production is encountered, battery will be located on a northwest extension of the well mat as shown on Exhibit "C".

6. LEASE PIPELINES

a. EXISTING - None.

b. PLANNED - If production is encountered, all lease lines are to be constructed on well mat.

7. WASTE DISPOSAL - Well cuttings will be disposed in reserve pit. Barrel trash containers to be in accessible locations within drill site area during drilling and completion procedures. All detrimental waste will be hauled away, burned or buried with a minimum cover of 24" of dirt. See Exhibit "C" for location of pits. If well is productive, maintenance waste will be placed in special trash cans and hauled away periodically. Any produced water will be collected in tanks until hauled to an approved disposal system, or separate disposal application will be submitted to the Survey for appropriate approval.

8. WATER SUPPLY - Supply water will be hauled.

9. ARCHAEOLOGICAL RESOURCES - None Observed
10. RESTORATION OF SURFACE - If well is productive, pits will be backfilled and leveled as soon as practical to original condition.
11. OPERATOR'S REPRESENTATIVE - Field personnel who can be contacted concerning compliance of this Surface Use Plan are as follows:

Production & Drilling

John Yuronka
120-C Central Building
Midland, Texas 79701
Office Phone: 915-684-6223
Home Phone: 915-683-4579

12. CERTIFICATION

I hereby certify that I, or persons under my direct supervision, have inspected the proposed drill site and access route; that I am familiar with the conditions as they actually exist; that the statements made in this plan are, to the best of my knowledge, true and correct; and that the proposed work performed by Honeysuckle Exploration Corporation and its contractors and sub-contractors will conform to this plan.

November 13, 1975
Date

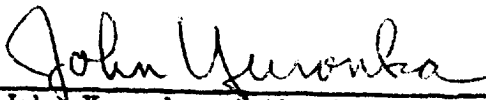

John Yuronka, Authorized Agent



SURFACE USE PLAN - Exhibit "B"
Honeysuckle Exml. Corn. - Federal 26 #1
330/S 1980/E Sec. 26-18S-31E

MGF Drilling Company - Rig No. 22

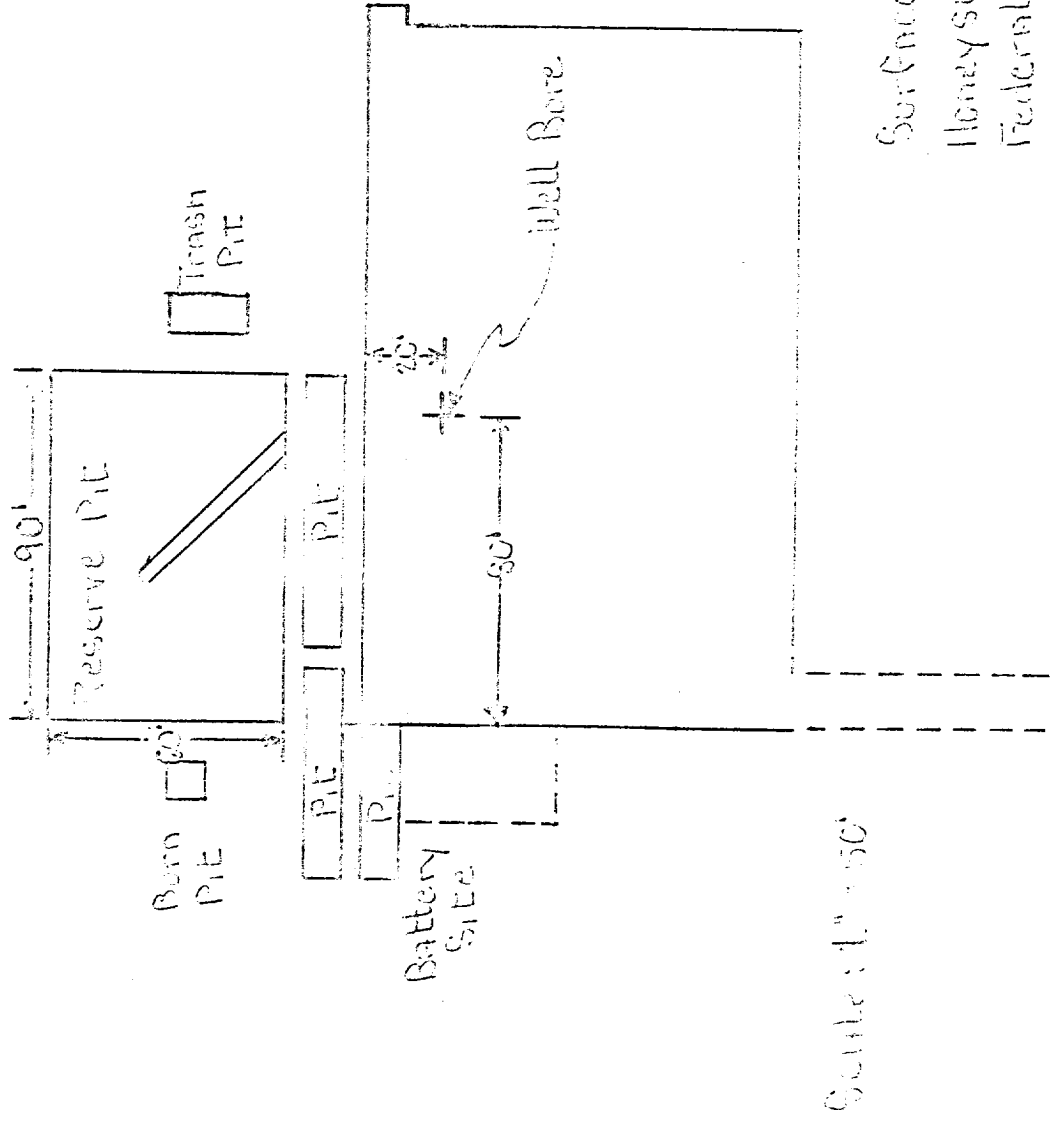
N



Source: Use Plan: Exhibit "C"
 Honeyuckle Expt. Corp.
 Federal ZG Well No. 1
 330 FSL - 1990' FHL
 Sec. ZG, 1986, 1231E