

UNITED STATES
DEPARTMENT OF THE INTERIOR
GEOLOGICAL SURVEYSUBMIT IN TRIPLE
(Other Instructions
reverse side)Form approved
Budget Bureau No. 42-R1424.

5. LEASE DESIGNATION AND SERIAL NO.

NM 0559774

6. IF INDIAN, ALLOTTEE OR TRIBE NAME

SUNDRY NOTICES AND REPORTS ON WELLS

(Do not use this form for proposals to drill or to deepen or plug back to a different reservoir.
Use "APPLICATION FOR PERMIT—" for such proposals.)

1. OIL WELL <input type="checkbox"/> GAS WELL <input checked="" type="checkbox"/> OTHER <input type="checkbox"/>		MAY 6 1976	
2. NAME OF OPERATOR Yates Petroleum Corporation ✓		O. C. C.	
3. ADDRESS OF OPERATOR 207 South 4th Street - Artesia, NM 88210		ARTESIA, OFFICE	
4. LOCATION OF WELL (Report location clearly and in accordance with any State requirements.* See also space 17 below.) At surface 1980' FNL & 1980' FWL of Sec. 28-19S-24E		7. UNIT AGREEMENT NAME	
14. PERMIT NO.		15. ELEVATIONS (Show whether DF, RT, GR, etc.) 3731' GR	
16. Check Appropriate Box To Indicate Nature of Notice, Report, or Other Data		8. FARM OR LEASE NAME CC Tank Unit	
NOTICE OF INTENTION TO:		9. WELL NO. 1	
SUBSEQUENT REPORT OF:		10. FIELD AND POOL, OR WILDCAT Wildcat	
TEST WATER SHUT-OFF <input type="checkbox"/>		11. SEC., T., R., M., OR BLK. AND SURVEY OR AREA Sec. 28-19S-24E Unit F NMPM	
FRACTURE TREAT <input type="checkbox"/>		12. COUNTY OR PARISH Eddy	
SHOOT OR ACIDIZE <input type="checkbox"/>		13. STATE NM	
REPAIR WELL <input type="checkbox"/>			
(Other) <input type="checkbox"/>			

16. Check Appropriate Box To Indicate Nature of Notice, Report, or Other Data	
NOTICE OF INTENTION TO:	SUBSEQUENT REPORT OF:
TEST WATER SHUT-OFF <input type="checkbox"/>	TEST WATER SHUT-OFF <input checked="" type="checkbox"/>
FRACTURE TREAT <input type="checkbox"/>	FRACTURE TREATMENT <input type="checkbox"/>
SHOOT OR ACIDIZE <input type="checkbox"/>	SHOOTING OR ACIDIZING <input type="checkbox"/>
REPAIR WELL <input type="checkbox"/>	(Other) Spud <input checked="" type="checkbox"/>
(Other) <input type="checkbox"/>	(NOTE: Report results of multiple completion on Well Completion or Recompletion Report and Log form.)

17. DESCRIBE PROPOSED OR COMPLETED OPERATIONS (Clearly state all pertinent data and give pertinent dates, including estimated date of starting any proposed work. If well is directionally drilled, give subsurface locations and measured and true vertical depths for all markers and zones pertinent to this work.) *

Spudded a 17½" hole at 12 noon 4-26-76.

TD 208' - Ran 5 joints of 13-3/8" 48# H-40 (208.75') of casing, set at 208' and cemented by Halliburton w/125 sacks of Class "C" 4% CaCl. PD 8:45 PM 4-26-76. Cement did not circulate. WOC 4 hours and dumped 7 yards of Ready-mix and filled hole to surface. WOC 12 hours, backed off casing, nipples up, reduced hole to 12¼" and drilled plug, resumed drilling.

TD 947' - Ran 23 joints of 8-5/8" 24# K-55 ST&C (955.88') of casing set at 947'. 1-Texas Pattern shoe, centralizers at 905 & 291', baskets at 239 and 323'. Cemented by Halliburton w/200 sacks of "Thick Set" and followed w/175 sacks of Lite w/5# gilsonite and 1/4# flocele followed w/125 sacks of Class "C" 2% CaCl. Cement did not circulate. PD 2:45 PM 4-28-76. WOC 6 hours and ran Temperature Survey, found top of cement at 245'. Ran 1" to 210', spotted 50 sacks of Class "C" 4% CaCl. PD 10:15 PM 4-28-76. WOC 2 hours and ran 1" to 210', spotted 50 sacks of Class "C" 4% CaCl. PD 12:45 AM 4-29-76. Laid down 1" and filled hole to surface w/5 yards of Ready-Mix at 3:30 AM 4-29-76. WOC 18 hours. Nipples up, installed Bop's, tstd to 1000#. OK. Reduced hole to 7-7/8", drld plug, tested to 600#. OK. Resumed drilling.

18. I hereby certify that the foregoing is true and correct

SIGNED Christine Johnson TITLE Geol. Secty DATE 4-30-76

(This space for Federal or State office use)

TITLE _____ DATE _____

APPROVED BY _____

CONDITIONS OF APPROVAL, IF ANY:

TITLE _____ DATE _____

*See Instructions on Reverse Side

NEW MEXICO OIL CONSERVATION COMMISSION
WELL LOCATION AND ACREAGE DEDICATION PLAT

Form C-102
Supersedes C-128
Effective 1-1-65

All distances must be from the outer boundaries of the Section.

Operator Yates Petroleum Corp.		Lease CC Tank Unit		Well No. 1	
Unit Letter F	Section 28	Township 19-S	Range 24-E	County Eddy	
Actual Footage Location of Well: 1980 feet from the North line and 1980 feet from the West line					
Ground Level Elev. 3731 GR	Producing Formation Morrow	Pool Wildcat	Dedicated Acreage: 320 Acres		

1. Outline the acreage dedicated to the subject well by colored pencil or hatchure marks on the plat below.
2. If more than one lease is dedicated to the well, outline each and identify the ownership thereof (both as to working interest and royalty).
3. If more than one lease of different ownership is dedicated to the well, have the interests of all owners been consolidated by communitization, unitization, force-pooling, etc?

☒ Yes ☐ No If answer is "yes," type of consolidation **Being Communitized**

If answer is "no," list the owners and tract descriptions which have actually been consolidated. (Use reverse side of this form if necessary.) _____

No allowable will be assigned to the well until all interests have been consolidated (by communitization, unitization, forced-pooling, or otherwise) or until a non-standard unit, eliminating such interests, has been approved by the Commission.

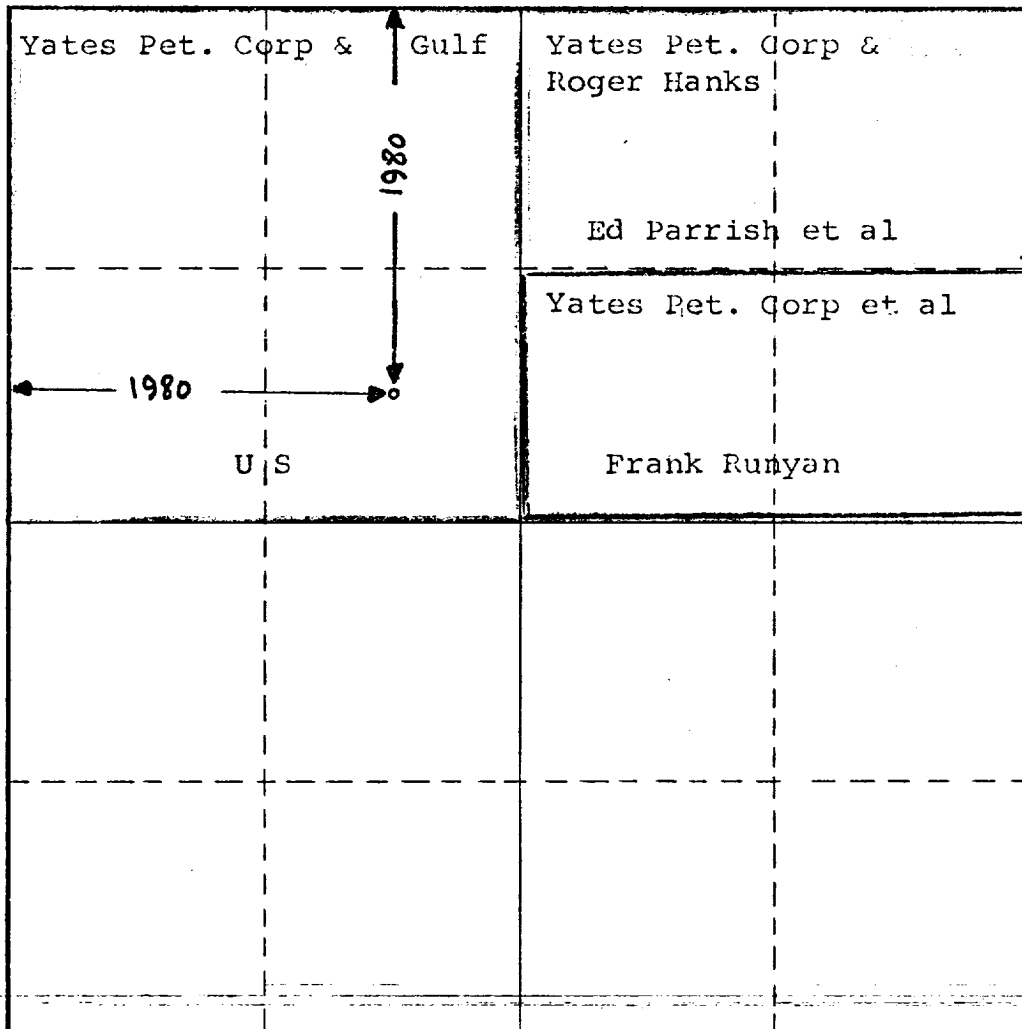

CERTIFICATION

I hereby certify that the information contained herein is true and complete to the best of my knowledge and belief.

Eddie M. Mahfood
Name
Eddie M. Mahfood

Position
Engineer

Company
Yates Petroleum Corp.

Date
4-29-76

I hereby certify that the well location shown on this plat was plotted from field notes, actual surveys made by me or under my supervision, and that the same are correct to the best of my knowledge and belief.

RECEIVED
APR 29 1976
U. S. GEOLOGICAL SURVEY
ARTESIA, NEW MEXICO

REFER TO ORIGINAL PLAT

Date Surveyed

Registered Professional Engineer and/or Land Surveyor

Certificate No.