

District I
PO Box 1980, Hobbs, NM 88241-1980

District II
811 South First, Artesia, NM 88210

District III
1000 Rio Brazos Rd., Aztec, NM 87410

District IV
2040 South Pacheco, Santa Fe, NM 87505

State of New Mexico
Energy, Minerals & Natural Resources Department

OIL CONSERVATION DIVISION
2040 South Pacheco
Santa Fe, NM 87505

Form C-101

Revised October 18, 1994

Instructions on back

Submit to Appropriate District Office

State Lease - 6 Copies

Fee Lease - 5 Copies

☐ AMENDED REPORT

APPLICATION FOR PERMIT TO DRILL, RE-ENTER, DEEPEN, PLUGBACK, OR ADD A ZONE

1Operator Name and Address SOUTHWEST ROYALTIES, INC. P.O. BOX 11390 MIDLAND, TX 79702		2OGRID Number 21355
		3API Number 30 - 015 21863
4Property Code 10637	5Property Name JULIE COM	6Well No. 1

7Surface Location

UL or lot no.	Section	Township	Range	Lot Idn	Feet from the	North/South line	Feet from the	East/West Line	County
H	17	19S	25E		1980	NORTH	990	EAST	EDDY

8Proposed Bottom Hole Location If Different From Surface

UL or lot no.	Section	Township	Range	Lot Idn	Feet from the	North/South line	Feet from the	East/West Line	County
H	17	19S	25E		1650	NORTH	330	EAST	EDDY
9Proposed Pool 1 N. DAGGER DRAW (CISCO CANYON)					10Proposed Pool 2				

11Work Type Code P E	12Well Type Code O	13Cable/Rotary C	14Lease Type Code P	15Ground Level Elevation 3523
16Multiple No	17Proposed Depth 7800	18Formation CISCO CANYON	19Contractor	20Spud Date 12-01-97

21Proposed Casing and Cement Program

Hole Size	Casing Size	Casing weight/foot	Setting Depth	Sacks of Cement	Estimated TOC
17-1/2	13-3/8	54	415	300	SURF
11	8-5/8	24	1125	200	SURF
7-7/8	5-1/2	17	8052	280	6900

22Describe the proposed program. If this application is to DEEPEN or PLUG BACK give the data on the present productive zone and proposed new productive zone. Describe the blowout prevention program, if any. Use additional sheets if necessary.

SQUEEZE OFF INJ ZONE FROM 4762-4954'. DRILL OUT CEMENT PLUGS & RET @ 5465' & @ 6700'. KICK OFF FROM TOP OF PLUG @ 7690' * & MILL WINDOW IN 5-1/2" CSG. DRILL 100' RADIUS TO HORIZONTAL & MAINTAIN DIRECTIONAL BETWEEN 7775 & 7800'. DRILL PLUS OR MINUS 700' LATERAL TO PROPOSED BOTTOM HOLE LOCATION LISTED ABOVE. ACIDIZE ZONE & RUN PUMPING EQUIPMENT TO KOP.

* NOTE: BOTTOM CIBP WAS REPORTED ON 12-18-86 TO BE @ 7960'. THIS IS BELOW OLD PERFS @ 7776 -7848 & IS THEREFORE EXPECTED TO BE @ 7690'. WE WILL TAG THIS PLUG BEFORE KICKING OFF.

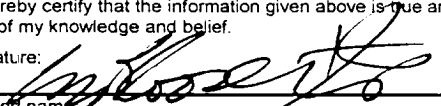
23I hereby certify that the information given above is true and complete to the best of my knowledge and belief.		OIL CONSERVATION DIVISION	
Signature: 		Approved By: ORIGINAL SIGNED BY TIM W. GUM	
Printed name: MARTY BLOODWORTH		Title: DISTRICT II SUPERVISOR	
Title: AREA SUPERVISOR 05-01-01 915 686-9927		Approval Date: JUN 19 2001 Expiration Date: JUN 19 2002	
Date:	Phone:	Conditions of Approval: Attached: <input type="checkbox"/> USC Required to Produce	

District I
PO Box 1980, Hobbs, NM 88241-1980

District II
811 South First, Artesia, NM 88210

District III
1000 Rio Brazos Rd., Aztec, NM 87410

District IV
2040 South Pacheco, Santa Fe, NM 87505

State of New Mexico
Energy, Minerals & Natural Resources Department

OIL CONSERVATION DIVISION
2040 South Pacheco
Santa Fe, NM 87505

Form C-102
Revised October 18, 1994
Instructions on back
Submit to Appropriate District Office
State Lease - 4 Copies
Fee Lease - 3 Copies

☐ AMENDED REPORT

WELL LOCATION AND ACREAGE DEDICATION PLAT

1 API Number 30 015 21863	2 Pool Code	3 Pool Name N. DAGGER DRAW (CISCO CANYON)
4 Property Code	5 Property Name JULIE COM	6 Well Number 1
7 GRID No.	8 Operator Name SOUTHWEST ROYALTIES, INC.	9 Elevation 3523

10 Surface Location

UL or lot no. H	Section 17	Township 19S	Range 25E	Lot Idn	Feet from the 1980	North/South line NORTH	Feet from the 990	East/West Line EAST	County EDDY
--------------------	---------------	-----------------	--------------	---------	-----------------------	---------------------------	----------------------	------------------------	----------------

11 Bottom Hole Location If Different From Surface

UL or lot no. H	Section 17	Township 19S	Range 25E	Lot Idn	Feet from the 1650	North/South line NORTH	Feet from the 330	East/West Line EAST	County EDDY
--------------------	---------------	-----------------	--------------	---------	-----------------------	---------------------------	----------------------	------------------------	----------------

12 Dedicated Acres 40.00	13 Joint or Infill N	14 Consolidation Code	15 Order No.
-----------------------------	-------------------------	-----------------------	--------------

NO ALLOWABLE WILL BE ASSIGNED TO THIS COMPLETION UNTIL ALL INTERESTS HAVE BEEN CONSOLIDATED
OR A NON-STANDARD UNIT HAS BEEN APPROVED BY THE DIVISION

16					17 OPERATOR CERTIFICATION <i>I hereby certify that the information contained herein is true and complete to the best of my knowledge and belief</i> Signature C. M. BLOODWORTH Printed Name AREA SUPERVISOR/ENGINEER Title 05-01-01 Date
18 SURVEYOR CERTIFICATION <i>I hereby certify that the well location shown on this plat was plotted from field notes of actual surveys made by me or under my supervision, and that the same is true and correct to the best of my belief.</i> Date of Survey Signature and Seal of Professional Surveyer: Certificate Number					

SOUTHWEST ROYALTIES

PROJECT JULIE Com #1

PAGE _____ OF _____

BY _____ DATE _____

CURRENT

AS SWD

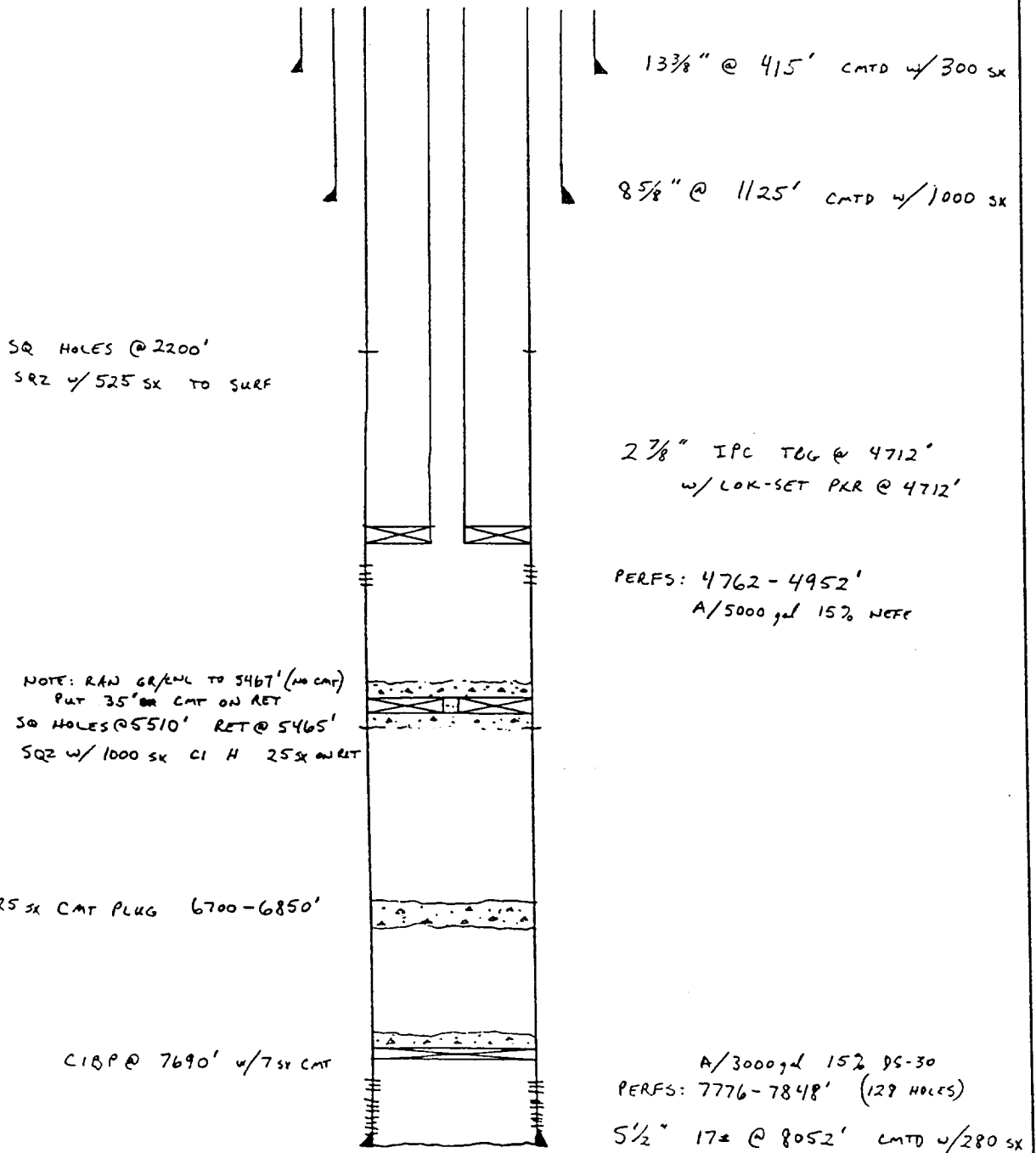

JOB 9/12/97

SOUTHWEST ROYALTIES, INC.

Structure : JULIE COM NO. 1

Slot : slot #1

Field : N. DAGGER DRAW

Location : EDDY COUNTY, NM.

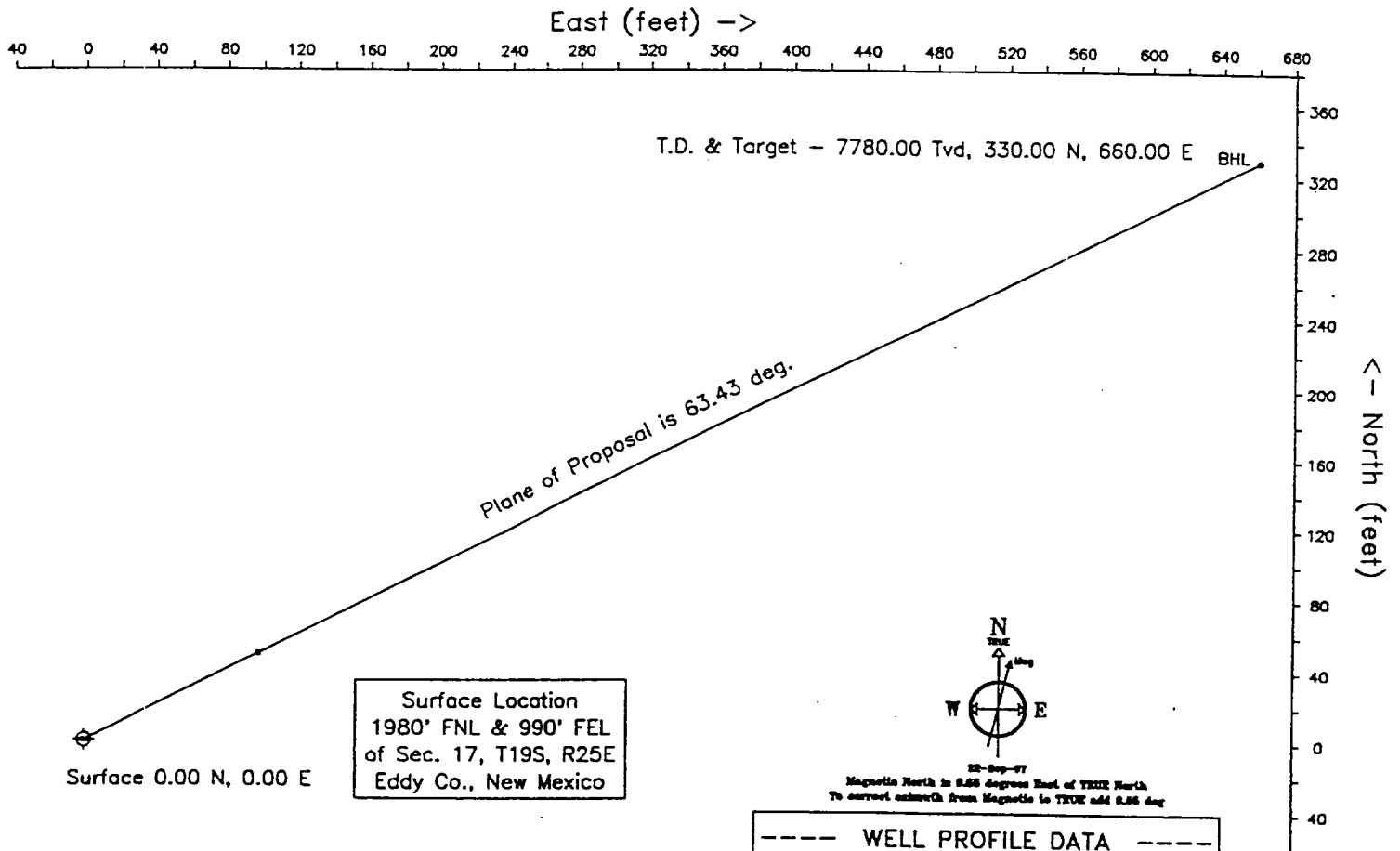

--- WELL PROFILE DATA ---

Point	MD	IN	TH	TVD	MEAS	SL	% SLO	SLP/100
Surf	0.00	0.00	0.00	0.00	0.00	0.00	0.00	0.00
KOP	7670.00	0.00	0.00	7670.00	0.00	0.00	0.00	0.00
End of Bld	7842.79	90.00	0.00	7780.00	45.70	95.30	110.00	95.30
T.D. & Target	8470.69	90.00	0.00	7780.00	228.60	95.30	737.90	95.30

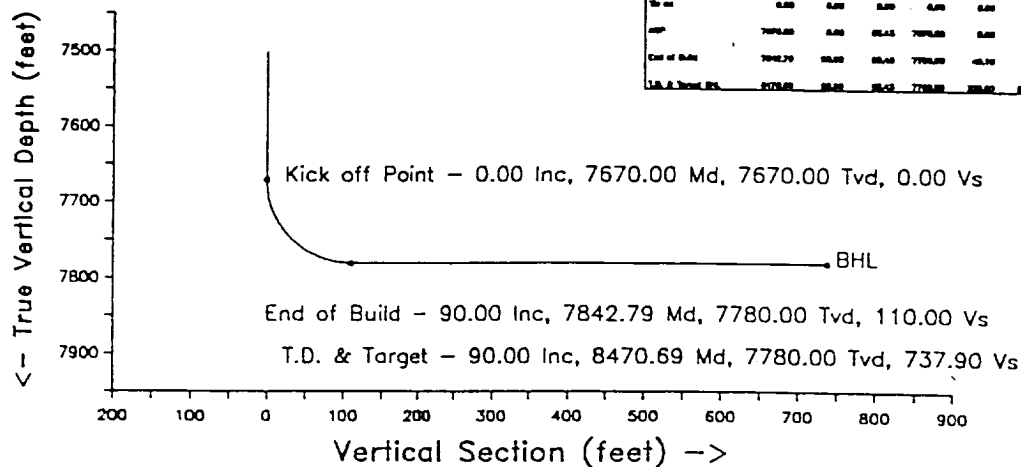

Azimuth 63.43 with reference 0.00 N, 0.00 E from slot #1

District I
PO Box 1960, Hobbs, NM 88241-1960
District II
PO Drawer DD, Artesia, NM 88211-0719
District III
1000 Rio Brazos Rd., Aztec, NM 87410
District IV
PO Box 2088, Santa Fe, NM 87504-2088

State of New Mexico
Energy, Minerals & Natural Resources Department

OIL CONSERVATION DIVISION
PO Box 2088
Santa Fe, NM 87504-2088

Form C-101
Revised February 10, 1994
Instructions on back
Submit to Appropriate District Office
State Lease - 6 Copies
Fee Lease - 5 Copies

☐ AMENDED REPORT

APPLICATION FOR PERMIT TO DRILL, RE-ENTER, DEEPEN, PLUGBACK, OR ADD A ZONE

Operator Name and Address: SOUTHWEST ROYALTIES, INC. P.O. BOX 11390 MIDLAND, TX 79702		OGRID Number
Property Code		API Number 30-015 21863
Property Name JULIE COM		Well No. 1

Surface Location

UL or lot no.	Section	Township	Range	Lot Idn	Feet from the	North/South line	Feet from the	East/West line	County
H	17	19 ¹ TS	25E		1980	NORTH	990	EAST	EDDY

Proposed Bottom Hole Location If Different From Surface

UL or lot no.	Section	Township	Range	Lot Idn	Feet from the	North/South line	Feet from the	East/West line	County
H	17	19 ¹ TS	25E		1650	NORTH	330	EAST	EDDY

Proposed Pool 1 N. DANGER DRAW (CISCO CANYON)	Proposed Pool 2
--	-----------------

Work Type Code P	Well Type Code 0	Cable/Rotary C	Lease Type Code P	Ground Level Elevation 3523
Multiple NO	Proposed Depth 7800	Formation CISCO CANYON	Contractor	Spud Date 12-1-97

Proposed Casing and Cement Program

Hole Size	Casing Size	Casing weight/foot	Setting Depth	Sacks of Cement	Estimated TOC
17 ¹ / ₂	13-3/8	54	415	300	Surf
11	8-5/8	24	1125	200	Surf
7-7/8	5-1/2	17	8052	280	6900

Describe the proposed program. If this application is to DEEPEN or PLUG BACK give the data on the present productive zone and proposed new productive zone. Describe the blowout prevention program, if any. Use additional sheets if necessary.
SQUEEZE OFF INJ. ZONE FROM 4762-4954'. DRILL OUT CEMENT PLUGS & RET @ 5465' & @ 6700'. KICK OFF FROM TOP OF PLUG @ 7690' & MILL WINDOW IN 5-1/2" CSG. DRILL w/4-3/4" BIT 100' RADIUS TO HORIZONTAL & MAINTAIN DIRECTIONAL BETWEEN 7775 & 7800'. DRILL ± 700' LATERAL TO PROPOSED BOTTOM HOLE LOCATION LISTED ABOVE. ACIDIZE ZONE & RUN PUMPING EQUIPMENT TO KOP.
* NOTE : BOTTOM CIBP WAS REPORTED ON 11-18-86 TO BE @ 7960'. THIS IS BELOW OLD PERFS @7776-7848' & IS THEREFORE EXPECTED TO BE @ 7690'. WE WILL TAG THIS PLUG BEFORE KICKING OFF.

I hereby certify that the information given above is true and complete to the best of my knowledge and belief.

Signature: *James Blount*

Printed name: JAMES BLOUNT

Title: AREA SUPERVISOR

Date: 10-7-97
Phone: 1 800 433 7945

OIL CONSERVATION DIVISION

Approved by: ORIGINAL SIGNED BY TIM W. GUN
DISTRICT II SUPERVISOR

Approval Date: 4-2-98
Expiration Date:

Conditions of Approval:
Attached ☐

W F CH AL Jim Stueck KS m L DW oco

State of New Mexico
Energy, Minerals & Natural Resources Department

Form C-102
Revised February 10, 1994
Instructions on back
Submit to Appropriate District Office
State Lease - 4 Copies
Fee Lease - 3 Copies

WELL LOCATION AND ACREAGE DEDICATION PLAT

¹⁰ Surface Location

		08-96	990
" Bottom Hole Location If Different From Surface			

NO ALLOWABLE WILL BE ASSIGNED TO THIS COMPLETION UNTIL ALL INTERESTS HAVE BEEN CONSOLIDATED
OR A NON-STANDARD UNIT HAS BEEN APPROVED BY THE DIVISION

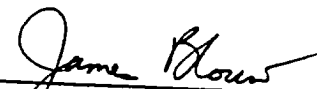
16					<p>1720'</p> <p>1050'</p> <p>330'</p> <p>990'</p> <p>BNL</p>	<p>17 OPERATOR CERTIFICATION</p> <p><i>I hereby certify that the information contained herein is true and complete to the best of my knowledge and belief</i></p> <p style="text-align: center;">  Signature </p> <p style="text-align: center;"> Printed Name JAMES BLOUNT </p> <p style="text-align: center;"> Title Area Supervisor </p> <p style="text-align: center;"> Date 10-7-97 </p>
						<p>18 SURVEYOR CERTIFICATION</p> <p><i>I hereby certify that the well location shown on this plat was plotted from field notes of actual surveys made by me or under my supervision, and that the same is true and correct to the best of my belief.</i></p> <p>Date of Survey</p> <p>Signature and Seal of Professional Surveyor:</p>
						<p>Certificate Number</p>

SOUTHWEST ROYALTIES

PROJECT JULIE Com #1

PAGE _____ OF _____

BY _____ DATE _____

CURRENT

AS SWD

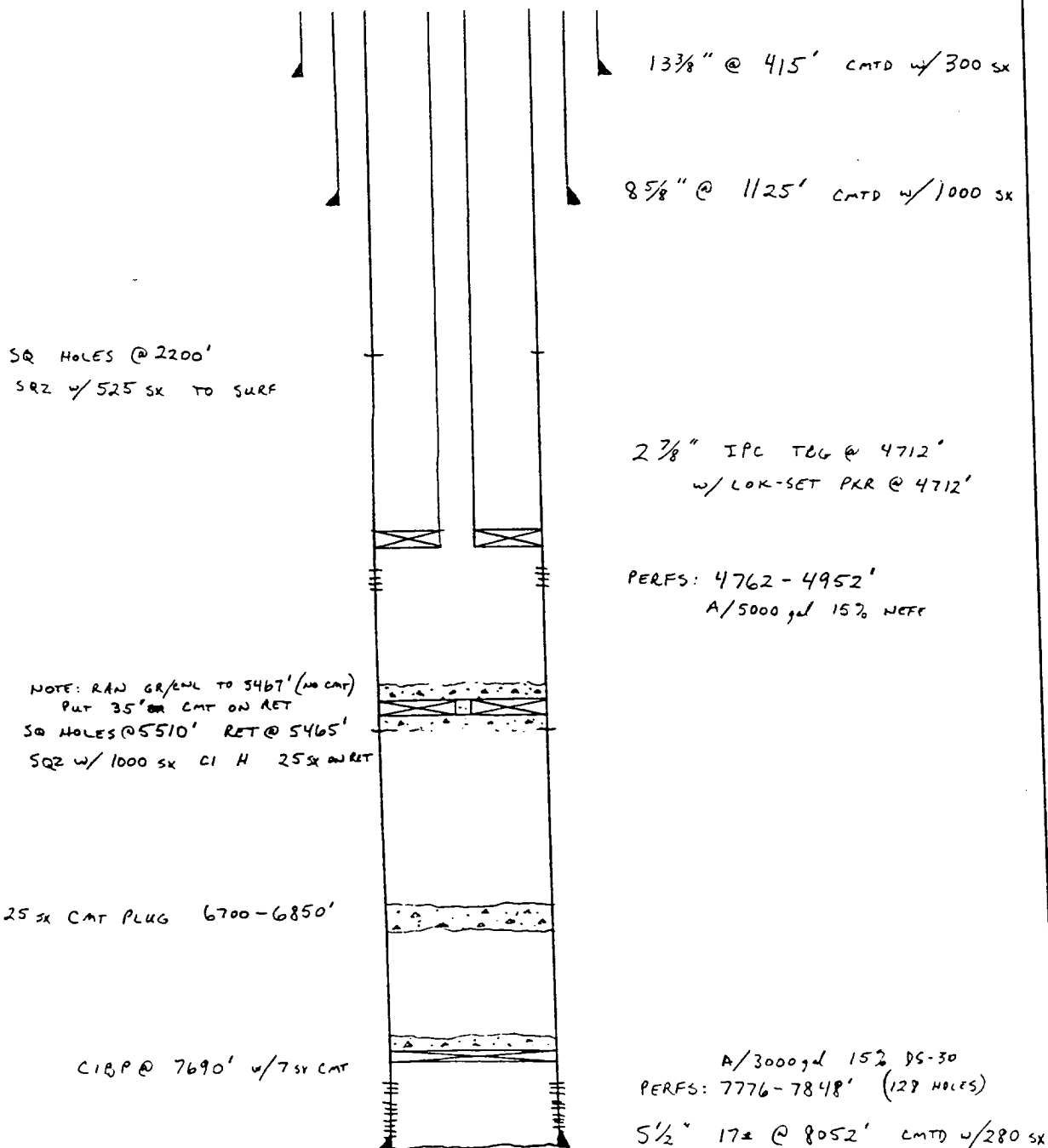

ISB 9/12/97