

NO. OF COPIES RECEIVED		
DISTRIBUTION		
SANTA FE		
FILE		
U.S.G.S.		
LAND OFFICE		
OPERATOR		

NEW MEXICO OIL CONSERVATION COMMISSION RECEIVED

APR 21 1976

Form C-101
Revised 1-1-65

O. C. C.
ARTESIA, OFFICE

5A. Indicate Type of Lease
STATE FEE

5. State Oil & Gas Lease No.

APPLICATION FOR PERMIT TO DRILL, DEEPEN, OR PLUG BACK

1a. Type of Work
 DRILL DEEPEN PLUG BACK
 b. Type of Well
 OIL WELL GAS WELL OTHER _____
 SINGLE ZONE MULTIPLE ZONE

2. Name of Operator
Roger C. Hanks

3. Address of Operator
P. O. Box 3148, Midland, TX 79701

4. Location of Well
 UNIT LETTER P LOCATED 990 FEET FROM THE South LINE
 AND 990 FEET FROM THE East LINE OF SEC. 13 TWP. 19S RGE. 24E NMPM

7. Unit Agreement Name
8. Farm or Lease Name
Molly Com
9. Well No.
1
10. Field and Pool, or Wildcat
Dagger Draw Field

12. County
Eddy

19. Proposed Depth
8000'
19A. Formation
Cisco Canyon
20. Rotary or C.T.
Rotary

21. Elevations (Show whether DF, RT, etc.)
3606.4 GR
21A. Kind & Status Plug. Bond
\$10,000 #400DN-
21B. Drilling Contractor
Moran Bros, Inc.
22. Approx. Date Work will start
Upon Approval

23. PROPOSED CASING AND CEMENT PROGRAM

SIZE OF HOLE	SIZE OF CASING	WEIGHT PER FOOT	SETTING DEPTH	SACKS OF CEMENT	EST. TOP
17 1/2"	13-3/8"	32#	410'	200 sx.	
11"	8-5/8"	23# & 26#	1120'	600 sx.	

Operator plans to drill the well to TD of approx. 8000' and test zone either by DST or log analysis. If information indicates zone is productive of oil and/or gas, the operator plans to run 8-5/8" csg, cement same, perforate and acidize for production tests. If dry hole is indicated, well will be plugged and abandoned in accordance with state rules and regulations.

1. BOP Program - Two Shaffer Hydraulic preventors and one Hydril "GK" w/ 3000 psi WP ratings. Sufficient mud wt to contain formation at all times. (See complete diagram on attachment).
2. Mud Program - Native mud to 4000'. Good sample mud from 4000' to 7000'. Low water loss mud (wt. 9.2-9.6) from 7000' to TD.
3. Drilling Waste Disposal Program - Drilling waste will be completely contained in earthen pits. Any liquid will be allowed to evaporate. Pits will be re-covered with soil and area returned to its original condition.

IN ABOVE SPACE DESCRIBE PROPOSED PROGRAM; IF PROPOSAL IS TO DEEPEN OR PLUG BACK, GIVE DATA ON PRESENT PRODUCTIVE ZONE AND PROPOSED NEW PRODUCTIVE ZONE. GIVE BLOWOUT PREVENTER PROGRAM, IF ANY.

I hereby certify that the information above is true and complete to the best of my knowledge and belief.

Signed Roger C. Hanks Title Owner-Operator Date April 20, 1976
 (This space for State Use)

APPROVED BY _____ TITLE _____ DATE _____
 CONDITIONS OF APPROVAL, IF ANY:

NEW MEXICO OIL CONSERVATION COMMISSION
WELL LOCATION AND ACREAGE DEDICATION PLAT

Form O-11-12
Supersedes C-128
Effective 1-1-65

All distances must be from the outer boundaries of the Section

Operator Roger C. Hanks		Lease Molly Com		Acres 1	
Section P	Range 13	Westing 19 South	Meridian 24 East	County Eddy	
Section 990	Section South	Section 990	Section East		
Section 3606.4	Section Clapp Canyon	Section North Digger Draw - Upper Penn	Section 160		

- 1 Outline the acreage dedicated to the subject well by colored pencil or hash-bite marks on the plat below.
- 2 If more than one lease is dedicated to the well, outline each and identify the ownership there of (both as to working interest and royalty).
- 3 If more than one lease of different ownership is dedicated to the well, have the interests of all owners been consolidated by communitization, unitization, force-pooling, etc?

Yes No If answer is "yes," type of consolidation **Communitization**

If answer is "no," list the owners and tract descriptions which have actually been consolidated (Use reverse side of this form if necessary.) _____

No allowable will be assigned to the well until all interests have been consolidated (by communitization, unitization, forced-pooling, or otherwise) or until a non-standard unit, eliminating such interests, has been approved by the Commission.

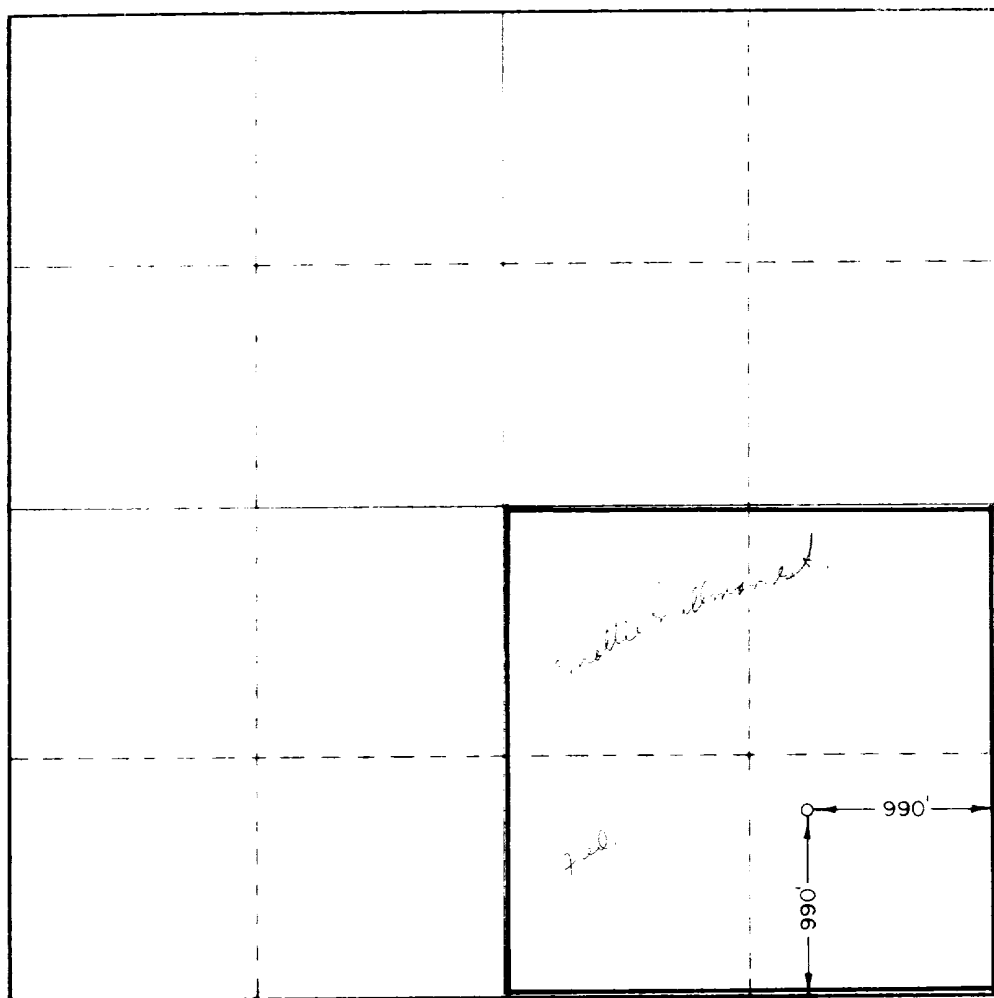

CERTIFICATION

I hereby certify that the information contained herein is true and complete to the best of my knowledge and belief.

Roger C. Hanks
Roger C. Hanks
Owner Operator

Roger C. Hanks

April 9, 1976

I hereby certify that the well location shown on this plat was plotted from field notes of actual surveys made by me or under my supervision and that the same is true and correct to the best of my knowledge and belief.

REGISTERED PROFESSIONAL ENGINEER & LAND SURVEYOR
STATE OF NEW MEXICO
April 5, 1976
676
John W. West
JOHN W. WEST 676

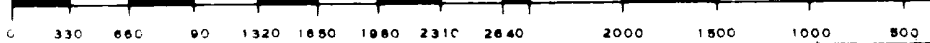

MINIMUM BLOWOUT PREVENTER EQUIPMENT FOR HAZARDOUS INTERMEDIATE PRESSURE SERVICE

Class II (3000 psi WP - Series 900)

Note: For Air Drilling, Add Rotating Head above Hydril; Minimum 7" Flow Line, and increase Size of Choke Line to 4".

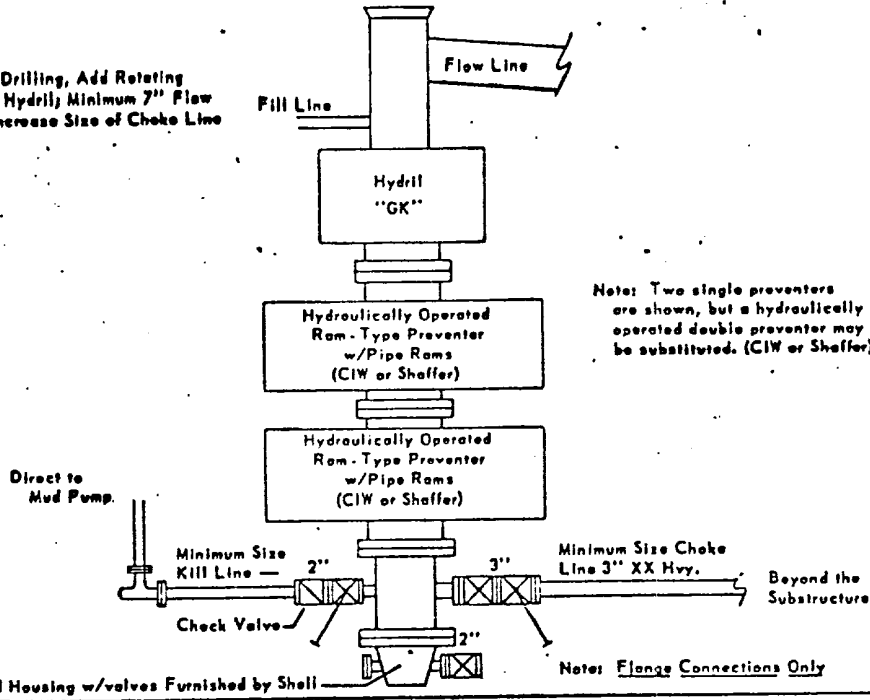

Note: Two single preventers are shown, but a hydraulically operated double preventer may be substituted. (CIW or Shaffer).

Casing Head Housing w/valves Furnished by Shell

Note: Flange Connections Only

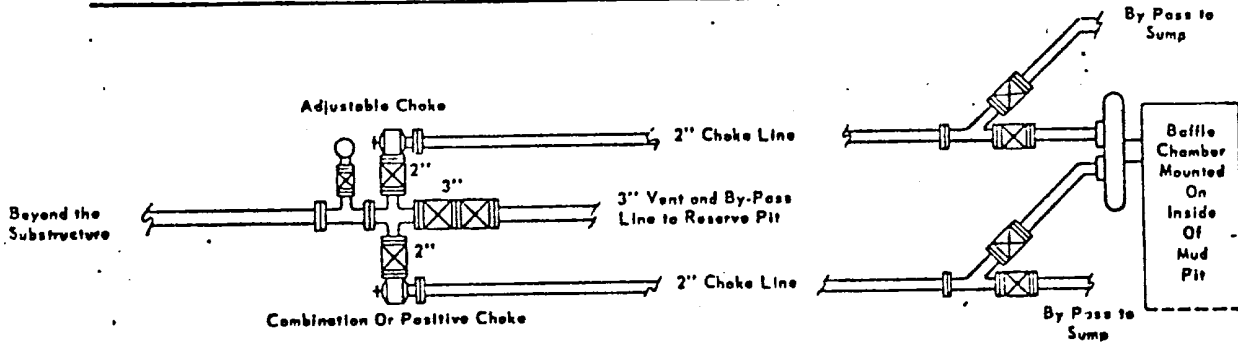

MINIMUM REQUIREMENTS

1. All BOP's, valves, fittings and lines shall have 3000 psi WP (Series 900) ratings.
2. All equipment from the top preventer to the outermost valve or choke shall be pressure tested to 3000 psi.
3. All valves employed must be gate type suitable for high pressure mud service.
4. Outside valves on spool that are 4" or larger shall be hydraulically operated.
5. The Cameron steel ring and a rubber "O" ring shall be required on all BOP Flange connections.
6. Replacement parts for chokes shall be available at rig.
7. All lines shall be securely anchored.
8. Casing wear ring shall be required when the BOP is larger than the nominal casing size.
9. An 80 gallon hydraulic accumulator with an operating pressure of 1500 psi shall be required.
10. Two control points (a master control manifold and a remote control manifold including Hydril regulator valves,) shall be properly equipped and connected to BOP's with steel lines.
11. Inside BOP and Kelly cock shall be provided.
12. BOP's shall have extensions for latching rams.
13. Outside valve on choke line and inside valve on kill line shall have extensions for operating valves.
14. Valve on casing head housing shall be used only in extreme emergency.
15. Choke and vent line shall be streamlined with no abrupt turns or bends.

30-015-~~25638~~
21864

1-5-77

Sidwall Neutron Porosity

Qual Petrolog Micro JFL

Ana-Log