

NO. OF COPIES RECEIVED	6
DISTRIBUTION	
SANTA FE	1
FILE	1
U.S.G.S.	2
LAND OFFICE	1
OPERATOR	1

**RECEIVED**

NEW MEXICO OIL CONSERVATION COMMISSION

APR 18 1977

**O. C. C.**  
ARTESIA, OFFICE

30-015-22122

Form O-101  
Revised 1-1-65

5A. Indicate Type of Lease STATE <input checked="" type="checkbox"/> FEE <input type="checkbox"/>
5. State Oil & Gas Lease No. K-6850
7. Unit Agreement Name
8. Farm or Lease Name Read & Stevens State
9. Well No. 1
11. Field and Pool, or Wildcat San Andres Wildcat
12. County Eddy
19. Dr. point depth 3300'
19A. Formation San Andres
20. Rotary or C.T. Rotary
21. Elevations (Show whether DF, RT, etc.) 3381.0 Ground Level
21A. Kind & Status Plug. Bend State Wide
21B. Drilling Contractor Artesia Fishing Tool
22. Approx. Date Work will start 4-18-77

**APPLICATION FOR PERMIT TO DRILL, DEEPEN, OR PLUG BACK**

1a. Type of Work	DRILL <input checked="" type="checkbox"/>	DEEPEN <input type="checkbox"/>	PLUG BACK <input type="checkbox"/>
b. Type of Well	OIL WELL <input checked="" type="checkbox"/>	GAS WELL <input type="checkbox"/>	OTHER <input type="checkbox"/>
2. Name of Operator	Gene A. Snow ✓		
3. Address of Operator	606 S. 13th St., Lovington, New Mexico 88260		
4. Location of Well	UNIT LETTER H	LOCATED 990'	FEET FROM THE East LINE
AND	1650 FEET FROM THE North	LINE OF SEC. 10	TWP. 19S RGE. 29E NMPM
21. Elevations (Show whether DF, RT, etc.)	21A. Kind & Status Plug. Bend	21B. Drilling Contractor	22. Approx. Date Work will start

**PROPOSED CASING AND CEMENT PROGRAM**

SIZE OF HOLE	SIZE OF CASING	WEIGHT PER FOOT	SETTING DEPTH	SACKS OF CEMENT	EST. TOP
11"	8 5/8"	24 #	300'	160	Circulate
7 7/8"	4 1/2"	9.5 #	3300'	865	Circulate

1. Drill an 11" hole to the top of the Salt, at approximately 300'.
2. Run 8 5/8"; 24 #; J-55 Casing and cement with sufficient amount of cement to circulate.
3. Drill 7 7/8" Hole to approximately 3300', or the Lovington Sand in the San Andres formation.
4. Run 4 1/2" casing to 3300' and cement with sufficient amount of cement to circulate.

**APPROVAL VALID  
FOR 90 DAYS UNLESS  
DRILLING COMMENCED,**

EXPIRES 7-18-77

IN ABOVE SPACE DESCRIBE PROPOSED PROGRAM; IF PROPOSAL IS TO DEEPEN OR PLUG BACK, GIVE DATA ON PRESENT PRODUCTIVE ZONE AND PROPOSED NEW PRODUCTIVE ZONE. GIVE BLOWOUT PREVENTER PROGRAM, IF ANY.

I hereby certify that the information above is true and complete to the best of my knowledge and belief.

Signed Gene A. Snow Title Operator Date 4-18-77

(This space for State Use)

APPROVED BY W. A. Gussert TITLE SUPERVISOR, DISTRICT II DATE APR 18 1977

CONDITIONS OF APPROVAL, IF ANY:

NEW MEXICO OIL CONSERVATION COMMISSION  
WELL LOCATION AND ACREAGE DEDICATION PLAT

Form C-102  
Supersedes C-128  
Effective 1-1-65

All distances must be from the outer boundaries of the Section.

Operator <b>GENE A. SNOW</b>			Lease <b>Read and Stevens State</b>		Well No. <b>1</b>
Tract Letter <b>"H"</b>	Section <b>10</b>	Township <b>19 South</b>	Range <b>29 East</b>	County <b>Eddy</b>	
Actual Footage Location of Well: <b>1650</b> feet from the <b>North</b> line and <b>990</b> feet from the <b>East</b> line					
Ground Level Elev. <b>3381.0</b>	Producing Formation <b>San Andres</b>	Pool <b>San Andres W. C.</b>	Dedicated Acreage: <b>40</b> Acres		

1. Outline the acreage dedicated to the subject well by colored pencil or hachure marks on the plat below.
2. If more than one lease is dedicated to the well, outline each and identify the ownership thereof (both as to working interest and royalty).
3. If more than one lease of different ownership is dedicated to the well, have the interests of all owners been consolidated by communitization, unitization, force-pooling, etc?

Yes     No    If answer is "yes," type of consolidation \_\_\_\_\_

If answer is "no," list the owners and tract descriptions which have actually been consolidated. (Use reverse side of this form if necessary.) \_\_\_\_\_

No allowable will be assigned to the well until all interests have been consolidated (by communitization, unitization, forced-pooling, or otherwise) or until a non-standard unit, eliminating such interests, has been approved by the Commission.

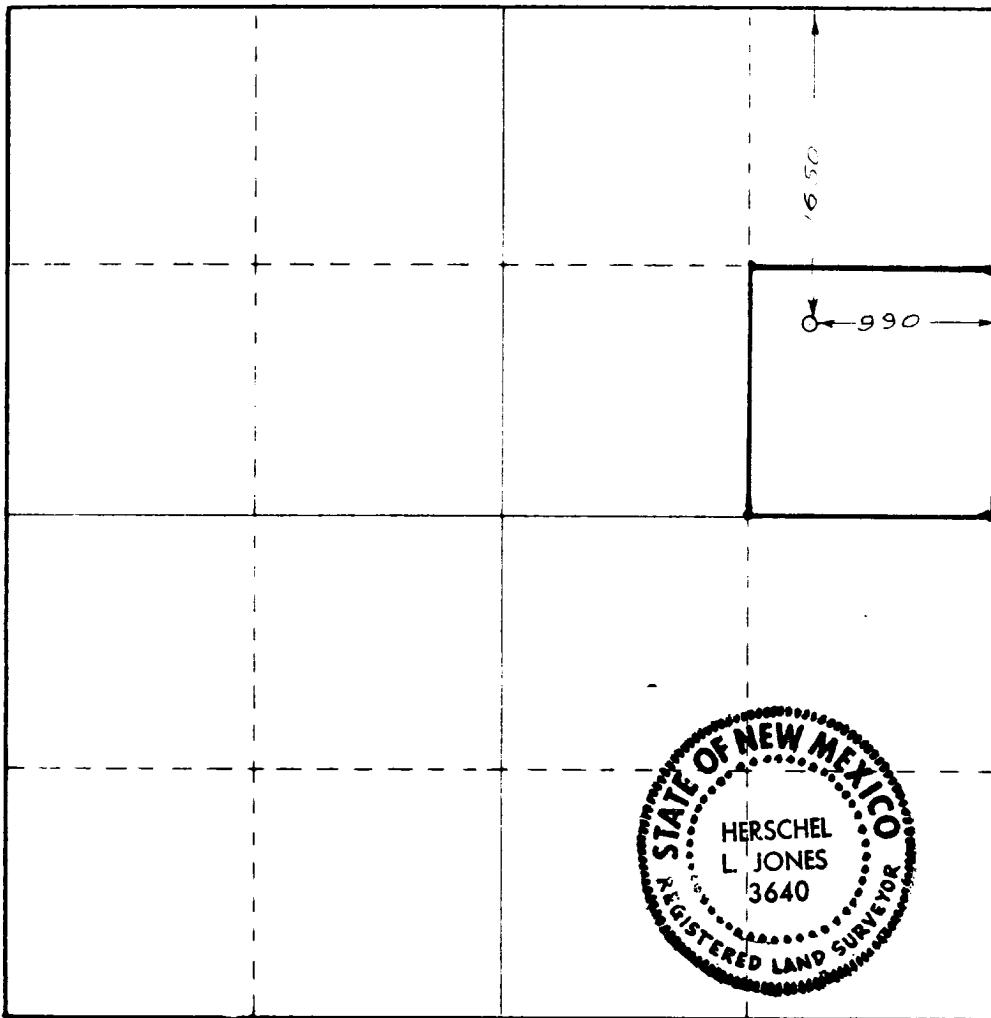

**CERTIFICATION**

I hereby certify that the information contained herein is true and complete to the best of my knowledge and belief.

Name <b>Gene A. Snow</b>
Position <b>Operator</b>
Company <b>Gene A. Snow</b>
Date <b>4-15-1977</b>

I hereby certify that the well location shown on this plat was plotted from field notes of actual surveys made by me or under my supervision, and that the same is true and correct to the best of my knowledge and belief.

Date Surveyed <b>April 15, 1977</b>
Registered Professional Engineer and/or Land Surveyor <b>Herschel L. Jones</b>
Certificate No. <b>3640</b>

