

NEW MEXICO OIL CONSERVATION COMMISSION  
WELL LOCATION AND ACREAGE DEDICATION PLAT

Form O-112  
Supersedes O-128  
Effective 1-1-65

All distances must be from the outer boundaries of the Section

Operator <b>CITIES SERVICE COMPANY</b>		Lease <b>STATE CX</b> Com		Well No. <b>1</b>
Unit Letter <b>N</b>	Section <b>28</b>	Township <b>19 South</b>	Range <b>28 East</b>	County <b>Eddy</b>
Actual Location of Well:				
<b>660</b>	feet from the <b>South</b>	line and	<b>1980</b>	feet from the <b>West</b>
Ground Level Elev. <b>3356.7'</b>	Producing Formation <b>Morrow</b>	Face	<b>Winchester Morrow</b>	Section <b>320</b>

1. Outline the acreage dedicated to the subject well by colored pencil or hatchure marks on the plat below.
2. If more than one lease is dedicated to the well, outline each and identify the ownership thereof (both as to working interest and royalty).
3. If more than one lease of different ownership is dedicated to the well, have the interests of all owners been consolidated by communitization, unitization, force-pooling, etc?

☒ Yes ☐ No If answer is "yes," type of consolidation Communitization

If answer is "no," list the owners and tract descriptions which have actually been consolidated. (Use reverse side of this form if necessary.)

No allowable will be assigned to the well until all interests have been consolidated (by communitization, unitization, forced-pooling, or otherwise) or until a non-standard unit, eliminating such interests, has been approved by the Commission.

Working interests of participating companies in this well are as follows:

Cities Service Company	50.000000%
Gulf Oil Company	25.000000%
John A. Yates	12.500000%
Atlantic-Richfield	6.250000%
Yates Pet.	2.256950%
Deppo, Inc.	1.996525%
Husky	1.996525%
	<u>100.000000%</u>

CERTIFICATION

I hereby certify that the information contained herein is true and complete to the best of my knowledge and belief.

Signature *E. Spiller*  
Region Operations Manager

Cities Service Company

September 28, 1977

I hereby certify that the well location shown on this plat was plotted from field notes of actual surveys made by me or under my supervision, and that the same is true and correct to the best of my knowledge and belief.

Date Surveyed

**April 12, 1977**

Registered Professional Land Surveyor and State Surveyor

Signature *W. West*  
676

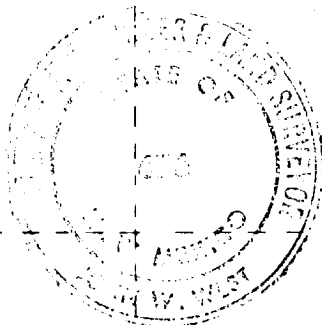

5010 L-5128

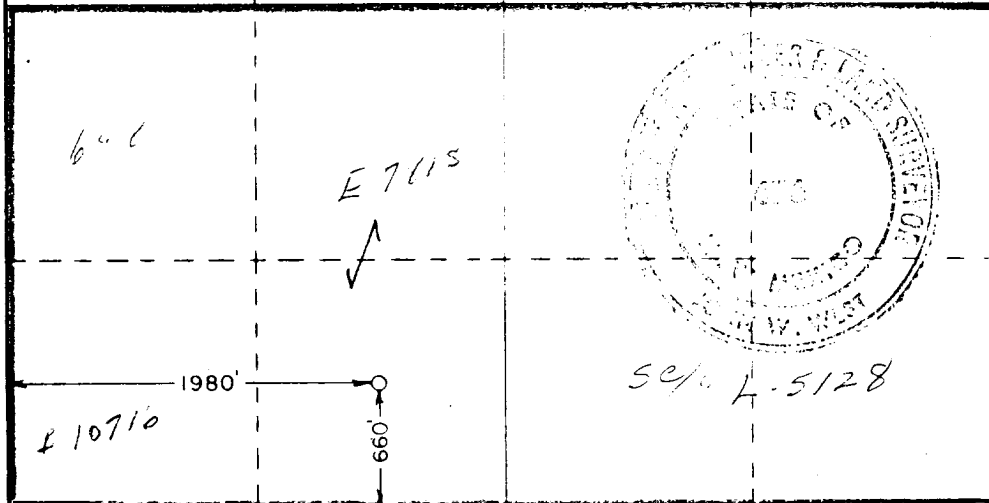

0 330 660 990 1320 1680 1980 2310 2640 2000 1800 1600 1400 1200 1000 800 600 400 200 0