

NO. COPIES RECEIVED	6
DISTRIBUTION	
SANTA FE	1
FILE	1
U.S.G.S.	2
LAND OFFICE	1
OPERATOR	1

RECEIVED
NEW MEXICO OIL CONSERVATION COMMISSION

JUN 15 1977

O. C. C.
ARTESIA, OFFICE

30-015-22187

Form C-101
Revised 11-65

5A. Indicate Type of Lease STATE <input checked="" type="checkbox"/> FEE <input type="checkbox"/>
5. State Oil & Gas Lease No. K-6096
7. Unit Agreement Name -----
8. Farm or Lease Name Albert State Com.
9. Well No. 1
10. Field and Pool, or Willcat Cemetery Morrow
12. County Eddy
13. Proposed Depth 9600
19A. Formation Morrow
20. Rotary or C.T. Rotary
21. Elevations (Show whether DE, RT, etc.) GR 3511
21A. Kind & Status Plug. Bond blanket
21B. Drilling Contractor Cactus
22. Approx. Date Work will start August 1, 1977

APPLICATION FOR PERMIT TO DRILL, DEEPEN, OR PLUG BACK			
1a. Type of Work b. Type of Well OIL WELL <input type="checkbox"/> GAS WELL <input checked="" type="checkbox"/> OTHER <input type="checkbox"/> DRILL <input checked="" type="checkbox"/> DEEPEN <input type="checkbox"/> PLUG BACK <input type="checkbox"/> SINGLE ZONE <input checked="" type="checkbox"/> MULTIPLE ZONE <input type="checkbox"/>			
2. Name of Operator Monsanto Company			
3. Address of Operator 1330 Midland National Bank Midland, Texas 79701			
4. Location of Well UNIT LETTER F LOCATED 1980 FEET FROM THE north LINE AND 1980 FEET FROM THE west LINE OF SEC. 32 TWP. 19-S RGL. 25-E NMPM			
5. Unit Agreement Name -----			
6. Farm or Lease Name Albert State Com.			
7. Well No. 1			
8. Field and Pool, or Willcat Cemetery Morrow			
9. County Eddy			
10. Proposed Depth 9600			
19A. Formation Morrow			
20. Rotary or C.T. Rotary			
21. Elevations (Show whether DE, RT, etc.) GR 3511			
21A. Kind & Status Plug. Bond blanket			
21B. Drilling Contractor Cactus			
22. Approx. Date Work will start August 1, 1977			

23. PROPOSED CASING AND CEMENT PROGRAM

SIZE OF HOLE	SIZE OF CASING	WEIGHT PER FOOT	SETTING DEPTH	SACKS OF CEMENT	EST. TOP
17 1/2"	13 3/8"	48	400	500	Surface
12 3/4"	9 5/8"	36	1400	800	Surface
8 3/4"	5 1/2"	20	9600	800	7500'

Drill 17 1/2" hole to 400'; Set 13 3/8", 48# casing and cement to surface.
Drill 12 3/4" hole to 1400'; Set 9 5/8", 36# casing and cement to surface.
Drill 8 3/4" hole to 9600'; Run logs.
If production is indicated, run 5 1/2", 20# casing to 9600'.
Perforate and treat as necessary.

Gas Partially Dedicated

APPROVAL VALID
FOR 90 DAYS UNLESS
DRILLING COMMENCED,
EXPIRES 9-16-77

IN ABOVE SPACE DESCRIBE PROPOSED PROGRAM; IF PROPOSAL IS TO DEEPEN OR PLUG BACK, GIVE DATA ON PRESENT PRODUCTIVE ZONE AND PROPOSED NEW PRODUCTIVE ZONE. GIVE BLOWOUT PREVENTER PROGRAM, IF ANY.

I hereby certify that the information above is true and complete to the best of my knowledge and belief.

Signed *W. A. Gressett* Title Regional Production Mgr. Date June 14, 1977

(This space for State Use)

APPROVED BY *W. A. Gressett* TITLE SUPERVISOR, DISTRICT # DATE JUN 16 1977

CONDITIONS OF APPROVAL, IF ANY:

Cement must be circulated to
surface behind 13 3/8" & 9 5/8" casing

Notify N.M.O.C.C. in sufficient
time to witness cementing
the 9 5/8" casing

NEW MEXICO OIL CONSERVATION COMMISSION
WELL LOCATION AND ACREAGE DEDICATION - LAT

Form C-102
Supersedes C-128
Effective 1-1-65

All distances must be from the outer boundaries of the Section.

Operator MONSANTO COMPANY			Lease ALBERT STATE		Well No. 1
Unit Letter F	Section 32	Township 19-S	Range 25-E	County EDDY	
Actual Footage Location of Well: 1980 feet from the NORTH line and 1980 feet from the WEST line					
Ground Level Elev. 3511	Producing Formation Morrow		Pool Cemetery Morrow		Dedicated Acreage: 320 Acres

- Outline the acreage dedicated to the subject well by colored pencil or hachure marks on the plat below.
- If more than one lease is dedicated to the well, outline each and identify the ownership thereof (both as to working interest and royalty).
- If more than one lease of different ownership is dedicated to the well, have the interests of all owners been consolidated by communitization, unitization, force-pooling, etc?

☒ Yes ☐ No If answer is "yes," type of consolidation Communitization

If answer is "no," list the owners and tract descriptions which have actually been consolidated. (Use reverse side of this form if necessary.) _____

No allowable will be assigned to the well until all interests have been consolidated (by communitization, unitization, forced-pooling, or otherwise) or until a non-standard unit, eliminating such interests, has been approved by the Commission.

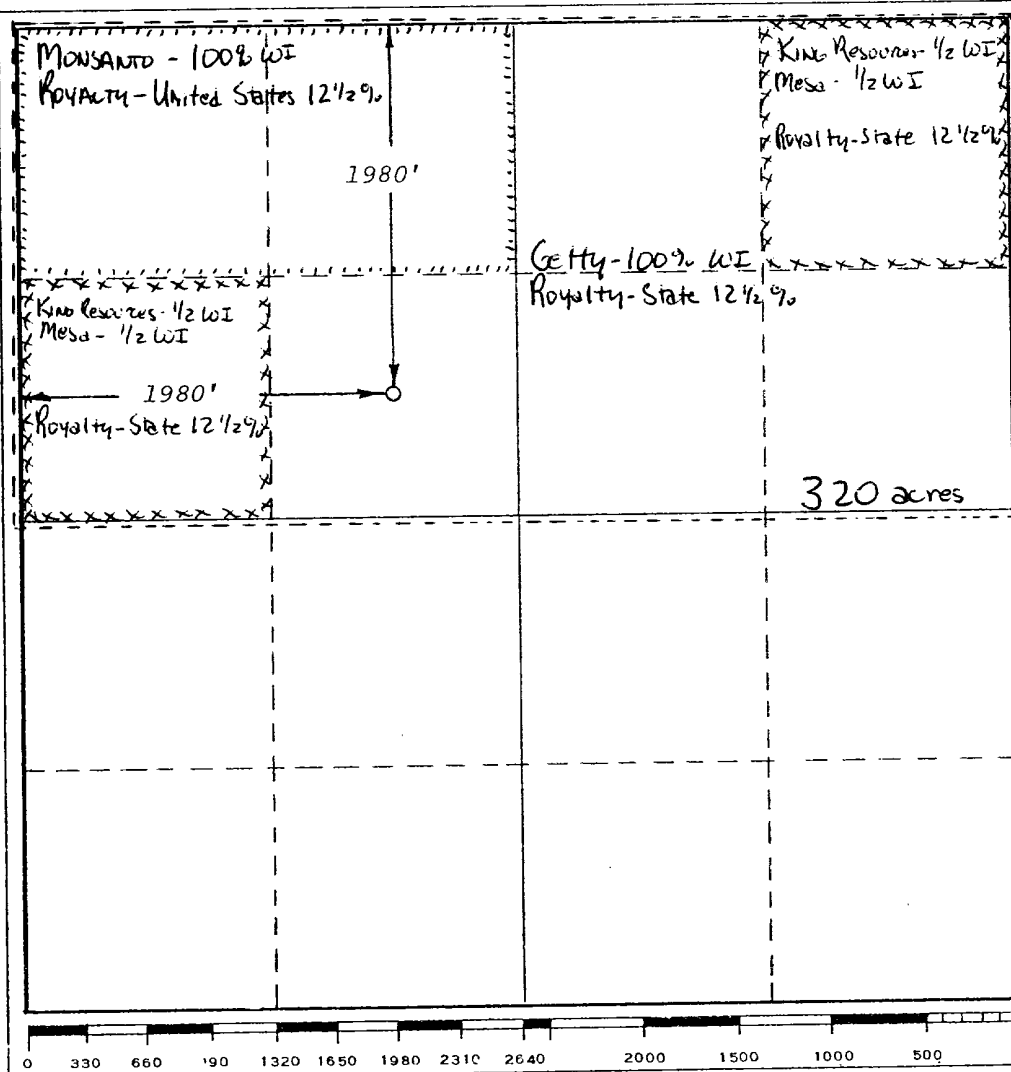

THE BLOWOUT PREVENTER STACK

5,000 psi. Working Pressure

