

NO. OF COPIES RECEIVED	
DISTRIBUTION	
SANTA FE	
FILE	
U.S.G.S.	
LAND OFFICE	
OPERATOR	

NEW MEXICO OIL CONSERVATION COMMISSION

RECEIVED

AUG 1 1977

U.C.C.

30-015-222.33
Form C-101
Revised 1-1-65

5A. Indicate Type of Lease	
STATE <input checked="" type="checkbox"/>	FEE <input type="checkbox"/>
5. State Oil & Gas Lease No.	
1937 LG-4119	

APPLICATION FOR PERMIT TO DRILL ~~WIDE AREA~~ **WIDE AREA** PLUG BACK

1a. Type of Work		7. Unit Agreement Name	
b. Type of Well OIL WELL <input type="checkbox"/> GAS WELL <input checked="" type="checkbox"/> OTHER <input type="checkbox"/>		8. Farm or Lease Name LAKEWOOD STATE COM.	
2. Name of Operator MONSANTO COMPANY		9. Well No. 1	
3. Address of Operator 1330 Midland National Bank Tower, Midland, Texas 79701		10. Field and Pool, or Willcut WILDCAT	
4. Location of Well UNIT LETTER F LOCATED 1980 FEET FROM THE North LINE AND 1980 FEET FROM THE West LINE OF SEC. 30 TWP. 19S RGE. 26E NMPM		12. County Eddy	
21. Elevations (Show whether DF, RT, etc.) GL 3419		21A. Kind & Status Plug Back Blanket	21B. Drilling Contractor KKA Drilling Co.
22. Approx. Date Work will start August 5, 1977		23. PROPOSED CASING AND CEMENT PROGRAM	

SIZE OF HOLE	SIZE OF CASING	WEIGHT PER FOOT	SETTING DEPTH	SACKS OF CEMENT	EST. TOP
17 1/2"	13 3/8	48	500'	500	Surface
12 1/4"	9 5/8	36	1400'	800	Surface
8 3/4"	5 1/2	20	9600'	1200	7000'

Drill 17 1/2" hole to 500'; Set 13 3/8" 48# Casing & cement to surface.

Drill 12 1/4" hole to 1400'; Set 9 5/8" 36# Casing & cement to surface.

Drill 8 3/4" hole to 9600' and log.

If log positive, set 5 1/2" Casing and cement, perforate and treat if necessary.

Gas not dedicated.

APPROVAL VALID
FOR 90 DAYS UNLESS
DRILLING COMMENCES,

EXPIRES 11-2-77

IN ABOVE SPACE DESCRIBE PROPOSED PROGRAM IF PROPOSAL IS FOR PLUG BACK, GIVE DATA ON PRESENT PRODUCTIVE ZONE AND PROPOSED NEW PRODUCTIVE ZONE. GIVE BLENDOUT PREVENTER PROGRAM, IF ANY.

I hereby certify that the information above is true and complete to the best of my knowledge and belief.

Signed W. A. Gussess Title Regional Production Mgr. Date 7/28/77

(This space for State Use)

APPROVED BY W. A. Gussess TITLE SUPERVISOR, DISTRICT II DATE AUG 2 1977

CONDITIONS OF APPROVAL, IF ANY:

Casing to be set to surface 1 1/2" 13 3/8" 48# casing

Notify N.M.O.C.C. in sufficient time to witness cementing the 9 5/8" casing

NEW MEXICO OIL CONSERVATION COMMISSION
WELL LOCATION AND ACREAGE DEDICATION PLAT

Form C-102
Supersedes C-128
Effective 1-1-65

All distances must be from the outer boundaries of the Section.

Operator MONSANTO COMPANY			Lease Lakewood State COM.		Well No. 1
Unit Letter F	Section 30	Township 19-S	Range 26-E	County Eddy	
Actual Footage Location of Well: 1980 feet from the North line and 1980 feet from the West line					
Ground Level Elev. 3419	Producing Formation Morrow		Pool Wildcat		Dedicated Acreage: 320 Acres

1. Outline the acreage dedicated to the subject well by colored pencil or hatchure marks on the plat below.
2. If more than one lease is dedicated to the well, outline each and identify the ownership thereof (both as to working interest and royalty).
3. If more than one lease of different ownership is dedicated to the well, have the interests of all owners been consolidated by communitization, unitization, force-pooling, etc?

☒ Yes ☐ No If answer is "yes," type of consolidation Communitization

If answer is "no," list the owners and tract descriptions which have actually been consolidated. (Use reverse side of this form if necessary.)

No allowable will be assigned to the well until all interests have been consolidated (by communitization, unitization, forced-pooling, or otherwise) or until a non-standard unit, eliminating such interests, has been approved by the Commission.

LEASE

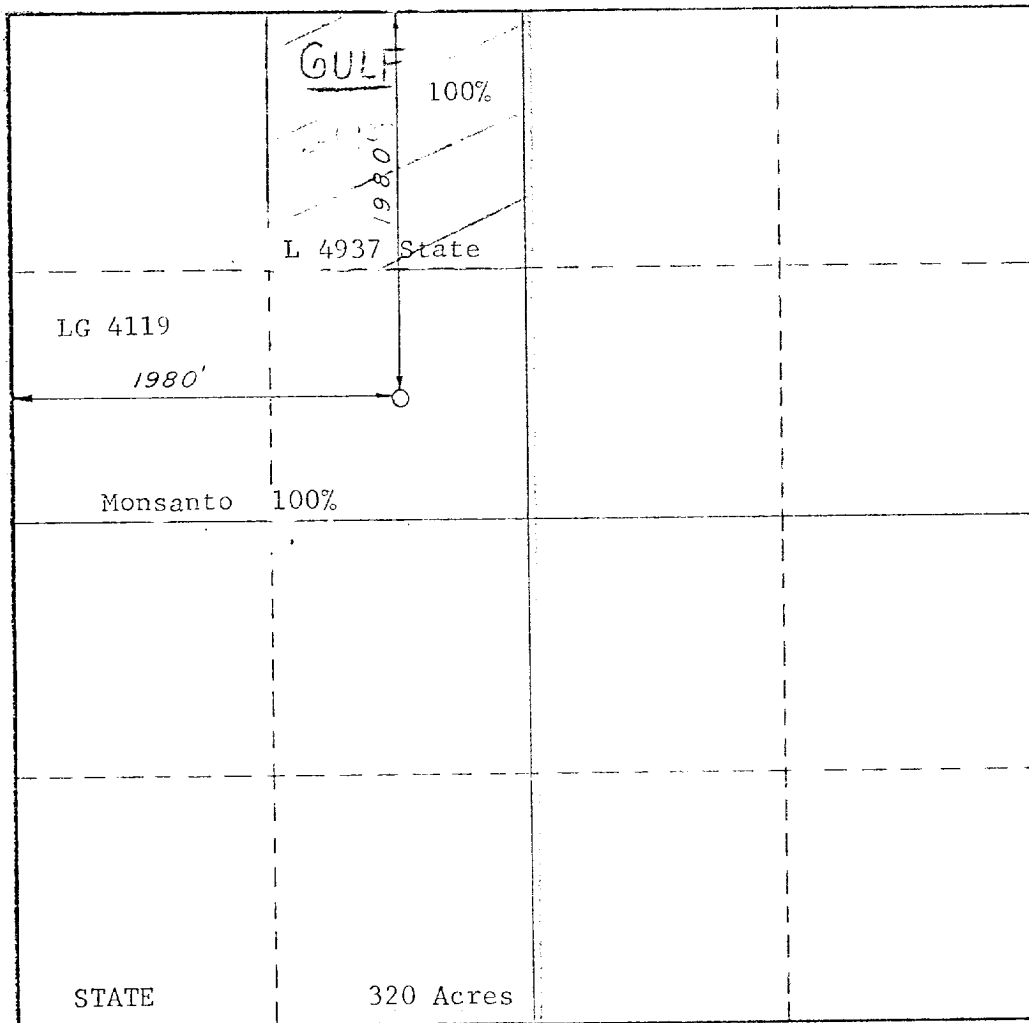

CERTIFICATION

I hereby certify that the information contained herein is true and complete to the best of my knowledge and belief.

Name
E. M. Scholl

Position
Regional Production Mgr.

Company
Monsanto Company

Date
July 25, 1977

I hereby certify that the well location shown on this plat was plotted from field notes of actual surveys made by me or under my supervision, and that the same is true and correct to the best of my knowledge and belief.

July 15, 1977

Date Surveyed
Richard B. Duniven

Registered Professional Engineer and/or Land Surveyor

[Signature]

Certificate No.

4882

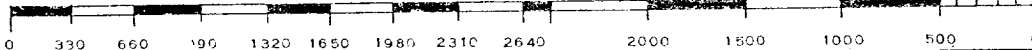

LAKEWOOD STATE COM. WELL NO. 1

MUD PROGRAM

Surface:	<u>0 - 500'</u> Fresh water gel/lime slurry.
Intermediate:	<u>500 - 1400'</u> Fresh water with LCM for seepage if required.
Production:	<u>1400' - T.D.</u> Fresh water to 7000'. At 7000' mud up with low solids, non- dispersed fresh water system. Weight and viscosity will be ad- justed to contain the formation fluids. The water loss will be decreased to 5 cc or less before drilling the Morrow.

THE BLOWOUT PREVENTER STACK

5,000 psi Working Pressure

