

STANDARD FORM NO. 6	6
SECTION	
COUNTY	1
WELL	1
W.C.O.S.	2
LAND OFFICE	1
OPERATOR	1

RECEIVED  
NEW MEXICO OIL CONSERVATION COMMISSION

OCT 17 1977

O. C. C.  
ARTESIA, OFFICE

30-015-22319  
Form O-10  
Revised 1-1-65

5A. Indicate Type of Lease	STATE <input checked="" type="checkbox"/>	FILE <input type="checkbox"/>
5. State Oil & Gas Lease No.	K-3153	

APPLICATION FOR PERMIT TO DRILL, DEEPEN, OR PLUG BACK

1. Type of Work	2. Unit Agreement Name
3. Type of Well OIL WELL <input type="checkbox"/> GAS WELL <input checked="" type="checkbox"/> OTHER <input type="checkbox"/>	7. Unit Agreement Name Parkway West
4. Name of Operator The Petroleum Corporation	8. Farm or Lease Name Parkway West Unit
5. Address of Operator 3303 Lee Parkway, Dallas, Texas 75219	9. Well No. 4
6. Location of Well UNIT LETTER C LOCATED 660 FEET FROM THE North LINE 1900 FEET FROM THE West LINE OF SEC. 20 TWP. 19S RGE. 29E NMPM	10. Field and Pool, or Wildcat West Parkway Morrow Gas
11. Elevation (Shall whether DP, RI, etc.) CL 3547	12. County Eddy
13. Proposed Depth 11,500	14. Formation Morrow
15. Kind & Status Plug Back \$50,000	16. Rotary or C.T.R. Rotary
17. Drilling Contractor Hondo Drilling Co	18. Approx. Date Work will start Oct. 25, 1977

PROPOSED CASING AND CEMENT PROGRAM

SIZE OF HOLE	SIZE OF CASING	WEIGHT PER FOOT	SETTING DEPTH	SACKS OF CEMENT	EST. TOP
18	11-3/4"	47	350-400	500	Circulate
12	8-5/8"	24 & 28	3,500	1,000	Base of Gas
7-7/8"	5-1/2"	17 & 20	11,500	750	Surface

Adequate BOP's to be installed from 350 feet to total depth.

See attachment

Drilled to  
855' depth  
Cemented to 11,500'

Gas is liberated

APPROVAL VALID  
FOR 90 DAYS UNLESS  
DRILLING COMMENCED,

EXPIRES 1-18-78

IN ABOVE SPACE DESCRIBE PROPOSED PROGRAM: IF PROPOSAL IS TO DEEPEN OR PLUG BACK, GIVE DATA ON PRESENT PRODUCTIVE ZONE AND PROPOSED NEW PRODUCTIVE ZONE. GIVE SLOWOUT PREVENTER PROGRAM, IF ANY.

I hereby certify that the information above is true and complete to the best of my knowledge and belief.

Signed Don Parker Title Vice President of Operations Date October 4, 1977

(This space for State Use)

APPROVED BY W.A. Gressett TITLE SUPERVISOR, DISTRICT II DATE OCT 18 1977

CONDITIONS OF APPROVAL, IF ANY:

Cement must be circulated to  
surface behind 11 3/4" casing

NEW MEXICO OIL CONSERVATION COMMISSION  
WELL LOCATION AND ACREAGE DEDICATION PLAT

Form 70-1  
Supersedes 6-1-78  
Effective 1-1-78

All distances must be from the outer boundaries of the Section

Operator <b>The Petroleum Corporation</b>		Lease <b>Parkway West</b>		Well No. <b>4</b>
Section <b>C</b>	Section <b>20</b>	Township <b>19 South</b>	Range <b>29 East</b>	County <b>Eddy</b>
Actual Placement Location of Well: <b>660</b> feet from the <b>North</b> line and <b>1980</b> feet from the <b>West</b> line				
Ground Level Elev. <b>3547.1</b>	Producing Formation <b>Morrow</b>	Pool <b>West Parkway Morrow Gas</b>	Estimated Acreage <b>320</b>	

1. Outline the acreage dedicated to the subject well by colored pencil or hachure marks on the plat below.
2. If more than one lease is dedicated to the well, outline each and identify the ownership thereof (both as to working interest and royalty).
3. If more than one lease of different ownership is dedicated to the well, have the interests of all owners been consolidated by communitization, unitization, force-pooling, etc?

☐ Yes ☐ No If answer is "yes," type of consolidation \_\_\_\_\_

If answer is "no," list the owners and tract descriptions which have actually been consolidated (Use reverse side of this form if necessary.) \_\_\_\_\_

No allowable will be assigned to the well until all interests have been consolidated (by communitization, unitization, forced-pooling, or otherwise) or until a non-standard unit, eliminating such interests, has been approved by the Commission.

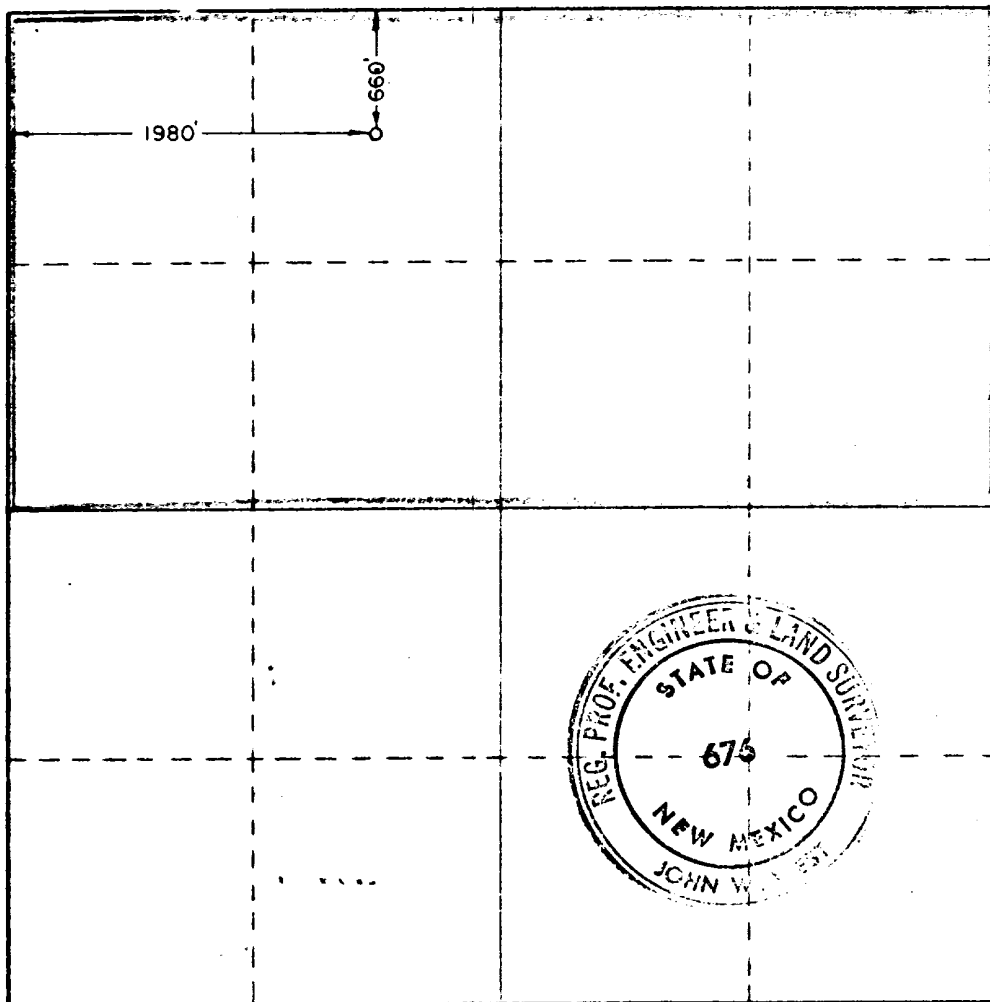

CERTIFICATION

I hereby certify that the information contained herein is true and complete to the best of my knowledge and belief.

Name  
**Don F. Tankersley**  
Position  
**Vice Pres. of Operations**  
Company  
**The Petroleum Corporation**  
Date  
**October 3, 1977**

I hereby certify that the well location shown on this plat was plotted from field notes of actual surveys made by me or under my supervision, and that the same is true and correct to the best of my knowledge and belief.

*John W. West*  
Date Surveyed

**August 16, 1977**

Registered Professional Engineer and/or Land Surveyor

*John W. West*  
Certificate No. **676**

0 330 660 990 1320 1650 1980 2310 2640 2970 3300 3630 3960 4290 4620 4950 5280 5610 5940 6270 6600

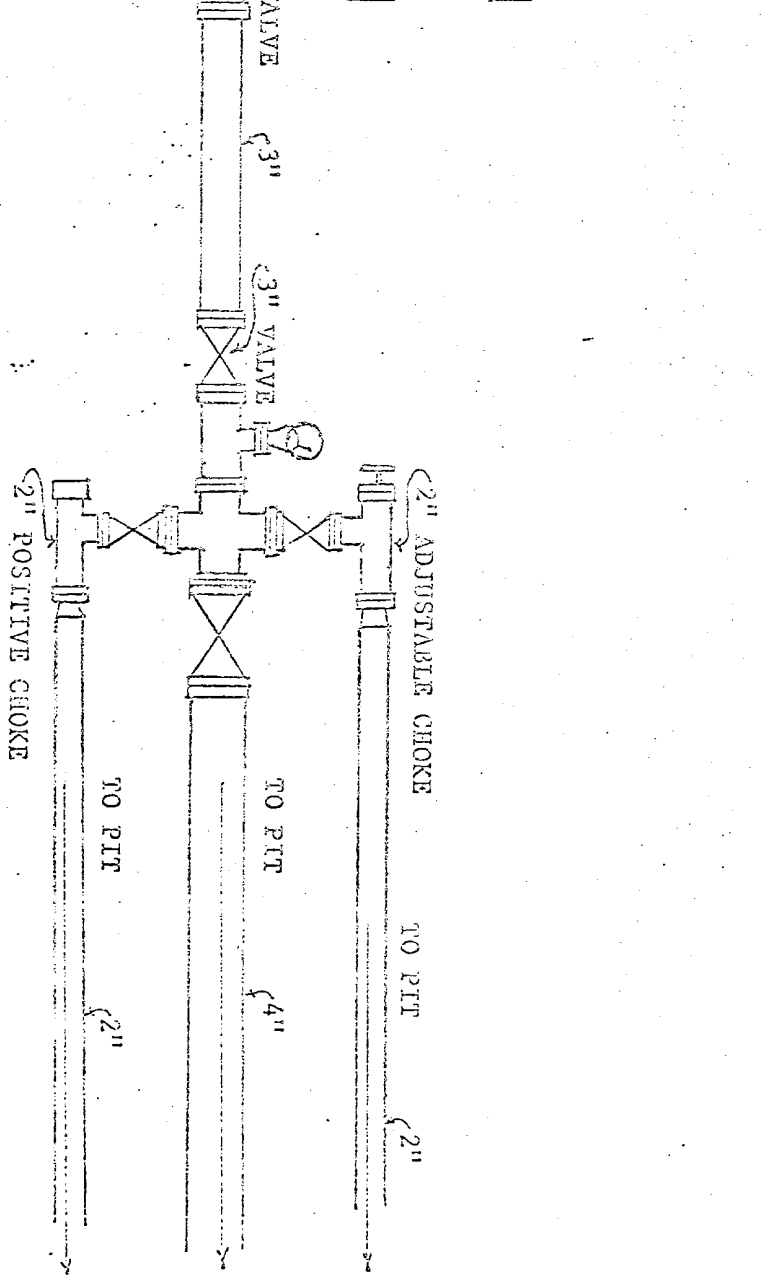
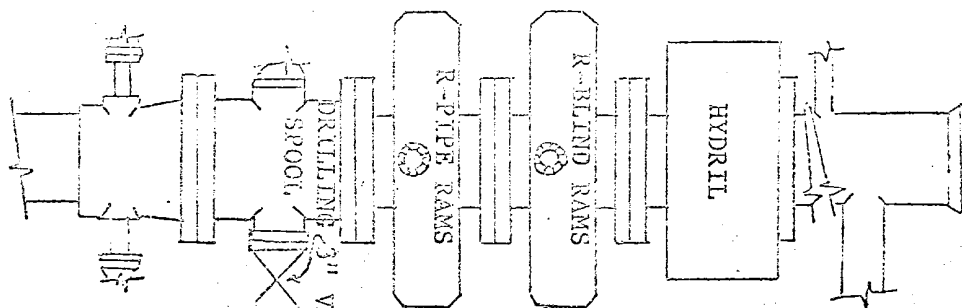

HONDO DRILLING COMPANY  
 RIG  
 BLOW OUT PREVENTION EQUIPMENT  
 10" 900s ALL FLANGED CONNECTIONS  
 3,000# WORKING PRESSURE - 6,000# TEST



DIRECTOR  
JOE D. RAMEY

## OIL CONSERVATION COMMISSION

STATE OF NEW MEXICO  
P. O. DRAWER DD - ARTESIA  
88210

LAND COMMISSIONER  
PHIL R. LUCERO

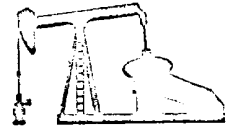

STATE GEOLOGIST  
EMERY C. ARNOLD

October 13, 1977

The Petroleum Corporation  
3303 Lee Parkway  
Dallas, TX 75219

Re: Parkway West Unit  
#4-C-20-19-29  
Eddy County, NM

Gentlemen:

We are returning the enclosed Forms C-101 on the subject well for additional information.

The surface casing should be set at top of the salt. Also show your BOP program and comply with the enclosed memo.

If you have any questions concerning this matter, please feel free to call upon me.

Sincerely yours,

A handwritten signature in cursive script, reading "W.A. Gressett".

W.A. Gressett  
Supervisor, District II

WAG:sm

Enclosures

MC TOPS LLB

← Penn - 7858  
Straun - 10142  
Atoka - 10466  
Morls - 10913  
Morcl - 11007

1/30/78  
Dual Laterolog  
9000 - 11428

2/24/78  
Dual Laterolog  
9000 11428

3/6/78  
Compensated Neutron-  
Formation Density  
0 - 11,441