

UNITED STATES
DEPARTMENT OF THE INTERIOR
GEOLOGICAL SURVEY

30-015-22365

APPLICATION FOR PERMIT TO DRILL, DEEPEN, OR PLUG BACK

1a. TYPE OF WORK

DRILL ☐ Re-EntryDEEPEN ☐PLUG BACK ☐

b. TYPE OF WELL

OIL
WELL ☒GAS
WELL ☐

OTHER

SINGLE
ZONE ☒MULTIPLE
ZONE ☐

2. NAME OF OPERATOR

Yates Petroleum Corporation ✓

3. ADDRESS OF OPERATOR

207 South 4th Street, Artesia, New Mexico 88210

4. LOCATION OF WELL (Report location clearly and in accordance with any State requirements.)*

At surface

2310' FWL and 660' FSL (Unit N Section 15)

At proposed prod. zone

14. DISTANCE IN MILES AND DIRECTION FROM NEAREST TOWN OR POST OFFICE*

Approximately 22 miles southwest of Artesia, New Mexico

15. DISTANCE FROM PROPOSED*

LOCATION TO NEAREST
PROPERTY OR LEASE LINE, FT.
(Also to nearest drilg. unit line, if any)

16. NO. OF ACRES IN LEASE

17. NO. OF ACRES ASSIGNED
TO THIS WELL

40

18. DISTANCE FROM PROPOSED LOCATION*
TO NEAREST WELL, DRILLING, COMPLETED,
OR APPLIED FOR, ON THIS LEASE, FT.

19. PROPOSED DEPTH

3200'

20. ROTARY OR CABLE TOOLS

Rotary

21. ELEVATIONS (Show whether DF, RT, GR, etc.)

3680 GR

22. APPROX. DATE WORK WILL START*

October 15, 1979

23.

PROPOSED CASING AND CEMENTING PROGRAM

SIZE OF HOLE	SIZE OF CASING	WEIGHT PER FOOT	SETTING DEPTH	QUANTITY OF CEMENT
17 1/2"	13 3/8	48	210'	200 SX
12 1/4"	8 5/8	24	1990'	920 SX
7 7/8"	5 1/2	15.5 & 17	8931'	2150 SX

This plugged and abandoned well was drilled to 8931' by Amco Production Company and was designated as Yates Federal No. 1, P & A'd March 6, 1979.

We plan to re-enter the subject well, clean out to +3200, test the 5 1/2" casing, perforate the Yeso formation and stimulate as necessary prior to placing on production.

Yates will hereafter designate the well as Allison "CQ" No. 3.

RECEIVED

OCT 11 1979

U.S. GEOLOGICAL SURVEY
ARTESIA, NEW MEXICO

IN ABOVE SPACE DESCRIBE PROPOSED PROGRAM: If proposal is to deepen or plug back, give data on present productive zone and proposed new productive zone. If proposal is to drill or deepen directionally, give pertinent data on subsurface locations and measured and true vertical depths. Give blowout preventer program, if any.

24.

SIGNED

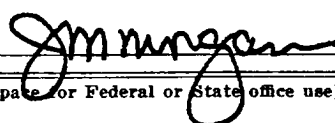

TITLE

Engineer

DATE

10/11/79

(This space for Federal or State office use)

PERMIT NO.

APPROVAL DATE

10-30-79

APPROVED BY

TITLE

CONDITIONS OF APPROVAL, IF ANY:

RECEIVED

OCT 31 1979

*See Instructions On Reverse Side

O. C. C.
ARTESIA, OFFICE

NEW MEXICO OIL CONSERVATION COMMISSION
WELL LOCATION AND ACREAGE DEDICATION PLAT

Form C-102
Supersedes C-128
Effective 1-4-65

All distances must be from the outer boundaries of the Section.

Operator Yates Petroleum Corporation			Lease Allison "CQ"		Well No. 3
Unit Letter N	Section 15	Township 19	Range 24	County Eddy	
Actual Footage Location of Well: 2310 feet from the West line and 660 feet from the South line					
Ground Level Elev: 3680	Producing Formation Yeso		Pool Undesignated		Dedicated Acreage: 40 Acres

1. Outline the acreage dedicated to the subject well by colored pencil or hachure marks on the plat below.
2. If more than one lease is dedicated to the well, outline each and identify the ownership thereof (both as to working interest and royalty).
3. If more than one lease of different ownership is dedicated to the well, have the interests of all owners been consolidated by communitization, unitization, force-pooling, etc?

☐ Yes ☐ No If answer is "yes," type of consolidation _____

OCT 31 1979
D. C. C.
ARTESIA, OFFICE

If answer is "no," list the owners and tract descriptions which have actually been consolidated. (Use reverse side of this form if necessary.) _____

No allowable will be assigned to the well until all interests have been consolidated (by communitization, unitization, forced-pooling, or otherwise) or until a non-standard unit, eliminating such interests, has been approved by the Commission.

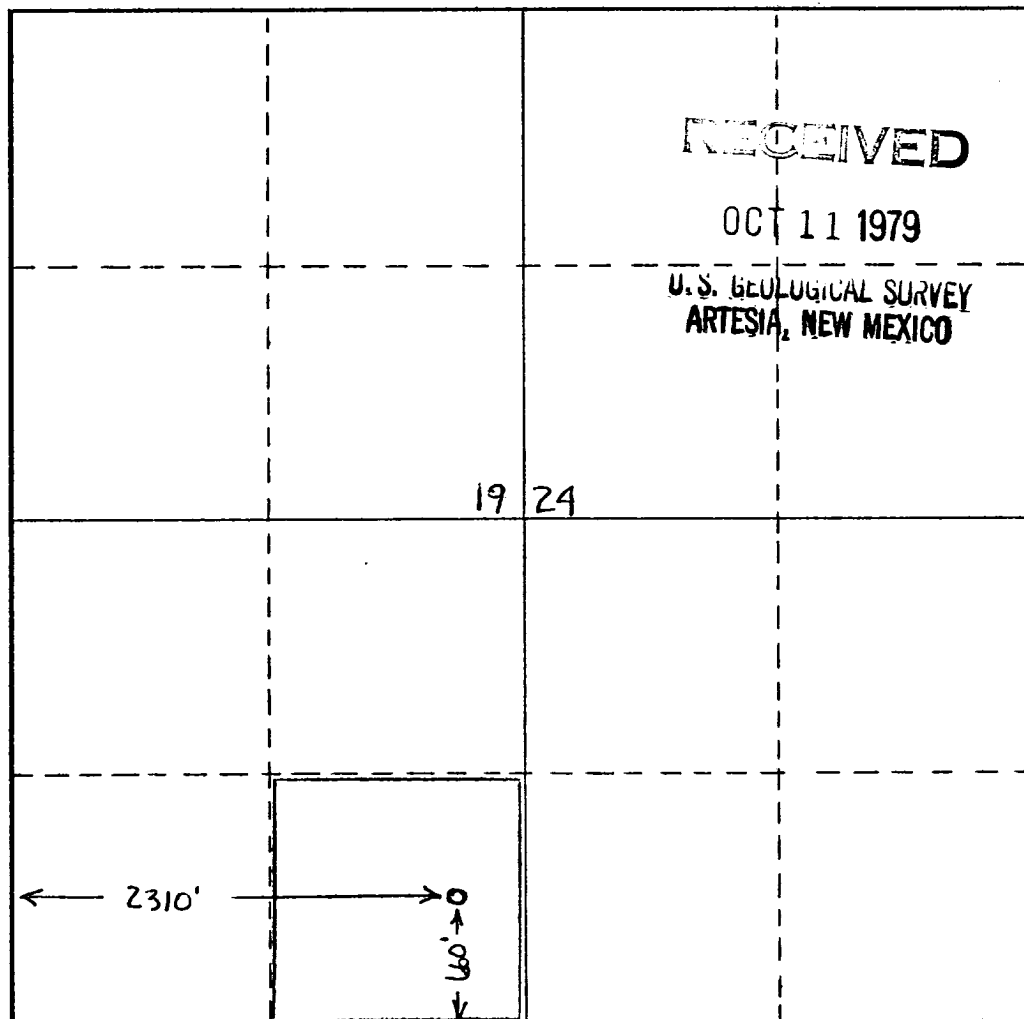

CERTIFICATION

I hereby certify that the information contained herein is true and complete to the best of my knowledge and belief.

Name
[Signature]
Position
Engineer
Company
Yates Petroleum Corporation
Date
October 11, 1979

I hereby certify that the well location shown on this plat was plotted from field notes of actual surveys made by me or under my supervision, and that the same is true and correct to the best of my knowledge and belief.

Date Surveyed
Registered Professional Engineer and/or Land Surveyor
Certificate No.

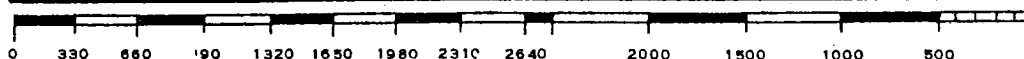



COPY

United States Department of the Interior

GEOLOGICAL SURVEY

P. O. Drawer U
Artesia, New Mexico 88210

RECEIVED

OCT 31 1979

O. C. C.
ARTESIA, OFFICE

October 30, 1979

Yates Petroleum Corporation
207 South Fourth Street
Artesia, New Mexico 88210

Gentlemen:

YATES PETROLEUM CORPORATION
Allison CQ No. 3
660 FSL 2310 FWL Sec. 15 T.19S R.24E
Eddy County Lease No. NM 14118

Above Data Required on Well Sign

Your APPLICATION FOR PERMIT TO RE-ENTER the above-described well to test the Yeso formation is hereby approved subject to compliance with the OIL AND GAS OPERATING REGULATIONS (30 CFR 221) and the following conditions:

1. Drilling operations authorized are subject to compliance with the GENERAL REQUIREMENTS FOR OIL AND GAS OPERATIONS ON FEDERAL LEASES, dated July 1, 1978.
2. Prior to commencing construction of road, pad, or other associated developments, operator will provide the dirt contractor with a copy of the SURFACE USE PLAN and this approval including the GENERAL REQUIREMENTS.
3. Submit a Daily Report of Operations from spud date until the Well Completion Report (form 9-330) is filed. The progress report should be not less than 8" x 5" in size and each page should identify the well.
4. All permanent above-ground structures and equipment shall be painted in accordance with the attached Painting Requirements. The color used should simulate Sandstone Brown (Federal Standard No. 595A, color 20318 or 30318).
5. Please have anyone contacting the Survey in regard to this well to identify the well with all of the information required above for the well sign.

Sincerely yours,

GEORGE H. STEWART

George H. Stewart
Acting District Engineer



APPLICATION TO RE-ENTER
Yates Petroleum Corporation

Allison "CQ" No. 3

2310' FWL and 660' FSL
Section 15-T19-R24E
Eddy County, New Mexico

RECEIVED
OCT 18 1979
U.S. GEOLOGICAL SURVEY
ARTESIA, NEW MEXICO

In conjunction with Form 9-331C, Application for Permit to Drill subject well, Yates Petroleum Corporation submits the following items of pertinent information in accordance with USGS requirements:

1. The geologic surface formation is quaternary alluvium.
2. The estimated tops of geologic markers are as follows:
 San Andres 400'
 Glorieta 1,850'
3. The estimated depths at which water, oil, or gas formations are expected to be are behind the existing 8 5/8" casing.
4. Proposed Casing Program: See Form 9-331C.
5. Pressure control equipment: BOP's, pipe rams tested daily, blind rams on trips.
6. Mud Program: 3% KCL water
7. Auxiliary Equipment: None
8. Testing, logging, and coring program: Gamma Ray-Neutron
9. No abnormal pressures or temperatures are anticipated.
10. Anticipated starting date: As soon as approved.

MULTI-JOINT SURFACE USE AND OPERATIONS PLAN
Yates Petroleum Corporation
Allison CQ No. 3
2310' FWL and 660' FSL
Section 15-T19S-R24E
Eddy County, New Mexico
(Re-Entry Well)

This plan is submitted in conjunction with Form 9-331C, Sundry Notice covering the re-entry of the subject well. This well was originally drilled by Amoco Production Company as their Yates Federal No. 1. The proposed re-construction activities and operations plan, the surface disturbance involved, and the procedures to be followed in rehabilitating the surface after completion of the operations are included to enhance an appraisal of the environment associated with the operation.

1. EXISTING ROADS.

- A. Exhibit A is a portion of BLM quad color map No. SE-23, on a scale of $\frac{1}{4}$ " to a mile showing the proposed location and the surrounding area. Exhibit B is a portion of a USGS topographic map on a scale of 1" to a mile, showing the area and the roads in the immediate vicinity of the proposed location. The proposed wellsite is located approximately 22 miles south and east of Artesia, New Mexico and the access route to the location is indicated in yellow on Exhibit A.

1. Proceed south from Artesia on U.S. 285 for a distance of approximately 12 miles. Turn west on the caliche road proceed west for 10.6 miles. The planned re-constructed access road will begin at this point.

2. PLANNED ACCESS ROADS.

- A. From the existing caliche road, the re-constructed access road will be the same as the original. The road will be 660' long and 12' wide.

3. LOCATION OF EXISTING WELLS.

- A. All existing wells within one mile radius are shown on Exhibit C.

4. LOCATION OF PROPOSED PRODUCTION FACILITIES:

- A. There are no production facilities on this lease at the present time.
B. If the well is commercially productive, the necessary facilities will be installed on the drilling pad.

5. LOCATION AND TYPE OF WATER SUPPLY.

- A. Both KCL and fresh water will be trucked by Jim's Water Service of Artesia, New Mexico.

6. SOURCE OF CONSTRUCTION MATERIALS.

- A. The existing access road and drilling pad will be used.

7. METHODS OF HANDLING WASTE DISPOSAL.

- A. Drill cuttings will be disposed of in portable steel pits.
- B. Drilling fluids will be collected in tanks until hauled to an approved disposal system.
- C. Oil produced will be collected in tanks until sold.
- D. Current laws and regulations pertaining to the disposal of human waste will be complied with.
- E. Trash, waste paper, garbage and junk will be buried or removed from the wellsite within 30 days after completing operations.

8. ANCILLARY FACILITIES.

- A. No camps, airstrips, etc. will be needed.

9. WELLSITE LAYOUT.

- A. Exhibit D shows relative location and dimensions of the wellsite area.
- B. The access road will joint the southeast corner of the pad.

10. PLANS FOR RESTORATION OF THE SURFACE.

- A. After finishing completion operations, all equipment and other material not needed for further operations will be removed. The entire location will be cleared of all trash and junk to leave the wellsite in as aesthetically pleasing condition as possible.
- B. Unguarded pits, if any, containing fluids will be fenced until they have been filled.
- C. If the proposed well is not productive, all rehabilitation and or/vegetation requirements of the BLM and the USGS will be complied with and will be accomplished as soon as possible. All pits will be filled and leveled within 90 days of abandonment.

11. OTHER INFORMATION.

- A. Topography: Local topography is distinguished by an undulating plain with shallow loamy soils. This location is underlain by caliche bedrock.
- B. Flora and Fauna: The dominant species at this location is Gutierrezia sarothrae. Other species include Opuntia spp., Sporobolus cryptandrus, Bouteloua eriopoda, and Agropyron Smithii.
- C. There are no ponds, lakes, streams, or rivers in the area.
- D. There are no inhabited dwellings in the vicinity of the proposed well. There is an abandoned house and a windmill approximately 1/2 mile south of the wellsite.
- E. Surface Ownership: The wellsite is on federal surface.

F. There is no evidence of any archeological, historical or cultural sites in the area. The archeological report was completed in October 1977 and submitted with the original application.

12. OPERATOR'S REPRESENTATIVE.

A.* The field representative responsible for assuring compliance with the approved surface use and operations plan is:

Johnny M. Morgan
Yates Petroleum Corporation
207 South 4th Street
Artesia, New Mexico 88210
Telephone: (505) 746-3558

13. CERTIFICATION.

I hereby certify that I, or persons under my direct supervision, have inspected the proposed drillsite and access route; that I am familiar with the conditions which presently exist; that the statements made in this plan are to the best of my knowledge true and correct; and that the work associated with operations proposed herein will be performed by Yates Petroleum Corporation and its contractors and subcontractors in conformity with this plan and the terms and conditions under which it is approved.

October 16, 1979

Date



Johnny M. Morgan, Engineer

EXHIBIT A

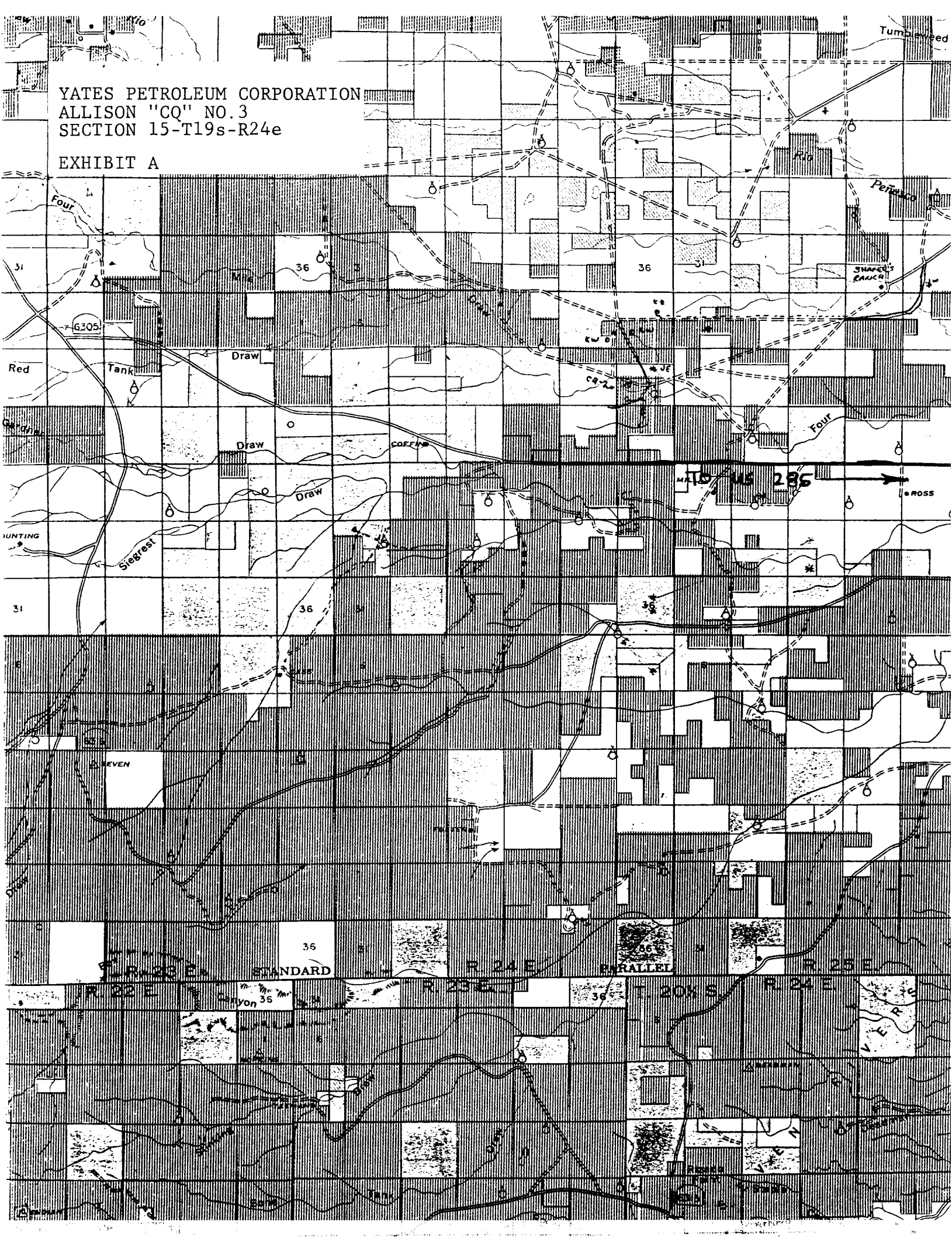

YATES PETROLEUM CORPORATION
ALLISON "CQ" NO. 3
SECTION 15-T19s-R24e

EXHIBIT B

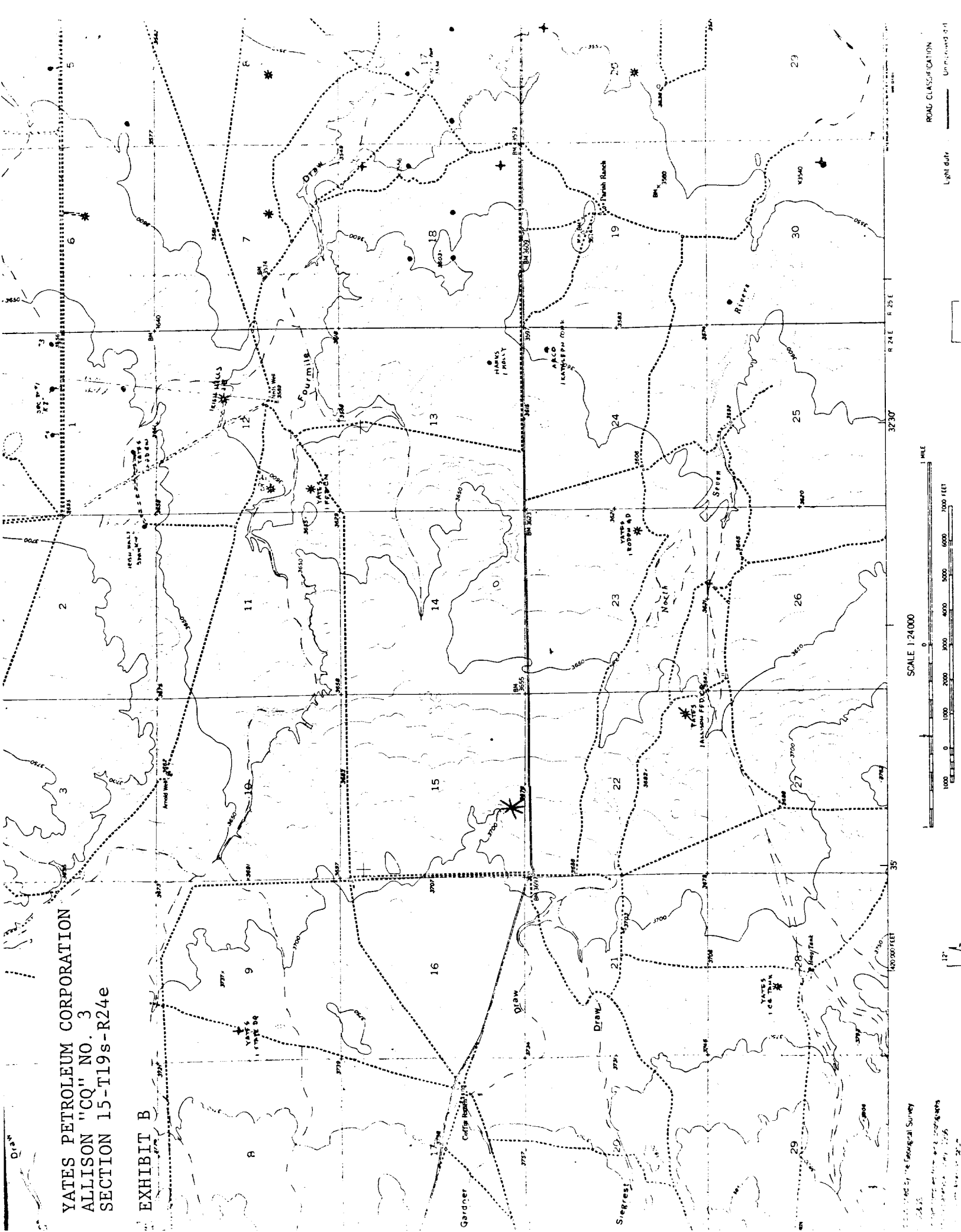

YATES PETROLEUM CORPORATION
ALLISON "CQ" NO. 3
SECTION 15-T19s-R24e

EXHIBIT C

<p>Superior 0129426 Texas Amer. to 9715'</p> <p>5 Texas Amer. to 675'</p> <p>US</p>	<p>Superior 0129426 Texas Amer. to 9715'</p> <p>4 Texas Amer. to 675'</p> <p>US</p>	<p>Yates Pet. HBP 0553263</p> <p>HNG3/4 Rockies Ltd. 1/4 6-1-78 6026</p> <p>State</p>	<p>Read & Stevens 6-16-80 L-4609 1625</p> <p>State</p>	<p>Allied Chem. L-2764 3033</p> <p>State</p>	<p>So. Roy. 5-20-79 L-2519 3527</p> <p>State</p>
<p>Exxon 9-1-84 L-2019 1065</p> <p>Amoco 2-18-79 L-2472 3373</p> <p>Amoco 2-18-79 L-2472 3373</p> <p>State</p>	<p>Pennzoil 12-1-86 L-2350 2617</p> <p>Pennzoil 12-1-86 L-2350 2617</p> <p>State</p>	<p>Yates Pet. et al. 5-1-86 L-2354 3676</p> <p>Yates Pet. 1-21-79 L-2330 2617</p> <p>State</p>	<p>Amoco 4-1-83 L-1131 1639</p> <p>Amoco 4-1-83 L-1131 1639</p> <p>State</p>	<p>Allied Chem. 8-1-74 0554472 U.S.</p> <p>Great Western, Oavill 3579 L-1-81 L-6887 2128</p> <p>State</p>	<p>Yates Pet. 1-21-79 L-2330 2617</p> <p>Yates Pet. 1-21-79 L-2330 2617</p> <p>State</p>
<p>Sun 6-7901</p> <p>State</p>	<p>Marathon 2-16-74 HBU E-7901</p> <p>State</p>	<p>Amoco 9-16-79 L-3527 3222</p> <p>Yates Pet. et al. 4-1-86 L-3481 1013</p> <p>State</p>	<p>Amoco 12-15-80 L-3527 3222</p> <p>Yates Pet. 1-21-79 L-2330 2617</p> <p>State</p>	<p>Amoco (Yates Pet.) M110</p> <p>State</p>	<p>HNG Oil 12-11-78 L-1-82 3-25-82 3-21-82 3-7-82</p> <p>State</p>
<p>Tom Brown Antelope Sink Unit</p> <p>State</p>	<p>Ellis Anulick, M.I. Earl Ancell</p> <p>State</p>	<p>Amoco 12-15-80 L-3527 3222</p> <p>Yates Pet. et al. 4-1-86 L-3481 1013</p> <p>State</p>	<p>Amoco 12-15-80 L-3527 3222</p> <p>Yates Pet. 1-21-79 L-2330 2617</p> <p>State</p>	<p>Amoco (Yates Pet.) M110</p> <p>State</p>	<p>HNG Oil 12-11-78 L-1-82 3-25-82 3-21-82 3-7-82</p> <p>State</p>
<p>So. Roy. 12-1-81 L-533 2073</p> <p>State</p>	<p>Exxon 12-1-85 L-6577 10633</p> <p>State</p>	<p>Yates Pet. et al. 3-1-71 L-2350 2617</p> <p>State</p>	<p>Yates Pet. HBP M118</p> <p>State</p>	<p>Yates Pet. HBP M118</p> <p>State</p>	<p>Yates Pet. HBP M118</p> <p>State</p>
<p>Southland Roy. 2-1-81 L-5153 2073</p> <p>State</p>	<p>Pennzoil 2-1-81 L-5154 2162</p> <p>State</p>	<p>Yates Pet. et al. 4-12-86</p> <p>State</p>	<p>Yates Pet. et al. 4-12-86</p> <p>State</p>	<p>Yates Pet. HBP M118</p> <p>State</p>	<p>Yates Pet. HBP M118</p> <p>State</p>
<p>So. Roy. 1-15-78 N/2, HBC L-2647 Morrow Disc. 27M.L.</p> <p>State</p>	<p>Amoco 5-1-81 13621</p> <p>State</p>	<p>(Gulf) R.C. Hanks 0559774</p> <p>Yates Pet. HBP M118</p> <p>State</p>	<p>Yates Pet. HBP M118</p> <p>State</p>	<p>Yates Pet. HBP M118</p> <p>State</p>	<p>Yates Pet. HBP M118</p> <p>State</p>
<p>Yates 6-1-78 6027</p> <p>State</p>	<p>Yates Pet. HBP M118</p> <p>State</p>	<p>Yates Pet. HBP M118</p> <p>State</p>	<p>Yates Pet. HBP M118</p> <p>State</p>	<p>Yates Pet. HBP M118</p> <p>State</p>	<p>Yates Pet. HBP M118</p> <p>State</p>
<p>Gulf 1-1-76 201</p> <p>State</p>	<p>MITCHELL ENERGY 3-20-81 LA-6459 15625</p> <p>State</p>	<p>Gulf HBP 0559775</p> <p>State</p>	<p>Yates Pet. HBP M118</p> <p>State</p>	<p>Yates Pet. HBP M118</p> <p>State</p>	<p>Yates Pet. HBP M118</p> <p>State</p>
<p>Gulf 1-1-76 201</p> <p>State</p>	<p>MITCHELL ENERGY 3-20-81 LA-6459 15625</p> <p>State</p>	<p>Gulf HBP 0559775</p> <p>State</p>	<p>Yates Pet. HBP M118</p> <p>State</p>	<p>Yates Pet. HBP M118</p> <p>State</p>	<p>Yates Pet. HBP M118</p> <p>State</p>
<p>Gulf 1-1-76 201</p> <p>State</p>	<p>MITCHELL ENERGY 3-20-81 LA-6459 15625</p> <p>State</p>	<p>Gulf HBP 0559775</p> <p>State</p>	<p>Yates Pet. HBP M118</p> <p>State</p>	<p>Yates Pet. HBP M118</p> <p>State</p>	<p>Yates Pet. HBP M118</p> <p>State</p>
<p>Gulf 1-1-76 201</p> <p>State</p>	<p>MITCHELL ENERGY 3-20-81 LA-6459 15625</p> <p>State</p>	<p>Gulf HBP 0559775</p> <p>State</p>	<p>Yates Pet. HBP M118</p> <p>State</p>	<p>Yates Pet. HBP M118</p> <p>State</p>	<p>Yates Pet. HBP M118</p> <p>State</p>
<p>Gulf 1-1-76 201</p> <p>State</p>	<p>MITCHELL ENERGY 3-20-81 LA-6459 15625</p> <p>State</p>	<p>Gulf HBP 0559775</p> <p>State</p>	<p>Yates Pet. HBP M118</p> <p>State</p>	<p>Yates Pet. HBP M118</p> <p>State</p>	<p>Yates Pet. HBP M118</p> <p>State</p>
<p>Gulf 1-1-76 201</p> <p>State</p>	<p>MITCHELL ENERGY 3-20-81 LA-6459 15625</p> <p>State</p>	<p>Gulf HBP 0559775</p> <p>State</p>	<p>Yates Pet. HBP M118</p> <p>State</p>	<p>Yates Pet. HBP M118</p> <p>State</p>	<p>Yates Pet. HBP M118</p> <p>State</p>
<p>Gulf 1-1-76 201</p> <p>State</p>	<p>MITCHELL ENERGY 3-20-81 LA-6459 15625</p> <p>State</p>	<p>Gulf HBP 0559775</p> <p>State</p>	<p>Yates Pet. HBP M118</p> <p>State</p>	<p>Yates Pet. HBP M118</p> <p>State</p>	<p>Yates Pet. HBP M118</p> <p>State</p>
<p>Gulf 1-1-76 201</p> <p>State</p>	<p>MITCHELL ENERGY 3-20-81 LA-6459 15625</p> <p>State</p>	<p>Gulf HBP 0559775</p> <p>State</p>	<p>Yates Pet. HBP M118</p> <p>State</p>	<p>Yates Pet. HBP M118</p> <p>State</p>	<p>Yates Pet. HBP M118</p> <p>State</p>
<p>Gulf 1-1-76 201</p> <p>State</p>	<p>MITCHELL ENERGY 3-20-81 LA-6459 15625</p> <p>State</p>	<p>Gulf HBP 0559775</p> <p>State</p>	<p>Yates Pet. HBP M118</p> <p>State</p>	<p>Yates Pet. HBP M118</p> <p>State</p>	<p>Yates Pet. HBP M118</p> <p>State</p>
<p>Gulf 1-1-76 201</p> <p>State</p>	<p>MITCHELL ENERGY 3-20-81 LA-6459 15625</p> <p>State</p>	<p>Gulf HBP 0559775</p> <p>State</p>	<p>Yates Pet. HBP M118</p> <p>State</p>	<p>Yates Pet. HBP M118</p> <p>State</p>	<p>Yates Pet. HBP M118</p> <p>State</p>
<p>Gulf 1-1-76 201</p> <p>State</p>	<p>MITCHELL ENERGY 3-20-81 LA-6459 15625</p> <p>State</p>	<p>Gulf HBP 0559775</p> <p>State</p>	<p>Yates Pet. HBP M118</p> <p>State</p>	<p>Yates Pet. HBP M118</p> <p>State</p>	<p>Yates Pet. HBP M118</p> <p>State</p>
<p>Gulf 1-1-76 201</p> <p>State</p>	<p>MITCHELL ENERGY 3-20-81 LA-6459 15625</p> <p>State</p>	<p>Gulf HBP 0559775</p> <p>State</p>	<p>Yates Pet. HBP M118</p> <p>State</p>	<p>Yates Pet. HBP M118</p> <p>State</p>	<p>Yates Pet. HBP M118</p> <p>State</p>
<p>Gulf 1-1-76 201</p> <p>State</p>	<p>MITCHELL ENERGY 3-20-81 LA-6459 15625</p> <p>State</p>	<p>Gulf HBP 0559775</p> <p>State</p>	<p>Yates Pet. HBP M118</p> <p>State</p>	<p>Yates Pet. HBP M118</p> <p>State</p>	<p>Yates Pet. HBP M118</p> <p>State</p>
<p>Gulf 1-1-76 201</p> <p>State</p>	<p>MITCHELL ENERGY 3-20-81 LA-6459 15625</p> <p>State</p>	<p>Gulf HBP 0559775</p> <p>State</p>	<p>Yates Pet. HBP M118</p> <p>State</p>	<p>Yates Pet. HBP M118</p> <p>State</p>	<p>Yates Pet. HBP M118</p> <p>State</p>
<p>Gulf 1-1-76 201</p> <p>State</p>	<p>MITCHELL ENERGY 3-20-81 LA-6459 15625</p> <p>State</p>	<p>Gulf HBP 0559775</p> <p>State</p>	<p>Yates Pet. HBP M118</p> <p>State</p>	<p>Yates Pet. HBP M118</p> <p>State</p>	<p>Yates Pet. HBP M118</p> <p>State</p>
<p>Gulf 1-1-76 201</p> <p>State</p>	<p>MITCHELL ENERGY 3-20-81 LA-6459 15625</p> <p>State</p>	<p>Gulf HBP 0559775</p> <p>State</p>	<p>Yates Pet. HBP M118</p> <p>State</p>	<p>Yates Pet. HBP M118</p> <p>State</p>	<p>Yates Pet. HBP M118</p> <p>State</p>
<p>Gulf 1-1-76 201</p> <p>State</p>	<p>MITCHELL ENERGY 3-20-81 LA-6459 15625</p> <p>State</p>	<p>Gulf HBP 0559775</p> <p>State</p>	<p>Yates Pet. HBP M118</p> <p>State</p>	<p>Yates Pet. HBP M118</p> <p>State</p>	<p>Yates Pet. HBP M118</p> <p>State</p>
<p>Gulf 1-1-76 201</p> <p>State</p>	<p>MITCHELL ENERGY 3-20-81 LA-6459 15625</p> <p>State</p>	<p>Gulf HBP 0559775</p> <p>State</p>	<p>Yates Pet. HBP M118</p> <p>State</p>	<p>Yates Pet. HBP M118</p> <p>State</p>	<p>Yates Pet. HBP M118</p> <p>State</p>
<p>Gulf 1-1-76 201</p> <p>State</p>	<p>MITCHELL ENERGY 3-20-81 LA-6459 15625</p> <p>State</p>	<p>Gulf HBP 0559775</p> <p>State</p>	<p>Yates Pet. HBP M118</p> <p>State</p>	<p>Yates Pet. HBP M118</p> <p>State</p>	<p>Yates Pet. HBP M118</p> <p>State</p>
<p>Gulf 1-1-76 201</p> <p>State</p>	<p>MITCHELL ENERGY 3-20-81 LA-6459 15625</p> <p>State</p>	<p>Gulf HBP 0559775</p> <p>State</p>	<p>Yates Pet. HBP M118</p> <p>State</p>	<p>Yates Pet. HBP M118</p> <p>State</p>	<p>Yates Pet. HBP M118</p> <p>State</p>
<p>Gulf 1-1-76 201</p> <p>State</p>	<p>MITCHELL ENERGY 3-20-81 LA-6459 15625</p> <p>State</p>	<p>Gulf HBP 0559775</p> <p>State</p>	<p>Yates Pet. HBP M118</p> <p>State</p>	<p>Yates Pet. HBP M118</p> <p>State</p>	<p>Yates Pet. HBP M118</p> <p>State</p>
<p>Gulf 1-1-76 201</p> <p>State</p>	<p>MITCHELL ENERGY 3-20-81 LA-6459 15625</p> <p>State</p>	<p>Gulf HBP 0559775</p> <p>State</p>	<p>Yates Pet. HBP M118</p> <p>State</p>	<p>Yates Pet. HBP M118</p> <p>State</p>	<p>Yates Pet. HBP M118</p> <p>State</p>
<p>Gulf 1-1-76 201</p> <p>State</p>	<p>MITCHELL ENERGY 3-20-81 LA-6459 15625</p> <p>State</p>	<p>Gulf HBP 0559775</p> <p>State</p>	<p>Yates Pet. HBP M118</p> <p>State</p>	<p>Yates Pet. HBP M118</p> <p>State</p>	<p>Yates Pet. HBP M118</p> <p>State</p>
<p>Gulf 1-1-76 201</p> <p>State</p>	<p>MITCHELL ENERGY 3-20-81 LA-6459 15625</p> <p>State</p>	<p>Gulf HBP 0559775</p> <p>State</p>	<p>Yates Pet. HBP M118</p> <p>State</p>	<p>Yates Pet. HBP M118</p> <p>State</p>	<p>Yates Pet. HBP M118</p> <p>State</p>
<p>Gulf 1-1-76 201</p> <p>State</p>	<p>MITCHELL ENERGY 3-20-81 LA-6459 15625</p> <p>State</p>	<p>Gulf HBP 0559775</p> <p>State</p>	<p>Yates Pet. HBP M118</p> <p>State</p>	<p>Yates Pet. HBP M118</p> <p>State</p>	<p>Yates Pet. HBP M118</p> <p>State</p>
<p>Gulf 1-1-76 201</p> <p>State</p>	<p>MITCHELL ENERGY 3-20-81 LA-6459 15625</p> <p>State</p>	<p>Gulf HBP 0559775</p> <p>State</p>	<p>Yates Pet. HBP M118</p> <p>State</p>	<p>Yates Pet. HBP M118</p> <p>State</p>	<p>Yates Pet. HBP M118</p> <p>State</p>
<p>Gulf 1-1-76 201</p> <p>State</p>	<p>MITCHELL ENERGY 3-20-81 LA-6459 15625</p> <p>State</p>	<p>Gulf HBP 0559775</p> <p>State</p>	<p>Yates Pet. HBP M118</p> <p>State</p>	<p>Yates Pet. HBP M118</p> <p>State</p>	<p>Yates Pet. HBP M118</p> <p>State</p>
<p>Gulf 1-1-76 201</p> <p>State</p>	<p>MITCHELL ENERGY 3-20-81 LA-6459 15625</p> <p>State</p>	<p>Gulf HBP 0559775</p> <p>State</p>	<p>Yates Pet. HBP M118</p> <p>State</p>	<p>Yates Pet. HBP M118</p> <p>State</p>	<p>Yates Pet. HBP M118</p> <p>State</p>
<p>Gulf 1-1-76 201</p> <p>State</p>	<p>MITCHELL ENERGY 3-20-81 LA-6459 15625</p> <p>State</p>	<p>Gulf HBP 0559775</p> <p>State</p>	<p>Yates Pet. HBP M118</p> <p>State</p>	<p>Yates Pet. HBP M118</p> <p>State</p>	<p>Yates Pet. HBP M118</p> <p>State</p>
<p>Gulf 1-1-76 201</p> <p>State</p>	<p>MITCHELL ENERGY 3-20-81 LA-6459 15625</p> <p>State</p>	<p>Gulf HBP 0559775</p> <p>State</p>	<p>Yates Pet. HBP M118</p> <p>State</p>	<p>Yates Pet. HBP M118</p> <p>State</p>	<p>Yates Pet. HBP M118</p> <p>State</p>
<p>Gulf 1-1-76 201</p> <p>State</p>	<p>MITCHELL ENERGY 3-20-81 LA-6459 15625</p> <p>State</p>	<p>Gulf HBP 0559775</p> <p>State</p>	<p>Yates Pet. HBP M118</p> <p>State</p>	<p>Yates Pet. HBP M118</p> <p>State</p>	<p>Yates Pet. HBP M118</p> <p>State</p>
<p>Gulf 1-1-76 201</p> <p>State</p>	<p>MITCHELL ENERGY 3-20-81 LA-6459 15625</p> <p>State</p>	<p>Gulf HBP 0559775</p> <p>State</p>	<p>Yates Pet. HBP M118</p> <p>State</p>	<p>Yates Pet. HBP M118</p> <p>State</p>	<p>Yates Pet. HBP M118</p> <p>State</p>
<p>Gulf 1-1-76 201</p> <p>State</p>	<p>MITCHELL ENERGY 3-20-81 LA-6459 15625</p> <p>State</p>	<p>Gulf HBP 0559775</p> <p>State</p>	<p>Yates Pet. HBP M118</p> <p>State</p>	<p>Yates Pet. HBP M118</p> <p>State</p>	<p>Yates Pet. HBP M118</p> <p>State</p>
<p>Gulf 1-1-76 201</p> <p>State</p>	<p>MITCHELL ENERGY 3-20-81 LA-6459 15625</p> <p>State</p>	<p>Gulf HBP 0559775</p> <p>State</p>	<p>Yates Pet. HBP M118</p> <p>State</p>	<p>Yates Pet. HBP M118</p> <p>State</p>	<p>Yates Pet. HBP M118</p> <p>State</p>
<p>Gulf 1-1-76 201</p> <p>State</p>	<p>MITCHELL ENERGY 3-20-81 LA-6459 15625</p> <p>State</p>	<p>Gulf HBP 0559775</p> <p>State</p>	<p>Yates Pet. HBP M118</p> <p>State</p>	<p>Yates Pet. HBP M118</p> <p>State</p>	<p>Yates Pet. HBP M118</p> <p>State</p>
<p>Gulf 1-1-76 201</p> <p>State</p>	<p>MITCHELL ENERGY 3-20-81 LA-6459 15625</p> <p>State</p>	<p>Gulf HBP 0559775</p> <p>State</p>	<p>Yates Pet. HBP M118</p> <p>State</p>	<p>Yates Pet. HBP M118</p> <p>State</p>	<p>Yates Pet. HBP M118</p> <p>State</p>
<p>Gulf 1-1-76 201</p> <p>State</p>	<p>MITCHELL ENERGY 3-20-81 LA-6459 15625</p> <p>State</p>	<p>Gulf HBP 0559775</p> <p>State</p>	<p>Yates Pet. HBP M118</p> <p>State</p>	<p>Yates Pet. HBP M118</p> <p>State</p>	<p>Yates Pet. HBP M118</p> <p>State</p>
<p>Gulf 1-1-76 201</p> <p>State</p>	<p>MITCHELL ENERGY 3-20-81 LA-6459 15625</p> <p>State</p>	<p>Gulf HBP 0559775</p> <p>State</p>	<p>Yates Pet. HBP M118</p> <p>State</p>	<p>Yates Pet. HBP M118</p> <p>State</p>	<p>Yates Pet. HBP M118</p> <p>State</p>
<p>Gulf 1-1-76 201</p> <p>State</p>	<p>MITCHELL ENERGY 3-20-81 LA-6459 15625</p> <p>State</p>	<p>Gulf HBP 0559775</p> <p>State</p>	<p>Yates Pet. HBP M118</p> <p>State</p>	<p>Yates Pet. HBP M118</p> <p>State</p>	<p>Yates Pet. HBP M118</p> <p>State</p>
<p>Gulf 1-1-76 201</p> <p>State</p>	<p>MITCHELL ENERGY 3-20-81 LA-6459 15625</p> <p>State</p>	<p>Gulf HBP 0559775</p> <p>State</p>	<p>Yates Pet. HBP M118</p> <p>State</p>	<p>Yates Pet. HBP M118</p> <p>State</p>	<p>Yates Pet. HBP M118</p> <p>State</p>
<p>Gulf 1-1-76 201</p> <p>State</p>	<p>MITCHELL ENERGY 3-20-81 LA-6459 15625</p> <p>State</p>	<p>Gulf HBP 0559775</p> <p>State</p>	<p>Yates Pet. HBP M118</p> <p>State</p>	<p>Yates Pet. HBP M118</p> <p>State</p>	<p>Yates Pet. HBP M118</p> <p>State</p>
<p>Gulf 1-1-76 201</p> <p>State</p>	<p>MITCHELL ENERGY 3-20-81 LA-6459 15625</p> <p>State</p>	<p>Gulf HBP 0559775</p> <p>State</p>	<p>Yates Pet. HBP M118</p> <p>State</p>	<p>Yates Pet. HBP M118</p> <p>State</p>	<p>Yates Pet. HBP M118</p> <p>State</p>
<p>Gulf 1-1-76 201</p> <p>State</p>	<p>MITCHELL ENERGY 3-20-81 LA-6459 15625</p> <p>State</p>	<p>Gulf HBP 0559775</p> <p>State</p>	<p>Yates Pet. HBP M118</p> <p>State</p>	<p>Yates Pet. HBP M118</p> <p>State</p>	<p>Yates Pet. HBP M118</p> <p>State</p>
<p>Gulf 1-1-76 201</p> <p>State</p>	<p>MITCHELL ENERGY 3-20-81 LA-6459 15625</p> <p>State</p>	<p>Gulf HBP 0559775</p> <p>State</p>	<p>Yates Pet. HBP M118</p> <p>State</p>	<p>Yates Pet. HBP M118</p> <p>State</p>	<p>Yates Pet. HBP M118</p> <p>State</p>
<p>Gulf 1-1-76 201</p> <p>State</p>	<p>MITCHELL ENERGY 3-20-81 LA-6459 15625</p> <p>State</p>	<p>Gulf HBP 0559775</p> <p>State</p>	<p>Yates Pet. HBP M118</p> <p>State</p>	<p>Yates Pet. HBP M118</p> <p>State</p>	<p>Yates Pet. HBP M118</p> <p>State</p>
<p>Gulf 1-1-76 201</p> <p>State</p>	<p>MITCHELL ENERGY 3-20-81 LA-6459 15625</p> <p>State</p>	<p>Gulf HBP 0559775</p> <p>State</p>	<p>Yates Pet. HBP M118</p> <p>State</p>	<p>Yates Pet. HBP M118</p> <p>State</p>	<p>Yates Pet. HBP M118</p> <p>State</p>
<p>Gulf 1-1-76 201</p> <p>State</p>	<p>MITCHELL ENERGY 3-20-81 LA-6459 15625</p> <p>State</p>	<p>Gulf HBP 0559775</p> <p>State</p>	<p>Yates Pet. HBP M118</p> <p>State</p>	<p>Yates Pet. HBP M118</p> <p>State</p>	<p>Yates Pet. HBP M118</p> <p>State</p>
<p>Gulf 1-1-76 201</p> <p>State</p>	<p>MITCHELL ENERGY 3-20-81 LA-6459 15625</p> <p>State</p>	<p>Gulf HBP 0559775</p> <p>State</p>	<p>Yates Pet. HBP M118</p> <p>State</p>	<p>Yates Pet. HBP M118</p> <p>State</p>	<p>Yates Pet. HBP M118</p> <p>State</p>
<p>Gulf 1-1-76 201</p> <p>State</p>	<p>MITCHELL ENERGY 3-20-81 LA-6459 15625</p> <p>State</p>	<p>Gulf HBP 0559775</p> <p>State</p>	<p>Yates Pet. HBP M118</p> <p>State</p>	<p>Yates Pet. HBP M118</p> <p>State</p>	<p>Yates Pet. HBP M118</p> <p>State</p>
<p>Gulf 1-1-76 201</p> <p>State</p>	<p>MITCHELL ENERGY 3-20-81 LA-6459 15625</p> <p>State</p>	<p>Gulf HBP 0559775</p> <p>State</p>	<p>Yates Pet. HBP M118</p> <p>State</p>	<p>Yates Pet. HBP M118</p> <p>State</p>	<p>Yates Pet. HBP M118</p> <p>State</p>
<p>Gulf 1-1-76 201</p> <p>State</p>	<p>MITCHELL ENERGY 3-20-81 LA-6459 15625</p> <p>State</p>	<p>Gulf HBP 0559775</p> <p>State</p>	<p>Yates Pet. HBP M118</p> <p>State</p>	<p>Yates Pet. HBP M118</p> <p>State</p>	<p>Yates Pet. HBP M118</p> <p>State</p>
<p>Gulf 1-1-76 201</p> <p>State</p>	<p>MITCHELL ENERGY 3-20-81 LA-6459 15625</p> <p>State</p>	<p>Gulf HBP 0559775</p> <p>State</p>	<p>Yates Pet. HBP M118</p> <p>State</p>	<p>Yates Pet. HBP M118</p> <p>State</p>	<p>Yates Pet. HBP M118</p> <p>State</p>
<p>Gulf 1-1-76 201</p> <p>State</p>	<p>MITCHELL ENERGY 3-20-81 LA-6459 15625</p> <p>State</p>	<p>Gulf HBP 0559775</p> <p>State</p>	<p>Yates Pet. HBP M118</p> <p>State</p>	<p>Yates Pet. HBP M118</p> <p>State</p>	<p>Yates Pet. HBP M118</p> <p>State</p>
<p>Gulf 1-1-</p>					

Yates Petroleum Corporation
Allison "CQ" No. 3
660' FSL and 2310' FWL
Section 15 - T19S - R24E
Eddy County, New Mexico

Exhibit "D"

