

UNITED STATES  
DEPARTMENT OF THE INTERIOR  
GEOLOGICAL SURVEYSUBMIT IN TRIPLICATE\*  
(Other instructions on  
reverse side)Form approved.  
Budget Bureau No. 42-R1425.

Copy to AS

## APPLICATION FOR PERMIT TO DRILL, DEEPEN, OR PLUG BACK

## 1a. TYPE OF WORK

DRILL ☒DEEPEN ☐PLUG BACK ☐

## b. TYPE OF WELL

OIL  
WELL ☒GAS  
WELL ☐

OTHER

SINGLE  
ZONE ☐MULTIPLE  
ZONE ☐

## 2. NAME OF OPERATOR

Westall - Mask ✓

## 3. ADDRESS OF OPERATOR

Drawer 1477, Roswell, New Mexico 88201

## 4. LOCATION OF WELL (Report location clearly and in accordance with any State requirements.)\*

At surface

2,310' from East Line and 330' from South Line

At proposed prod. zone

## 14. DISTANCE IN MILES AND DIRECTION FROM NEAREST TOWN OR POST OFFICE\*

O. C. C.  
ARTESIA, OFFICE

## 15. DISTANCE FROM PROPOSED\*

LOCATION TO NEAREST  
PROPERTY OR LEASE LINE, FT.  
(Also to nearest drlg. unit line, if any)

330'

## 16. NO. OF ACRES IN LEASE

160 3/20

17. NO. OF ACRES ASSIGNED  
TO THIS WELL

40

18. DISTANCE FROM PROPOSED LOCATION\*  
TO NEAREST WELL, DRILLING, COMPLETED,  
OR APPLIED FOR, ON THIS LEASE, FT.

990'

## 19. PROPOSED DEPTH

4,000

## 20. ROTARY OR CABLE TOOLS

Rotary

## 21. ELEVATIONS (Show whether DF, RT, GR, etc.)

3689.5 GR

## 22. APPROX. DATE WORK WILL START\*

11/15/78

## 23.

## PROPOSED CASING AND CEMENTING PROGRAM

SIZE OF HOLE	SIZE OF CASING	WEIGHT PER FOOT	SETTING DEPTH	QUANTITY OF CEMENT
11	8 5/8	20#	650	Approx. 225 sacks to circ.
7 7/8	5 1/2	14#	Approx 4000	"

Blowout preventer will be double manual (Shaeffer) B.O.P. with 3000# test.

Mud Program - We will use fresh water to 650', then use salt gel to total depth.

No anticipated abnormal pressure or temperatures.

Anticipated starting date November 15, 1978

Tops: Yates 2600' Queen 3600' Grayburg 4000'

IN ABOVE SPACE DESCRIBE PROPOSED PROGRAM: If proposal is to deepen or plug back, give data on present productive zone and proposed new productive zone. If proposal is to drill or deepen directionally, give pertinent data on subsurface locations and measured and true vertical depths. Give blowout preventer program, if any.

## 24.

SIGNED

Jack Mask

TITLE

Agent (Co-Owner)

DATE

10/13/78

(This space for Federal or State office use)

PERMIT NO.

APPROVAL DATE

APPROVED BY

TITLE

DATE

CONDITIONS OF APPROVAL, IF ANY:

\*See Instructions On Reverse Side



NMOCC COPY

# United States Department of the Interior

## GEOLOGICAL SURVEY

P. O. Drawer U  
Artesia, New Mexico 88210

November 8, 1978

Westall-Mask  
Drawer 1477  
Roswell, New Mexico 88201

WESTALL-MASK Keohane <sup>24</sup> Federal <del>24</del> No. 1 330 FSL 2310 FEL Sec. 24, T18S, R31E Eddy County Lease No. NM-025777
Above Data Required on Well Sign

Gentlemen:

Your APPLICATION FOR PERMIT TO DRILL the above-described well to a depth of 4,000 feet to test the Grayburg formation is hereby approved subject to compliance with the OIL AND GAS OPERATING REGULATIONS (30 CFR 221) and the following conditions:

1. Drilling operations authorized are subject to compliance with the GENERAL REQUIREMENTS FOR OIL AND GAS OPERATIONS ON FEDERAL LEASES, dated July 1, 1978.
2. Prior to commencing construction of road, pad, or other associated developments, operator will provide the dirt contractor with a copy of the SURFACE USE PLAN and his approval including the GENERAL REQUIREMENTS.
3. Submit a Daily Report of Operations from spud date until the Well Completion Report (form 9-330) is filed. The progress report should be not less than 8" x 5" in size and each page should identify the well.
4. All permanent above-ground structures and equipment shall be painted in accordance with the attached Painting Requirements. The color used should simulate sandstone brown (Federal Standard Color #595A, color 20318 or 30318).

Sincerely yours,

(Orig. Sgd.) ALBERT R. STALL

Albert R. Stall  
Acting District Engineer

NEW MEXICO OIL CONSERVATION COMMISSION  
WELL LOCATION AND ACREAGE DEDICATION PLAT

Form C-102  
Supersedes C-128  
Effective 1-1-65

All distances must be from the outer boundaries of the Section.

Operator <b>Westall and Mask</b>			Lease <b>24 Keohane Federal</b>		Well No. <b>1</b>
Unit Letter <b>0</b>	Section <b>24</b>	Township <b>18 South</b>	Range <b>31 East</b>	County <b>Eddy</b>	
Actual Footage Location of Well: <b>2310</b> feet from the <b>East</b> line and <b>330</b> feet from the <b>South</b> line					
Ground Level Elev. <b>3689.5</b>	Producing Formation <b>4. SR. B. G</b>		Pool <b>Und. Shugart 4. SR. B. G</b>		Dedicated Acreage: <b>40</b> Acres

1. Outline the acreage dedicated to the subject well by colored pencil or hachure marks on the plat below.
2. If more than one lease is dedicated to the well, outline each and identify the ownership thereof (both as to working interest and royalty).
3. If more than one lease of different ownership is dedicated to the well, have the interests of all owners been consolidated by communitization, unitization, force-pooling, etc?

☐ Yes   ☐ No   If answer is "yes," type of consolidation \_\_\_\_\_

If answer is "no," list the owners and tract descriptions which have actually been consolidated. (Use reverse side of this form if necessary.) \_\_\_\_\_

No allowable will be assigned to the well until all interests have been consolidated (by communitization, unitization, forced-pooling, or otherwise) or until a non-standard unit, eliminating such interests, has been approved by the Commission.

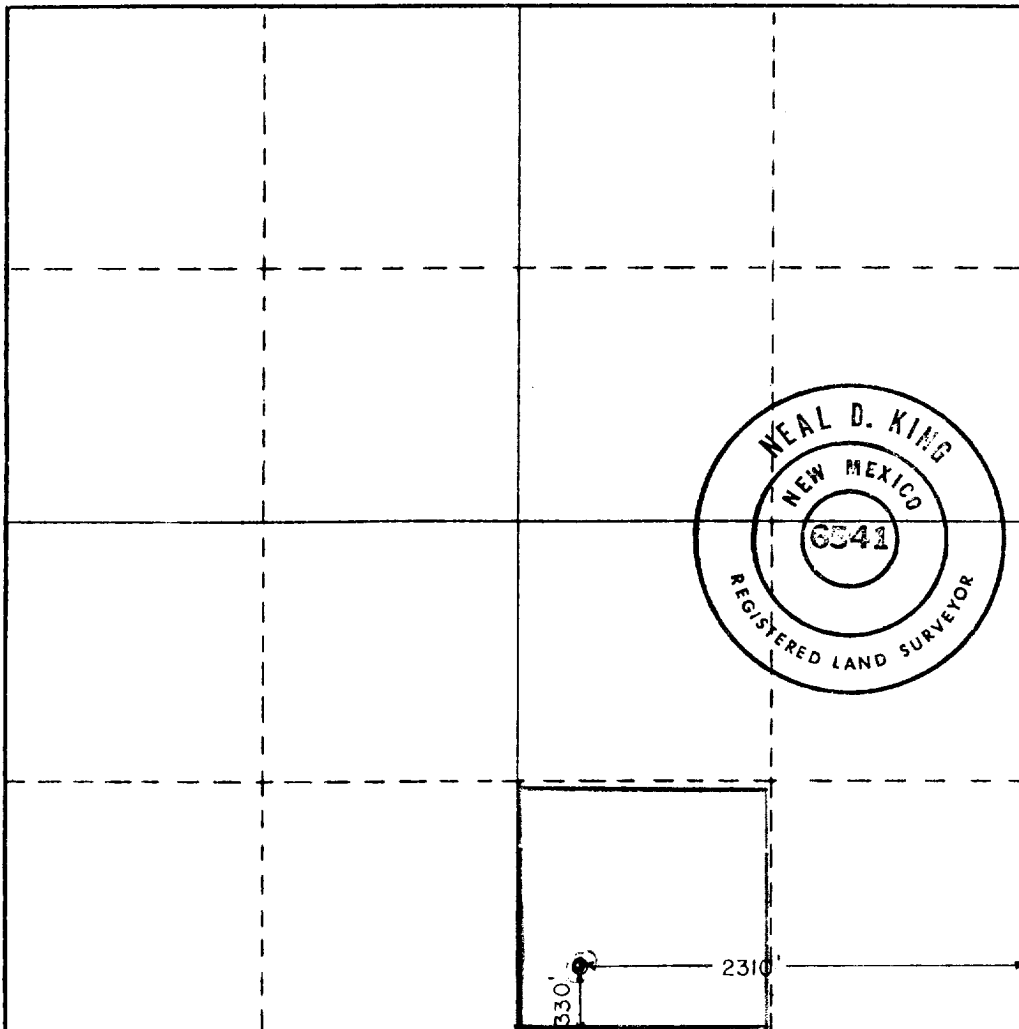

**CERTIFICATION**

I hereby certify that the information contained herein is true and complete to the best of my knowledge and belief.

*Jack Mask*  
Name

Jack Mask

Position

Co-Owner

Company

Westall - Mask

Date

10/13/78

I hereby certify that the well location shown on this plat was plotted from field notes of actual surveys made by me or under my supervision, and that the same is true and correct to the best of my knowledge and belief.

Date Surveyed

OCTOBER 6, 1978





Registered Professional Engineer and/or Land Surveyor

*Neal D. King*  
Certificate No.

RLS

654

# SCHEDULE 1

STATE 31   
 LEASE ROAD   
 UNIMPROVED ROAD   
 OLD EXISTING ROAD 

◆ NEAREST  
 PRODUCTION

SURFACE USE PLAN

Westall - Mask Well #24-1  
 Keohane Federal 2,310' FEL  
 and 330' FSL Sec. 24,  
 T18S-R31E LC 065680  
 Eddy County, NM

NEW MEXICO  
 CLAYTON BASIN QUADRANGLE  
 15 MINUTE SERIES

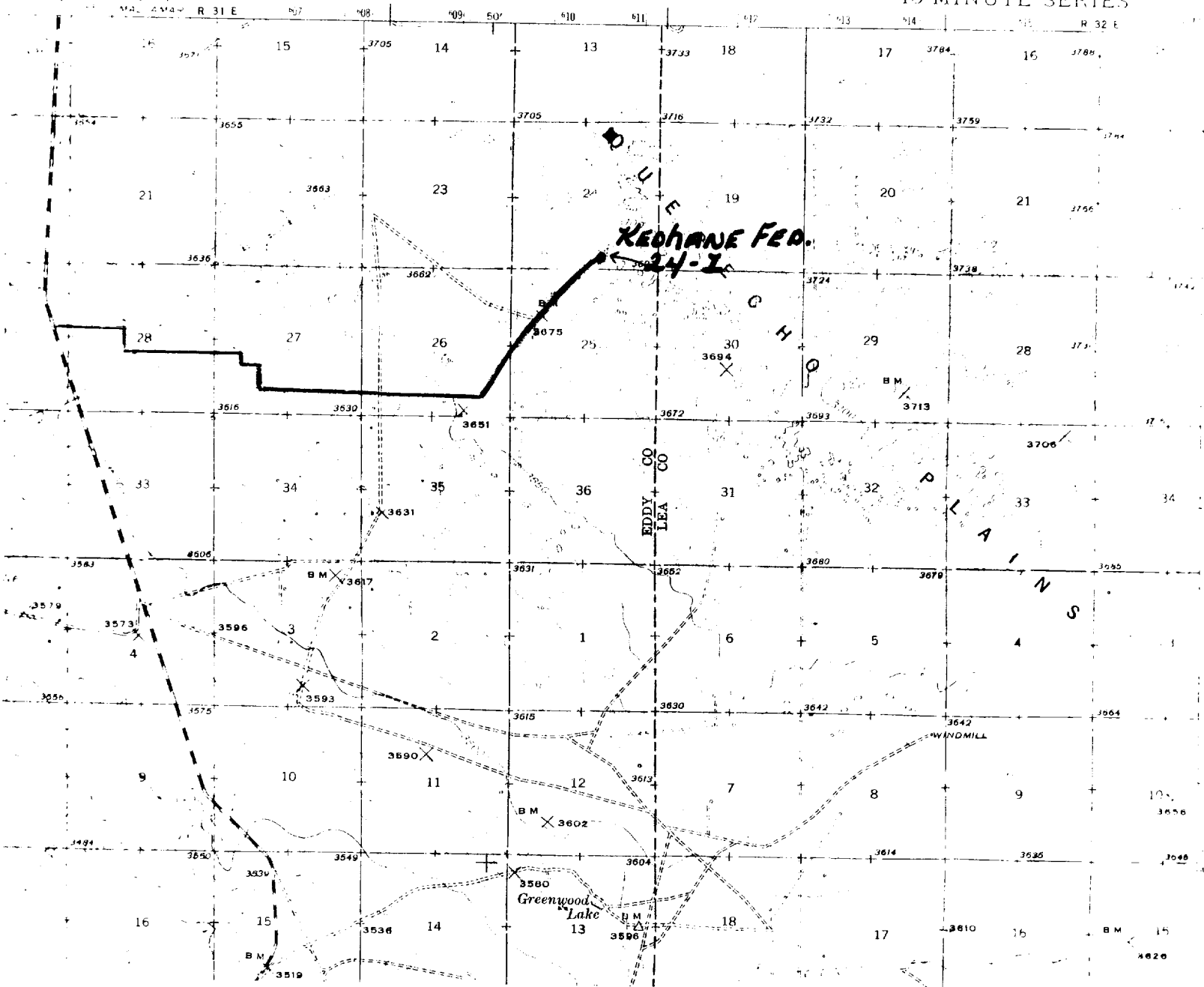

SCHEDULE 1-C

TANK BATTERY ☐

SECTION \_\_\_\_\_

TOWNSHIP \_\_\_\_\_ 18S \_\_\_\_\_

RANGE \_\_\_\_\_ 31E \_\_\_\_\_

STATE 3

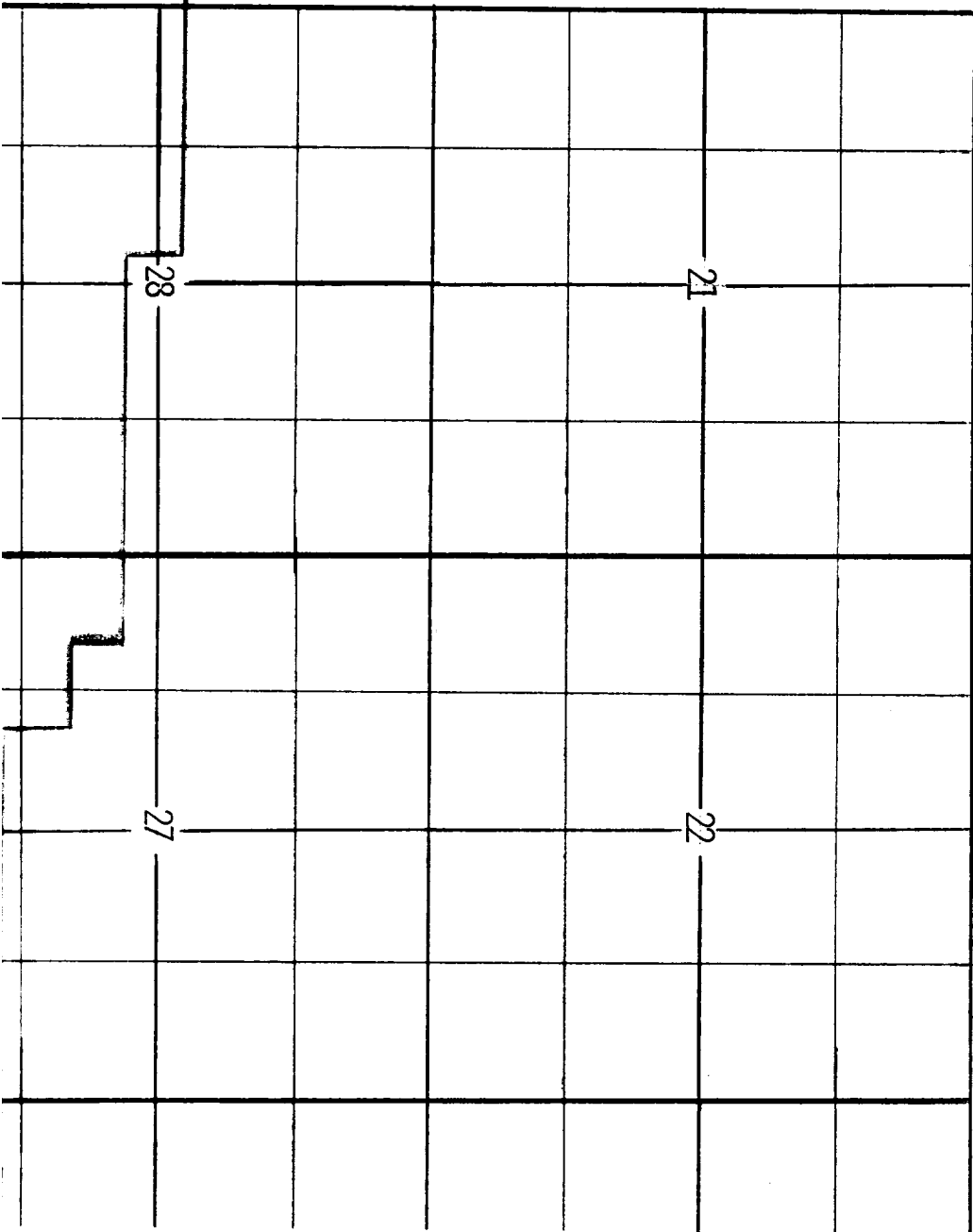

# SCHEDULE 2

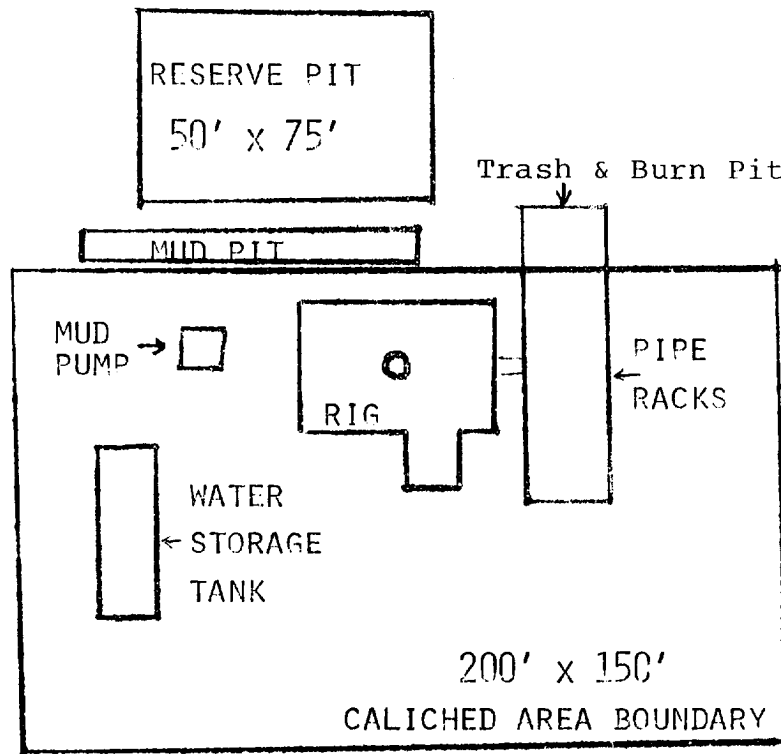

SCALE 1" = 50'

## DEVELOPMENT PLAN FOR SURFACE USE

WESTALL AND MASK, ROSWELL NM 88201

Westall - Mask      Well #24-1  
 Keohane Federal      2,310' FEL  
 and 330' FSL      Sec. 24,  
 T18S-R31E      LC 065680  
 Eddy County, NM

SURFACE USE PLAN