

NEW MEXICO OIL CONSERVATION COMMISSION  
WELL LOCATION AND ACREAGE DEDICATION PLAT

Form C-122  
Supersedes C-128  
Effective 1-1-65

All distances must be from the outer boundaries of the Section

Owner Southland Royalty Co.			Lease State 14 Com.		Well No. 1
Section Letter E	Section 14	Township 19 South	Range 29 East	County Eddy	
Well Location of Well: 1980 feet from the North line and 660 feet from the West line					
Ground Level Elev. 3319.2	Producing Formation Morrow	Pool Undesignated ( <del>Tract</del> )		Dedicated Acreage: 320 Acres	

- Outline the acreage dedicated to the subject well by colored pencil or hachure marks on the plat below.
- If more than one lease is dedicated to the well, outline each and identify the ownership thereof (both as to working interest and royalty).
- If more than one lease of different ownership is dedicated to the well, have the interests of all owners been consolidated by communitization, unitization, force-pooling, etc?

Yes  No If answer is "yes," type of consolidation Communitized

If answer is "no," list the owners and tract descriptions which have actually been consolidated. (Use reverse side of this form if necessary.) \_\_\_\_\_

No allowable will be assigned to the well until all interests have been consolidated (by communitization, unitization, forced-pooling, or otherwise) or until a non-standard unit, eliminating such interests, has been approved by the Commission.

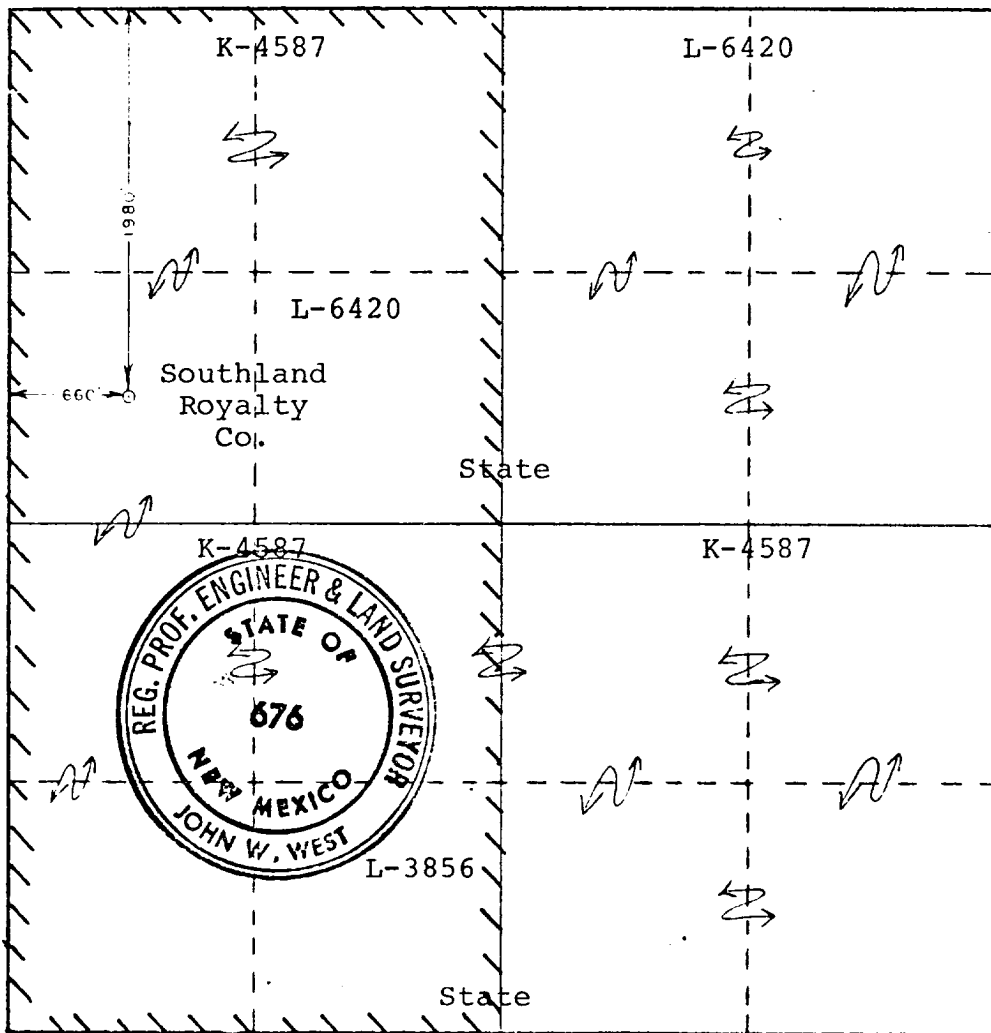

CERTIFICATION	
I hereby certify that the information contained herein is true and complete to the best of my knowledge and belief.	
Name	<i>C. Harvey Carr</i>
Position	District Engineer
Company	Southland Royalty Co.
Date	11/14/78
I hereby certify that the well location shown on this plat was plotted from field notes of actual surveys made by me or under my supervision, and that the same is true and correct to the best of my knowledge and belief.	
Date Surveyed	November 10, 1978
Registered Professional Engineer and/or Land Surveyor	
<i>John W. West</i>	
Certificate No.	John W. West 676

