

DISTRIBUTION			
SANTA FE		1	
FILE		1	
U.S.G.S.			
LAND OFFICE			
TRANSPORTER	OIL		
	GAS		
OPERATOR			
PRORATION OFFICE			

NEW MEXICO OIL CONSERVATION COMMISSION
REQUEST FOR ALLOWABLE
AND
AUTHORIZATION TO TRANSPORT OIL AND NATURAL GAS

Form C-104
Supersedes Old C-104 and C-111
Effective 1-1-65

RECEIVED

DEC 27 1979

Operator Mesa Petroleum Co.		O. C. D. ARTESIA, OFFICE	
Address 1000 Vaughn Building / Midland, Texas 79701			
Reason(s) for filing (Check proper box)		Other (Please explain)	
New Well <input checked="" type="checkbox"/>	Change in Transporter of: Oil <input type="checkbox"/> Dry Gas <input type="checkbox"/> Casinghead Gas <input type="checkbox"/> Condensate <input type="checkbox"/>		
Recompletion <input type="checkbox"/>			
Change in Ownership <input type="checkbox"/>			

If change of ownership give name
and address of previous owner

DESCRIPTION OF WELL AND LEASE		Well No.	Pool Name, Including Formation	Kind of Lease
Lease Name Frank State		1	Runyan Ranch - Abo	State, Federal or Fee State
Location				
Unit Letter	I	2130	Feet From The South Line and 660	Feet From The East
Line of Section	7	Township	19 South Range 23 East	NMPM, Eddy County

DESIGNATION OF TRANSPORTER OF OIL AND NATURAL GAS		Address (Give address to which approved copy of this form is to be sent)	
Name of Authorized Transporter of Oil <input type="checkbox"/> or Condensate <input type="checkbox"/>			
Name of Authorized Transporter of Casinghead Gas <input type="checkbox"/> or Dry Gas <input checked="" type="checkbox"/>		Box 2300, Midland, Texas 79702	
If well produces oil or liquids, give location of tanks.	Unit I Sec. 7 Twp. 19 Rge. 23	Is gas actually connected? No <u>yes</u>	When <u>5-23-80</u> Est. January 15, 1980

If this production is commingled with that from any other lease or pool, give commingling order number:

COMPLETION DATA		Oil Well	Gas Well	New Well	Workover	Deepen	Plug Back	Same Res'v.	Diff. Res'v
Designate Type of Completion - (X)			X	X					
Date Spudded January 18, 1979	Date Compl. Ready to Prod. 6-29-79	Total Depth 7700'		P.B.T.D. 7656'					
Pool Runyan Ranch	Name of Producing Formation Abo	Top Oil/Gas Pay 4395'		Tubing Depth 7565'					
Perforations 4395'---4454' (14 holes)				Depth Casing Shoe 7700'					

TUBING, CASING, AND CEMENTING RECORD			
HOLE SIZE	CASING & TUBING SIZE	DEPTH SET	SACKS CEMENT
17-1/2"	13-3/8"	240'	275 sx "C"
11"	8-5/8"	1665'	200thixset/175HLW/200"C"
7-7/8"	5-1/2"	7700'	800 50-50 poz/300 "H"
* Sliding sleeve in 2-3/8" tbq in closed position at 4491' (Abo produced up annulus-Morrow/tbg)			

TEST DATA AND REQUEST FOR ALLOWABLE OIL WELL (Test must be after recovery of total volume of load oil and must be equal to or exceed top allowable for this depth or be for full 24 hours)

Date First New Oil Run To Tanks	Date of Test	Producing Method (Flow, pump, gas lift, etc.)	
Length of Test	Tubing Pressure	Casing Pressure	Choke Size
Actual Prod. During Test	Oil-Ebbls.	Water-Ebbls.	Gas-MCF

GAS WELL		Ebbls. Condensate/MMCF	Gravity of Condensate
Actual Prod. Test-MCF/D 720	Length of Test 4 hrs	none produced during test	-
Testing Method (pilot, back pr.) Back Pressure	Tubing Pressure 2220' SITP *	Casing Pressure 920*	Choke Size 12/64

CERTIFICATE OF COMPLIANCE

I hereby certify that the rules and regulations of the Oil Conservation Commission have been complied with and that the information given above is true and complete to the best of my knowledge and belief.

R.E. Morris
Regulatory Coordinator
December 21, 1979

OIL CONSERVATION COMMISSION
MAY 27 1980
APPROVED
BY W.A. Gressitt
TITLE SUPERVISOR, DISTRICT II

This form is to be filed in compliance with RULE 1104.
If this is a request for allowable for a newly drilled or deep well, this form must be accompanied by a tabulation of the device tests taken on the well in accordance with RULE 111.
All sections of this form must be filled out completely for all wells on new and recompleted wells.
Fill out Sections I, II, III, and VI only for changes of owner, well name or number, or transporter, or other such change of condition.
Separate Forms C-104 must be filed for each pool in multi-

NEW MEXICO OIL CONSERVATION COMMISSION
WELL LOCATION AND ACREAGE DEDICATION, AT

Form C-102
Supersedes C-128
Effective 1-1-65

All distances must be from the outer boundaries of the Section.

Operator Mesa Petroleum Co		Lease Frank State		Well No. 1
Well Letter I	Section 7	Township 19 South	Range 23 East	County Eddy
Actual Footage Location of Well: 2130 feet from the South line and 660 feet from the East line				
Ground Level Elev. 4040.6	Producing Formation Abo	Pool Runyan Ranch	Dedicated Acreage: SE/4 160 Acres	

1. Outline the acreage dedicated to the subject well by colored pencil or hachure marks on the plat below.
2. If more than one lease is dedicated to the well, outline each and identify the ownership thereof (both as to working interest and royalty).
3. If more than one lease of different ownership is dedicated to the well, have the interests of all owners been consolidated by communitization, unitization, force-pooling, etc?

RECEIVED

DEC 27 1979

O. C. D.

ARTESIA, OFFICE

☐ Yes ☐ No If answer is "yes," type of consolidation _____

If answer is "no," list the owners and tract descriptions which have actually been consolidated. (Use reverse side of this form if necessary.) _____

No allowable will be assigned to the well until all interests have been consolidated (by communitization, unitization, forced-pooling, or otherwise) or until a non-standard unit, eliminating such interests, has been approved by the Commission.

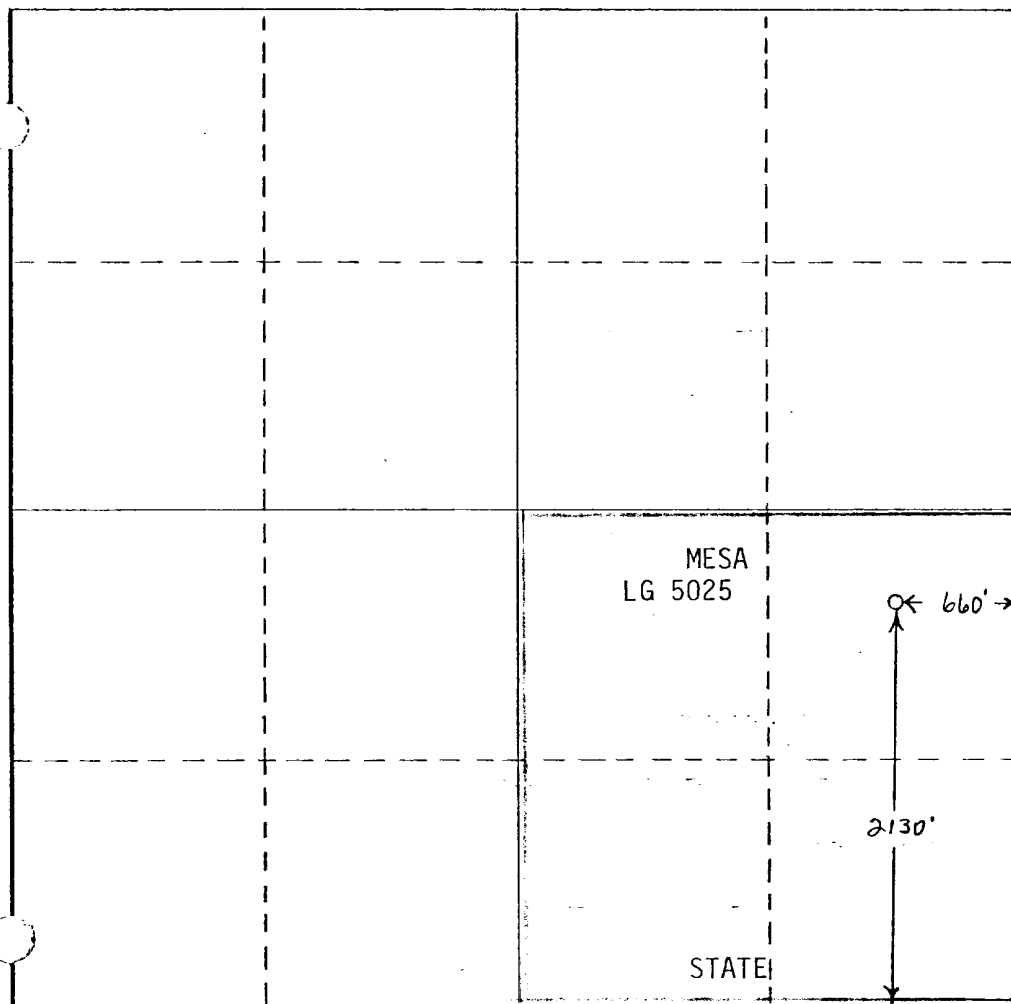

CERTIFICATION

I hereby certify that the information contained herein is true and complete to the best of my knowledge and belief.

Michael P. Houston

Name	Michael P. Houston
Position	Operations Manager
Company	Mesa Petroleum Co
Date	December 21, 1979

I hereby certify that the well location shown on this plat was plotted from field notes of actual surveys made by me or under my supervision, and that the same is true and correct to the best of my knowledge and belief.

Date Surveyed	
Registered Professional Engineer and/or Land Surveyor	
Certificate No.	

OIL CONSERVATION DIVISION

RECEIVED

DRAWER DB

MAY 26 1980

ARTESIA, NEW MEXICO

O. C. D.

ARTESIA, OFFICE

NOTICE OF GAS CONNECTION

DATE 1-2-80

This is to notify the Oil Conservation Division that connection for the purchase of gas from the Mesa Petroleum Co. ✓, Frankstate No. 1-8 .
Operator Lease

I , 7-19-23 , Undesignated Abo , Northern Natural Gas ,
Well Unit S. T. R. Pool Name of Purchaser

was made on ~~1-4-80~~ 5-23-80 .
Date

Northern Natural Gas Company
Purchaser

Stowell Fund
Representative

Gas Contract Specialist
Title

cc: To Operator
Oil Conservation Division - Santa Fe
File