

NO. OF COPIES RECEIVED	6
DISTRIBUTION	
SANTA FE	1
FILE	1
U.S.G.S.	2
LAND OFFICE	1
OPERATOR	1

NEW MEXICO OIL CONSERVATION COMMISSION

MAR 12 1979

O. C. C.
ARTESIA, OFFICE

30-015-22875
Form C-101
Revised 1-1-65

5A. Indicate Type of Lease
STATE <input checked="" type="checkbox"/> FEE <input type="checkbox"/>
5. State Oil & Gas Lease No.
L-2631

APPLICATION FOR PERMIT TO DRILL, DEEPEN, OR PLUG BACK

1a. Type of Work	DRILL <input checked="" type="checkbox"/> DEEPEN <input type="checkbox"/> PLUG BACK <input type="checkbox"/>
b. Type of Well	OIL WELL <input type="checkbox"/> GAS WELL <input checked="" type="checkbox"/> OTHER <input type="checkbox"/>
2. Name of Operator	Wm. B. Barnhill
3. Address of Operator	P. O. Box 1354 Roswell, New Mexico 88201
4. Location of Well	UNIT LETTER D LOCATED 660 FEET FROM THE north LINE AND 660 FEET FROM THE west LINE OF SEC. 27 TWP. 19s RGE. 23e NMPM
7. Unit Agreement Name	NONE
8. Farm or Lease Name	Siegreest Draw
9. Well No.	1
10. Field and Pool, or Wildcat	Wildcat Abo
12. County	Eddy
19. Proposed Depth	4900
19A. Formation	Abo
20. Rotary or C.T.	rotary to surface
21. Elevations (Show whether DF, RT, etc.)	3951 gr
21A. Kind & Status Plug. Bond	Nationwide
21B. Drilling Contractor	
22. Approx. Date Work will start	March 15, 1979

PROPOSED CASING AND CEMENT PROGRAM					
SIZE OF HOLE	SIZE OF CASING	WEIGHT PER FOOT	SETTING DEPTH	SACKS OF CEMENT	EST. TOP
15"	13 3/8	37#	250	300	circ to surface
11 1/2	8 5/8	24#	1850	700	Circ to surface
7 7/8	5 1/2	17#	4900	350	

Propose to set 13 3/8 casing with cable tool Abbott Bros. Drilling Co. Move on rotary and drill to T.D.
The acreage dedicated to well is not committed to a gas contract.
Fresh water for drilling fluid to 4500', 10# mud with 2 % KCL from 4500' to T.D.

APPROVAL VALID
FOR 90 DAYS UNLESS
DRILLING COMMENCED,
EXPIRES 6/15/79

IN ABOVE SPACE DESCRIBE PROPOSED PROGRAM: IF PROPOSAL IS TO DEEPEN OR PLUG BACK, GIVE DATA ON PRESENT PRODUCTIVE ZONE AND PROPOSED NEW PRODUCTIVE ZONE, GIVE BLOWOUT PREVENTER PROGRAM, IF ANY.

I hereby certify that the information above is true and complete to the best of my knowledge and belief.

Signed Wm. B. Barnhill Title Operator Date March 12, 1979

(This space for State Use)

APPROVED BY Mark Walker TITLE OIL AND GAS INSPECTOR

CONDITIONS OF APPROVAL, IF ANY:

Cement must be circulated to
surface 13 3/8 18 7/8 casing

MAR 15 1979
Notify Wm. B. Barnhill
the 8 5/8 casing

NEW MEXICO OIL CONSERVATION COMMISSION
WELL LOCATION AND ACREAGE DEDICATION PLAT

Form C-102
Supersedes C-100
Effective 1-1-83

All distances must be from the outer boundaries of the Section.

Operator Wm. B. Barnhill			Lease Wm. Barnhill No. 1 Siecrest Draw		Well No. 1
Unit Letter "D"	Section 27	Township 19 South	Range 23 East	County Eddy	
Actual Footage Location of Well: 660 feet from the North line and 660 feet from the West line					
Ground Level Elev. 3951	Producing Formation ABO		Pool Wildcat		Dedicated Acreage: 330 / 160 Acres

1. Outline the acreage dedicated to the subject well by colored pencil or hatchure marks on the plat below.
2. If more than one lease is dedicated to the well, outline each and identify the ownership thereof (both as to working interest and royalty).
3. If more than one lease of different ownership is dedicated to the well, have the interests of all owners been consolidated by communitization, unitization, force-pooling, etc?

☐ Yes ☐ No If answer is "yes," type of consolidation _____

If answer is "no," list the owners and tract descriptions which have actually been consolidated. (Use reverse side of this form if necessary.) _____

No allowable will be assigned to the well until all interests have been consolidated (by communitization, unitization, forced-pooling, or otherwise) or until a non-standard unit, eliminating such interests, has been approved by the Commission.

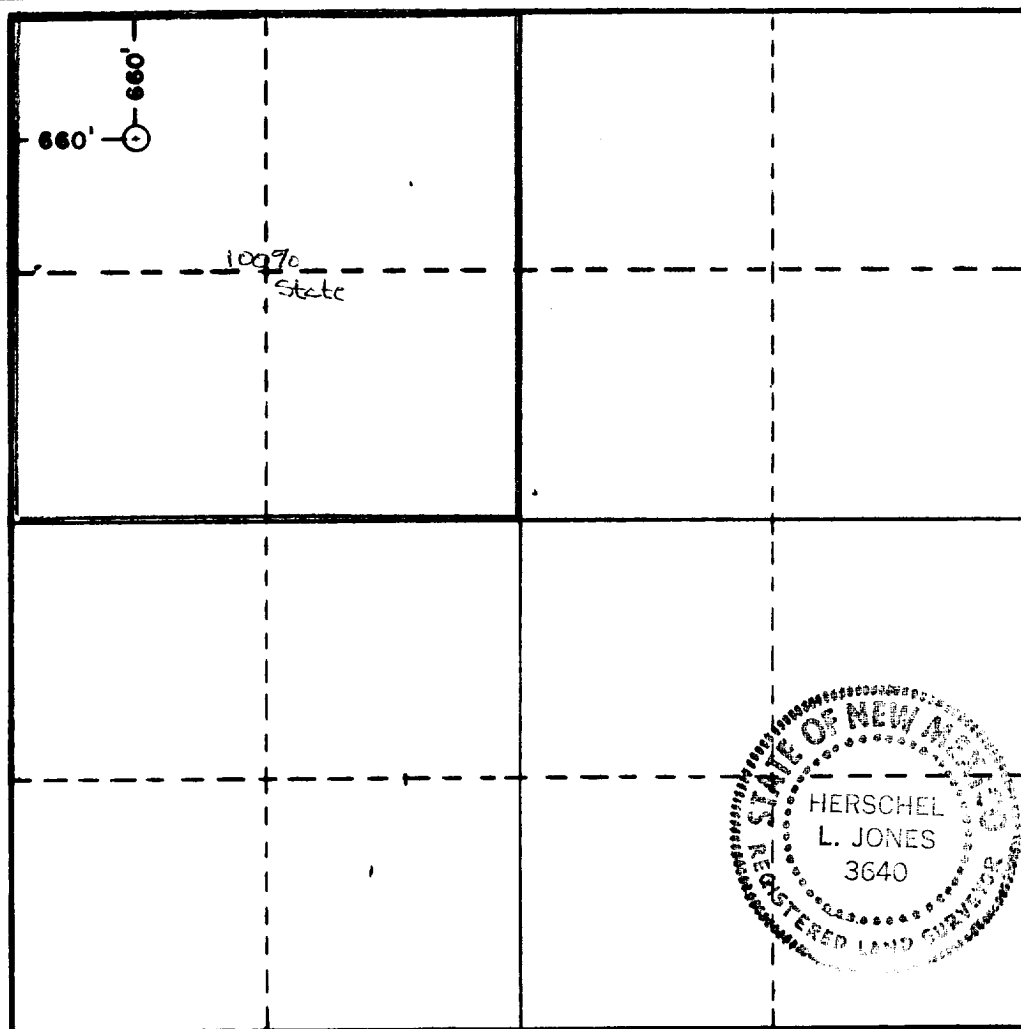

CERTIFICATION

I hereby certify that the information contained herein is true and complete to the best of my knowledge and belief.

Wm. B. Barnhill
Name **Wm. B. Barnhill**

Position **Operator**

Company **Wm. B. Barnhill**

Date **March 12, 1979**

I hereby certify that the well location shown on this plat was plotted from field notes of actual surveys made by me or under my supervision, and that the same is true and correct to the best of my knowledge and belief.

Date Surveyed

March 10, 1979

Registered Professional Engineer and/or Land Surveyor

Herschel L. Jones
Certificate No.

3640

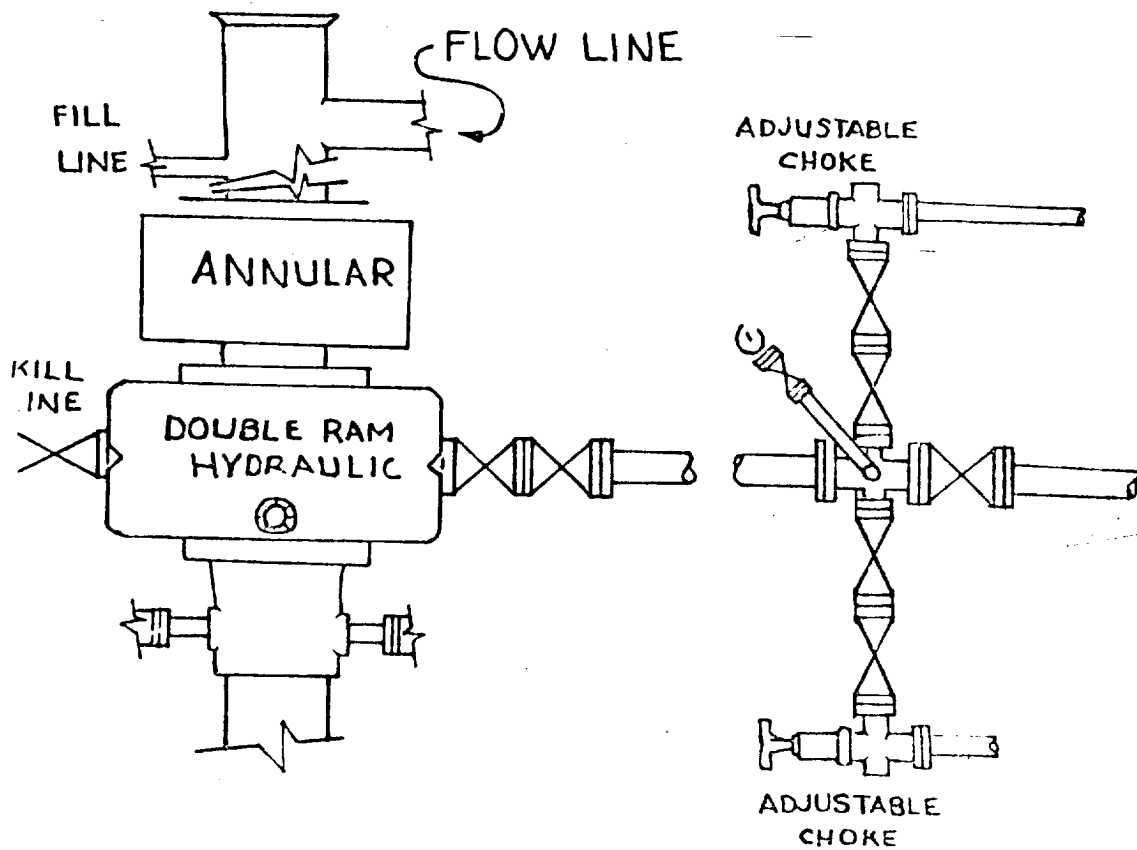

Blow-out preventers to be used on Barnhill #1 Allied State