

NO. OF COPIES RECEIVED	6
DISTRIBUTION	
SANTA FE	/
FILE	/
U.S.G.S.	2
LAND OFFICE	/
OPERATOR	/

NEW MEXICO OIL CONSERVATION COMMISSION

RECEIVED

30-015-22876

Form C-101
Revised 1-1-65

MAR 15 1979

O. C. C.
ARTESIA, OFFICE

5A. Indicate Type of Lease
STATE <input checked="" type="checkbox"/> FEE <input type="checkbox"/>
5. State Oil & Gas Lease No.
L-2764

APPLICATION FOR PERMIT TO DRILL, DEEPEN, OR PLUG BACK

1a. Type of Work		7. Unit Agreement Name	
b. Type of Well DRILL <input checked="" type="checkbox"/> DEEPEN <input type="checkbox"/> PLUG BACK <input type="checkbox"/> OIL WELL <input checked="" type="checkbox"/> GAS WELL <input type="checkbox"/> OTHER <input type="checkbox"/> SINGLE ZONE <input checked="" type="checkbox"/> MULTIPLE ZONE <input type="checkbox"/>		8. Farm or Lease Name	
2. Name of Operator		Irish Hills KW St.	
Yates Petroleum Corporation ✓		9. Well No.	
3. Address of Operator		1	
207 South 4th Street, Artesia, NM 88201		10. Field and Pool, or Wildcat	
4. Location of Well		Yeso S	
UNIT LETTER P LOCATED 330 FEET FROM THE South LINE		Und. Penasco Draw	
AND 330 FEET FROM THE East LINE OF SEC. 2 TWP. 19S RGE. 24E NMPM			
		12. County	
		Eddy	
		19. Proposed Depth	
		3000	
		19A. Formation	
		Yeso	
		20. Rotary or C.T.	
		Rotary	
21. Elevations (Show whether DF, RT, etc.)		21B. Drilling Contractor	
21A. Kind & Status Plug. Bond		L & M Drilling Co.	
Blanket		22. Approx. Date Work will start	
		March 17, 1979	

23.

PROPOSED CASING AND CEMENT PROGRAM

SIZE OF HOLE	SIZE OF CASING	WEIGHT PER FOOT	SETTING DEPTH	SACKS OF CEMENT	EST. TOP
15	10 3/4	32.7#	Approx 300	175	Circulate
9 1/2	7	17#	Approx 920	550	Circulate
6 1/2	5 1/2-4 1/2	14#-9.5#	Approx 3000	250	Circulate

Propose to drill and test the Yeso and San Andres formations. Approx. 300' of surface casing will be set to shut off gravel and caving and intermediate casing will be set at least 100' below the Artesian Water Zone. A tapered 5 1/2" & 4 1/2" production casing will be run, perforated and sand-frac'd for production.

Mud Program: Fresh water Gel to 920', fresh water to TD.

BOP Program: BOP's will be installed on 7" casing & tested.

APPROVAL VALID
FOR 90 DAYS UNLESS
DRILLING COMMENCED,

EXPIRES 6/16/79

IN ABOVE SPACE DESCRIBE PROPOSED PROGRAM: IF PROPOSAL IS TO DEEPEN OR PLUG BACK, GIVE DATA ON PRESENT PRODUCTIVE ZONE AND PROPOSED NEW PRODUCTIVE ZONE. GIVE BLOWOUT PREVENTER PROGRAM, IF ANY.

I hereby certify that the information above is true and complete to the best of my knowledge and belief.

Signed Christine Thompson Title Geological Secretary Date 3-15-79

(This space for State Use)

APPROVED BY Mike Williams TITLE OIL AND GAS INSPECTOR DATE MAR 16 1979

CONDITIONS OF APPROVAL, IF ANY:

Cement must be circulated to
surface behind 10 3/4" & 7" casing

Notify N.M.O.C.C. in sufficient time to witness

7

NEW MEXICO OIL CONSERVATION COMMISSION
WELL LOCATION AND ACREAGE DEDICATION PLAT

Form C-102
Supersedes C-128
Effective 1-1-65

All distances must be from the outer boundaries of the Section.

Operator YATES PETROLEUM CORPORATION		Lease Irish Hills KW State		Well No. 1
Init Letter P	Section 2	Township 19 South	Range 24 East	County Eddy
Actual Footage Location of Well: 330 feet from the South line and 330 feet from the East line Pool Undesignated Penasco Dedicated Acreage: 40 Acres Ground Level Elev. 3652.4 Producing Formation Yeso Draw Yeso SA				

- Outline the acreage dedicated to the subject well by colored pencil or hachure marks on the plat below.
- If more than one lease is dedicated to the well, outline each and identify the ownership thereof (both as to working interest and royalty).
- If more than one lease of different ownership is dedicated to the well, have the interests of all owners been consolidated by communitization, unitization, force-pooling, etc?

☐ Yes ☐ No If answer is "yes," type of consolidation _____

If answer is "no," list the owners and tract descriptions which have actually been consolidated. (Use reverse side of this form if necessary.) _____

No allowable will be assigned to the well until all interests have been consolidated (by communitization, unitization, forced-pooling, or otherwise) or until a non-standard unit, eliminating such interests, has been approved by the Commission.

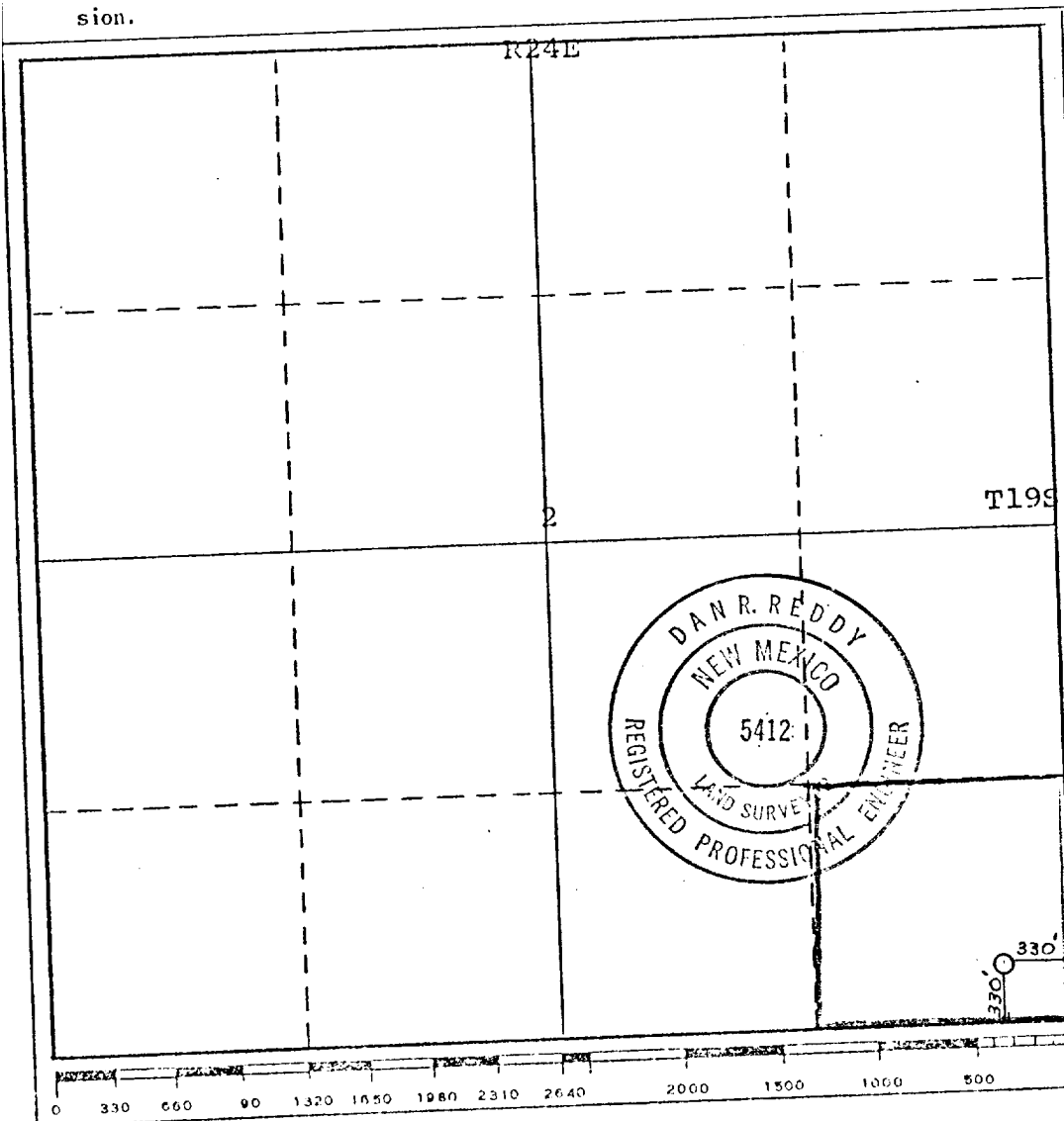

CERTIFICATION

I hereby certify that the information contained herein is true and complete to the best of my knowledge and belief.

Name
Eddie M. Mahfood

Position
Engineer

Company
Yates Petroleum Corp.

Date
3-15-79

I hereby certify that the well location shown on this plat was plotted from field notes of actual surveys made by me or under my supervision, and that the same is true and correct to the best of my knowledge and belief.

Date Surveyed
March 14, 1979

Registered Professional Engineer and/or Land Surveyor

Dan R. Reddy
Certificate No.

New Mexico PE&LS #5412

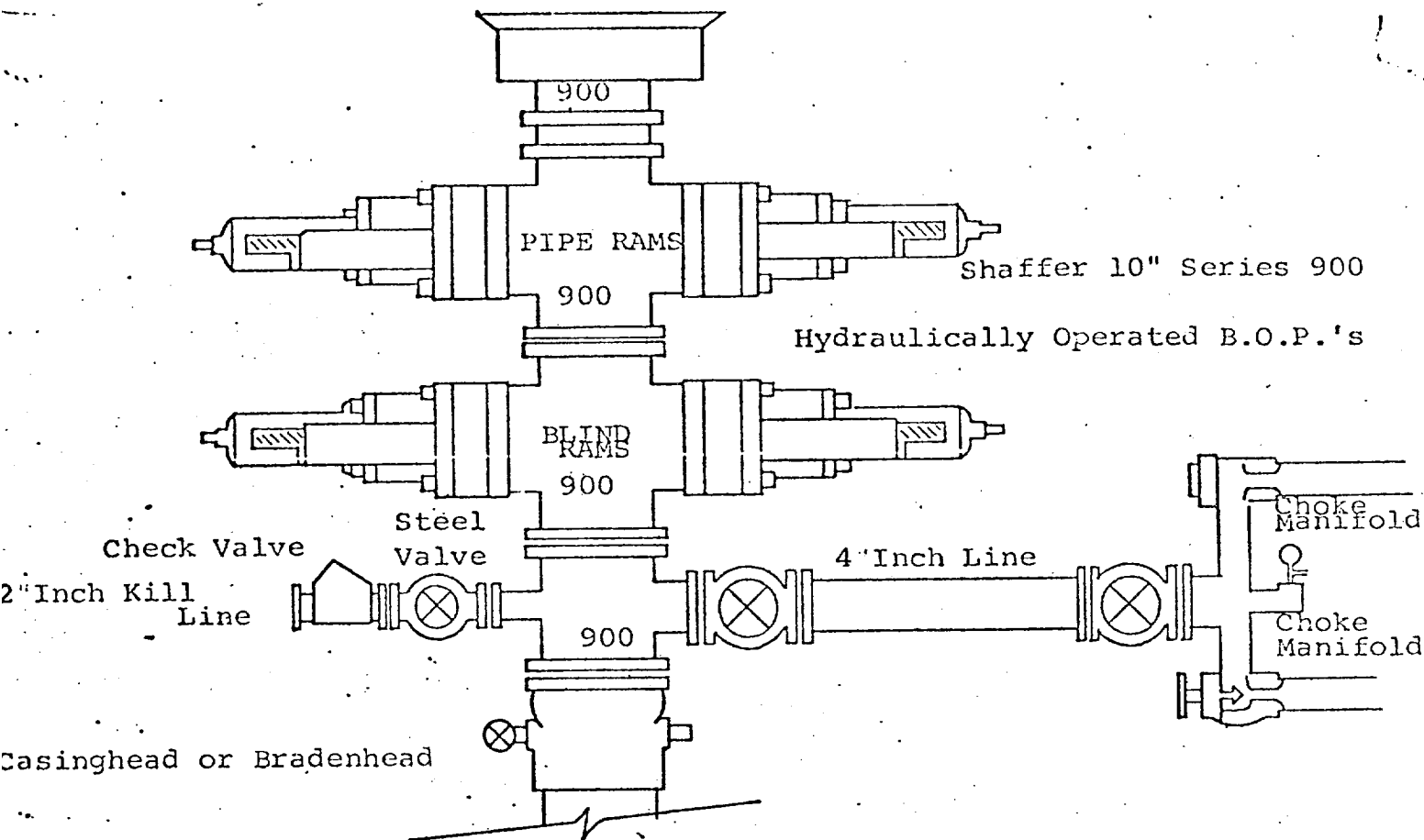

THE FOLLOWING CONSTITUTE MINIMUM BLOWOUT PREVENTER REQUIREMENTS

1. All preventers to be hydraulically operated with secondary manual controls installed prior to drilling out from under casing.
2. Choke outlet to be a minimum of 4" diameter.
3. Kill line to be of all steel construction of 2" minimum diameter.
4. All connections from operating manifolds to preventers to be all steel. hole or tube a minimum of one inch in diameter.
5. The available closing pressure shall be at least 15% in excess of that required with sufficient volume to operate the B.O.P.'s.
6. All connections to and from preventer to have a pressure rating equivalent to that of the B.O.P.'s.
7. Inside blowout preventer to be available on rig floor.
8. Operating controls located a safe distance from the rig floor.
9. Hole must be kept filled on trips below intermediate casing. Operator not responsible for blowouts resulting from not keeping hole full.
10. D. P. float must be installed and used below zone of first gas intrusion.