

NO. OF COPIES RECEIVED	6
DISTRIBUTION	
SANTA FE	1
FILE	1 ✓
U.S.G.S.	2
LAND OFFICE	1
OPERATOR	1

NEW MEXICO OIL CONSERVATION COMMISSION  
**RECEIVED**

SEP 28 1979

O. C. C.

30-015-23011  
Form C-101  
Revised 1-1-65

5A. Indicate Type of Lease	
STATE <input checked="" type="checkbox"/>	FEE <input type="checkbox"/>
5. State Oil & Gas Lease No.	
OG 783	

ARTESIA OFFICE  
**APPLICATION FOR PERMIT TO DRILL, DEEPEN, OR PLUG BACK**

1a. Type of Work		7. Unit Agreement Name	
b. Type of Well OIL WELL <input checked="" type="checkbox"/> GAS WELL <input type="checkbox"/> OTHER <input type="checkbox"/>		8. Farm or Lease Name Greagewood BD State	
2. Name of Operator YATES PETROLEUM Corp.		9. Well No. 2	
3. Address of Operator 207 South Fourth, Artesia, N. Mex, 88210		10. Field and Pool, or Wildcat Penasco Draw (Yeso, S.A.)	
4. Location of Well UNIT LETTER <u>E</u> LOCATED <u>2310</u> FEET FROM THE <u>North</u> LINE AND <u>990</u> FEET FROM THE <u>West</u> LINE OF SEC. <u>6</u> TWP. <u>19S</u> RGE. <u>25E</u> NMPM		12. County Eddy	
19. Proposed Depth 3150		19A. Formation Yeso	20. Rotary or C.T. Rotary
21. Elevations (Show whether DF, RT, etc.) 3652	21A. Kind & Status Plug. Bond Blanket	21B. Drilling Contractor LaRue Dtg Co	22. Approx. Date Work will start October 1 1979

**PROPOSED CASING AND CEMENT PROGRAM**

SIZE OF HOLE	SIZE OF CASING	WEIGHT PER FOOT	SETTING DEPTH	SACKS OF CEMENT	EST. TOP
15"	10 3/4"	32.75	Approx. 320'	275	Circulated
9 5/8"	7"	20	Approx. 1000'	500	Circulated
6 1/4"	4 1/2"	9.5	Approx. 3150'	200	Circulated

Propose to drill a Yeso test well. Approx 320' of surface casing will be set to shut off gravel & caving, and intermediate casing will be set 100' below the Artesian Water zone. A 4 1/2" Production string will be run to TD and all strings circulated. Well will be perforated and stimulated for production.

Mud Program: S.W. Gel & LCM to 1000'; fresh Water to TD.

BOP Program: BOP's will be installed on the 7" csq and tested pipe rams daily blind rams on trips.

APPROVAL VALID  
FOR 90 DAYS UNLESS  
DRILLING COMMENCED,

EXPIRES 12-28-79

IN ABOVE SPACE DESCRIBE PROPOSED PROGRAM: IF PROPOSAL IS TO DEEPEN OR PLUG BACK, GIVE DATA ON PRESENT PRODUCTIVE ZONE AND PROPOSED NEW PRODUCTIVE ZONE. GIVE BLOWOUT PREVENTER PROGRAM, IF ANY.

I hereby certify that the information above is true and complete to the best of my knowledge and belief.

Signed Eddie L. Melby Title Engineer Date 9-28-79

(This space for State Use)

APPROVED BY W.A. Gressett TITLE SUPERVISOR, DISTRICT II DATE SEP 28 1979

CONDITIONS OF APPROVAL, IF ANY:

Cement must be circulated to surface behind 10 3/4" - 7" + 4 1/2" casing

Notify N.M.O.C.C. in sufficient time to witness cementing the 7" casing

NEW MEXICO OIL CONSERVATION COMMISSION  
WELL LOCATION AND ACREAGE DEDICATION PLAT

Form C-102  
Supersedes C-128  
Effective 1-1-65

All distances must be from the outer boundaries of the Section.

Operator <b>YATES PETROLEUM CORPORATION</b>			Lease <b>Greasewood BD State</b>		Well No. <b>2</b>
Unit Letter <b>E</b>	Section <b>6</b>	Township <b>19-S</b>	Range <b>25-E</b>	County <b>Eddy</b>	
Actual Footage Location of Well: <b>2310</b> feet from the <b>North</b> line and <b>990</b> feet from the <b>West</b> line					
Ground Level Elev. <b>3652</b>	Producing Formation <b>Yeso</b>		Pool <b>Und Penasco Draw (Yeso, S.A.)</b>	Dedicated Acreage: <b>4.00</b> Acres	

1. Outline the acreage dedicated to the subject well by colored pencil or ink marks on the plat below.
2. If more than one lease is dedicated to the well, outline each and identify the ownership thereof (both as to working interest and royalty).
3. If more than one lease of different ownership is dedicated to the well, have the interests of all owners been consolidated by communitization, unitization, force-pooling, etc?

☐ Yes ☐ No If answer is "yes," type of consolidation \_\_\_\_\_

If answer is "no," list the owners and tract descriptions which have actually been consolidated. (Use reverse side of this form if necessary.) \_\_\_\_\_

No allowable will be assigned to the well until all interests have been consolidated (by communitization, unitization, forced-pooling, or otherwise) or until a non-standard unit, eliminating such interests, has been approved by the Commission.

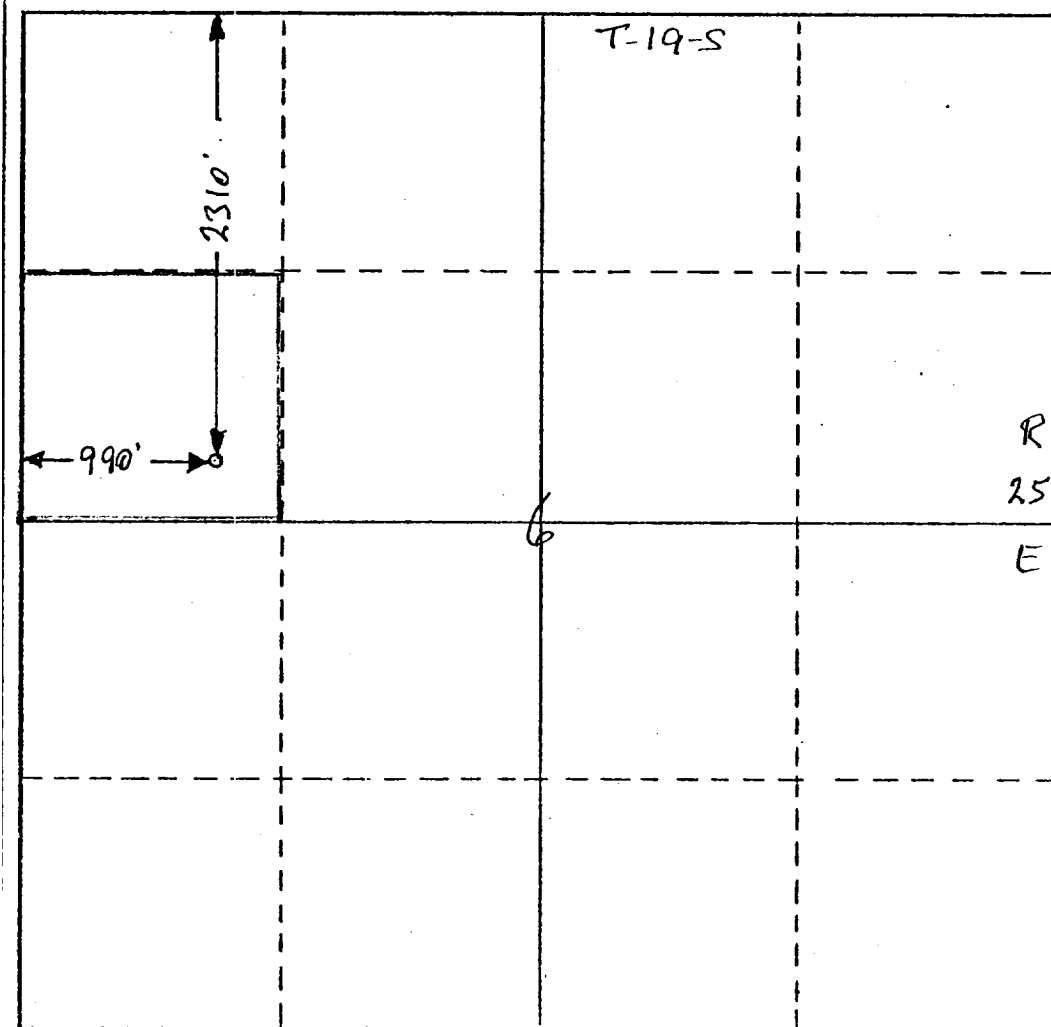

CERTIFICATION

I hereby certify that the information contained herein is true and complete to the best of my knowledge and belief.

*Eddie M. Mahfood*

Name  
**Eddie M. Mahfood**

Position  
**ENGINEER**

Company  
**Yates Petroleum Corp**

Date  
**9-28-79**

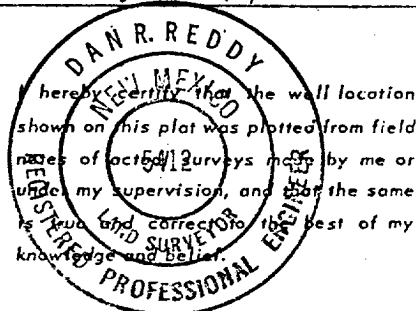

Date Surveyed

Registered Professional Engineer  
and/or Land Surveyor

*Dan R. Reddy*

Certificate No.  
**NM PE&LS #5412**

