

NO. OF COPIES RECEIVED	6
DISTRIBUTION	
SANTA FE	1
FILE	1 ✓
U.S.G.S.	2
LAND OFFICE	1
OPERATOR	1

NEW MEXICO OIL CONSERVATION COMMISSION

RECEIVED

OCT 9 1979

O. C. C.

ARTESIA, OFFICE

30-015-23033

Form C-101
Revised 1-1-65

5A. Indicate Type of Lease

STATE ☒ FEE ☐

5. State Oil & Gas Lease No.

L 3099

APPLICATION FOR PERMIT TO DRILL, DEEPEN, OR PLUG BACK

1a. Type of Work		7. Unit Agreement Name	
b. Type of Well DRILL <input checked="" type="checkbox"/> DEEPEN <input type="checkbox"/> PLUG BACK <input type="checkbox"/> OIL WELL <input type="checkbox"/> GAS WELL <input checked="" type="checkbox"/> OTHER <input type="checkbox"/> SINGLE ZONE <input checked="" type="checkbox"/> MULTIPLE ZONE <input type="checkbox"/>		Parkway West	
2. Name of Operator		8. Farm or Lease Name	
The Petroleum Corporation		Parkway West Unit	
3. Address of Operator		9. Well No.	
1440 Midland Natl. Bank Tower, Midland, Texas 79701		8	
4. Location of Well UNIT LETTER <u>K</u> LOCATED <u>1980</u> FEET FROM THE <u>South</u> LINE AND <u>1980</u> FEET FROM THE <u>West</u> LINE OF SEC. <u>22</u> TWP. <u>19-S</u> RGE. <u>29-E</u> NMPM		10. Field and Pool, or Wildcat Undesignated Parkway West (Morrow)	
		12. County	
		Eddy	
		13. Proposed Depth	19A. Formation
		11,800'	Morrow
		20. Rotary or C.T.	
		Rotary	
21. Elevations (Show whether DE, KI, etc.)	21A. Kind & Status Plug. Bond	21B. Drilling Contractor	22. Approx. Date Work will start
3292.7 GR	Blanket	Warton	Nov. 10, 1979

23.

PROPOSED CASING AND CEMENT PROGRAM

SIZE OF HOLE	SIZE OF CASING	WEIGHT PER FOOT	SETTING DEPTH	SACKS OF CEMENT	EST. TOP
17-1/2"	13-3/8"	48#	350	600	Circ.
12-1/4"	8-5/8"	24# & 32#	3,100	1400	Circ.
7-7/8"	4-1/2"	11.6# & 13.5#	11,000	1000	8500'

Set surface casing into T/Salt estimated to be 350', circ. cement. Drill 12-1/4" hole with brine water to prevent washout to 3100', set 8-5/8" casing @ 3100', circ. cement. Drill 7-7/8" hole with fresh water to 9000'. Add brine water @ 9500' to raise mud weight. Drill to TD of 11,800' to test Morrow and intermediate horizons. If commercial, will run casing to TD. Cement with sufficient cement to bind cement above all prospective zones. Estimated T/cement to be 8500'. Perf and stimulate Morrow for production.

NOTE: Gas is not dedicated.

MUD PROGRAM: 0-350': spud mud; 350-3100': 10# brine water; 3100-9000': fresh water; 9000-10,800': cut brine water gel MW 9.4, vis 35; 10,800-TD: starch, salt gel & Drispac MW 9.7, vis 36-40 @ TD. WL 6 cc thru Morrow. Bottom hole pressure @ TD anticipated to be 4700 psi. No abnormal pressures expected. BOP PROGRAM: BOPs to be installed on 13-3/8" & 8-5/8" casing. BOP to be tested daily. Test with yellow jacket prior to drilling. formation.

IN ABOVE SPACE DESCRIBE PROPOSED PROGRAM; IF PROPOSAL IS TO DEEPEN OR PLUG BACK, GIVE DATA ON PRESENT PRODUCTION ZONE AND PROPOSED NEW PRODUCTION ZONE. GIVE BLOWOUT PREVENTER PROGRAM, IF ANY.

I hereby certify that the information above is true and complete to the best of my knowledge and belief.

Signed G. K. Gleitman Title District Engineer Date 10-4-79

(This space for State Use)

APPROVED BY W. A. Gressett TITLE SUPERVISOR, DISTRICT II DATE OCT 16 1979

CONDITIONS OF APPROVAL, IF ANY:

Cement must be circulated to surface behind 13 3/8" - 8 5/8" casing

NEW MEXICO OIL CONSERVATION COMMISSION
WELL LOCATION AND ACREAGE DEDICATION PLAT

Form O-122
Supersedes O-122
Effective 1-1-65

All distances must be from the outer boundaries of the Section

Operator Petroleum Corporation XXXXXXXXXX		Lease Parkway West Unit		Well No. 8
Tract Letter K	Section 22	Township 19 South	Range 29 East	County Eddy
Actual First Location of Well: 1980 feet from the South line and 1980 feet from the West line				
Ground Level Elev 3292.7	Producing Formation Morrow	For Undesignated Parkway West (Morrow)	Estimated Acreage S/2 320	

- Outline the acreage dedicated to the subject well by colored pencil or ballpoint pen on this plat below.
- If more than one lease is dedicated to the well, outline each and identify the ownership thereof (both as to working interest and royalty)
- If more than one lease of different ownership is dedicated to the well, have the interests of all owners been consolidated by communitization, unitization, force-pooling, etc?

RECEIVED

OCT 9 1979

O. O. O.
ARTESIA, OFFICE

☒ Yes ☐ No If answer is "yes," type of consolidation Unitization

If answer is "no," list the owners and tract descriptions which have actually been consolidated (Use reverse side of this form if necessary.)

No allowable will be assigned to the well until all interests have been consolidated (by communitization, unitization, forced-pooling, or otherwise) or until a non-standard unit, eliminating such interests, has been approved by the Commission.

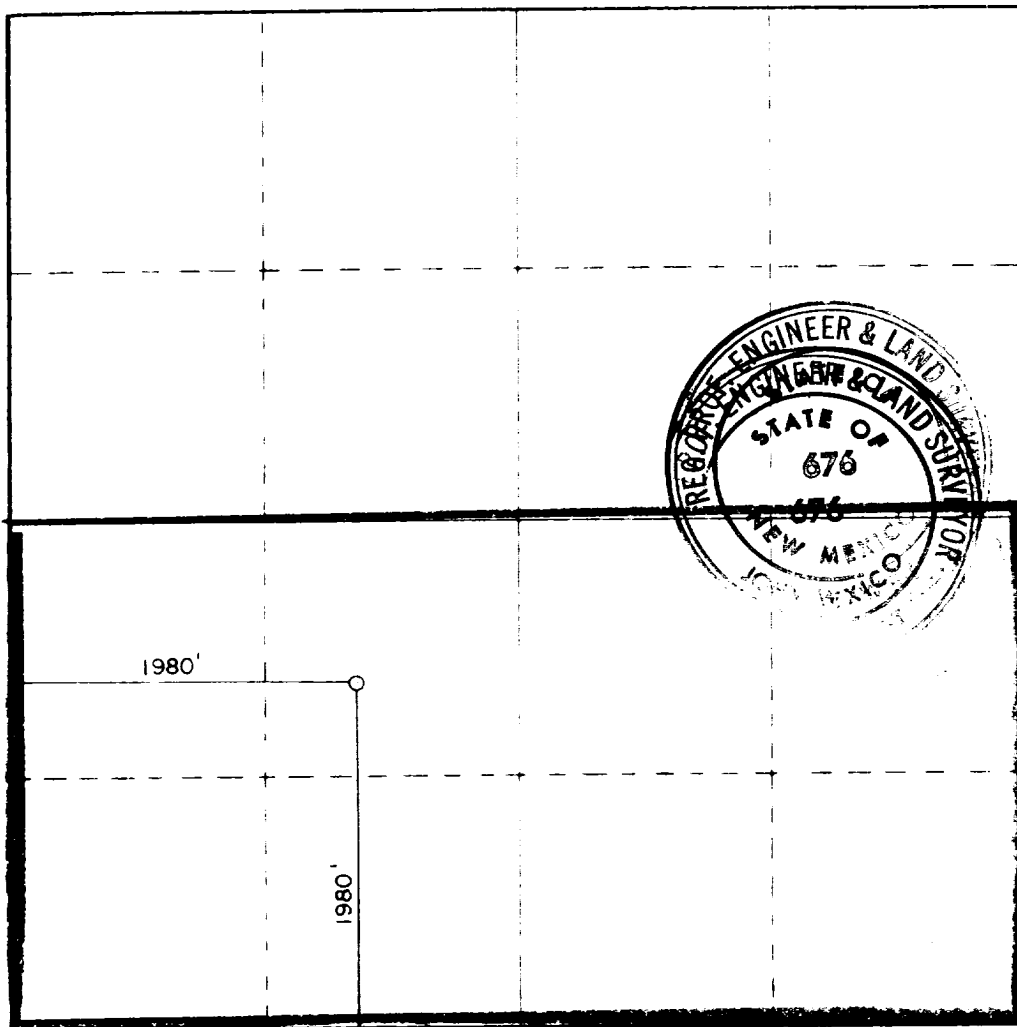

CERTIFICATION

I hereby certify that the information contained herein is true and complete to the best of my knowledge and belief

Name
J. K. Gleitman
Position
District Engineer

Company
The Petroleum Corporation

Date
10-4-79

I hereby certify that the well location shown on this plat was plotted from field notes of actual surveys made by me or under my supervision, and that the same is true and correct to the best of my knowledge and belief.

Date Surveyed
September 28, 1979
Registered Professional Engineer and Land Surveyor

John W. West

Certificate No. John W. West 676
Ronald J. Eidson 3239

