

NEW MEXICO OIL CONSERVATION COMMISSION
WELL LOCATION AND ACREAGE DEDICATION PLAT

Form C-102
Supersedes C-128
Effective 1-1-65

All distances must be from the outer boundaries of the Section

Operator SOUTHLAND ROYALTY Co.			Lease State 14 A com		Well No. 1
Unit Letter G	Section 14	Township 19 South	Range 29 East	County Eddy	
Actual Footage Location of Well:					
1325 feet from the North line and		2303 feet from the East line			
Ground Level Elev. 3357	Producing Formation Morrow	Pool Undesignated (Turkey Track Morrow)		Dedicated Acreage: 320	Acres

- Outline the acreage dedicated to the subject well by colored pencil or hachure marks on the plat below.
- If more than one lease is dedicated to the well, outline each and identify the ownership thereof (both as to working interest and royalty).
- If more than one lease of different ownership is dedicated to the well, have the interests of all owners been consolidated by communitization, unitization, force-pooling, etc?

☒ Yes ☐ No If answer is "yes" type of consolidation Communitized

If answer is "no," list the owners and tract descriptions which have actually been consolidated (Use reverse side of this form if necessary.)

No allowable will be assigned to the well until all interests have been consolidated (by communitization, unitization, forced-pooling, or otherwise) or until a non-standard unit, eliminating such interests, has been approved by the Commission.

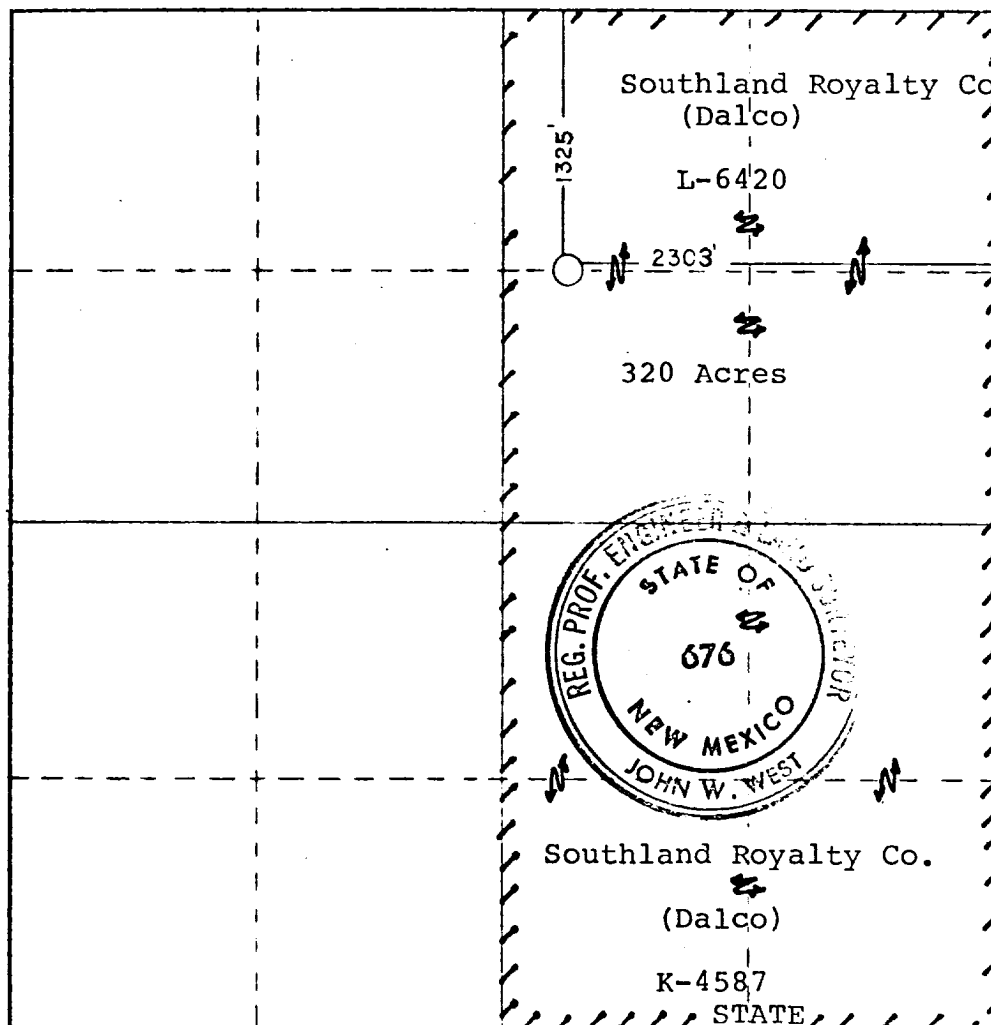

CERTIFICATION

I hereby certify that the information contained herein is true and complete to the best of my knowledge and belief

Name
C. Harney Can
Position
District Engineer
Company
Southland Royalty Co.
Date
October 18, 1979

I hereby certify that the well location shown on this plat was plotted from field notes of actual surveys made by me or under my supervision, and that the same is true and correct to the best of my knowledge and belief

Date
October 12, 1979
Registered Professional Engineer
and Land Surveyor

John W. West
Certificate No. **John W. West 676**

