

NEW MEXICO OIL CONSERVATION COMMISSION
WELL LOCATION AND ACREAGE DEDICATION PLAT

Form C-102
 Supersedes C-128
 Effective 1-1-65

All distances must be from the outer boundaries of the Section.

Operator YATES PETROLEUM CORPORATION			Lease Rio Penasco NF Federal		Well No. 1
Unit Letter F	Section 11	Township 19 South	Range 25 East	County Eddy	

Actual Footage Location of Well:
 1980 feet from the North line and 1980 feet from the West line

Ground Level Elev. 3453.8	Producing Formation MORROW	Pool UNDES. MORROW	Dedicated Acreage 1.0000
-------------------------------------	--------------------------------------	------------------------------	------------------------------------

- Outline the acreage dedicated to the subject well by colored pencil or machine marks on the plat below.
- If more than one lease is dedicated to the well, outline each and identify the ownership thereof (as to working interest and royalty).
- If more than one lease of different ownership is dedicated to the well, have the interests of the well been consolidated by communitization, unitization, force-pooling, etc?

☒ Yes ☐ No If answer is "yes," type of consolidation TO BE COMMUNITIZED

If answer is "no," list the owners and tract descriptions which have actually been consolidated. (Use reverse side of this form if necessary.)

No allowable will be assigned to the well until all interests have been consolidated (by communitization, unitization, forced-pooling, or otherwise) or until a non-standard unit, eliminating such interests, has been approved by the Commission.

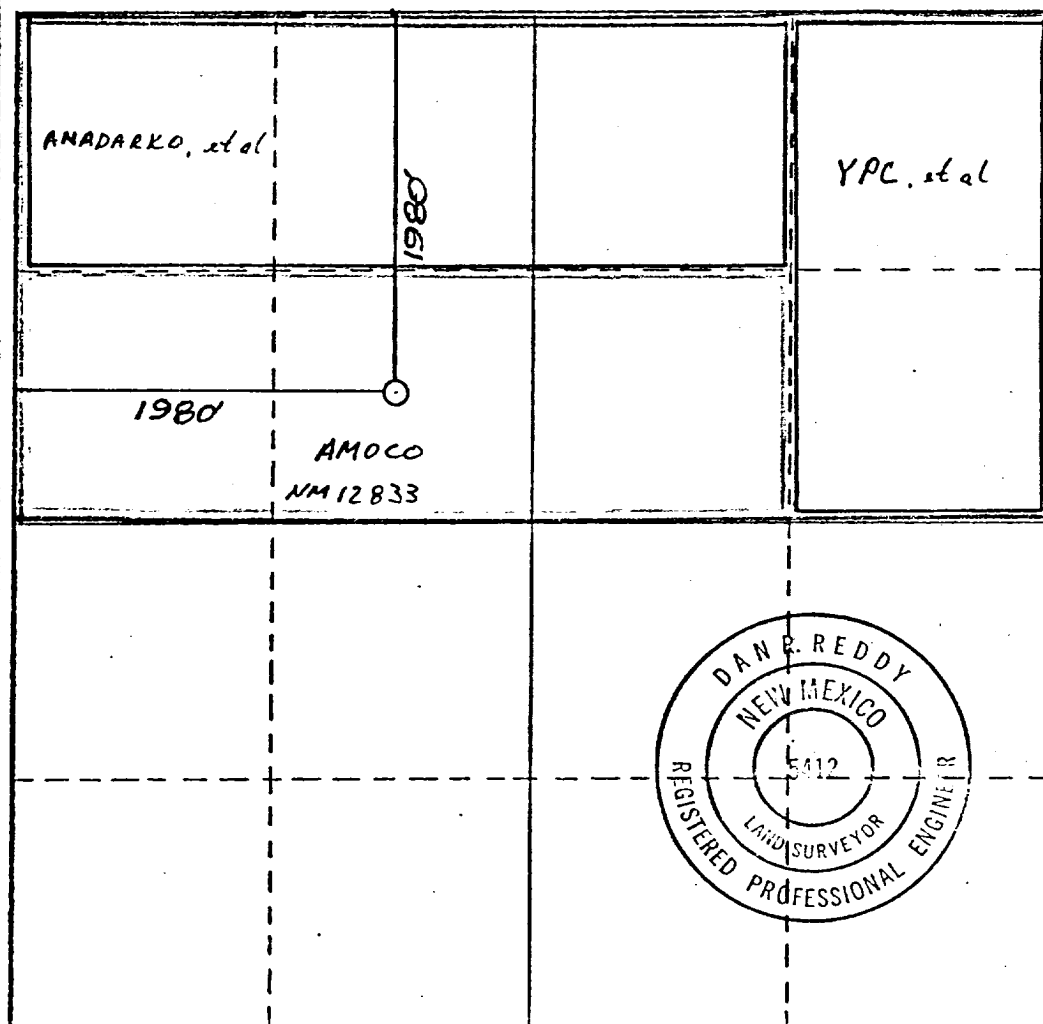

CERTIFICATION

I hereby certify that the information contained herein is true and complete to the best of my knowledge and belief.

Gliserio Rodriguez

Name
GLISERIO RODRIGUEZ
 Position
GEOGRAPHER
 Company
YATES PETROLEUM CORP
 Date
11-12-79

I hereby certify that the well location shown on this plat was plotted from field notes of actual surveys made by me or under my supervision, and that the same is true and correct to the best of my knowledge and belief.

Date Surveyed
October 27, 1979
 Registered Professional Engineer and/or Land Surveyor

Dan R. Reddy

Certificate No.
NM PE&LS #5412