

NE EXICO OIL CONSERVATION COMMISSION
WELL LOCATION AND ACREAGE DEDICATION PLAT

Form O-102
Supersedes O-128
Effective 12-65

All distances must be from the outer boundaries of the Section

Owner <i>The</i> Petroleum Corporation		Lease Parkway West Unit		Well No. 109	
Section G	Section 21	Range 19South	Range 29East	County Eddy	
Actual Surface Location of Well: 1980 feet from the North line and 1980 feet from the East line					
Ground Level Elev 3342'	Producing Formation Morrow	Foot Undesignated Parkway West (Morrow)	Estimated Acreage N/2 320		

- Outline the acreage dedicated to the subject well by colored pencil or hatchure marks on the plat below.
- If more than one lease is dedicated to the well, outline each and identify the ownership thereof (both as to working interest and royalty).
- If more than one lease of different ownership is dedicated to the well, have the interests of all owners been consolidated by communitization, unitization, force-pooling, etc?

☒ Yes ☐ No If answer is "yes," type of consolidation Unitization

If answer is "no," list the owners and tract descriptions which have actually been consolidated (Use reverse side of this form if necessary.) _____

No allowable will be assigned to the well until all interests have been consolidated (by communitization, unitization, forced-pooling, or otherwise) or until a non-standard unit, eliminating such interests, has been approved by the Commission.

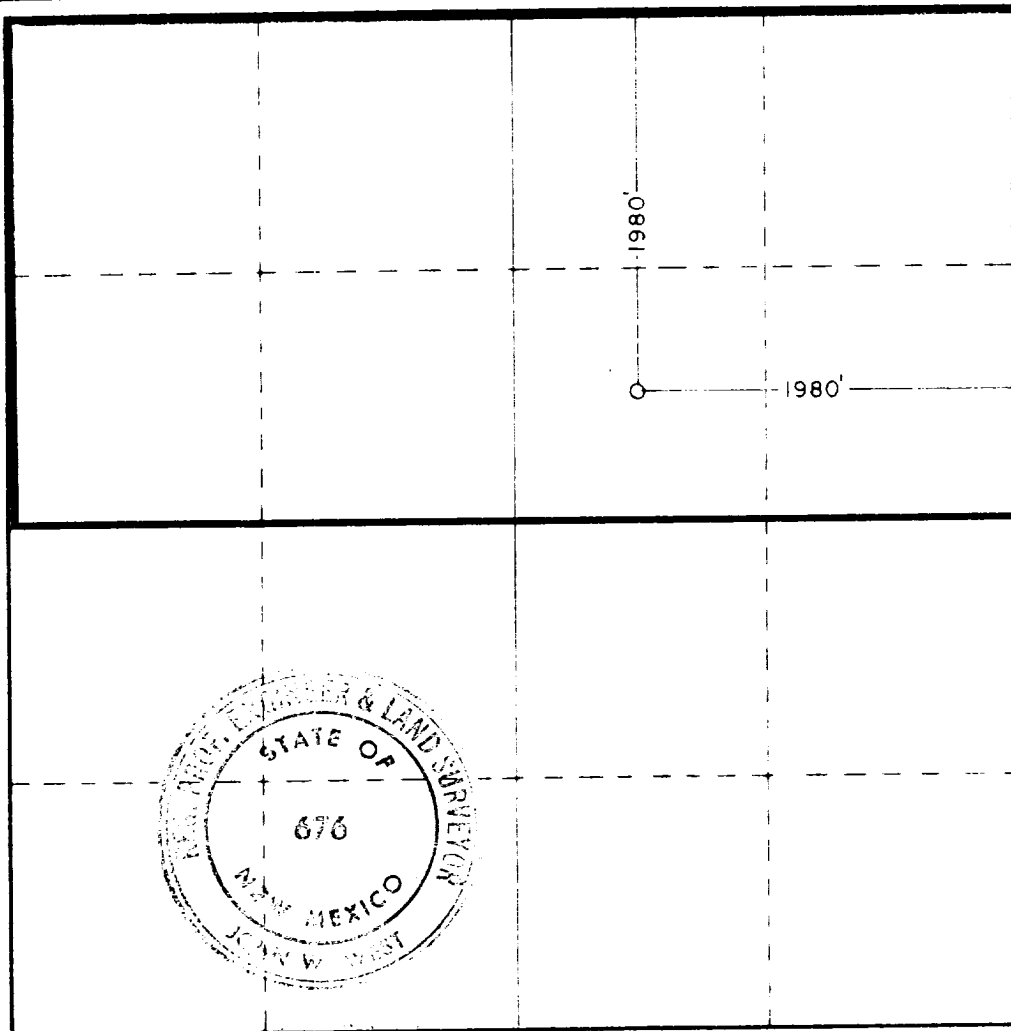

CERTIFICATION

I hereby certify that the information contained herein is true and complete to the best of my knowledge and belief

Claudia Ofield
Claudia Ofield

Position
Engineering Assistant

Company
The Petroleum Corporation

Date
August 10, 1981

I hereby certify that the well location shown on this plat was plotted from field notes of actual surveys made by me or under my supervision and that the same is true and correct to the best of my knowledge and belief

Date Received
July 30, 1981

Registered Professional Engineer
in Oil and Gas Engineering

John W. West
Certificate No. JOHN W. WEST 676
PATRICK A. ROMERO 6883
Ronald J. Eidson 3239

