

NEW MEXICO OIL CONSERVATION COMMISSION  
WELL COMPLETION OR RECOMPLETION REPORT AND LOG

RECEIVED

APR 11 1980

NO. OF COPIES RECEIVED	
DISTRIBUTION	
SANTA FE	1
FILE	1 ✓
U.S.G.S.	2
LAND OFFICE	1
OPERATOR	

BM 1

5a. Indicate Type of Lease  
State     
5. State Oil & Gas Lease No.  
**B-8876**

1a. TYPE OF WELL  
OIL WELL  GAS WELL  DRY  OTHER   
b. TYPE OF COMPLETION  
NEW WELL  WORK OVER  DEEPEN  PLUG BACK  DIFF. REGRV.  OTHER   
2. Name of Operator  
**Marbob Energy Corp.**

7. Unit Agreement Name  
**Turkey Track Sec 3 Ut**  
8. Farm or Lease Name  
**Turkey Track Sec. 3 Ut**

3. Address of Operator  
**P.O. Box 304, Artesia, N.M. 88210**  
4. Location of Well

9. Well No.  
**22**  
10. Field and Pool, or Wellcut  
**Turkey Track SR-Q-G**

UNIT LETTER **B** LOCATED **990** FEET FROM THE **North** LINE AND **1670** FEET FROM  
THE **East** LINE OF SEC. **3** TWP. **19S** RGE. **29E** NMPM

11. County  
**Eddy**

15. Date Spudded **3/24/80** 16. Date T.D. Reached **3/29/80** 17. Date Compl. (Ready to Prod.) **4/3/80** 18. Elevations (DF, RKB, RT, GR, etc.) **3409' GR** 19. Elev. Casinghead **3409' GR**  
20. Total Depth **3000'** 21. Plug Back T.D. **2965'** 22. If Multiple Compl., How Many  
23. Intervals Drilled By  
24. Producing Interval(s), of this completion - Top, Bottom, Name  
**2210-2588' Queen; 2686-2826' Grayburg**

12. County  
**Eddy**  
13. Elev. Casinghead  
**3409' GR**  
25. Was Directional Survey Made  
**Yes**

26. Type Electric and Other Logs Run  
**Gamma ray neutron**  
27. Was Well Cored  
**No**

28. CASING RECORD (Report all strings set in well)

CASING SIZE	WEIGHT LB./FT.	DEPTH SET	HOLE SIZE	CEMENTING RECORD	AMOUNT PULLED
8 5/8"	24#	290.38'	12 1/2"	150 sax 2% CC	
4 1/2"	10.50#	3000'	7 7/8"	425 sax Class H, 5/10 of 1# CFR-w 5# salt, 10# #3 sand per sack	

29. LINER RECORD

SIZE	TOP	BOTTOM	SACKS CEMENT	SCREEN

30. TUBING RECORD

SIZE	DEPTH SET	PACKER SET
2 3/8"	2846'	

31. Perforation Record (Interval, size and number)

2210 - 2402, 36 holes  
2498 - 2588, 18 holes  
2686 - 2826, 20 holes

32. ACID, SHOT, FRACTURE, CEMENT SQUEEZE, ETC.

DEPTH INTERVAL	AMOUNT AND KIND MATERIAL USED
2210-2826	195,000 gal gel water 104,000# 20/40 sand, 75,000# 10/20 sand

33. PRODUCTION

Date First Production **4/7/80** Production Method (Flowing, gas lift, pumping - Size and type pump) **Pumping - 1 1/2"** Well Status (Prod. or Shut-in) **Prod.**

Date of Test	Hours Tested	Choke Size	Prod'n. Per Test Period	Oil - Bbl.	Gas - MCF	Water - Bbl.	Gas - Oil Ratio
4/6/80	24			50	to pipeline	50	

Flow Tubing Press.	Casing Pressure	Calculated 24-Hour Rate	Oil - Bbl.	Gas - MCF	Water - Bbl.	Oil Gravity - API (Corr.)
			50	to pipeline	50	

34. Disposition of Gas (Sold, used for fuel, vented, etc.) **Sold** Test Witnessed By **Mack C. Chase**

35. List of Attachments  
**GRN log, deviation survey**

36. I hereby certify that the information shown on both sides of this form is true and complete to the best of my knowledge and belief.

SIGNED Carolyn Cris TITLE Secretary DATE 4/9/80



From	To	Thickness in feet	Format
0	40	40	Sand
40	60	20	Caliche
60	115	55	Red shale
115	125	10	Sand & gravel
125	140	15	Red shale
140	175	35	Anhydrite
175	230	55	Brown shale
230	270	40	Anhydrite
270	310	40	Shale
310	375	65	Salt
375	400	25	Anhydrite
400	500	100	Salt
500	550	50	Anhydrite
550	580	30	Salt
580	600	20	Anhydrite
600	780	180	Salt
780	925	145	Anhydrite
925	950	25	Salt
950	1250	300	Anhydrite
1250	1255	5	Lime
1255	1350	95	Lime, anhydrite
1350	1370	20	Sand
1370	1450	80	Lime, anhydrite
1450	1470	20	Lime, sand
1470	1500	30	Lime, anhydrite
1500	1550	50	Dolomite, anhydrite, sand, shale
1550	1570	20	Dolomite, anhydrite, sand
1570	1630	60	Dolomite, anhydrite, red shale, sand
1630	1830	200	Dolomite, anhydrite, shale
1830	1860	30	Dolomite
1860	1880	20	Dolomite, anhydrite
1880	1900	20	Dolomite, shale
1900	1940	40	Dolomite, anhydrite
1940	1980	40	Dolomite
1980	2000	20	Dolomite, anhydrite, shale, sand
2000	2020	20	Dolomite, shale
2020	2040	20	Dolomite, anhydrite, shale
2040	2050	10	Dolomite, anhydrite, shale, sand
2050	2060	10	Dolomite, shale, sand
2060	2100	40	Dolomite, anhydrite, sand
2100	2130	30	Dolomite, shale, sand
2130	2140	10	Dolomite, anhydrite, shale, sand
2140	2160	20	Dolomite, shale, sand
2160	2180	20	Dolomite, shale, sand, anhydrite
2180	2190	10	Dolomite, shale, sand
2190	2200	10	Dolomite, sand
2200	2220	20	Dolomite
2220	2410	190	Dolomite, sand
2410	2420	10	Dolomite, sand, anhydrite
2420	2430	10	Dolomite, sand
2430	2450	20	Dolomite, sand, anhydrite
2450	2470	20	Dolomite, sand
2470	2500	30	Dolomite, sand, anhydrite
2500	2560	60	Dolomite
2560	2900	340	Dolomite, sand
2900	2960	60	Dolomite
2960	3000	40	Dolomite, anhydrite
3000			TD
2965			PBTD

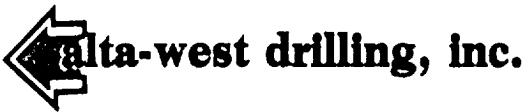

RECEIVED

WM. N. MORGAN  
Off. Ph.: 805-748-2194  
Home Ph.: 805-748-2325  
P. O. Drawer 1  
Artesia, N.M. 88210

APR 11 1980

O. C. D.  
ARTESIA, OFFICE

April 1, 1980

Marbob Energy Corp.  
P.O. Box 304  
Artesia, New Mexico 88210

Re: Turkey Track Sec. 3 Ut. #22 ✓  
Sec 3 Twn19 Rge29  
990/N 1670/E Unit B  
Eddy County, New Mexico

Gentlemen:

The following is a Deviation Survey of the  
above well:

- 330' - 1/2 degree
- 857' - 1/2 degree
- 1329' - 3/4 degree
- 1834' - 3/4 degree
- 2303' - 1 degree
- 2411' - 1 degree
- 2902' - 1 3/4 degree
- 3012' - 2 degree

Yours truly,

*William N. Morgan*

William N. Morgan  
Alta-West Drlg., Inc.

STATE OF NEW MEXICO )  
                                  )  
COUNTY OF EDDY        )

The foregoing was acknowledged before me this 2nd day  
of April, 1980, by William N. Morgan.

My Commission Expires:  
June 23, 1981

Betty J. Klein  
Notary Public

OIL CONSERVATION DIVISION  
P. O. BOX 2088  
SANTA FE, NEW MEXICO 87501

Form C-103  
Revised 10-1-79

NO. OF COPIES RECEIVED		
DISTRIBUTION		
SANTA FE	1	
FILE	1	1
U.S.O.S.		
LAND OFFICE		
OPERATOR	1	

RECEIVED  
APR 2 1980

5a. Indicate Type of Lease  
State  Fee   
5. State Oil & Gas Lease No.  
B-8876

SUNDRY NOTICES AND REPORTS ON WELLS *ARTESIA DISTRICT*  
(DO NOT USE THIS FORM FOR PROPOSALS TO DRILL OR TO DEEPEN OR PLUG BACK TO A DIFFERENT RESERVOIR. USE "APPLICATION FOR PERMIT -" (FORM C-101) FOR SUCH PROPOSALS.)

OIL WELL  GAS WELL  OTHER   
Name of Operator: Marbob Energy Corp. ✓  
Address of Operator: P.O. Box 304, Artesia, N.M. 88210  
Location of Well: UNIT LETTER B 990 FEET FROM THE North LINE AND 1670 FEET FROM THE East LINE, SECTION 3 TOWNSHIP 19S RANGE 29E N.M.P.M.  
15. Elevation (Show whether DF, RT, GR, etc.): 3409 GR  
12. County: Eddy  
7. Unit Agreement Name: Turkey Track Sec 3 Ut  
8. Farm or Lease Name: Turkey Track Sec. 3 Ut  
9. Well No.: 22  
10. Field and Pool, or Wildcat: Turkey Track SR-Q-G

6. Check Appropriate Box To Indicate Nature of Notice, Report or Other Data

NOTICE OF INTENTION TO:		SUBSEQUENT REPORT OF:	
PERFORM REMEDIAL WORK <input type="checkbox"/>	PLUG AND ABANDON <input type="checkbox"/>	REMEDIAL WORK <input type="checkbox"/>	ALTERING CASING <input type="checkbox"/>
TEMPORARILY ABANDON <input type="checkbox"/>	CHANGE PLANS <input type="checkbox"/>	COMMENCE DRILLING OPNS. <input type="checkbox"/>	PLUG AND ABANDONMENT <input type="checkbox"/>
PULL OR ALTER CASING <input type="checkbox"/>	OTHER <input type="checkbox"/>	CASING TEST AND CEMENT JOBS <input checked="" type="checkbox"/>	OTHER <input type="checkbox"/>

7. Describe Proposed or Completed Operations (Clearly state all pertinent details, and give pertinent dates, including estimated date of starting any proposed work) SEE RULE 1103.

3/29/80 TD 3012'. Conditioned hole, lay down drill pipe & collars, ran guide shoe, insert float on short jt., ran 91 jts. 4½" 10.50# new casing, landed @ 3012' KB, 3000' GR, pumped 425 sax Class H cement, 5/10 of 1% CFR-2, 5# salt, 10# #3 sand per sack. Plug down @ 7:30 am 3/29/80. Ran temperature survey - top of cement @ 1140'.

8. I hereby certify that the information above is true and complete to the best of my knowledge and belief.

SIGNED Carolyn Orris TITLE Secretary DATE 4/1/80  
APPROVED BY W.A. Gressett TITLE SUPERVISOR, DISTRICT II DATE APR 3 1980  
CONDITIONS OF APPROVAL, IF ANY:

NO. OF COPIES RECEIVED	
DISTRIBUTION	
SANTA FE	1
FILE	1
U.S.G.S.	
LAND OFFICE	
OPERATOR	1

MAR 26 1980

O. C. D.

ARTESIA, OFFICE

5a. Indicate Type of Lease  
State  For

5. State Oil & Gas Lease No.  
B-8876

SUNDRY NOTICES AND REPORTS ON WELLS  
(DO NOT USE THIS FORM FOR PROPOSALS TO DRILL OR TO DEEPEN OR PLUG BACK TO A DIFFERENT RESERVOIR. USE "APPLICATION FOR PERMIT -" (FORM C-101) FOR SUCH PROPOSALS.)

OIL WELL  GAS WELL  OTHER

Name of Operator  
Marbob Energy Corp. ✓

Address of Operator  
P.O. Box 304, Artesia, N.M. 88210

Location of Well  
UNIT LETTER B 990 FEET FROM THE North LINE AND 1670 FEET FROM  
THE East LINE, SECTION 3 TOWNSHIP 19S RANGE 29E N.M.P.M.

7. Unit Agreement Name  
Turkey Track Sec. 3 Ut.

8. Farm or Lease Name  
Turkey Track Sec 3 Ut.

9. Well No.  
22

10. Field and Pool, or Wildcat  
Turkey Track SR-Q-G

12. County  
Eddy

15. Elevation (Show whether DF, RT, GR, etc.)  
3409 GR

6. Check Appropriate Box To Indicate Nature of Notice, Report or Other Data  
NOTICE OF INTENTION TO: SUBSEQUENT REPORT OF:

PERFORM REMEDIAL WORK <input type="checkbox"/>	PLUG AND ABANDON <input type="checkbox"/>	REMEDIAL WORK <input type="checkbox"/>	ALTERING CASING <input type="checkbox"/>
TEMPORARILY ABANDON <input type="checkbox"/>	CHANGE PLANS <input type="checkbox"/>	COMMENCE DRILLING OPNS. <input checked="" type="checkbox"/>	PLUG AND ABANDONMENT <input type="checkbox"/>
PULL OR ALTER CASING <input type="checkbox"/>	OTHER <input type="checkbox"/>	CASING TEST AND CEMENT JOB <input checked="" type="checkbox"/>	

7. Describe Proposed or Completed Operations (Clearly state all pertinent details, and give pertinent dates, including estimated date of starting any proposed work) SEE RULE 1103.

Spudded 3:22 p.m., 3/24/80, drilling 12½" hole, lost circulation @ 60', drilled on to 330', ran Texas pattern shoe, insert float, 7 jts. new 8 5/8" casing, landed @ 290.38' GR, 302.38' KB. Pumped 150 sax 2% calcium chloride cement, plug down @ 1:00 a.m. 3/25/80. Ready mixed to surface w/8 yards. Pressure tested @ 400# for 10 minutes-held okay. WOC 18 hours.

8. I hereby certify that the information above is true and complete to the best of my knowledge and belief.

APPROVED BY Carolyn Orvis TITLE Secretary DATE 3/26/80

APPROVED BY W.A. Gussert TITLE SUPERVISOR, DISTRICT 1 DATE MAR 27 1980

CONDITIONS OF APPROVAL, IF ANY:

NO. OF COPIES RECEIVED		
DISTRIBUTION		
SANTA FE	1	
FILE	1	✓
U.S.G.S.	2	
LAND OFFICE	1	
OPERATOR	1	

**RECEIVED**  
NEW MEXICO OIL CONSERVATION COMMISSION

30-015-23243  
Form C-101  
Revised 1-1-65

MAR 21 1980

O. C. D.  
ARTESIA, OFFICE

5A. Indicate Type of Lease  
STATE  FEE

5. State Oil & Gas Lease No.  
B-8876

APPLICATION FOR PERMIT TO DRILL, DEEPEN, OR PLUG BACK

1a. Type of Work DRILL <input checked="" type="checkbox"/> DEEPEN <input type="checkbox"/> PLUG BACK <input type="checkbox"/>		7. Unit Agreement Name Turkey Track Sec. 3 Ut	
b. Type of Well OIL WELL <input checked="" type="checkbox"/> GAS WELL <input type="checkbox"/> OTHER <input type="checkbox"/>		8. Farm or Lease Name Turkey Track Sec. 3 Ut	
2. Name of Operator Marbob Energy Corp. ✓		9. Well No. 22	
3. Address of Operator P.O. Box 304, Artesia, N.M. 88210		10. Field and Pool, or Wildcat Turkey Track SR Q G	
4. Location of Well UNIT LETTER B LOCATED 990 FEET FROM THE North LINE AND 1670 FEET FROM THE East LINE OF SEC. 3 TWP. 19S RGE. 29E NMPM		12. County Eddy	
19. Proposed Depth 3000'		19A. Formation Grayburg	20. Rotary or C.T. Rotary
21. Elevations (Show whether DT, RT, etc.) 3409 GR	21A. Kind & Status Plug. Bond Statewide active	21B. Drilling Contractor Alta-West Drilling Co.	22. Approx. Date Work will start 3/22/80

23.

PROPOSED CASING AND CEMENT PROGRAM

SIZE OF HOLE	SIZE OF CASING	WEIGHT PER FOOT	SETTING DEPTH	SACKS OF CEMENT	EST. TOP
11"	8 5/8"	20#	300'	Circulate	
7 7/8"	4 1/2"	10.50#	2950'	400 sax	

We propose to drill to approximately 300' and run 8 5/8" casing, circulate cement, drill on to test Grayburg formation at approximately 3000' & set 4 1/2" production string w/400 sax cement, 50/50 poz C, 2% gel. We do not anticipate gas at this depth and will not set up a blowout preventer program at this time.

APPROVAL VALID  
FOR 90 DAYS UNLESS  
DRILLING COMMENCED,

EXPIRES 6-24-80

IN ABOVE SPACE DESCRIBE PROPOSED PROGRAM; IF PROPOSAL IS TO DEEPEN OR PLUG BACK, GIVE DATA ON PRESENT PRODUCTIVE ZONE AND PROPOSED NEW PRODUCTIVE ZONE. GIVE BLOWOUT PREVENTER PROGRAM, IF ANY.

I hereby certify that the information above is true and complete to the best of my knowledge and belief.

Signed Carolyn Arris Title Secretary Date 3/19/80

(This space for State Use)

APPROVED BY W.A. Gressitt TITLE SUPERVISOR, DISTRICT 7A DATE MAR 24 1980

CONDITIONS OF APPROVAL, IF ANY:

NEW MEXICO OIL CONSERVATION COMMISSION  
WELL LOCATION AND ACREAGE DEDICATION PLAT

MAR 21 1980

Form O-107  
Supersedes O-128  
Effective 1-1-65

All distances must be from the outer boundaries of the Section

O. C. O.

Operator <b>MARBOb ENERGY CORPORATION</b>		Section <b>Sec. 3</b>		Office <b>ARTESIA, OFFICE</b>		County <b>22</b>	
Unit Letter <b>B</b>	Location <b>3</b>	Westing <b>19 South</b>	Range <b>29 East</b>	County <b>Eddy</b>			
Actual Footage Location of Well:							
990 feet from the		<b>North</b>		1670 feet to the		<b>East</b>	
Ground Level Elev. <b>3409</b>		Formation <b>Grayburg</b>		Tract Description <b>Turkey Track SR Qn Grbg</b>		Section <b>40</b>	

1. Outline the acreage dedicated to the subject well by colored pencil or hachure marks on the plat below.
2. If more than one lease is dedicated to the well, outline each and identify the ownership thereof (both as to working interest and royalty).
3. If more than one lease of different ownership is dedicated to the well, have the interests of all owners been consolidated by communitization, unitization, forced-pooling, etc?

Yes  No If answer is "yes," type of consolidation \_\_\_\_\_

If answer is "no," list the owners and tract descriptions which have actually been consolidated (Use reverse side of this form if necessary.) \_\_\_\_\_

No allowable will be assigned to the well until all interests have been consolidated (by communitization, unitization, forced-pooling, or otherwise) or until a non-standard unit, eliminating such interests, has been approved by the Commission.

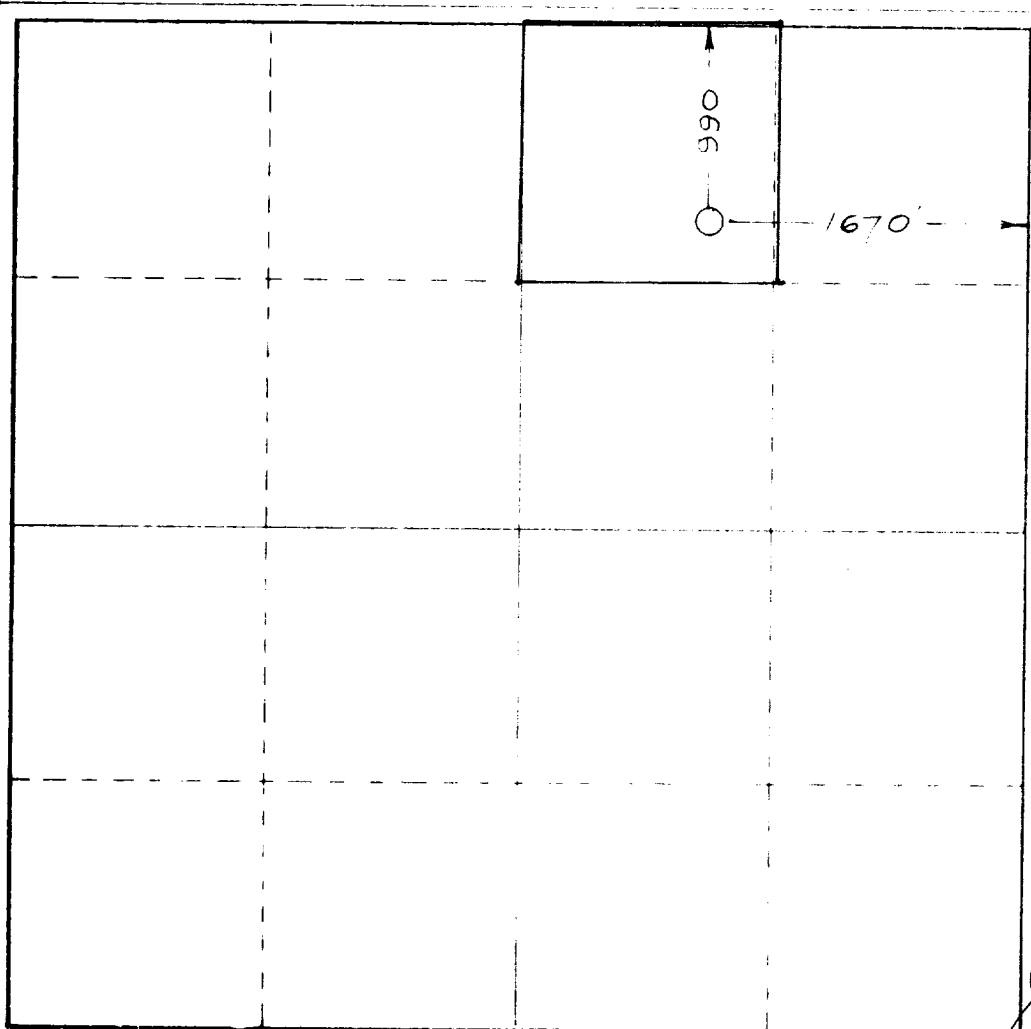

CERTIFICATION

I hereby certify that the information contained herein is true and complete to the best of my knowledge and belief.

*Carylyn Orris*

Secretary

Marbob Energy Corp.

3/19/80

I hereby certify that the well location shown on this plat was plotted from field notes of actual surveys made by me or under my supervision, and that the same is true and correct to the best of my knowledge and belief.

February 13, 1980

Registered Professional Engineer  
in the State of New Mexico

*John W. Shearn*  
1559