

MEXICO OIL CONSERVATION COMMISS. N
WELL LOCATION AND ACREAGE DEDICATION PLAT

Form C-102
 Supersedes C-126
 Effective 1-1-85

All distances must be from the outer boundaries of the Section

Operator CONOCO, INC.			Lease PENNY FEDERAL			Well No. 2		
Unit Letter G	Section 23	Township 20 South	Range 24 East	County Eddy				
Actual Footage Location of Well: 1650 feet from the North line and 1780 feet from the East line								
Ground Level Elev. 3625.1	Producing Formation Morrow		Pool Undesignated Morrow			Dedicated Acreage 320		

1. Outline the acreage dedicated to the subject well by colored pencil or hachure marks on the plat below.
2. If more than one lease is dedicated to the well, outline each and identify the ownership thereof (both as to working interest and royalty).
3. If more than one lease of different ownership is dedicated to the well, have the interests of all owners been consolidated by communitization, unitization, force-pooling, etc?

☐ Yes ☐ No If answer is "yes," type of consolidation _____

If answer is "no," list the owners and tract descriptions which have actually been consolidated. (Use reverse side of this form if necessary.) _____

No allowable will be assigned to the well until all interests have been consolidated (by communitization, unitization, forced-pooling, or otherwise) or until a non-standard unit, eliminating such interests, has been approved by the Commission.

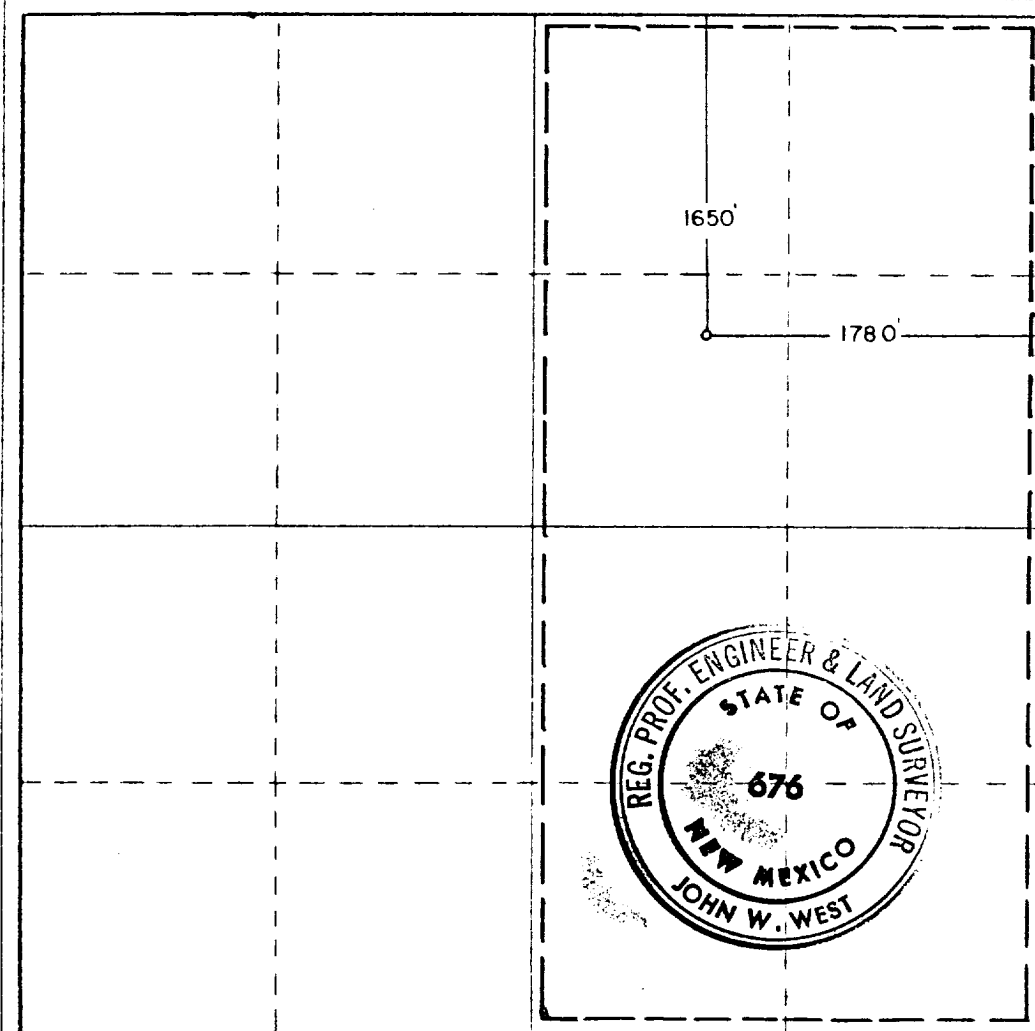

CERTIFICATION

I hereby certify that the information contained herein is true and complete to the best of my knowledge and belief

Name John A. Butterfield
 Title Administrative Supervisor
 Company Conoco Inc.
 Date October 13, 1981

I hereby certify that the well location shown on this plat was plotted from field notes of actual surveys made by me or under my supervision, and that the same is true and correct to the best of my knowledge and belief.

Date Surveyed 10/10/81

Registered Professional Engineer and Land Surveyor

John W. West
 Certificate No **JOHN W. WEST 676**
PATRICK A. ROMERO 6883
Ronald J. Eidson 3239