

NO. OF COPIES RECEIVED	6
DISTRIBUTION	
SANTA FE	1
FILE	1 ✓
U.S.G.S.	2
LAND OFFICE	1
OPERATOR	1

# NEW MEXICO OIL CONSERVATION COMMISSION

JAN 19 1981

O.C.C.

30-015-23620

Form C-101  
Revised 1-1-65

5A. Indicate Type of Lease STATE <input checked="" type="checkbox"/> FEE <input type="checkbox"/>
5. State Oil & Gas Lease No. L - 5360
7. Unit Agreement Name
8. Farm or Lease Name HOPE STATE COM
9. Well No. 1
10. Field and Pool, or Wildcat WILDCAT
12. County EDDY
19. Proposed Depth 8100'
19A. Formation MORROW
20. Rotary or C.T. ROTARY
21. Elevations (Show whether DF, RT, etc.) 4015.8' GR
21A. Kind & Status Plug. Bond BLANKET
21B. Drilling Contractor SHARP
22. Approx. Date Work will start FEBRUARY 1, 1981

APPLICATION FOR PERMIT TO DRILL, DEEPEN, OR PLUG BACK	
1a. Type of Work	
b. Type of Well DRILL <input checked="" type="checkbox"/> DEEPEN <input type="checkbox"/> PLUG BACK <input type="checkbox"/> OIL WELL <input type="checkbox"/> GAS WELL <input checked="" type="checkbox"/> OTHER <input type="checkbox"/> SINGLE ZONE <input checked="" type="checkbox"/> MULTIPLE ZONE <input type="checkbox"/>	
2. Name of Operator Mesa Petroleum Co. ✓	
3. Address of Operator 1000 Vaughn Building / Midland, Texas 79701	
4. Location of Well UNIT LETTER L LOCATED 1980' FEET FROM THE SOUTH LINE AND 660' FEET FROM THE WEST LINE OF SEC. 16 TWP. 19S RGE. 23E NMPM	

PROPOSED CASING AND CEMENT PROGRAM					
SIZE OF HOLE	SIZE OF CASING	WEIGHT PER FOOT	SETTING DEPTH	SACKS OF CEMENT	EST. TOP
17 1/2"	13 3/8"	48#	350'	500	SURFACE
11"	8 5/8"	24#	1900'	1100	SURFACE
7 7/8"	4 1/2"	10.5#	8100'	900	SUFFICIENT TO COVER ALL PAY

Propose to drill 17 1/2" hole to approximately 350' with fresh water gel flocculated with lime and pretreated with lost circulation material. Will cement 13 3/8" casing and nipple up 12" Bradenhead and 10" API 3000 psi BOPs and drill 11" hole to 1900' using fresh water, adding paper for seepage control. Will cement 8 5/8" casing with 200 sx Thixset + 825 sx LW, followed by 200 sx Class "C" or sufficient volume to circulate cement to bottom of surface casing. Will nipple up 12" API 3000 WP x 10" API 3000 WP Casinghead Spool and install 10" API 3000 psi WP BOP stack (consisting of 1 pipe ram, 1 blind ram, 1 bag type BOP) to drill 7 7/8" production hole to total depth. Maximum mud weight should not exceed 9.4 ppg based upon nearby well data.

Operator's gas is not dedicated.

APPROVAL VALID FOR 180 DAYS  
PERMIT EXPIRES 2-23-81  
UNLESS DRILLING UNDERWAY

XC: NMOCD (6), TLS, HOBBS OFFICE, CEN RCDS, ACCTG, MAH, PARTNERS, FILE, MEC  
ABOVE SPACE DESCRIBE PROPOSED PROGRAM: IF PROPOSAL IS TO DEEPEN OR PLUG BACK, GIVE DATA ON PRESENT PRODUCTIVE ZONE AND PROPOSED NEW PRODUCTIVE ZONE. GIVE BLOWOUT PREVENTER PROGRAM, IF ANY.

I hereby certify that the information above is true and complete to the best of my knowledge and belief.

Signed R. P. Nash Title Regulatory Coordinator Date 1-16-81

(This space for State Use)

APPROVED BY W. A. Gussitt TITLE SUPERVISOR, DISTRICT II DATE JAN 23 1981

CONDITIONS OF APPROVAL, IF ANY:

Cement must be circulated to surface behind 13 3/8" & 8 5/8" casing

Notify N.M.O.C.C. in sufficient time to witness cementing

2 5/8" casing

**MEXICO OIL CONSERVATION COMMISSION  
WELL LOCATION AND ACREAGE DEDICATION PLAT**

Form C-102  
Supersedes C-128  
Effective 1-1-65

All distances must be from the outer boundaries of the Section

Operator <b>Mesa Petroleum Company</b>			Lease <b>Hope State Com.</b>		Well No. <b>1</b>
Unit Letter <b>L</b>	Section <b>16</b>	Township <b>19 South</b>	Range <b>23 East</b>	County <b>Eddy</b>	
Actual Footage Location of Well: <b>1980</b> feet from the <b>South</b> line and <b>660</b> feet from the <b>West</b> line					
Ground Level Elev. <b>4015.8</b>	Producing Formation <b>MORROW</b>	Pool <b>WILDCAT</b>		Dedicated Acreage: <b>W/2 320</b> Acres	

1. Outline the acreage dedicated to the subject well by colored pencil or hachure marks on the plat below.
2. If more than one lease is dedicated to the well, outline each and identify the ownership thereof (both as to working interest and royalty).
3. If more than one lease of different ownership is dedicated to the well, have the interests of all owners been consolidated by communitization, unitization, force-pooling, etc?

☐ Yes    ☒ No    If answer is "yes," type of consolidation \_\_\_\_\_

If answer is "no," list the owners and tract descriptions which have actually been consolidated. (Use reverse side of this form if necessary.) COMMUNITIZATION IN PROGRESS

No allowable will be assigned to the well until all interests have been consolidated (by communitization, unitization, forced-pooling, or otherwise) or until a non-standard unit, eliminating such interests, has been approved by the Commission.

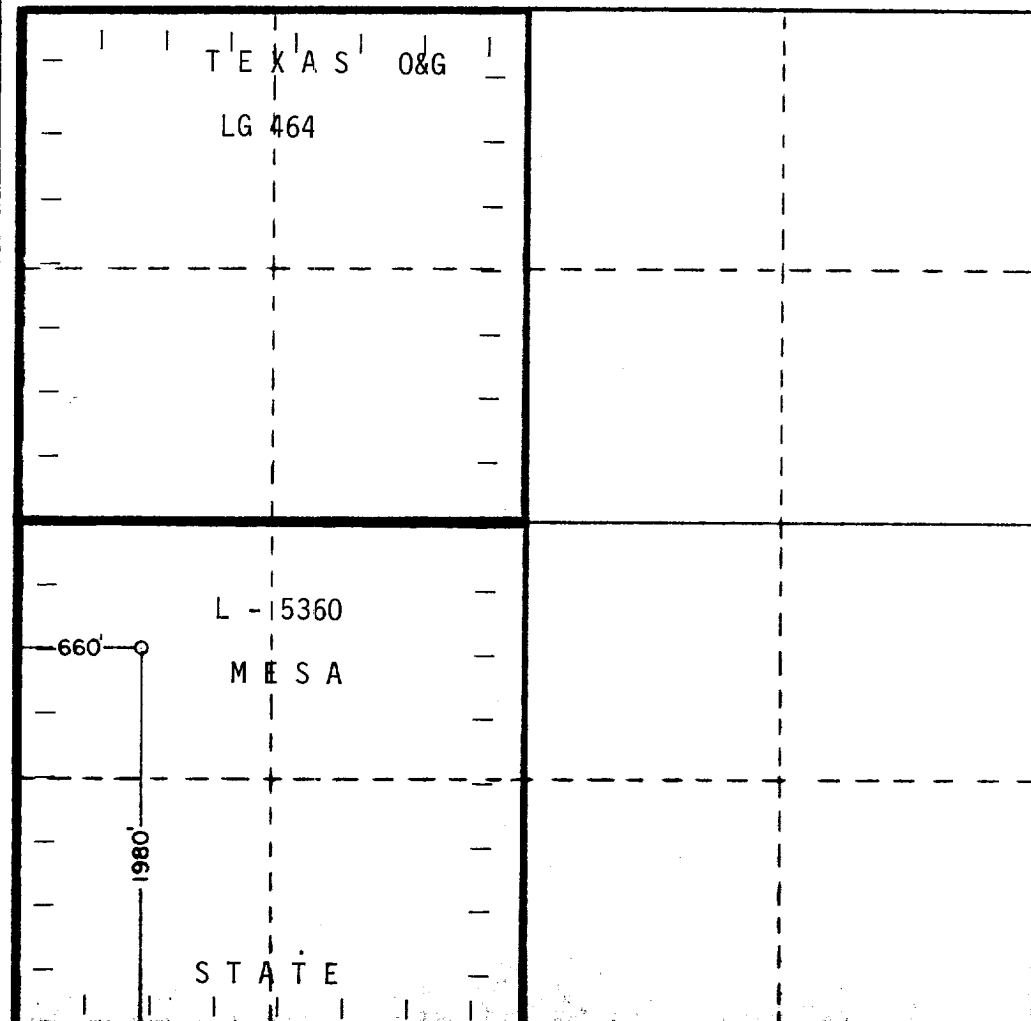

**CERTIFICATION**

I hereby certify that the information contained herein is true and complete to the best of my knowledge and belief.

*R. E. Mathis*

Name

**R. E. MATHIS**

Position

**REGULATORY COORDINATOR**

Company

**MESA PETROLEUM CO.**

Date

**JANUARY 16, 1981**

I hereby certify that the location shown on this plat was plotted from field notes of actual surveys made by me or under my supervision, and that the same is true and correct to the best of my knowledge and belief.

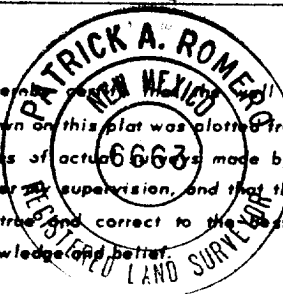

Date Surveyed

**January 9, 1981**

Registered Professional Engineer  
and/or Land Surveyor

*Patrick A. Romero*

Certificate No. **6663**  
 State of New Mexico  
 Patrick A. Romero  
 Registered Professional Engineer and Land Surveyor