

NO. OF COPIES RECEIVED	
DISTRIBUTION	
SANTA FE	1
FILE	1
U.S.G.S.	1
LAND OFFICE	1
OPERATOR	1

NEW MEXICO OIL CONSERVATION COMMISSION

30-015-23712
Form C-101
Revised 1-1-65

MAR 19 1981
O. C. D.
ARTESIA OFFICE

5A. Indicate Type of Lease STATE <input checked="" type="checkbox"/> FEE <input type="checkbox"/>
5. State Oil & Gas Lease No. B-8876
7. Unit Agreement Name
8. Farm or Lease Name Aurora
9. Well No. 1
10. Field and Pool, or Wildcat Turkey Track SR On Gr.
12. County Eddy
19. Proposed Depth 3,000'
19A. Formation Grayburg
20. Rotary or C.T. Rotary
21. Elevations (Show whether DF, RT, etc.) 3421' Gr
21A. Kind & Status Plug. Bond Statewide active
21B. Drilling Contractor WEK Drilling Co.
22. Approx. Date Work will start 3/28/81

APPLICATION FOR PERMIT TO DRILL, DEEPEN, OR PLUG BACK	
1a. Type of Work DRILL <input checked="" type="checkbox"/> DEEPEN <input type="checkbox"/> PLUG BACK <input type="checkbox"/>	
b. Type of Well OIL WELL <input checked="" type="checkbox"/> GAS WELL <input type="checkbox"/> OTHER <input type="checkbox"/> SINGLE ZONE <input checked="" type="checkbox"/> MULTIPLE ZONE <input type="checkbox"/>	
2. Name of Operator Marbob Energy Corporation	
3. Address of Operator P.O. Box 304, Artesia, N.M. 88210	
4. Location of Well UNIT LETTER A LOCATED 990 FEET FROM THE North LINE AND 330 FEET FROM THE East LINE OF SEC. 3 TWP. 19S RGE. 29E NMPM	
23.	

PROPOSED CASING AND CEMENT PROGRAM					
SIZE OF HOLE	SIZE OF CASING	WEIGHT PER FOOT	SETTING DEPTH	SACKS OF CEMENT	EST. TOP
11"	8 5/8"	24#	300'	Circulate	
7 7/8"	4 1/2"	10.50#	3000'	400 sax	

We propose to drill to approximately 300', set 8 5/8", circulate cement, drill on to test the Grayburg formation at approximately 3,000' and set 4 1/2" production string w/400 sax cement. We do not anticipate gas at this depth and will not set up a blowout preventer program at this time.

APPROVAL VALID FOR 180 DAYS
PERMIT EXPIRES 9-20-81
UNLESS DRILLING UNDERWAY

IN ABOVE SPACE DESCRIBE PROPOSED PROGRAM: IF PROPOSAL IS TO DEEPEN OR PLUG BACK, GIVE DATA ON PRESENT PRODUCTIVE ZONE AND PROPOSED NEW PRODUCTIVE ZONE. GIVE BLOWOUT PREVENTER PROGRAM, IF ANY.

I hereby certify that the information above is true and complete to the best of my knowledge and belief.
Signed Charles J. Davis Title Production Clerk Date 3/18/81

(This space for State Use)
APPROVED BY Mr. Williams TITLE OIL AND GAS INSPECTOR DATE MAR 20 1981
CONDITIONS OF APPROVAL, IF ANY:

N MEXICO OIL CONSERVATION COMMISS
WELL LOCATION AND ACREAGE DEDICATION PLAT

Form C-102
 Supersedes C-128
 Effective 1-1-65

All distances must be from the outer boundaries of the Section.

Operator MARBOB ENERGY CORPORATION			Lease 1		Well No. 1
Unit Letter A	Section 3	Township 19 South	Range 29 East	County EDDY	
Actual Footage Location of Well: 990 feet from the North line and 330 feet from the East line					
Ground Level Elev. 3421	Producing Formation Grayburg		Pool Turkey Track SR On. Grbg		Dedicated Acreage: 40 Acres

1. Outline the acreage dedicated to the subject well by colored pencil or hachure marks on the plat below.
2. If more than one lease is dedicated to the well, outline each and identify the ownership thereof (both as to working interest and royalty).
3. If more than one lease of different ownership is dedicated to the well, have the interests of all owners been consolidated by communitization, unitization, force-pooling, etc?

☐ Yes ☐ No If answer is "yes," type of consolidation _____

If answer is "no," list the owners and tract descriptions which have actually been consolidated. (Use reverse side of this form if necessary.) _____

No allowable will be assigned to the well until all interests have been consolidated (by communitization, unitization, forced-pooling, or otherwise) or until a non-standard unit, eliminating such interests, has been approved by the Commission.

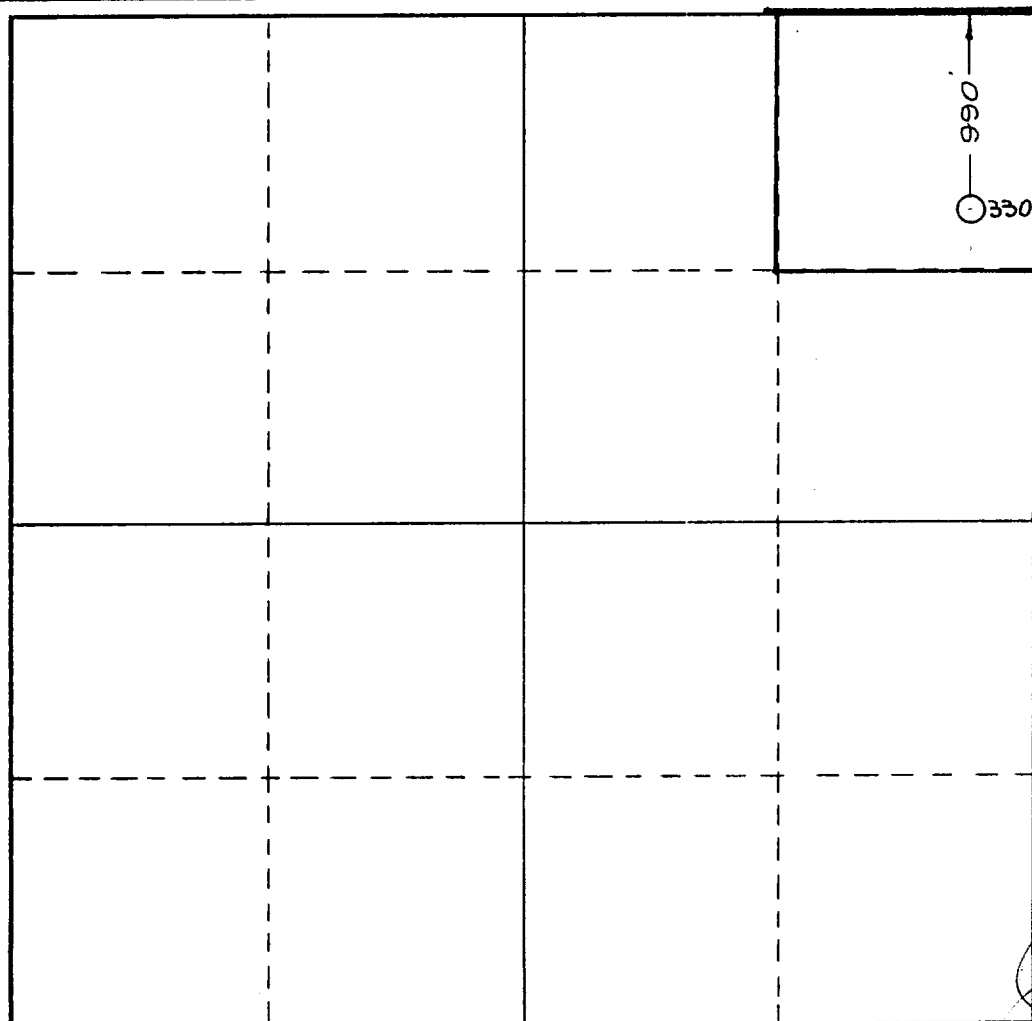

CERTIFICATION

I hereby certify that the information contained herein is true and complete to the best of my knowledge and belief.

Name Carolyn Orris
 Position Production Clerk
 Company Marbob Energy Corp.

Date 3/18/81

I hereby certify that the well location shown on this plat was plotted from field notes of actual surveys made by me or under my supervision, and that the same is true and correct to the best of my knowledge and belief.

Date Surveyed October 27, 1980
 Registered Professional Engineer and/or Land Surveyor

Certificate No.

1559