

MEXICO OIL CONSERVATION COMMISSION
WELL LOCATION AND ACREAGE DEDICATION PLAT

Form C-124
Supersedes C-124
Effective 1-1-81

All distances must be from the outer boundaries of the Section.

Field Keith Collins Pet. Corp.		Lease Copelan Fed.		Well 1
Section N	Range 5	Township 19 South	Range 25 East	County Eddy
Distance from the Section Corner to the Location of Well: 600 feet from the South line and 1980 feet from the West line.				
Area of Well Tract 3575.0	Producing Formation YESO	Pool X-PENASCO DRAW SAN ANDRES-YESO (ASSOC.)		Dedicated Acreage 40

- Outline the acreage dedicated to the subject well by colored pencil or hatchure marks on the plat below.
- If more than one lease is dedicated to the well, outline each and identify the ownership thereof (both as to working interest and royalty).
- If more than one lease of different ownership is dedicated to the well, have the interests of all owners been consolidated by communitization, unitization, force-pooling, etc?

☐ Yes ☐ No If answer is "yes," type of consolidation _____

If answer is "no," list the owners and tract descriptions which have actually been consolidated. (Use reverse side of this form if necessary.) _____

No allowable will be assigned to the well until all interests have been consolidated (by communitization, unitization, forced-pooling, or otherwise) or until a non-standard unit, eliminating such interests, has been approved by the Commission.

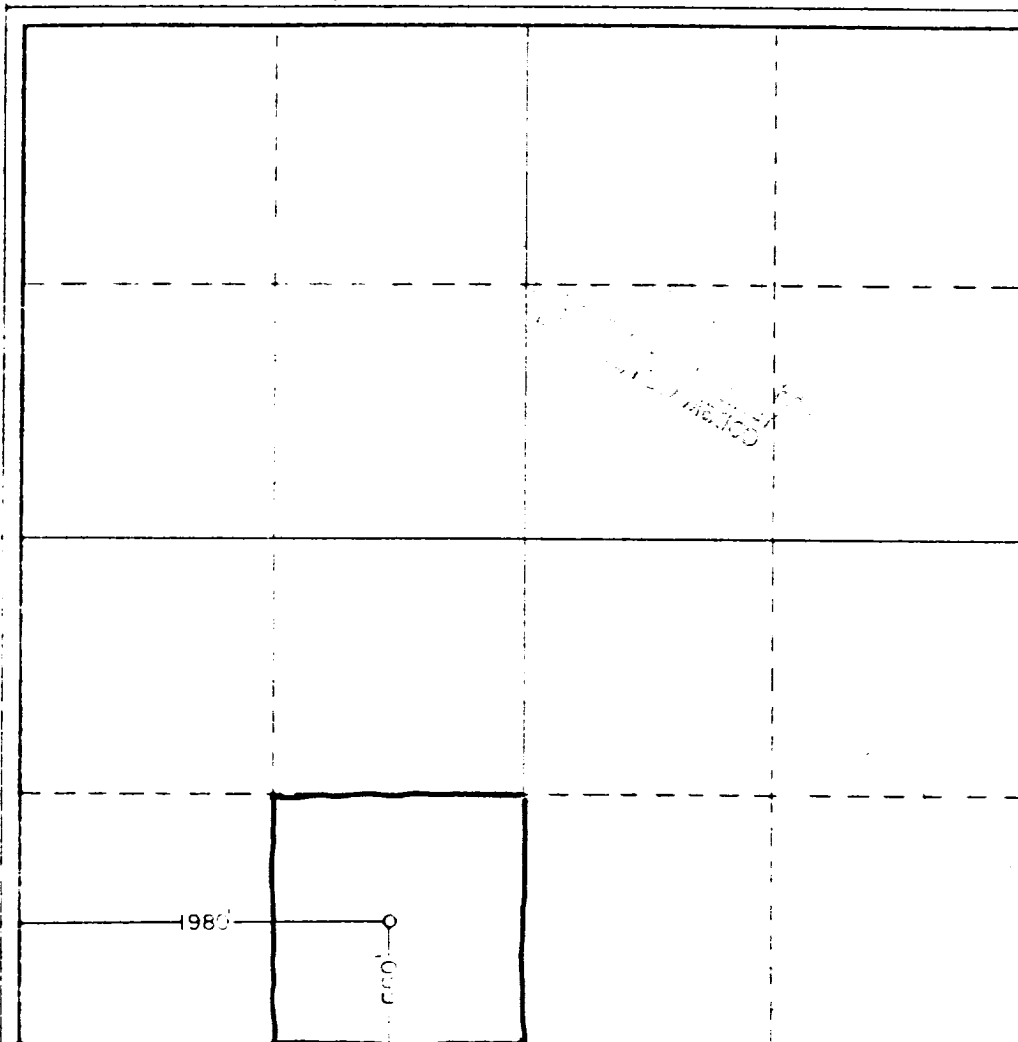

CERTIFICATION

I hereby certify that the information contained herein is true and complete to the best of my knowledge and belief.

Arthur R. Brown
Arthur R. Brown

Position
Agent for
Company
KEITH COLLINS PETROLEUM CORP.

Date
FEBRUARY 16, 1981

I hereby certify that the well location shown on this plat was plotted from field notes of actual surveys made by me or under my supervision, and that the same is true and correct to the best of my knowledge and belief.

Date Surveyed
2-6-81
Registered Professional Engineer
and/or Land Surveyor

John W. West
Certificate No. JOHN W. WEST 67
PATRICK A. ROMERO 6600
Ronald J. Eidson 3230

330 660 990 1320 1650 1980 2310 2640 2970 3300 3630 3960 4290 4620 4950 5280 5610 5940 6270 6600