

NO. OF COPIES RECEIVED	
DISTRIBUTION	
SANITARY	1
FILE	1
U.S.G.S.	2
LAND OFFICE	7
OPERATOR	1

NEW MEXICO OIL CONSERVATION COMMISSION

JUN 4 1981

O. C. D.  
ARTESIA, OFFICE

30-015-23818

Form C-101  
Revised 1-1-65

5A. Indicate Type of Lease	STATE <input checked="" type="checkbox"/>	FEE <input type="checkbox"/>
5. State Oil & Gas Lease No.	L-1493	

## APPLICATION FOR PERMIT TO DRILL, DEEPEN, OR PLUG BACK

1a. Type of Work		7. Unit Agreement Name	
b. Type of Well DRILL <input checked="" type="checkbox"/> DEEPEN <input type="checkbox"/> PLUG BACK <input type="checkbox"/> OIL WELL <input type="checkbox"/> GAS WELL <input checked="" type="checkbox"/> OTHER <input type="checkbox"/> SINGLE ZONE <input checked="" type="checkbox"/> MULTIPLE ZONE <input type="checkbox"/>		8. Farm or Lease Name	
2. Name of Operator Southland Royalty Company		9. Well No. 1	
3. Address of Operator 1100 Wall Towers West, Midland, Texas 79701		10. Field and Pool, or Fieldcat Turkey Track Undesignated (Atoka)	
4. Location of Well UNIT LETTER F LOCATED 1980 FEET FROM THE North LINE AND 1980 FEET FROM THE West LINE OF SEC. 15 TWP. 19-S RGE. 29-E N14PM		12. County Eddy	
11. Elevations (Show whether DI, RI, etc.) 3339.1' GR		13. Proposed Depth 11,000	14. Formation Strawn/Atoka
21A. Kind & Status Plug. Bond Blanket		21B. Drilling Contractor Hondo Rig #1	22. Approx. Date Work will start June 15, 1981

## PROPOSED CASING AND CEMENT PROGRAM

SIZE OF HOLE	SIZE OF CASING	WEIGHT PER FOOT	SETTING DEPTH	SACKS OF CEMENT	EST. TOP
17 1/4"	11 3/4"	42#	225	450	Circ.
11"	8 5/8"	24#	2750	1200	Circ.
7 7/8"	5 1/2"	17#	11000	1100	7000'

Drill 17 1/4" hole to 225' & set 11 3/4" csg. Circ cement. Drill 11" hole to 2750' & set 8 5/8" csg. Circ. cement. Drill 7 7/8" hole to TD to test Atoka and intermediate horizons with shows. If commercial, run 5 1/2" csg to TD. Cement w/sufficient volume to bring cement above prospective zones. Estimated top of cement @ 7000'. Perforate & stimulate. MUD PROGRAM: 0-225', spud mud; 225'-2750', brine water; 2750'-7500', fresh water; 7500'-9500', cut brine water; 9500-10400', starch, gel, flosal; 10,400-11,000', starch, gel, flosal, 3%KCL. Mud wt. 10.0-10.5#, Vis 40, WL 6cc. three Atoka. BHP @ TD anticipated to be 5500psi. Mud up w/10.5# mud prior to drilling thru Atoka. Gas separator to be installed on mud system after setting 8 5/8" csg. BOP PROGRAM: BOP to be installed and tested after setting 11 3/4" & 8 5/8" csg. BOP to be tested by Yellow Jacket Inc. after setting 8 5/8" csg.

Gas is not dedicated.

APPROVAL VALID FOR 180 DAYS  
PERMIT EXPIRES 12-10-81  
UNLESS DRILLING UNDERWAY

IN ABOVE SPACE DESCRIBE PROPOSED PROGRAM: IF PROPOSAL IS TO DEEPEN OR PLUG BACK, GIVE DATA ON PRESENT PRODUCTIVE ZONE AND PROPOSED NEW PRODUCTIVE ZONE. GIVE BLOWOUT PREVENTER PROGRAM, IF ANY.

I hereby certify that the information above is true and complete to the best of my knowledge and belief.

Signed CC Parsons Title District Operation Engineer Date June 2, 1981

(This space for State Use)

APPROVED BY W.A. Gressett TITLE SUPERVISOR, DISTRICT II DATE JUN 10 1981

CONDITIONS OF APPROVAL, IF ANY:

Set surface casing @ Top of Salt

NEW MEXICO OIL CONSERVATION COMMISSION  
WELL LOCATION AND ACREAGE DEDICATION PLAT

Form C-102  
Supersedes C-128  
Effective 1-1-65

All distances must be from the outer boundaries of the Section.

Operator <b>Southland Royalty Co.</b>			Lease <b>Parkway C State Comm</b>		Well No. <b>1</b>
Unit Letter <b>F</b>	Section <b>15</b>	Township <b>19 S</b>	Range <b>29 E</b>	County <b>Eddy</b>	
Actual Footage Location of Well: <b>1980</b> feet from the <b>NORTH</b> line and <b>1980</b> feet from the <b>WEST</b> line					
Ground Level Elev. <b>3339.10</b>	Producing Formation <b>ATOKA</b>		Pool <b>Turkey Track Atoka</b> <b>UNDESIGNATED</b>	Dedicated Acreage: <b>320</b> Acres	

1. Outline the acreage dedicated to the subject well by colored pencil or hatchure marks on the plat below.
2. If more than one lease is dedicated to the well, outline each and identify the ownership thereof (both as to working interest and royalty).
3. If more than one lease of different ownership is dedicated to the well, have the interests of all owners been consolidated by communitization, unitization, force-pooling, etc?

☒ Yes    ☐ No    If answer is "yes," type of consolidation COMMUNITIZATION

If answer is "no," list the owners and tract descriptions which have actually been consolidated. (Use reverse side of this form if necessary.) \_\_\_\_\_

No allowable will be assigned to the well until all interests have been consolidated (by communitization, unitization, forced-pooling, or otherwise) or until a non-standard unit, eliminating such interests, has been approved by the Commission.

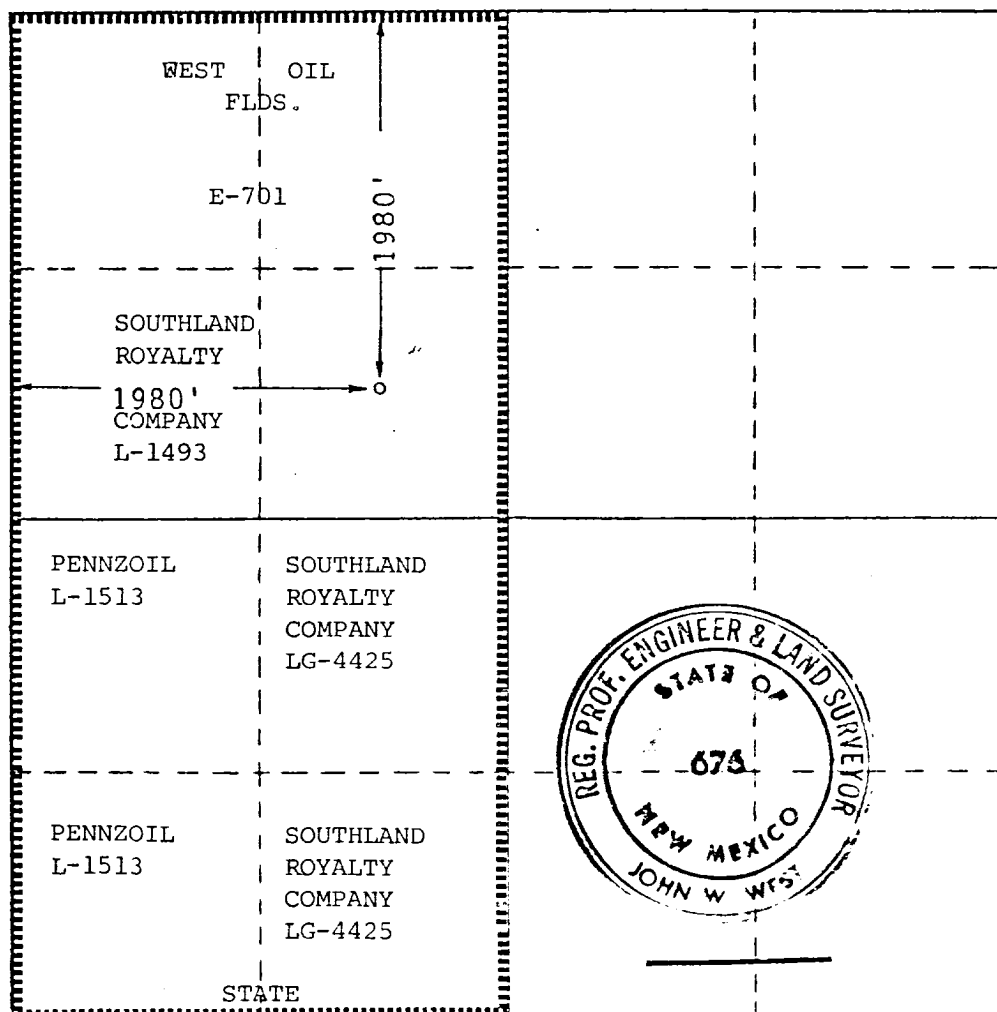

CERTIFICATION

I hereby certify that the information contained herein is true and complete to the best of my knowledge and belief.

Name CC Parsons  
Position  
District Operations Engineer  
Company  
Southland Royalty Company  
Date  
June 2, 1981

I hereby certify that the well location shown on this plat was plotted from field notes of actual surveys made by me or under my supervision, and that the same is true and correct to the best of my knowledge and belief.

Date Surveyed  
May 6, 1981

Registered Professional Engineer and/or Land Surveyor

Ronald J. Eiden

Certificate No. JOHN W. WEST 675  
PATRICK A. ROMERO 6853  
Ronald J. Eiden 3239