

NO. OF COPIES RECEIVED	
DISTRIBUTION	
SANTA FE	
FILE	
U.S.G.S.	
LAND OFFICE	
OPERATOR	

NEW MEXICO OIL CONSERVATION COMMISSION

JUN 09 1981

O. C. O.
ARTESIA OFFICE

Form C-101
Revised 1-1-65

30-015-23820

5A. Indicate Type of Lease
STATE ☒ FEE ☐

5. State Oil & Gas Lease No.
B-8096

7. Unit Agreement Name
NA

8. Farm or Lease Name
Conoco 9 "A" State

9. Well No.
1

10. Field and Pool, or Wildcat
Turkey Track Morrow

12. County
Eddy

APPLICATION FOR PERMIT TO DRILL, DEEPEN, OR PLUG BACK

1a. Type of Work
b. Type of Well
DRILL ☒ DEEPEN ☐ PLUG BACK ☐
OIL WELL ☐ GAS WELL ☒ OTHER ☐ SINGLE ZONE ☒ MULTIPLE ZONE ☐

2. Name of Operator
Threshold Development Company

3. Address of Operator
1400 Gihls Tower West, Midland, Texas 79701

4. Location of Well
UNIT LETTER G LOCATED 1980 FEET FROM THE north LINE
AND 1980 FEET FROM THE east LINE OF SEC. 9 TWP. 19S RGE. 29E NMPM

19. Proposed Depth 11,750'
19A. Formation Morrow
20. Rotary or C.T. Rotary
21. Elevations (Show whether DE, RT, etc.) 3396.1 GL
21A. Kind & Status Plug. Bond Active Blanket
21B. Drilling Contractor Landis Drlg Co. Rig 3
22. Approx. Date Work will start June 20, 1981

PROPOSED CASING AND CEMENT PROGRAM

SIZE OF HOLE	SIZE OF CASING	WEIGHT PER FOOT	SETTING DEPTH	SACKS OF CEMENT	EST. TOP
17-1/2"	13-3/8"	48#	350'	525	Surface
11"	8-5/8"	24# & 32#	3050'	1700	Surface
7-7/8"	5-1/2"	17#	11750'	600	8800'

This well will be spudded with a 17-1/2" hole and drilled to 350'±. Surface casing will be run and cement circulated to surface. Casing will be tested to 1000 psi before drilling out of surface. BOP's will be installed and pressure tested to 3000 psi. (BOP's will be pressure tested a minimum of once every 10 days). A 11" hole will be drilled to 3050' and 8-5/8" OD casing set and cemented to the surface. Casing will be tested to 1000 psi before drilling out. A 7-7/8" hole will be drilled to a total depth of 11,750'±. If the well is deemed productive, 5-1/2" OD casing will be run and cemented with 600± sacks cement.

Note: BOP that meets NMOCC requirements will be used. (See attached diagram).
Gas is dedicated.

APPROVAL VALID FOR 180 DAYS
PERMIT EXPIRES 12-12-81
UNLESS DRILLING UNDERWAY

IN ABOVE SPACE DESCRIBE PROPOSED PROGRAM: IF PROPOSAL IS TO DEEPEN OR PLUG BACK, GIVE DATA ON PRESENT PRODUCTIVE ZONE AND PROPOSED NEW PRODUCTIVE ZONE. GIVE BLOWOUT PREVENTER PROGRAM, IF ANY.

I hereby certify that the information above is true and complete to the best of my knowledge and belief.

Signed Peggy A. Redman Title Engineer Assistant Date June 8, 1981

(This space for State Use)

APPROVED BY W. A. Gressett TITLE SUPERVISOR, DISTRICT II DATE JUN 12 1981

CONDITIONS OF APPROVAL, IF ANY:

N MEXICO OIL CONSERVATION COMMISSION
WELL LOCATION AND ACREAGE DEDICATION PLAT

RECEIVED

Form C-102
Supersedes C-128
Effective 4-65

JUN 09 1981

All distances must be from the outer boundaries of the Section

Operator Threshold Development Co.			Lease Conoco 9A State			O. C. D. Well No. ARTESIA OFFICE 1	
Tract Letter G	Section 9	Township 19 south	Range 29 east	County Eddy			
Annual Production 1980		Direction of Well: north		Date 1980		Direction east	
Ground Level Elev. 3396.1	Producing Formation Morrow	Pool Turkey Track Morrow			Dedicated Acreage: 320 Acres		

1. Outline the acreage dedicated to the subject well by colored pencil or hachure marks on the plat below.
2. If more than one lease is dedicated to the well, outline each and identify the ownership thereof (both as to working interest and royalty).
3. If more than one lease of different ownership is dedicated to the well, have the interests of all owners been consolidated by communitization, unitization, force-pooling, etc?

☒ Yes ☐ No If answer is "yes," type of consolidation By Operating Agreement will be communitized upon establishment of production.

If answer is "no," list the owners and tract descriptions which have actually been consolidated. (Use reverse side of this form if necessary.) _____

No allowable will be assigned to the well until all interests have been consolidated (by communitization, unitization, forced-pooling, or otherwise) or until a non-standard unit, eliminating such interests, has been approved by the Commission.

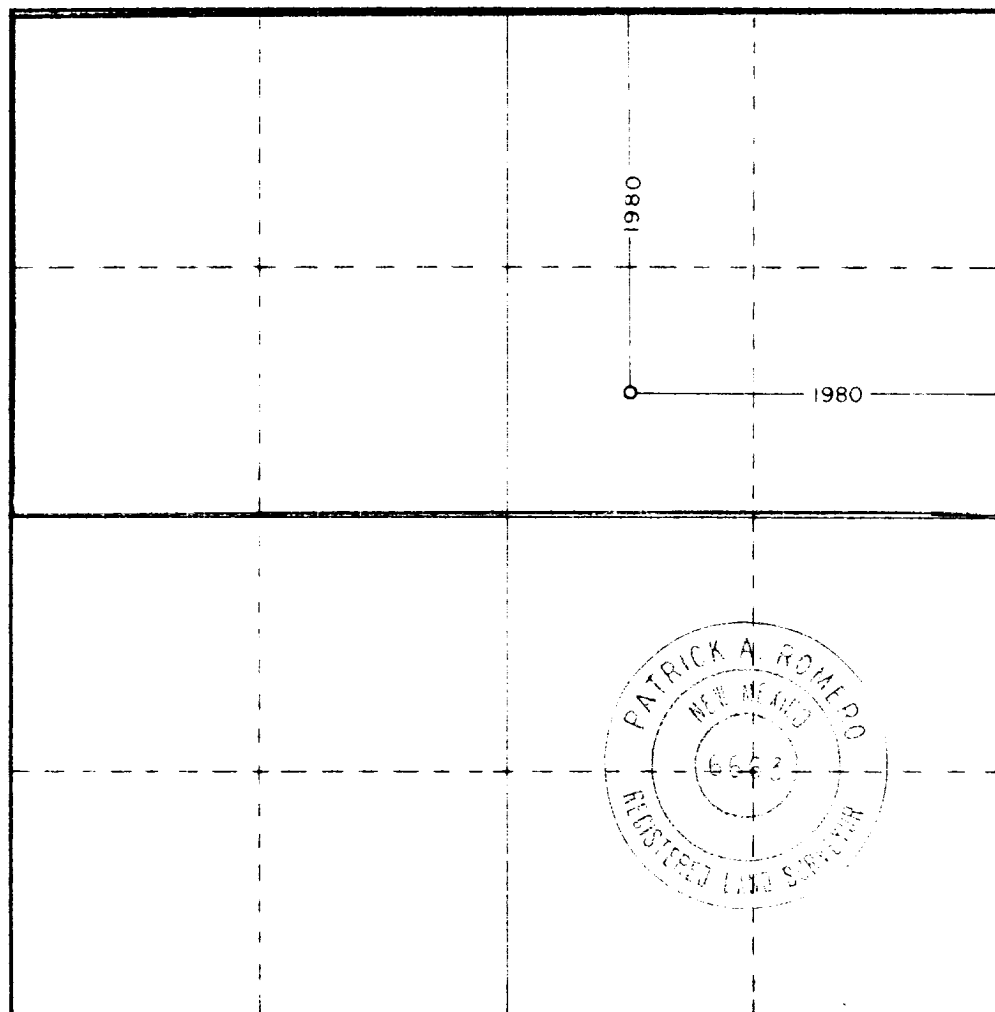

CERTIFICATION

I hereby certify that the information contained herein is true and complete to the best of my knowledge and belief.

Name
Peggy A. Redman

Position
Engineer Assistant

Company
Threshold Development Co.

Date
June 8, 1981

I hereby certify that the well location shown on this plat was plotted from field notes of actual surveys made by me or under my supervision, and that the same is true and correct to the best of my knowledge and belief.

Date Surveyed
9-12-80

Registered Professional Engineer and Land Surveyor

Patrick A. Romero

Certificate No. JOHN W. WEST 878
PATRICK A. ROMERO 8883
Ronald J. Eidson 3239

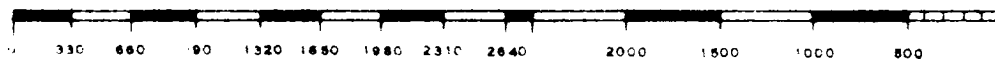

3000 LB. W.P. B.O.P.
 10" CAMERON TYPE-SS HYDRAULIC B.O.P. 3000 P.S.I.
 12" G.K. HYDRILL 3000 W.P.
 80 GALLON- STATION KOOMEY ACCUMULATOR
 3000 LB. W.P. CHOKE MANIFOLD

Lundis Drilling Company

