

N MEXICO OIL CONSERVATION COMMISSION
WELL LOCATION AND ACREAGE DEDICATION PLAT

Form C-102
 Supersedes C-128
 Effective 1-1-65

All distances must be from the outer boundaries of the Section.

Operator <u>JACK BLONSON</u>			Lease <u>NE 1/4 Sec 3 T2N R3E</u>		Well No. <u>4</u>
Unit Letter	Section <u>3</u>	Township <u>South</u>	Range <u>3 East</u>	County <u>A</u>	
Actual Footage Location of Well: <u>590</u> feet from the <u>North</u> line and <u>990</u> feet from the <u>East</u> line					
Ground Level Elev. <u>5015</u>	Producing Formation <u>yates sand</u>		Pool <u>shugart</u>	Dedicated Acreage: <u>10</u> Acres	

1. Outline the acreage dedicated to the subject well by colored pencil or hatchure marks on the plat below.
2. If more than one lease is dedicated to the well, outline each and identify the ownership thereof (both as to working interest and royalty).
3. If more than one lease of different ownership is dedicated to the well, have the interests of all owners been consolidated by communitization, unitization, force-pooling, etc?

☐ Yes ☒ No If answer is "yes," type of consolidation _____

If answer is "no," list the owners and tract descriptions which have actually been consolidated. (Use reverse side of this form if necessary.) Per American and Butte oil companies own the right below a depth of 4500 feet
 No allowable will be assigned to the well until all interests have been consolidated (by communitization, unitization, forced-pooling, or otherwise) or until a non-standard unit, eliminating such interests, has been approved by the Commission.

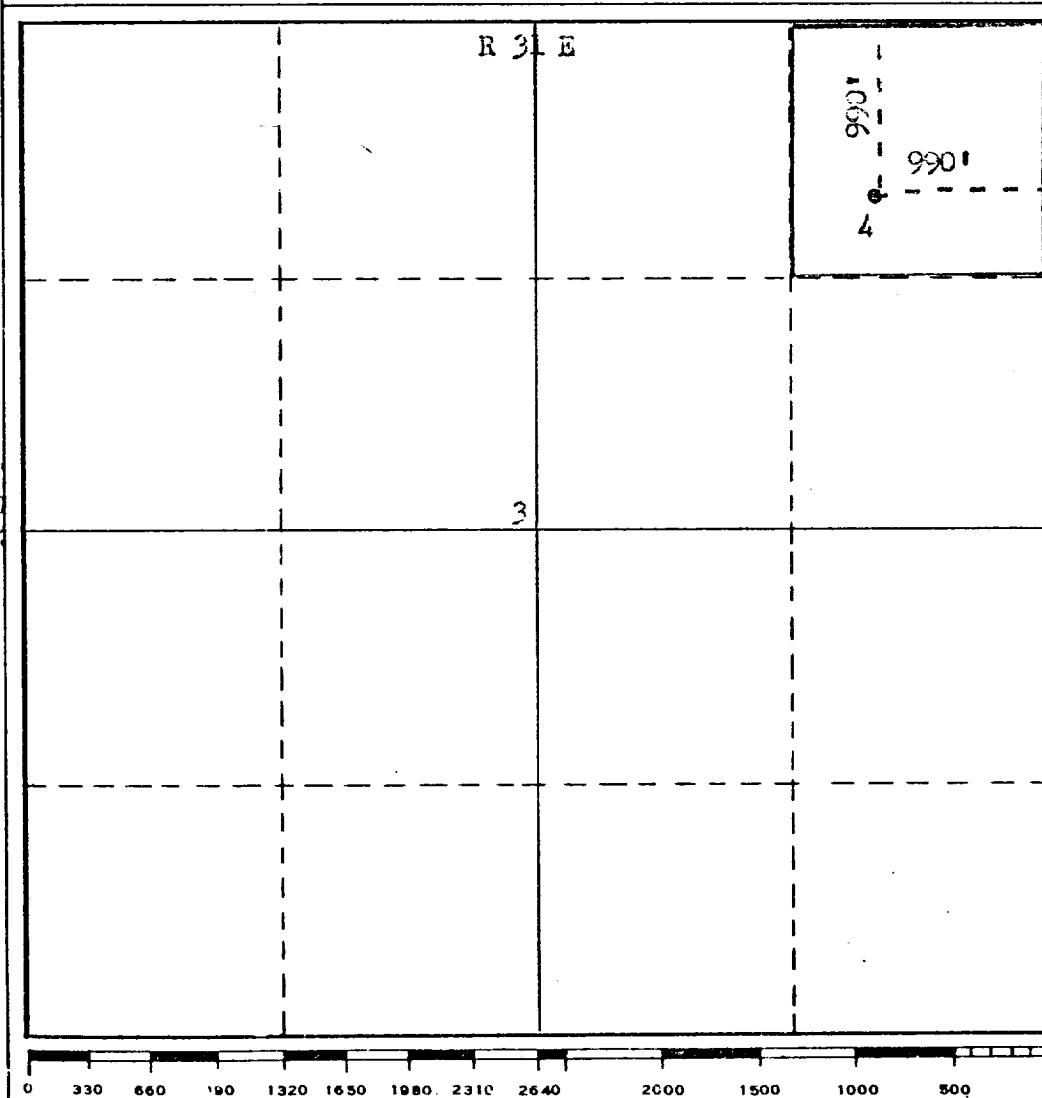

CERTIFICATION RECEIVED SET 11-15 DIVISION OF OIL & GAS ALABAMA, NEW MEXICO	
I hereby certify that the information contained herein is true and complete to the best of my knowledge and belief.	
Name <u>Ben Blonson</u>	
Position <u>Agent</u>	
Company <u>Jack Blonson Drilling Co.</u>	
Date <u>6-13-65</u>	
I hereby certify that the well location shown on this plat was plotted from field notes of actual surveys made by me or under my supervision, and that the same is true and correct to the best of my knowledge and belief.	
Date Surveyed <u>June 13, 1965</u>	
Registered Professional Engineer and/or Land Surveyor <u>James H. Blonson</u> Certificate No. <u>1111</u>	