

NO. OF COPIES RECEIVED	
DISTRIBUTION	
SANTA FE	1
FILE	1
U.S.G.S.	2
LAND OFFICE	1
OPERATOR	1

NEW MEXICO OIL CONSERVATION COMMISSION

SEP 25 1981

O. C. D.
ARTESIAL OFFICE

30-015-23943

Form C-101
Revised 1-1-65

5A. Indicate Type of Lease
STATE ☒ FEE ☐

5. State Oil & Gas Lease No.
K-4169

APPLICATION FOR PERMIT TO DRILL, DEEPEN, OR PLUG BACK

1a. Type of Work DRILL <input checked="" type="checkbox"/> DEEPEN <input type="checkbox"/> PLUG BACK <input type="checkbox"/>		7. Unit Agreement Name N/A
b. Type of Well OIL WELL <input checked="" type="checkbox"/> GAS WELL <input type="checkbox"/> OTHER <input type="checkbox"/>		8. Farm or Lease Name Petco State
2. Name of Operator The Petroleum Corporation		9. Well No. A-1
3. Address of Operator One Marienfeld Place, Suite 555, Midland, Texas 79701		10. Field and Pool, or Wildcat Parkway Strawn
4. Location of Well UNIT LETTER G LOCATED 1980 FEET FROM THE North LINE AND 1980 FEET FROM THE East LINE OF SEC. 26 TWP. 19S RGE. 29E NADPM		12. County Eddy
19. Proposed Depth 10,800		19A. Formation Strawn
20. Rotary or C.T. Rotary		
21. Elevations (Show whether DF, RI, etc.) 3353.3 GR	21A. Kind & Status Plug. Bend Blanket	21B. Drilling Contractor Undetermined at this time
22. Approx. Date Work will start due to rig availability		

PROPOSED CASING AND CEMENT PROGRAM

SIZE OF HOLE	SIZE OF CASING	WEIGHT PER FOOT	SETTING DEPTH	SACKS OF CEMENT	EST. TOP
15"	11- 3/4"	42#	350'	600	Circ.
11"	8- 5/8"	24# & 32#	3100'	1400	Circ.
7 7/8"	4- 1/2"	11.6# & 13.5#	10,800'	1000	8500'

Set surface casing into T/salt estimated to be 350', circ. cement. Drill 11" hole with brine water to prevent washout to 3100', set 8-5/8" casing @ 3100', circ. cement. Drill 7-7/8" hole with fresh water to 9000'. Add brine water @ 9500' to raise mud weight. Drill to TD of 11,800" to test Strawn and intermediate horizons. Perf. and stimulate Strawn for production. MUD PROGRAM: 0-350' spud mud; 350'-3100' 10# brine water; 3100'-9000' fresh water; 9000' to 10,800' cut brine water gel, MW 9.4, vis 35. No abnormal pressure expected. BOP PROGRAM: BOP's to be installed on 11-3/4" and 8-5/8" casing. Bop to be tested daily. Test with yellow jacket prior to drilling Wolfcamp formation.

APPROVAL VALID FOR 180 DAYS
PERMIT EXPIRES 3-29-82
UNLESS DRILLING UNDERWAY

IN ABOVE SPACE DESCRIBE PROPOSED PROGRAM: IF PROPOSAL IS TO DEEPEN OR PLUG BACK, GIVE DATA ON PRESENT PRODUCTIVE ZONE AND PROPOSED NEW PRODUCTIVE ZONE. GIVE BLOWOUT PREVENTER PROGRAM, IF ANY.

I hereby certify that the information above is true and complete to the best of my knowledge and belief.

Signed W. A. Gressett Title Manager of Operations Date September 23, 1981

(This space for State Use)

APPROVED BY W. A. Gressett TITLE SUPERVISOR, DISTRICT 12 DATE SEP 29 1981

CONDITIONS OF APPROVAL, IF ANY:

Cement must be circulated to surface behind 11 3/4" & 8 5/8" casing

Posted ID-1
API + NL Book
10-2-81

NEW MEXICO OIL CONSERVATION COMMISSION
WELL LOCATION AND ACREAGE DEDICATION PLAT

Form 1-1-72
Superseded 6-1-78
Effective 1-1-85

All distances must be from the outer boundaries of the Section

Owner THE PETROLEUM CORP.		Lease PETCO STATE		Well No. 31
Grid Letter G	Section 26	Township 19 SOUTH	Range 29 EAST	County EDDY
Actual Well Location of Well:				
1980 feet from the NORTH line and		1980 feet from the EAST line		
Initial Level Elev. 3353.3	Producing Formation Strawn	Pool 1/4 Parkway Strawn	Dedicated Acreage NE/4 160	

- Outline the acreage dedicated to the subject well by colored pencil or hatchure marks on the plat below
- If more than one lease is dedicated to the well, outline each and identify the ownership thereof (both as to working interest and royalty). **SEE BACK Royalty - State of New Mexico**
- If more than one lease of different ownership is dedicated to the well, have the interests of all owners been consolidated by communitization, unitization, force-pooling, etc?

☐ Yes ☒ No If answer is "yes," type of consolidation will communitization upon completion

If answer is "no," list the owners and tract descriptions which have actually been consolidated (if so reverse side of this form if necessary.)

No allowable will be assigned to the well until all interests have been consolidated (by communitization, unitization, forced-pooling, or otherwise) or until a non-standard unit, eliminating such interests, has been approved by the Commission.

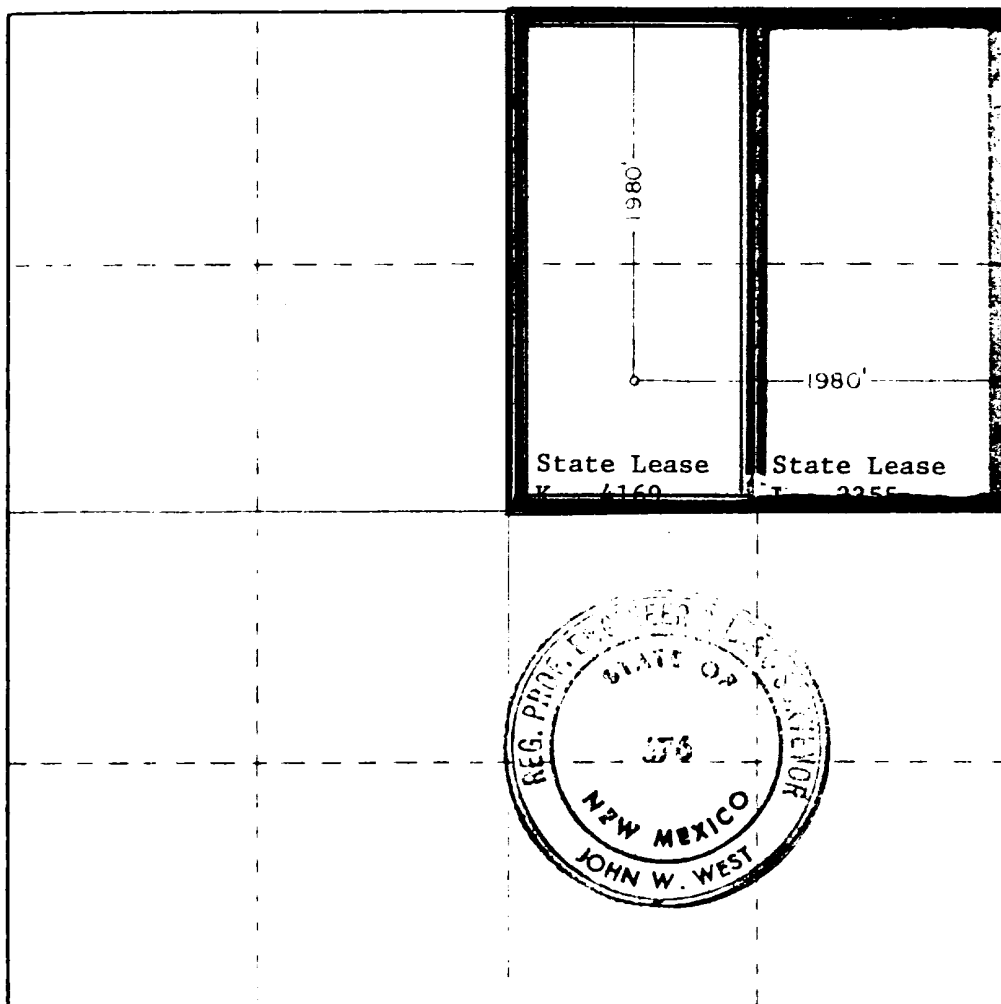

CERTIFICATION

I hereby certify that the information contained herein is true and complete to the best of my knowledge and belief

Claudia Ofield
Claudia Ofield

Position
Engineering Assistant

Company
The Petroleum Corporation

Date
August 14, 1981

I hereby certify that the well location shown on this plat was plotted from field notes of actual surveys made by me or under my supervision and that the same is true and correct to the best of my knowledge and belief

Date Surveyed
8-4-81

Registered Professional Engineer
and State Surveyor

John W. West

Certify to
JOHN W. WEST 874
PATRICK A. ROMERO 6868
RONALD L. EIDSON 1316

Working Interest Owners for both K-4169 and L-3355

Petroleum Corporation of Delaware	75.4628
Allied Chemical Company	18.9816
Sun Oil Company	5.5556

THE PETROLEUM CORPORATION
OF DELAWARE
ONE MARIENFELD PLACE SUITE 555
MIDLAND, TEXAS 79701

September 17, 1981

RECEIVED

New Mexico Oil Conservation Division
P.O. Drawer DD
Artesia, New Mexico 88210
Mr. W. A. Gressett

SEP 18 1981

O. C. D.
ARTESIA OFFICE

Re: Petco State A-1
Eddy County, New Mexico

Dear Mr. Gressett:

Enclosed are six (6) copies of Form C-101 and for (4) copies of Form C-102 for the above caption well.

An application for permit to Drill, Deepen, or plug back had previously been filed with your office September 10, 1981, for Petco State No. 3. This application was in error and we wish to resubmit this application for permit to Drill, Deepen, or plug back for the Petco State No. A-1 instead of the Petco State No. 3.

Thanking you in advance for your consideration and approval.

Yours very truly,



Donald R. Cox
District Manager

DRC:lm
Enclosures

00-00-23443

Ogeid- 21712
Property- 10731
Pool- 60660

2447510
2447530
2447550

2-1-82
DLL/MSFL
3134-10750
CNL/FDC
Surf- 10752

Spread
 No. 2-153C
 HASTINGS, MN
 LOS ANGELES, CHICAGO, LOGAN, OH
 MCGREGOR, TX, LOCUST GROVE, GA
 U.S.A.

12-15-81 L P + A

1170 - 350

887 2100

TD 10750

355X 10400-500

355 9900-10060

35 SX 9420-9520

35 SX 7160-7260

35 SX 57-5800

35 SX 36203720

35 SX 31-3200

355X 12-1300

355 - 2-0-450

15 SX surface

NC Tops Di

Tx

Bx

YATES

SEVEN RIVERS

DELAWARE

BONE SPRING

WOLF CAMP

CANYON

STRAWN

1210

1605

1910

4005

5668

9380

10182

10415

