

NM OIL CONS. COMMISSION

Drawer
Artesia, NM 88210

SUBMIT IN TRI...
(Other instructions on reverse side)

Form approved.
Budget Bureau No. 42-R1425.

Form 3-331 C
(May 1963)

UNITED STATES DEPARTMENT OF THE INTERIOR

C/SF

GEOLOGICAL SURVEY

APPLICATION FOR PERMIT TO DRILL, DEEPEN, OR PLUG BACK

1a. TYPE OF WORK

DRILL ☒

DEEPEN ☐

PLUG BACK ☐

b. TYPE OF WELL

OIL WELL ☒

GAS WELL ☐

OTHER ☐

SINGLE ZONE ☐

MULTIPLE ZONE ☐

2. NAME OF OPERATOR

SUPRON ENERGY CORPORATION

3. ADDRESS OF OPERATOR Building V, Fifth Floor

10300 N. Central Expwy., Dallas, TX 75231

4. LOCATION OF WELL (Report location clearly and in accordance with any State requirements.)

At surface

NW/4 SE/4 2110' FSL & 1650' FEL

At proposed prod. zone

same as above

14. DISTANCE IN MILES AND DIRECTION FROM NEAREST TOWN OR POST OFFICE*

Approximately 26 miles NE of Carlsbad, New Mexico

15. DISTANCE FROM PROPOSED* 1650'

LOCATION TO NEAREST

PROPERTY OR LEASE LINE, FT. 330'

(Also to nearest drlg. unit line, if any)

18. DISTANCE FROM PROPOSED LOCATION*

TO NEAREST WELL, DRILLING, COMPLETED,

OR APPLIED FOR, ON THIS LEASE, FT.

none

16. NO. OF ACRES IN LEASE

635.16

19. PROPOSED DEPTH

2400'

17. NO. OF ACRES ASSIGNED TO THIS WELL

40

20. ROTARY OR CABLE TOOLS

Rotary

21. ELEVATIONS (Show whether DF, RT, GR, etc.)

3441' ungraded ground level

22. APPROX. DATE WORK WILL START*

September 15, 1981

23. PROPOSED CASING AND CEMENTING PROGRAM

SIZE OF HOLE	SIZE OF CASING	WEIGHT PER FOOT	SETTING DEPTH	QUANTITY OF CEMENT
11"	8-5/8"	23#	650'	Cement to surface CIRCULATE
6-3/4"	4 1/2"	10.50#	2400'	Est 150 sx. CIRCULATE

1. Spud 11" surface hole. Drill to \pm 650'. Run 8-5/8" surface casing and cement to surface.
2. Nipple up Blow Out Preventor and test B.O.P and surface casing to 1000 psi.
3. Drill out from under surface casing with 6-3/4" hole to Total Depth of \pm 2400'. Take 60' core @ top of Yates Sandstone.
4. Run logs.
5. If warrented, run 4 1/2" production casing and cement as necessary to bring cement above potential zones.
6. Perforate and stimulate potential zones as necessary to establish production.
7. Install necessary production facilities.
8. Initiate rehabilitation procedures. All such operations to be conducted in accordance with B.L.M. and U.S.G.S. standards and requirements.

SEE NTL-6 COMPLIANCE FOR DETAILS OF OPERATIONS.

IN ABOVE SPACE DESCRIBE PROPOSED PROGRAM: If proposal is to deepen or plug back, give data on present productive zone and proposed new productive zone. If proposal is to drill or deepen directionally, give pertinent data on subsurface locations and measured and true vertical depths. Give blowout preventer program, if any.

24.

SIGNED

Dan R. Collier
Dan R. Collier

TITLE Operations Assistant

DATE August 11, 1981

(This space for Federal or State office use)

PERMIT NO.

APPROVED
AS AMENDED

APPROVAL DATE

APPROVED BY

CONDITIONS OF APPROVAL, IF ANY:

NOV 16 1981

TITLE

DATE

JAMES A. GILLHAM
DISTRICT SUPERVISOR

Posted ID-1
API + NL Book
11-13-81

AUG 21 1981
ROSWELL, NEW MEXICO

NEW MEXICO OIL CONSERVATION COMMISSION
WELL LOCATION AND ACREAGE DEDICATION PLAT

Form 7-1
Supersedes 1-1-78
Effective 1-1-79

All distances must be from the outer boundaries of the Section

Owner SUPRON ENERGY CORPORATION			Lease North Hackberry Federal		Well No. 1
Section J	Range 30	Township 12 South	Range 31 East	County Eddy	
Well Location of Wells					
Well 2119		feet from the South	line and 1650	feet from the East	acre 40
Producing Form Water	Rock Yates			Dedicated Acreage 40	

1. Outline the acreage dedicated to the subject well by colored pencil or hachure marks on the plat below.
2. If more than one lease is dedicated to the well, outline each and identify the ownership thereof (both as to working interest and royalty).
3. If more than one lease of different ownership is dedicated to the well, have the interests of all owners been consolidated by communitization, unitization, force-pooling, etc?

☐ Yes ☐ No If answer is "yes," type of consolidation _____

If answer is "no," list the owners and tract descriptions which have actually been consolidated. (Use reverse side of this form if necessary.) _____

No allowable will be assigned to the well until all interests have been consolidated (by communitization, unitization, forced-pooling, or otherwise) or until a non-standard unit, eliminating such interests, has been approved by the Commission.

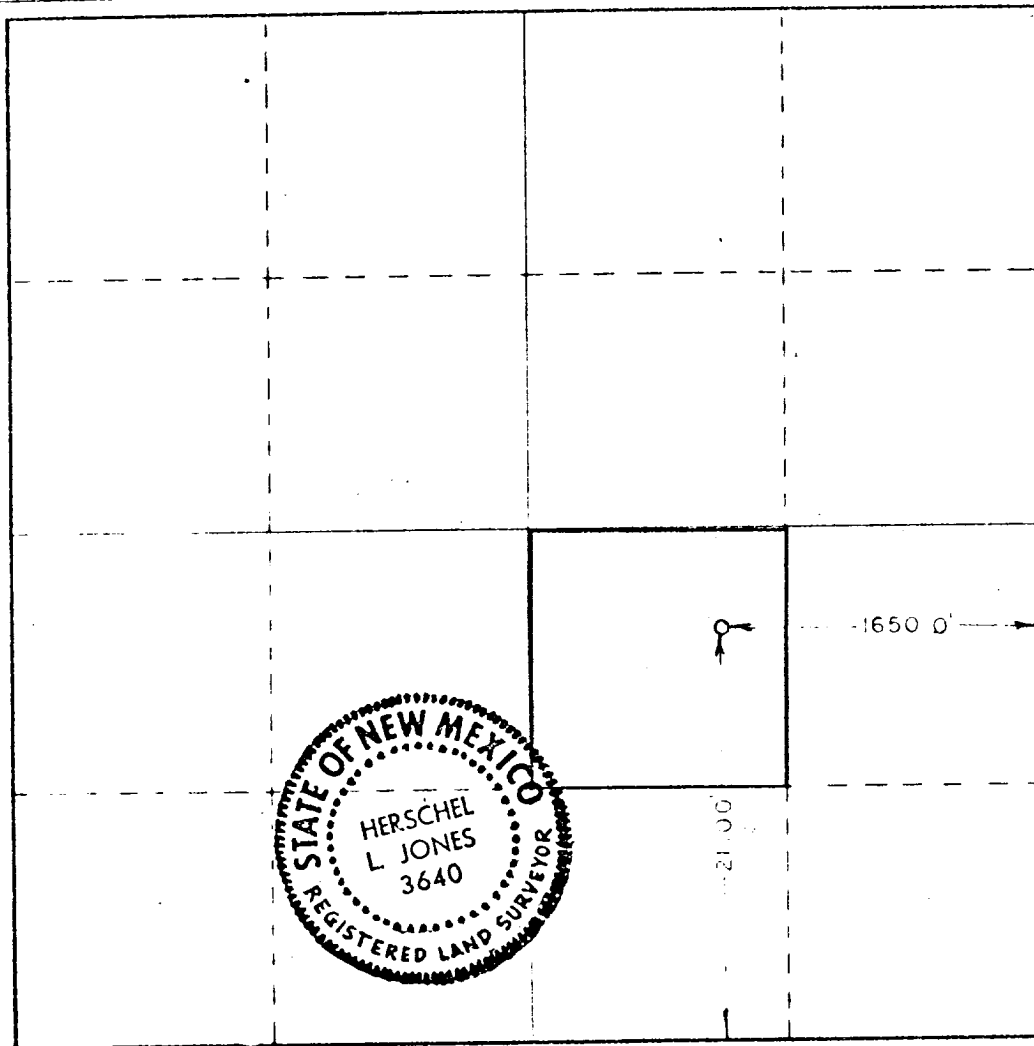

CERTIFICATION

I hereby certify that the information contained herein is true and complete to the best of my knowledge and belief.

Dan R. Collier

Name

Dan R. Collier

Position

Operations Assistant

Company

SUPRON ENERGY CORPORATION

Date

August 11, 1981

I hereby certify that the well location shown on this plat was plotted from field notes of actual surveys made by me or under my supervision, and that the same is true and correct to the best of my knowledge and belief.

Date Surveyed

July 17, 1981

Registered Professional Engineer and Land Surveyor

Certificate No.

15761

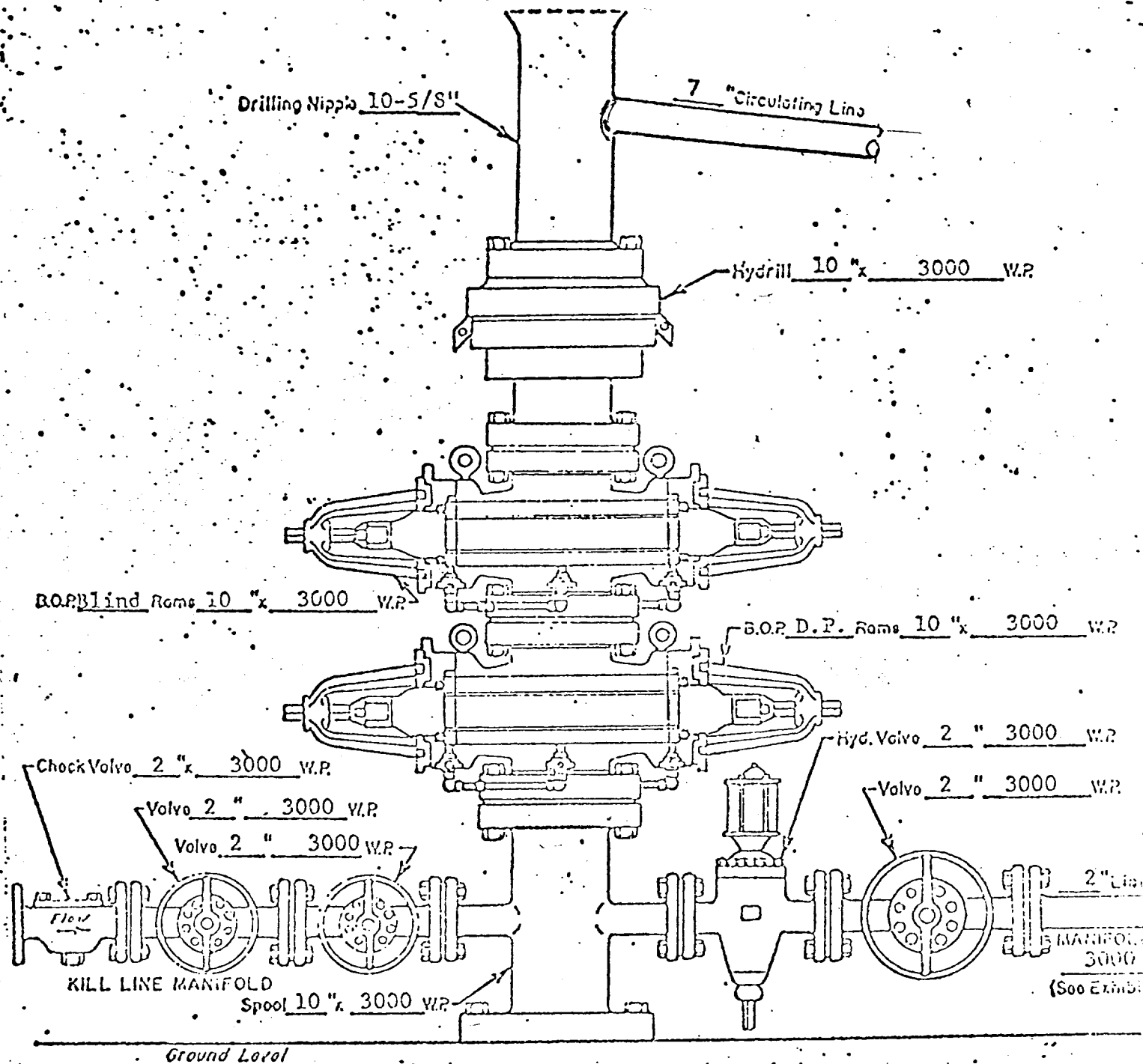

WELL HEAD B.O.P.
3000 W.P.

□ Manual
☒ Hydraulic

SUPRON ENERGY CORPORATION
BLDG. V, FIFTH FLOOR
10300 NORTH CENTRAL EXPRESSWAY
DALLAS, TEXAS 75231

DAN R. COLLIER
OPERATIONS ASSISTANT

TELEPHONE (214) 691-9141
TWX: (910) 861-9117
SUPCO-DAL

August 11, 1981

United States Geological Survey
Oil & Gas Division
Post Office Drawer 1857
Roswell, New Mexico 88201

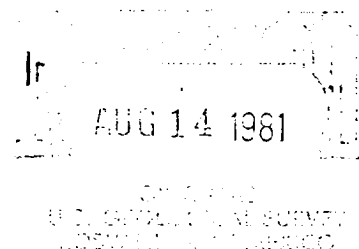

Attention: District Engineer

Dear Sir:

Pursuant to compliance with NTL-6, the following is the geological and well control information for Supron Energy Corporation's proposed F-30-19-31 #1 well to be located in the NW/4, SE/4 of Section 30, Township 19 South, Range 31 East, Eddy County, New Mexico:

1. The geological formation of the surface is Dewey Lake.
2. The estimated tops of the geological markers are as follows:

Rustler	400'
Tansill	1900'
Yates	2070' *

*Objective formation

3. No fresh water zones other than those to be protected by surface casing are expected. The primary objective is the Yates Sandstone with oil expected.
4. Proposed casing program:
 - a.) Surface Casing: 8-5/8", 23#, J-55, New. Set at \pm 650' and cemented to surface.
 - b.) Production Casing: 4 1/2", 10.50#, K-55, New. Set @ 2400' and cemented as necessary.
5. Proposed well control equipment:
 - a.) Casinghead: 10" x 8-5/8", 2000 psi W.P.
 - b.) Blow-out-Preventor: Series 600, Double ram hydraulic - 2000 psi WP. B.O.P. will be tested prior to drilling out and checked daily with results entered in driller's log.

United States Geological Survey
Attn: District Engineer

August 11, 1981
Page two - cont.

6. a.) It is planned to drill the surface hole (0-650') with air. If a mud system is necessary, however, a fresh water gel system will be used.
b.) The interval 650' to 2070' will be drilled with air. If a mud system is necessary, a salt water gel system will be used.
c.) 2070' to Total Depth will be drilled with a salt water gel system.
7. Auxiliary Equipment:
a.) Kelly Cocks: Yes.
b.) Floats on bit: No.
c.) Mud system will be monitored by visual means.
d.) Full open safety valve on floor: Yes.
8. Testing: No Drill Stem Tests are planned.

Coring: A 60' core is planned at the top of the Yates (estimated at 2070').

Logging: Dual Laterolog - Base of Surface casing to Total Depth.
FDC-CNL - Base of Surface Casing to Total Depth.

Stimulation: Breakdown will be with acid/water (est. 1500 gallons).
Stimulation will be a sand/water frac. using gelled water and 20/40 sand. (Est. 20,000 gallons gelled water and 40,000# 20/40 sand.)
9. No abnormal hazards, temperatures, or pressures are anticipated. It is expected to recover hydrocarbons from the Yates formation.
10. The proposed starting date of this project is September 15, 1981, contingent upon "APD" and rig availability.

Yours very truly,

Dan R. Collier
Operations Assistant

DRC:seb

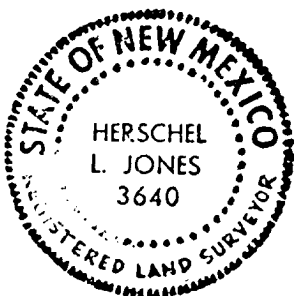
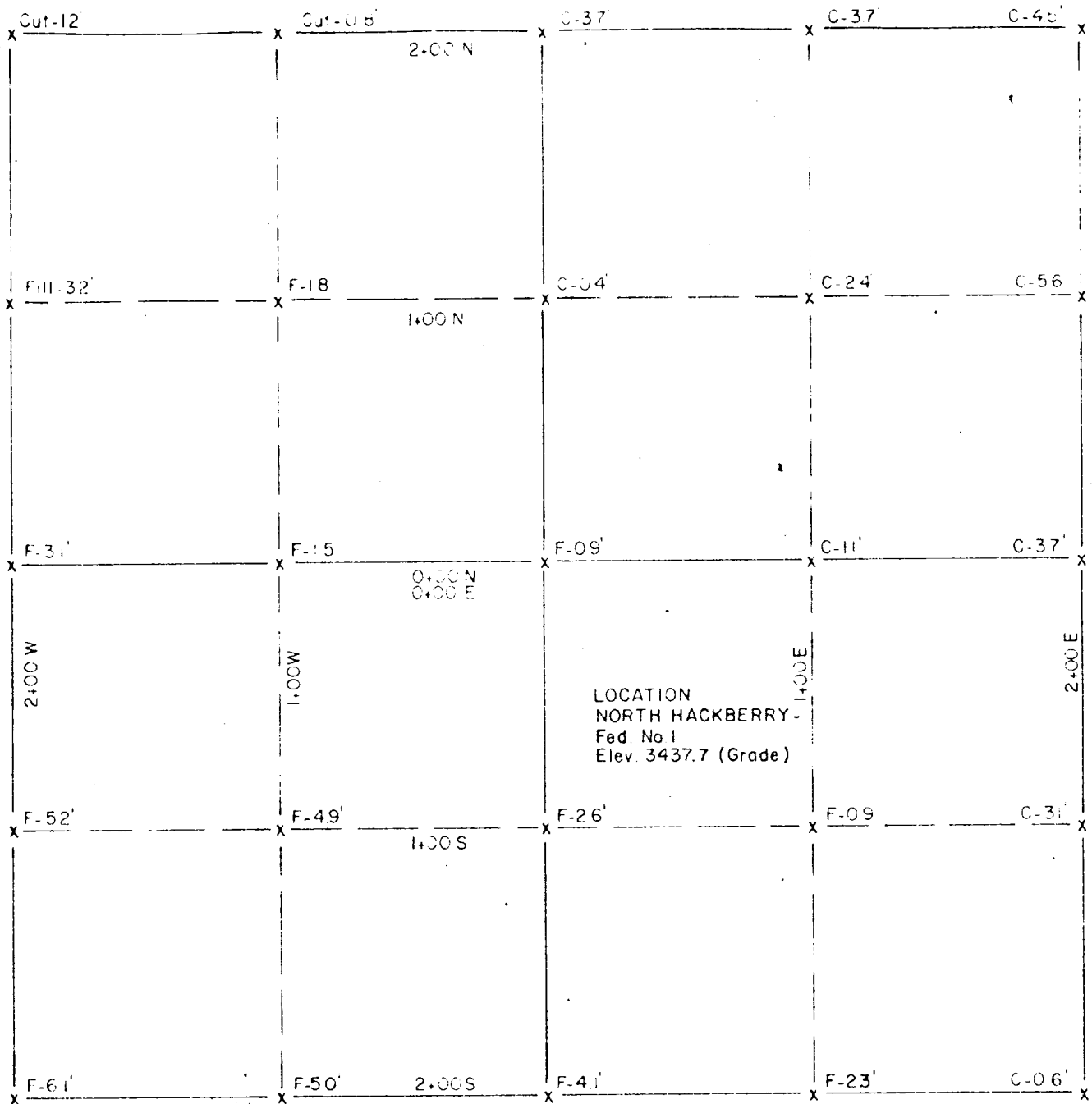

CERTIFICATE OF SURVEY:

I, Herschel L. Jones, hereby certify that I am the Registered Land Surveyor who prepared the above plat from field notes of actual surveys made under my direction and that the same are true and correct to the best of my knowledge and belief.

Herschel L. Jones
R.L.S. No 3640

COMPANY	JOB	DATE	SCALE	FILE NO