

NO. OF COPIES RECEIVED	3
DISTRIBUTION	
SANTA FE	1
FILE	1
U.S.G.S.	
LAND OFFICE	
OPERATOR	1

NEW MEXICO OIL CONSERVATION COMMISSION

RECEIVED

DEC 17 1981

O. C. D.  
ARTESIA, OFFICE

Form C-103  
Supersedes Old  
C-102 and C-103  
Effective 1-1-65

5a. Indicate Type of Lease
State <input checked="" type="checkbox"/> For <input type="checkbox"/>
5. State Oil & Gas Lease No.
B-8949

SUNDRY NOTICES AND REPORTS ON WELLS

(DO NOT USE THIS FORM FOR PROPOSALS TO DRILL OR TO DEEPEN OR PLUG BACK TO A DIFFERENT RESERVOIR.  
USE "APPLICATION FOR PERMIT -" (FORM C-101) FOR SUCH PROPOSALS.)

1. OIL WELL <input type="checkbox"/> GAS WELL <input checked="" type="checkbox"/> OTHER <input type="checkbox"/>	7. Unit Agreement Name
2. Name of Operator Cities Service Company /	8. Farm or Lease Name State DB Com.
3. Address of Operator P. O. Box 1919 Midland, Texas 79702	9. Well No. 1
4. Location of Well UNIT LETTER C 860 FEET FROM THE North LINE AND 2230 FEET FROM THE West LINE, SECTION 3 TOWNSHIP 19S RANGE 29E NMPM.	10. Field and Pool, or Wildcat Und. N. Turkey Trk. North
15. Elevation (Show whether DF, RT, GR, etc.) 3421.5' GR	12. County Eddy

16.

Check Appropriate Box To Indicate Nature of Notice, Report or Other Data

NOTICE OF INTENTION TO:

PERFORM REMEDIAL WORK ☐  
TEMPORARILY ABANDON ☐  
PULL OR ALTER CASING ☐

PLUG AND ABANDON ☐  
CHANGE PLANS ☐

OTHER ☐

SUBSEQUENT REPORT OF:

REMEDIAL WORK ☐  
COMMENCE DRILLING OPNS. ☒  
CASING TEST AND CEMENT JOB ☒

ALTERING CASING ☐  
PLUG AND ABANDONMENT ☐

OTHER ☐

17. Describe Proposed or Completed Operations (Clearly state all pertinent details, and give pertinent dates, including estimated date of starting any proposed work) SEE RULE 1103.

TD 312' Red Beds. Prep to drill ahead. MIRU a rotary and spudded a 17 1/2" hole @ 1230 MST 12-7-81 and drilled to a T.D. of 312' Red Beds. Ran and set 7 jts. (274') 13 3/8" 48# H-40 ST & C casing @ 291' and cemented with 300 sx Surefill + 10% Gypseal, 2% CaCl<sub>2</sub> & 1/4# Celloflake per sk. PD at 0245 MST 12-8-81. Cement did not circulate. RIH w/1" tbg. & tag TOC at 122'. Mix and pump 150 sx Class C w/2% CaCl<sub>2</sub>. Did not circulate. WOC 2 hrs. Mix and pump 150 sx Class C w/2% CaCl<sub>2</sub>. Did not circulate but TOC at 65'. WOC 2 hrs. Mix and pump 100 sx Class C w/2% CaCl<sub>2</sub>. Circ. 30 sx to surface. WOC 18 hrs.

18. I hereby certify that the information above is true and complete to the best of my knowledge and belief.

SIGNED Elmer W. Startz TITLE Reg. Oper. Mgr. - Prod. DATE 12-11-81

APPROVED BY Mike Williams TITLE OIL AND GAS INSPECTOR DATE DEC 18 1981

CONDITIONS OF APPROVAL, IF ANY:

NO. OF COPIES RECEIVED	
DISTRIBUTION	
SANTA FE	1
FILE	1
U.S.G.S.	1
LAND OFFICE	1
OPERATOR	1

NEW MEXICO OIL CONSERVATION COMMISSION  
RECEIVED

NOV 12 1981

O. C. D.

30-015-23993

Form C-101  
Revised 1-1-65

5A. Indicate Type of Lease  
STATE ☒ FEE ☐

5. State Oil & Gas Lease No.

B-8949

APPLICATION FOR PERMIT TO DRILL, DEEPEN, OR PLUG BACK

1a. Type of Work b. Type of Well DRILL <input checked="" type="checkbox"/> DEEPEN <input type="checkbox"/> PLUG BACK <input type="checkbox"/> OIL WELL <input type="checkbox"/> GAS WELL <input checked="" type="checkbox"/> OTHER <input type="checkbox"/> SINGLE ZONE <input checked="" type="checkbox"/> MULTIPLE ZONE <input type="checkbox"/>		7. Unit Agreement Name
2. Name of Operator CITIES SERVICE COMPANY		8. Farm or Lease Name STATE DB Com.
3. Address of Operator P. O. Box 1919 Midland, Texas 79702		9. Well No. 1
4. Location of Well UNIT LETTER C LOCATED 860 FEET FROM THE North LINE AND 2230 FEET FROM THE West LINE OF SEC. 3 TWP. 19S RGE. 29E NMPM		10. Field and Pool, or Wildcat Und. N. Turkey Trk. Mor.
		12. County Eddy
		19. Proposed Depth 11,550'
		19A. Formation Morrow
		20. Rotary or C.T. Rotary
21. Elevations (show whether DF, RI, etc.) 3421.5' GR	21A. Kind & Status Plug. Bond Required/Approved	21B. Drilling Contractor Warton Drlng. Co.
		22. Approx. Date Work will start Dec. 1, 1981

PROPOSED CASING AND CEMENT PROGRAM

SIZE OF HOLE	SIZE OF CASING	WEIGHT PER FOOT	SETTING DEPTH	SACKS OF CEMENT	EST. TOP
17-1/2"	13-3/8"	48#	300'	300	circulated
12-1/4"	8-5/8"	24 & 32#	3000'	1650	circulated
7-7/8"	5-1/2"	17 & 20#	11550'	700	Approx. 8000'

It is proposed to drill this well to a total depth of 11,550' to test the Morrow Formation. The blowout prevention program is as follows:

1. one set of blind rams
2. one set of drill pipe rams
3. one Hydril
4. one rotating head.

Posted ID-1  
API + NL Book  
11-20-81

The acreage assigned to this well is not dedicated to any gas purchaser.

APPROVAL VALID FOR 180 DAYS  
PERMIT EXPIRES 5-19-82  
UNLESS DRILLING UNDERWAY

IN ABOVE SPACE DESCRIBE PROPOSED PROGRAM; IF PROPOSAL IS TO DEEPEN OR PLUG BACK, GIVE DATA ON PRESENT PRODUCTIVE ZONE AND PROPOSED NEW PRODUCTIVE ZONE. GIVE BLOWOUT PREVENTER PROGRAM, IF ANY.

I hereby certify that the information above is true and complete to the best of my knowledge and belief.

Signed Elmer Startz Title Region Oper. Mgr.-Prod. Date 11-10-81  
(This space for State Use)

APPROVED BY M. Williams TITLE OIL AND GAS INSPECTOR DATE NOV 19 1981  
CONDITIONS OF APPROVAL, IF ANY:

NEW MEXICO OIL CONSERVATION COMMISSION  
WELL LOCATION AND ACREAGE DEDICATION PLAT

Form C-102  
Supersedes C-128  
Effective 1-1-65

All distances must be from the outer boundaries of the Section

Operator <b>Cities Service Company</b>			Lease <b>State D B Corn</b>		Well No. <b>1</b>
Unit Letter <b>C</b>	Section <b>3</b>	Township <b>19 South</b>	Range <b>29 East</b>	County <b>Eddy</b>	
Actual Footage Location of Well: <b>860</b> feet from the <b>north</b> line and <b>2230</b> feet from the <b>west</b> line					
Ground Level Elev. <b>3421.5'</b>	Producing Formation <b>Morrow</b>		Pool <b>Und. N. Turkey Track Morrow</b>		Dedicated Acreage: <b>320.8</b> Acres

1. Outline the acreage dedicated to the subject well by colored pencil or hatchure marks on the plat below.
2. If more than one lease is dedicated to the well, outline each and identify the ownership thereof (both as to working interest and royalty).
3. If more than one lease of different ownership is dedicated to the well, have the interests of all owners been consolidated by communitization, unitization, force-pooling, etc?

☒ Yes ☐ No If answer is "yes," type of consolidation Communitization

If answer is "no," list the owners and tract descriptions which have actually been consolidated. (Use reverse side of this form if necessary.) \_\_\_\_\_

No allowable will be assigned to the well until all interests have been consolidated (by communitization, unitization, forced-pooling, or otherwise) or until a non-standard unit, eliminating such interests, has been approved by the Commission.

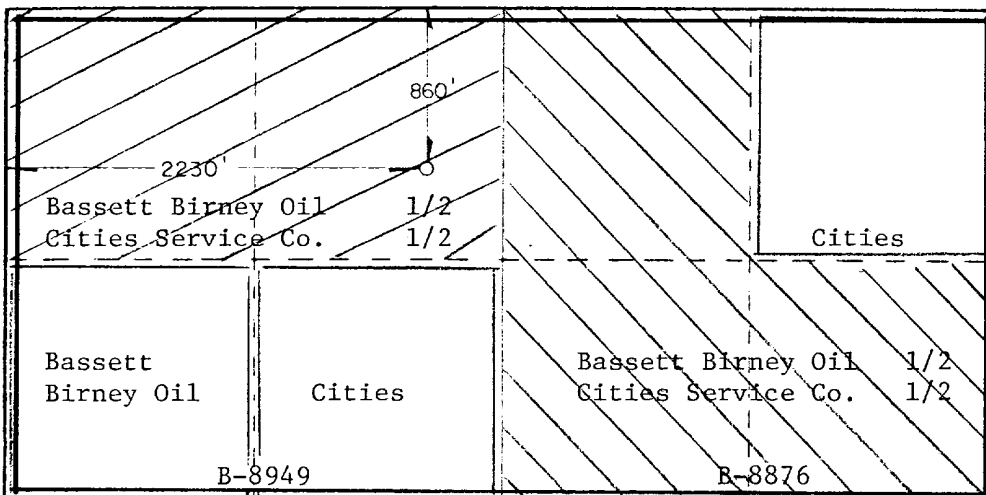

Working Interest of Participating companies in this proposed well are as follows:  
Cities Service Co. .5624201  
Bassett Birney Oil .4375799  
L.0000000

Royalty interest in both leases is the same....

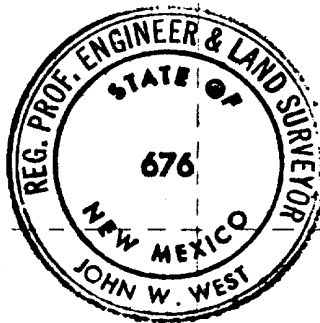

CERTIFICATION

I hereby certify that the information contained herein is true and complete to the best of my knowledge and belief.

Name  
**Elmer Stutz**  
Position  
**Region Opr. Mgr. - Prod**  
Company  
**Cities Service Company**  
Date  
**November 18, 1981**

I hereby certify that the well location shown on this plat was plotted from field notes of actual surveys made by me or under my supervision, and that the same is true and correct to the best of my knowledge and belief.

Date Surveyed  
**11-6-81**  
Registered Professional Engineer and/or Land Surveyor

**John W. West**  
Certificate No. **JOHN W. WEST 676**  
**PATRICK A. ROMERO 6668**  
**Ronald J. Eidson 3239**



OARID 192463  
PROP 27628  
POOI 86480

2035410-0  
2035430-2  
2035450-4

5-3-82  
DLL/MSFL  
Cag-11502  
CNL/FDC  
Surf-11501

Log  
 20.65 sq. ft.  
 8200  
 9810  
 10267  
 10600  
 11052  
 11161