

NO. OF COPIES RECEIVED	
DISTRIBUTION	
SANTA FE	1
FILE	1
U.S.G.S.	2
LAND OFFICE	1
OPERATOR	1

NEW MEXICO OIL CONSERVATION COMMISSION
RECEIVED

MAY 10 1982

O. C. D.

ARTESIA, OFFICE

Form C-101
Revised 1-1-65

5A. Indicate Type of Lease

STATE ☒ FEE ☐

5. State Oil & Gas Lease No.

B-8096

7. Unit Agreement Name

8. Farm or Lease Name

Conoco "7" State

9. Well No.

11

10. Field and Pool, or Wildcat

E. Millman (On-Grybg)

12. County

Eddy

19. Proposed Depth

2500'

19A. Formation

On-Grayburg

20. Rotary or C.T.

Rotary

21. Elevations (Show whether DF, RT, etc.)

3369.8' GL

21A. Kind & Status Plug. Bond

Active Blanket

21B. Drilling Contractor

Vinson Drlg. Co.

22. Approx. Date Work will start

June 1982

23.

PROPOSED CASING AND CEMENT PROGRAM

SIZE OF HOLE	SIZE OF CASING	WEIGHT PER FOOT	SETTING DEPTH	SACKS OF CEMENT	EST. TOP
12-1/4"	8-5/8"	23#	375	300	Surface
7-7/8"	4-1/2"	9.5#	2500	800	Surface

A 12-1/4" hole will be drilled to 375'. 8-5/8" csg will be set to this depth and cemented to surface. Csg will be tested to 1000# before drilling out. A 7-7/8" hole will be drilled to 2500'. If the well is deemed productive, 4-1/2" csg will be set and cemented to surface.

BOP schematic attached

APPROVAL VALID FOR 180 DAYS
PERMIT EXPIRES 11-11-82
UNLESS DRILLING UNDERWAY

IN ABOVE SPACE DESCRIBE PROPOSED PROGRAM: IF PROPOSAL IS TO DEEPEN OR PLUG BACK, GIVE DATA ON PRESENT PRODUCTIVE ZONE AND PROPOSED NEW PRODUCTIVE ZONE. GIVE BLOWOUT PREVENTER PROGRAM, IF ANY.

I hereby certify that the information above is true and complete to the best of my knowledge and belief.

Signed Bucky Burcit Title Area Manager Date May 6, 1982

(This space for State Use)

APPROVED BY Mike Wilho TITLE OH AND GAS INSPECTOR DATE MAY 11 1982

CONDITIONS OF APPROVAL, IF ANY:

**NEW MEXICO OIL CONSERVATION COMMISSION
WELL LOCATION AND ACREAGE DEDICATION PLAT**

Form C-102
Supersedes C-128
Effective 1-1-65

All distances must be from the outer boundaries of the Section.

Operator Threshold Development Co.			Lease Conoco 7 State		Well No. 11
Unit Letter H	Section 7	Township 19 South	Range 29 East	County Eddy	
Actual Footage Location of Well: 1980 feet from the North line and 560 feet from the East line					
Ground Level Elev. 3369.8	Producing Formation Qn-Grybg	Pool <i>Unit</i> E. Millman - Q-G		Dedicated Acreage: 40 Acres	

1. Outline the acreage dedicated to the subject well by colored pencil or hachure marks on the plat below.
2. If more than one lease is dedicated to the well, outline each and identify the ownership thereof (both as to working interest and royalty).
3. If more than one lease of different ownership is dedicated to the well, have the interests of all owners been consolidated by communitization, unitization, force-pooling, etc?

☐ Yes ☐ No If answer is "yes," type of consolidation Not Applicable

If answer is "no," list the owners and tract descriptions which have actually been consolidated. (Use reverse side of this form if necessary.) N/A

No allowable will be assigned to the well until all interests have been consolidated (by communitization, unitization, forced-pooling, or otherwise) or until a non-standard unit, eliminating such interests, has been approved by the Commission.

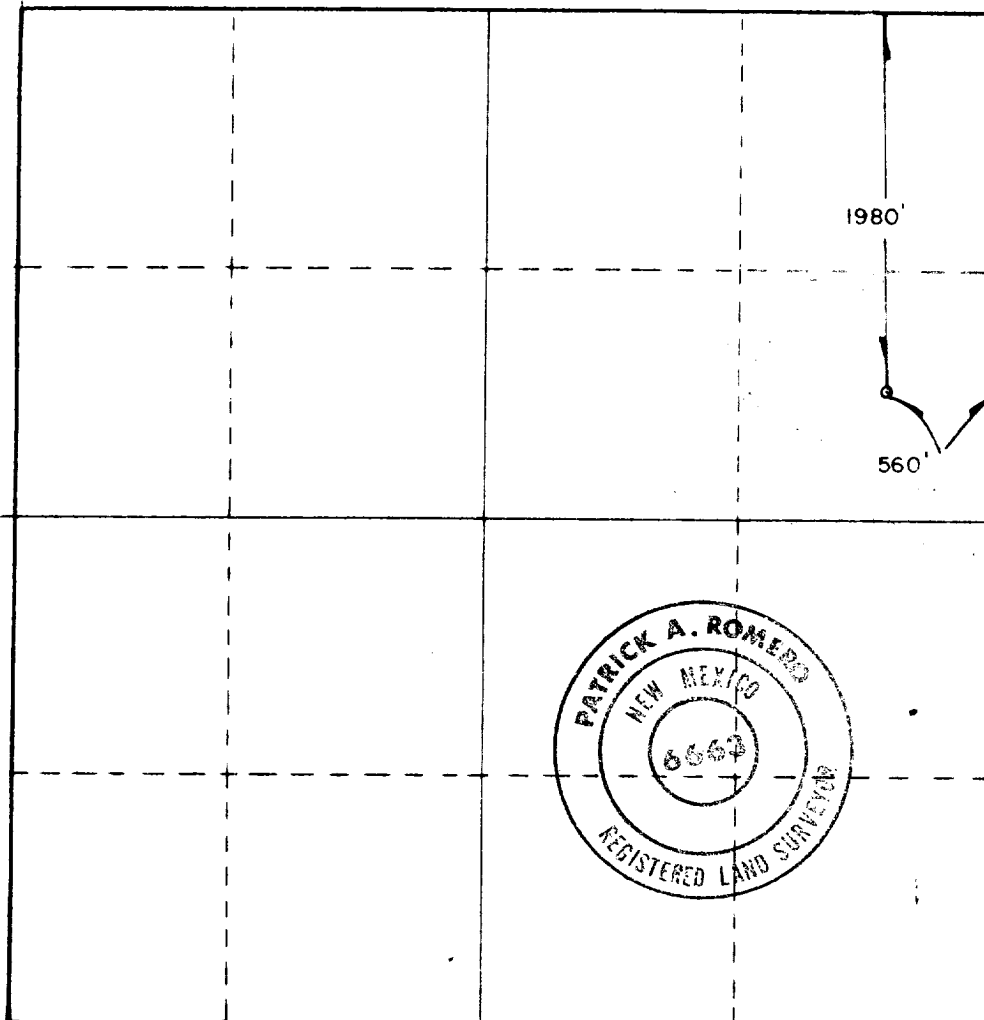

CERTIFICATION

I hereby certify that the information contained herein is true and complete to the best of my knowledge and belief.

Name Bucky Burch
 Position Area Manager
 Company Threshold Development
 Date May 6, 1982

I hereby certify that the well location shown on this plat was plotted from field notes of actual surveys made by me or under my supervision, and that the same is true and correct to the best of my knowledge and belief.

Date Surveyed 2/10/82
 Registered Professional Engineer and/or Land Surveyor Patrick Romero
 Certificate No. JOHN W. WEST 676
PATRICK A. ROMERO 6662
Ronald J. Eidson 3239



BOP SCHEMATIC
THRESHOLD DEVELOPMENT COMPANY
CONOCO "7" STATE WELL NO. 11
EDDY COUNTY, NEW MEXICO

