

NO. OF COPIES RECEIVED	6
DISTRIBUTION	
SANTA FE	1
FILE	1
U.S.G.S.	3
LAND OFFICE	1
OPERATOR	1

RECEIVED

JUL 9 1982

O. C. D.

ARTESIA, OFFICE

5A. Indicate Type of Lease  
STATE  WELL

5. State Oil & Gas Lease No.  
L-6787

7. Unit Agreement Lease

8. Name of Lease Hold  
Amoco State

9. Well No.  
1

10. Field and Pool, or Wildcat  
E. Millman SR

APPLICATION FOR PERMIT TO DRILL, DEEPEN OR PLUG BACK

Type of Work  
DRILL  DEEPEN  PLUG BACK

Type of Well  
OIL WELL  GAS WELL  OTHER  SINGLE ZONE  MULTIPLE ZONE

Name of Operator  
Marbob Energy Corporation

Address of Operator  
P.O. Drawer 217, Artesia, N.M. 88210

Location of Well  
UNIT LETTER O LOCATED 330 FEET FROM THE South LINE  
1650 FEET TO THE East LINE OF TWP. 19S RGE. 28E

11. Locality  
Eddy

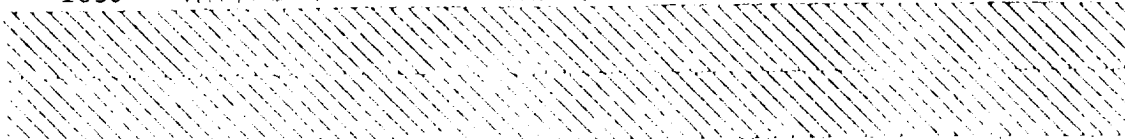

13. Proposed Depth 1200'	14A. Formation Seven Rivers	14B. Recovery of Oil Cable tool
15. Present Lease, whether or not, being 3451.3' GR	17. Status of State Lease Statewide active	21B. Drilling Contractor Jenkins Bros. Drlg. Co.
		22. Approx. Date Work will Start 7/12/82

PROPOSED CASING AND CEMENT PROGRAM

SIZE OF HOLE	SIZE OF CASING	WEIGHT PER FOOT	SETTING DEPTH	BACKS OF CEMENT	EST. TOP
12"	8 5/8"	24#	340'	100	Circ.
7 7/8"	4 1/2"	10.50#	1200'	300	Circ.

We propose to drill to 1200' to test the Seven Rivers formation. We will drill a 12" hole to 340', if water is encountered we will set 8 5/8" 24# new casing, cement and circulate; if water is not encountered we will reduce the hole to 7 7/8" and continue drilling to TD, run 4 1/2" 10.50# new casing, cement and circulate. We do not anticipate gas at this depth and will not set up a blowout preventer program at this time.

*Assted I.D.-I  
NL & API Board  
7-16-82*

APPROVAL VALID FOR 15 DAYS  
PERMIT EXPIRES 7-15-83  
UNLESS DRILLING UNDERWAY

BELOW SPACE DESCRIBE PROPOSED PROGRAM; IF PROPOSAL IS TO DEEPEN OR PLUG BACK, GIVE DATA ON PRESENT PRODUCTIVE ZONE AND PROPOSED NEW PRODUCTION ZONE. GIVE BLOWOUT PREVENTER PROGRAM, IF ANY.

I hereby certify that the information above is true and complete to the best of my knowledge and belief.  
*Carolyn Ellis* Title Production Clerk Date 7/9/82

(This space for State Use)  
APPROVED BY *Mike Williams* TITLE OIL AND GAS INSPECTOR DATE JUL 13 1982

REASONS OF APPROVAL, IF ANY:

NEW MEXICO CONSERVATION COMMISSION  
WELL LOCATION AND ACREAGE DEDICATION PLAT

RECEIVED

Form C-102  
Supersedes C-128  
Effective 10-85

JUL 9 1982

All distances shall be from the outer boundaries of the Section

Lessee Marbob Energy Corp.		Well Name Amoco St.		Office O. C. D. 1	
Section 0	Range 16	Meridian 19 South	Block 28 East	City EDDY	
Well Location 330 feet from the south		Well Location 1650 feet from the east		Section Acreage 40	
Tract Description 3451.3' Seven Rivers		Tract Description E. Millman SR		Section Acreage 40	

- Outline the acreage dedicated to the subject well by colored pencil or hachure marks on the plat below
- If more than one lease is dedicated to the well, outline each and identify the ownership thereof (both as to working interest and royalty)
- If more than one lease of different ownership is dedicated to the well, have the interests of all owners been consolidated by communitization, unitization, force-pooling, etc?

Yes  No If answer is "yes," type of consolidation \_\_\_\_\_

If answer is "no" list the owners and tract descriptions which have actually been consolidated (Use reverse side of this form if necessary) \_\_\_\_\_

No allowable will be assigned to the well until all interests have been consolidated by communitization, unitization, force-pooling, or otherwise or until a non-standard unit, eliminating such interests, has been approved by the Commission.

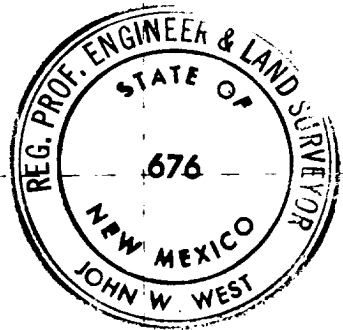
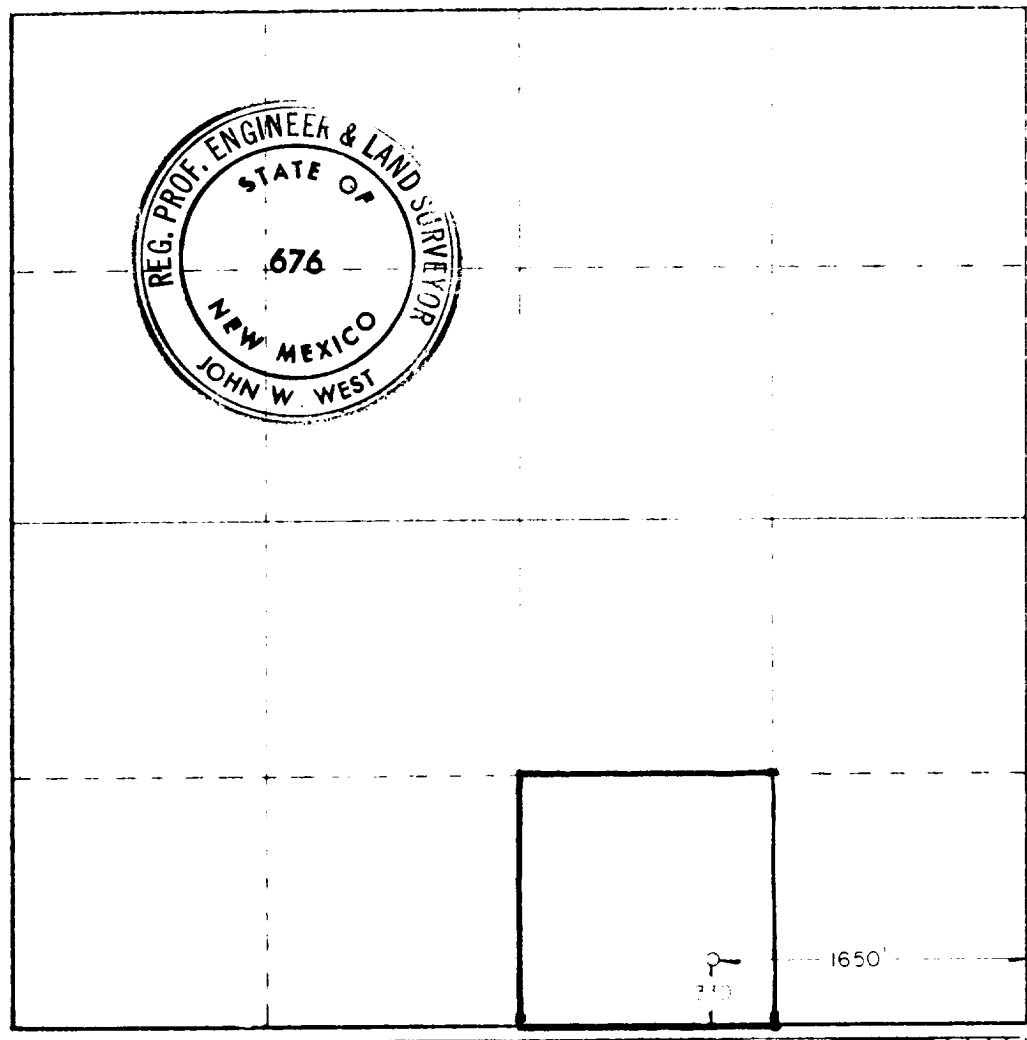

CERTIFICATION

I hereby certify that the information contained hereon is true and complete to the best of my knowledge and belief.

*Carolyn Orris*  
Carolyn Orris

Production Clerk

Marbob Energy Corp.

Date  
7/9/82

I hereby certify that the well location shown on this plat was plotted from field notes of actual surveys made by me or under my supervision, and that the same is true and correct to the best of my knowledge and belief.

Date Surveyed  
6-23-82

Registered Professional Engineer and Land Surveyor

*John W. West*  
John W. West

Certificate No. JOHN W. WEST 676  
PATRICK A. ROMERO 6663  
Ronald J. Eidson 3239

