

8-29-83

Let to Burl Reynolds
Change 2800' at $8\frac{5}{8}"$
to 1250' --

NO. OF COPIES RECEIVED	
DISTRIBUTION	
SANTA FE	<input checked="" type="checkbox"/>
FILE	<input checked="" type="checkbox"/>
U.S.G.S.	<input checked="" type="checkbox"/>
LAND OFFICE	<input checked="" type="checkbox"/>
OPERATOR	<input checked="" type="checkbox"/>

NEW MEXICO OIL CONSERVATION COMMISSION

Form C-101
1-65

RECEIVED BY

AUG 18 1983

O. C. D.

5A. Indicate Type of Lease	
STATE <input type="checkbox"/>	FEE <input checked="" type="checkbox"/>
5. State Oil & Gas Lease No.	

APPLICATION FOR PERMIT TO DRILL, DEEPEN, OR PLUG BACK

1a. Type of Work DRILL <input checked="" type="checkbox"/> DEEPEN <input type="checkbox"/> PLUG BACK <input type="checkbox"/>				7. Unit Agreement Name	
b. Type of Well OIL WELL <input type="checkbox"/> GAS WELL <input checked="" type="checkbox"/> OTHER <input type="checkbox"/>				8. Farm or Lease Name South Boyd	
2. Name of Operator Chama Petroleum Company <input checked="" type="checkbox"/>				9. Well No. 1-F <u>II</u>	
3. Address of Operator P.O. Box 31405, Dallas, Texas 75231				10. Field and Pool, or Wildcat <u>Wildcat</u>	
4. Location of Well UNIT LETTER <u>F</u> LOCATED <u>1980</u> FEET FROM THE <u>North</u> LINE AND <u>1980</u> FEET FROM THE <u>West</u> LINE OF SEC. <u>27</u> TWP. <u>19S</u> RGE. <u>25E</u> NMPM				12. County Eddy	
21. Elevations (Show whether D.F., RT, etc.) 3455.7 G.L.		21A. Kind & Status Plug Bond Blanket		21B. Drilling Contractor Hondo Drilling	
19. Proposed Depth 9600'		19A. Formation Morrow		20. Rotary or C.T. Rotary	
22. Approx. Date Work will start 9-1-83					

PROPOSED CASING AND CEMENT PROGRAM

SIZE OF HOLE	SIZE OF CASING	WEIGHT PER FOOT	SETTING DEPTH	SACKS OF CEMENT	EST. TOP
17 1/2"	13 3/8"	48#	350'	350 Sx	Circ.
11"	8 5/8"	24# & 28#	2800'	900 Sx	Circ.
7 7/8"	4 1/2" or 5 1/2"	11.6# or 17#	9600'	850 Sx	7500'

Propose to drill the well to evaluate the Morrow Formation. After reaching T.D., logs will be run and casing set if evaluation is positive. Perforate, test and stimulate as necessary to establish production. BOP program attached. Gas not dedicated.

*Posted 2-25-84
8-19-83*

APPROVAL VALID FOR 180 DAYS
PERMIT EXPIRES 2-25-84
UNLESS DRILLING UNDERWAY

IN ABOVE SPACE DESCRIBE PROPOSED PROGRAM: IF PROPOSAL IS TO DEEPEN OR PLUG BACK, GIVE DATA ON PRESENT PRODUCTIVE ZONE AND PROPOSED NEW PRODUCTIVE ZONE. GIVE BLOWOUT PREVENTER PROGRAM, IF ANY.

I hereby certify that the information above is true and complete to the best of my knowledge and belief.

Signed [Signature] Title President Date August 15, 1983

(This space for State Use)

Original Signed By
Leslie A. Clements
Supervisor District II

AUG 19 1983

APPROVED BY _____ TITLE _____ DATE _____

CONDITIONS OF APPROVAL, IF ANY:
Notify MLO.C.C. in sufficient
time to witness cementing
the 8 5/8" casing

N MEXICO OIL CONSERVATION COMMISS
WELL LOCATION AND ACREAGE DEDICATION PLAT

Form C-102
 Supersedes C-128
 Effective 1-1-65

All distances must be from the outer boundaries of the Section

Operator CHAMA PETROLEUM CO.			Lease SOUTH BOYD		Well No. 1
Unit Letter F	Section 27	Township 19 SOUTH	Range 25 EAST	County EDDY	
Actual Footage Location of Well:					
1980 feet from the NORTH line and		1980 feet from the WEST line			
Ground Level Elev. 3455.7	Producing Formation Morrow	Pool Widened Und. Community Morrow		Dedicated Acreage: 320 Acres	

1. Outline the acreage dedicated to the subject well by colored pencil or hachure marks on the plat below.
2. If more than one lease is dedicated to the well, outline each and identify the ownership thereof (both as to working interest and royalty).
3. If more than one lease of different ownership is dedicated to the well, have the interests of all owners been consolidated by communitization, unitization, force-pooling, etc?

☒ Yes ☐ No If answer is "yes," type of consolidation Pooled Unit

If answer is "no," list the owners and tract descriptions which have actually been consolidated. (Use reverse side of this form if necessary.) _____

No allowable will be assigned to the well until all interests have been consolidated (by communitization, unitization, forced-pooling, or otherwise) or until a non-standard unit, eliminating such interests, has been approved by the Commission.

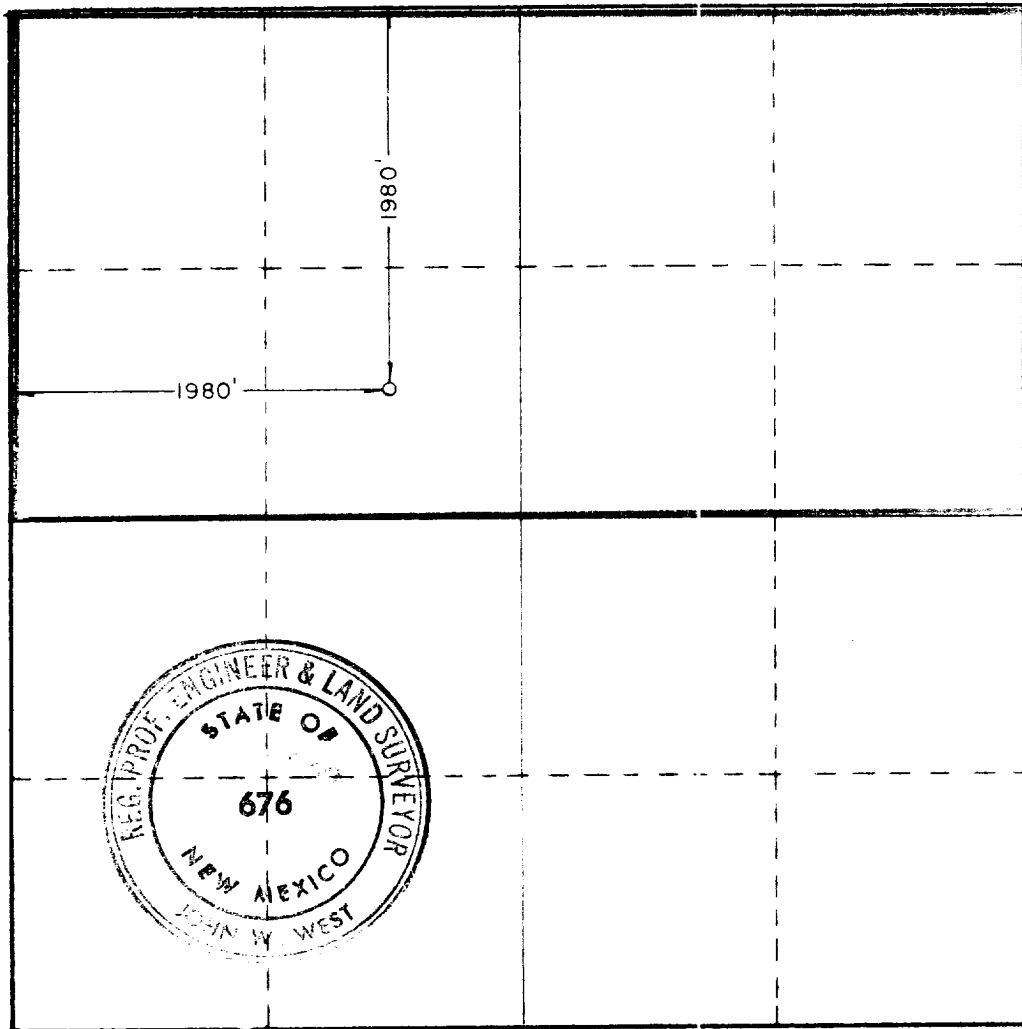

CERTIFICATION

I hereby certify that the information contained herein is true and complete to the best of my knowledge and belief.

Name Charles E. Nearburg
 Position **President**

Company
Chama Petroleum Company

Date
August 15, 1983

I hereby certify that the well location shown on this plat was plotted from field notes of actual surveys made by me or under my supervision, and that the same is true and correct to the best of my knowledge and belief.

Date Surveyed
AUGUST 10, 1983

Registered Professional Engineer and/or Land Surveyor

Certificate No. JOHN W. WEST, 676
RONALD J. EIDSON, 3239



BLOWOUT PREVENTER SKETCH

Chama Petroleum Company

Well #1-F South Boyd

1980' FNL & 1980' FNL Sec. 27, 19S, 25E

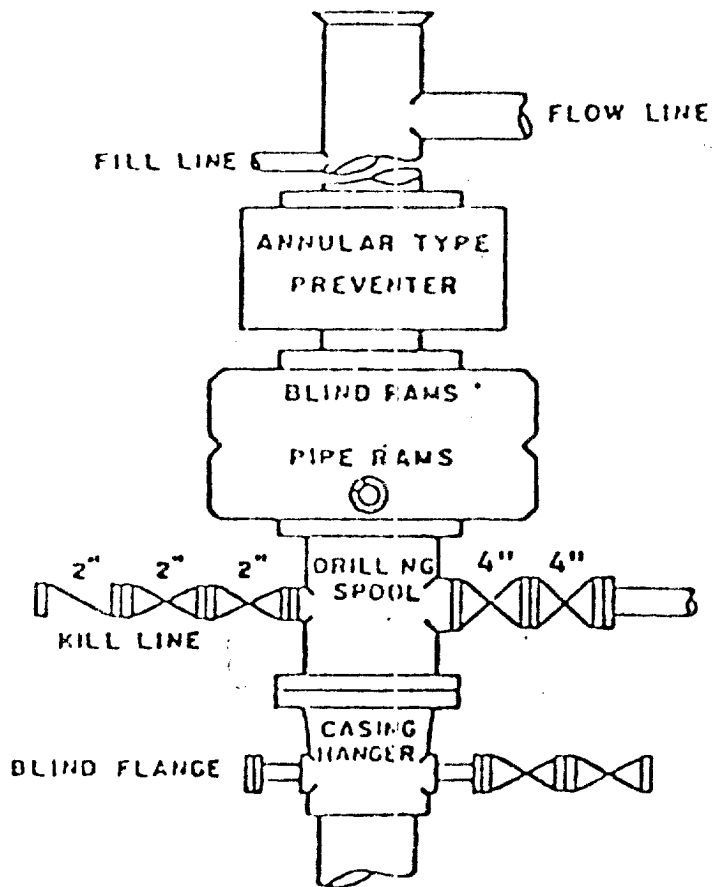

900 SERIES