

P. O. BOX 2088  
SANTA FE, NEW MEXICO 87501

Form C-101  
Revised 10-1-78

NO. OF COPIES RECEIVED	
DISTRIBUTION	
SANTA FE	
FILE	
U.S.G.S.	
LAND OFFICE	
OPERATOR	

RECEIVED BY  
JUL 03 1984  
O. C. D.  
ARTESIA, OFFICE

5A. Indicate Type of Lease  
STATE ☒ FEE ☐  
5. State Oil & Gas Lease No.

APPLICATION FOR PERMIT TO DRILL, DEEPEN, OR PLUG BACK

a. Type of Work DRILL <input checked="" type="checkbox"/> DEEPEN <input type="checkbox"/> PLUG BACK <input type="checkbox"/>		7. Unit Agreement Name
b. Type of Well OIL WELL <input checked="" type="checkbox"/> GAS WELL <input type="checkbox"/> OTHER <input type="checkbox"/> SINGLE ZONE <input checked="" type="checkbox"/> MULTIPLE ZONE <input type="checkbox"/>		8. Farm or Lease Name State HL 1
2. Name of Operator Tenneco Oil Company ✓		9. Well No. 2
3. Address of Operator 7990 IH 10 West, San Antonio, TX 78230		10. Field and Pool, or Wildcat Leo Queen, So. (Grayburg)
4. Location of Well UNIT LETTER C LOCATED 1980 660 FEET FROM THE West North LINE 660 FEET FROM THE North LINE OF SEC. 1 TWP. 19S RGE. 29E N.M.P.M.		11. County Eddy
19. Proposed Depth 2900		19A. Formation Grayburg
20. Rotary or C.R. Rotary		
1. Elevations (show whether DE, RT, etc.) 3415 GL	21A. Kind & Status Plug. Bond Blanket	21B. Drilling Contractor
22. Approx. Date Work will start 15 July 1984		

PROPOSED CASING AND CEMENT PROGRAM

SIZE OF HOLE	SIZE OF CASING	WEIGHT PER FOOT	SETTING DEPTH	SACKS OF CEMENT	EST. TOP
12 1/2	8 5/8	24 lbs.	300'	190	Surf.
7 7/8	5 1/2	15.5 lbs.	2900	427	Surf.

- Construct suitable location. Reserve pits, working pits, rat hole, mouse hole, cellar may be provided by operator or drilling contractor, and will be determined in conjunction with selection of drilling contractor/rig.
- MIRU. Drill 12 1/4" hole to 300' +/- . BHA: Slick
- CCM to run casing. SLM out of hole. Set 8 5/8" casing in full compression at 300 +/- . Run casing, cement and centralize.
- WOC 12 hours. Cut off 8 5/8" casing. Install (See Note #1) wellhead. test well to 680 psi (1/2 of csg. collapse strength for SOW heads).

Continued on back of page.

Minimum WOC time 18 hrs.

APPROVAL VALID FOR 180 DAYS  
PERMIT EXPIRES 1585  
UNLESS DRILLING UNDERWAY

ABOVE SPACE DESCRIBE PROPOSED PROGRAM: IF PROPOSAL IS TO DEEPEN OR PLUG BACK, GIVE DATA ON PRESENT PRODUCTIVE ZONE AND PROPOSED NEW PRODUCTIVE ZONE. GIVE SHUT-IN PRESSURE PROGRAM, IF ANY.

I hereby certify that the information above is true and complete to the best of my knowledge and belief.

Signed [Signature] Title Drilling Engineer Date 28 June 1984  
(This space for State Use)

APPROVED BY [Signature] TITLE OIL AND GAS INSPECTOR DATE JUL 05 1984

CONDITIONS OF APPROVAL, IF ANY:

Post a P.D.  
#D-104, P.B. 3  
7-6-84

**N. MEXICO OIL CONSERVATION COMMISSION  
WELL LOCATION AND ACREAGE DEDICATION PLAT**

Form C-102  
Supersedes C-128  
Effective 1-1-65

All distances must be from the outer boundaries of the Section

Operator <b>Tenneco Oil Co.</b>			Lease <b>State HL 1</b>		Well No. <b>2</b>
Unit Letter <b>C</b>	Section <b>1</b>	Township <b>19 South</b>	Range <b>29 East</b>	County <b>Eddy</b>	
Actual Footage Location of Well: <b>1980</b> feet from the <b>West</b> line and <b>660</b> feet from the <b>North</b> line Ground Level Elev. <b>3415</b> Producing Formation <b>Grayburg</b> Pool <b>Leo Queen, So. (Grayburg) Undesign.</b> Dedicated Acreage: <b>40</b> Acres					

1. Outline the acreage dedicated to the subject well by colored pencil or hatchure marks on the plat below.
2. If more than one lease is dedicated to the well, outline each and identify the ownership thereof (both as to working interest and royalty).
3. If more than one lease of different ownership is dedicated to the well, have the interests of all owners been consolidated by communitization, unitization, force-pooling, etc?  
☐ Yes    ☐ No    If answer is "yes," type of consolidation \_\_\_\_\_

If answer is "no," list the owners and tract descriptions which have actually been consolidated. (Use reverse side of this form if necessary.) \_\_\_\_\_

No allowable will be assigned to the well until all interests have been consolidated (by communitization, unitization, forced-pooling, or otherwise) or until a non-standard unit, eliminating such interests, has been approved by the Commission.

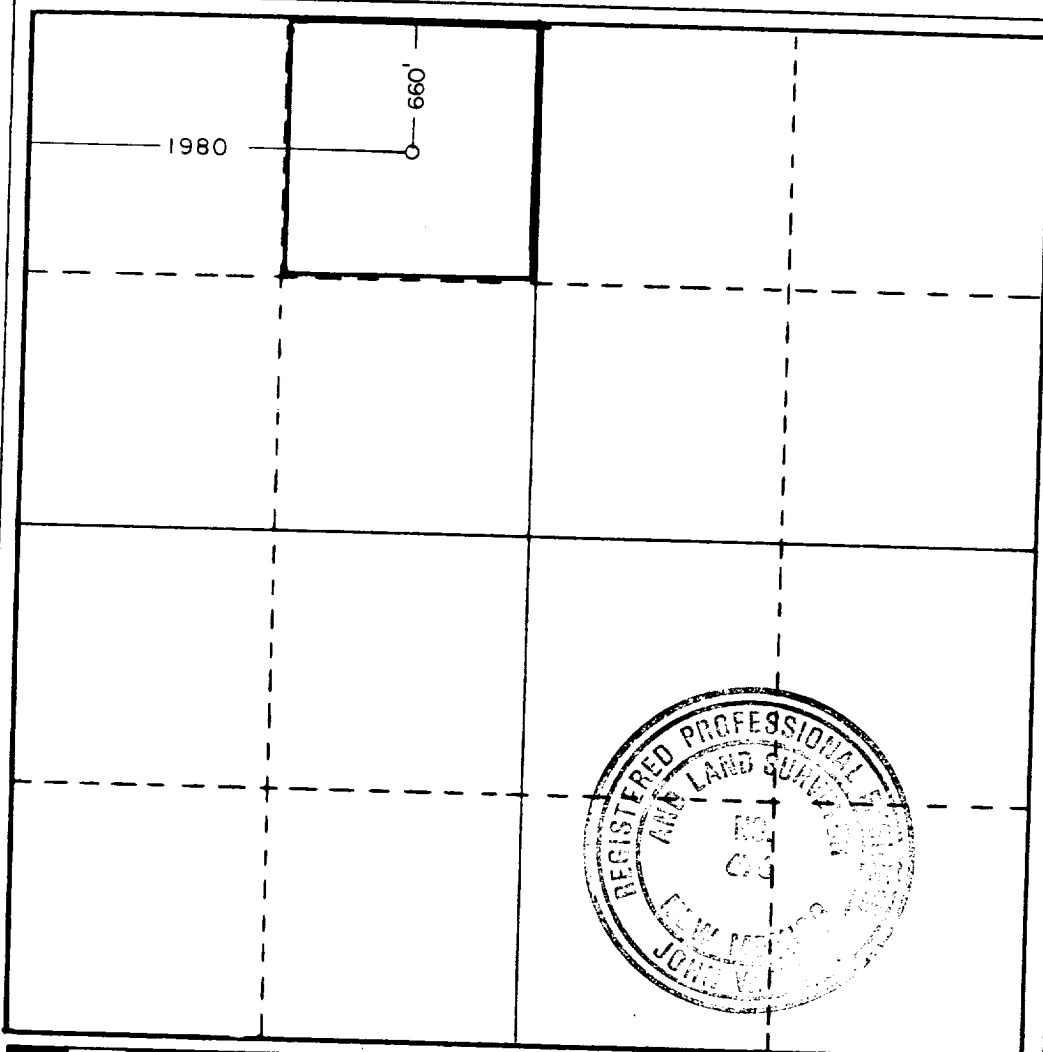

**CERTIFICATION**

I hereby certify that the information contained herein is true and complete to the best of my knowledge and belief.

Name *Ladell Collier*  
 Position **Geological Engineer**  
 Company **Tenneco Oil Company**

Date **28 June 1984**

I hereby certify that the well location shown on this plat was plotted from field notes of actual surveys made by me or under my supervision, and that the same is true and correct to the best of my knowledge and belief.

June 8, 1984

Date Surveyed

Registered Professional Engineer and/or Land Surveyor

*[Signature]*  
 Certificate No. **JOHN W. WEST, 676**  
**RONALD J. EIDSON, 3239**

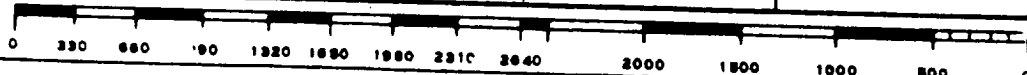

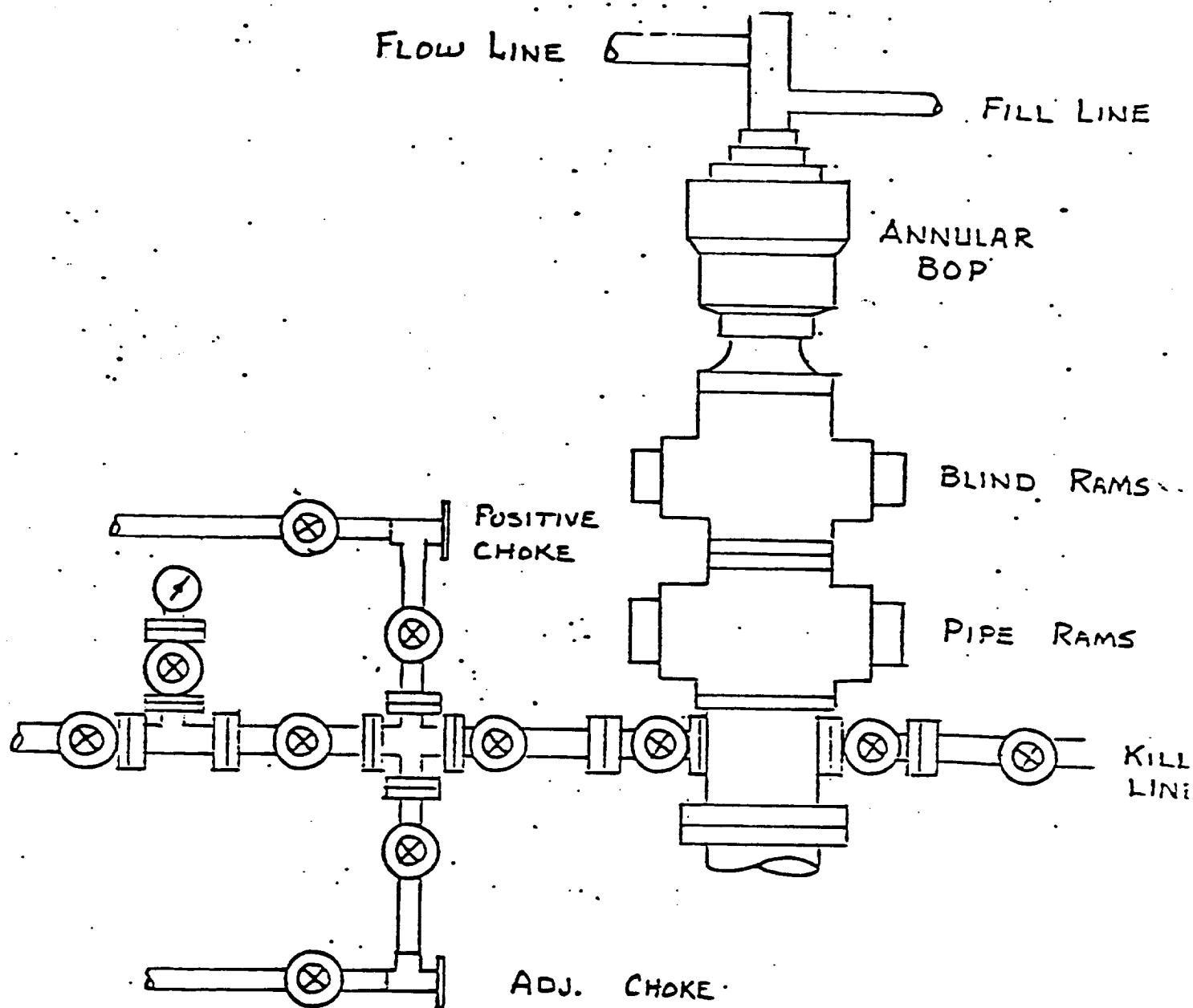

This is to be 3000 psi wp, which is adequate, that will be used on the 11" and 7 7/8" hole. This is the minimum possible BOP stack that will be used. Tenneco may choose to use more equipment and higher pressure.