

NO. OF COPIES RECEIVED	
DISTRIBUTION	
SANTA FE	<input checked="" type="checkbox"/>
FILE	<input checked="" type="checkbox"/>
U.S.G.S.	<input checked="" type="checkbox"/>
LAND OFFICE	<input checked="" type="checkbox"/>
OPERATOR	<input checked="" type="checkbox"/>

SANTA FE, NEW MEXICO 87501

NOV 05 1984

O. C. D.  
ARTESIA, OFFICE

5A. Indicate Type of Lease  
STATE ☒ FEDERAL ☐

5. State Oil & Gas Lease No.

APPLICATION FOR PERMIT TO DRILL, DEEPEN, OR PLUG BACK

Type of Work Type of Well: DRILL <input type="checkbox"/> DEEPEN <input type="checkbox"/> PLUG BACK <input checked="" type="checkbox"/> OIL WELL <input checked="" type="checkbox"/> GAS WELL <input type="checkbox"/> OTHER <input type="checkbox"/> SINGLE ZONE <input type="checkbox"/> MULTIPLE ZONE <input type="checkbox"/>		7. Unit Agreement Name
Name of Operator Tenneco Oil Company		8. Farm or Lease Name State HL-1
Address of Operator 7990 IH-10 West, San Antonio, TX 78230		9. Well No. 2
Location of Well UNIT LETTER C LOCATED 660 FEET FROM THE North LINE 1980 FEET FROM THE West LINE OF SEC. 1 TWP. 19S RCE. 29E N10W		10. Field and Pool, or Wildcat Seven Rivers
		12. County Eddy
		19. Proposed Depth 2,880'
		19A. Formation Seven Rivers
		20. Rotary or C.T. Rotary
Elevations (Show whether DF, HT, etc.) 3,415 GL	21A. Kind & Status Plug. Bond Blanket	22. Approx. Date Work will start 11/1/84

PROPOSED CASING AND CEMENT PROGRAM

SIZE OF HOLE	SIZE OF CASING	WEIGHT PER FOOT	SETTING DEPTH	SACKS OF CEMENT	EST. TOP
12-1/4"	8-5/8"	24 & 32	300'	200	Surface
7-7/8"	5-1/2"	15.5	2,880'	615	Surface

Present zone is South Leo Queen Und Grayburg). Request to plug back to the Seven Rivers zone as indicated on Attachment A.

See Attachments A & B.

APPROVAL VALID FOR 180 DAYS  
PERMIT EXPIRES 5/5/85  
UNLESS DRILLING UNDERWAY

PERMIT EXPIRES \_\_\_\_\_ DAYS  
UNLESS DRILLING UNDERWAY

ABOVE SPACE DESCRIBE PROPOSED PROGRAM: IF PROPOSAL IS TO DEEPEN OR PLUG BACK, GIVE DATA ON PRESENT PRODUCTIVE ZONE AND PROPOSED NEW PRODUCTION ZONE. GIVE BLOWOUT PREVENTER PROGRAM, IF ANY.

I hereby certify that the information above is true and complete to the best of my knowledge and belief.

Signed Whiter Zamore Title Production Engineer Date 11/1/84

(This space for State Use)

PROVED BY Original Signed By  
Leslie A. Clemente DATE NOV 5 1984  
CONDITIONS OF APPROVAL, IF ANY: Supervisor District II

**W MEXICO OIL CONSERVATION COMMISSION  
WELL LOCATION AND ACREAGE DEDICATION PLAT**

Form C-102  
Supersedes C-128  
Effective 1-1-65

All distances must be from the outer boundaries of the Section

Operator <b>Tenneco Oil Co.</b>			Lease <b>State HL 1</b>		Well No. <b>2</b>
Unit Letter <b>C</b>	Section <b>1</b>	Township <b>19 South</b>	Range <b>29 East</b>	County <b>Eddy</b>	
Actual Footage Location of Well:					
1980 feet from the West line and 660 feet from the North line					
Ground Level Elev. <b>3415</b>	Producing Formation <b>Grayburg</b>	Pool <b>Leo Queen, So. (Grayburg) Undesig.</b>	Dedicated Acreage: <b>40</b> Acres		

1. Outline the acreage dedicated to the subject well by colored pencil or hachure marks on the plat below.
2. If more than one lease is dedicated to the well, outline each and identify the ownership thereof (both as to working interest and royalty).
3. If more than one lease of different ownership is dedicated to the well, have the interests of all owners been consolidated by communitization, unitization, force-pooling, etc?

☐ Yes ☐ No If answer is "yes," type of consolidation \_\_\_\_\_

If answer is "no," list the owners and tract descriptions which have actually been consolidated. (Use reverse side of this form if necessary.) \_\_\_\_\_

No allowable will be assigned to the well until all interests have been consolidated (by communitization, unitization, forced-pooling, or otherwise) or until a non-standard unit, eliminating such interests, has been approved by the Commission.

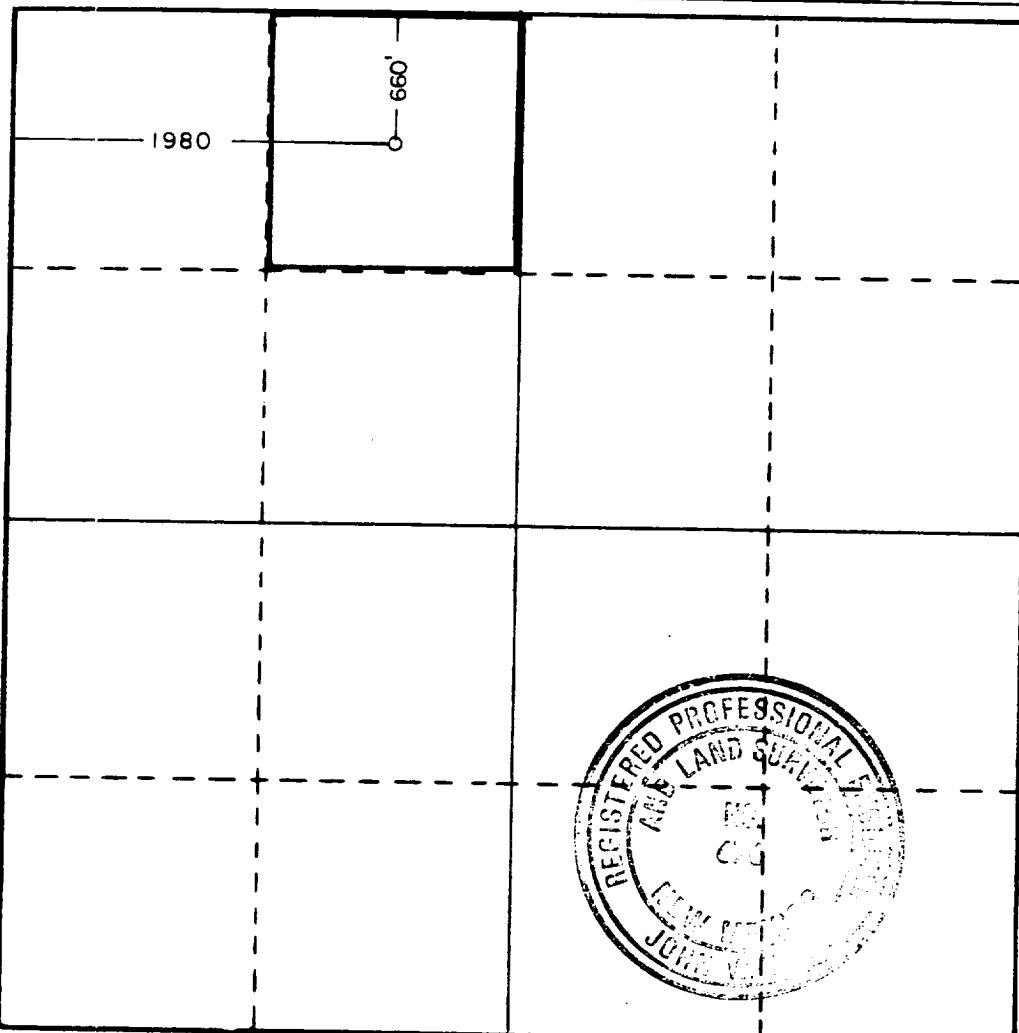

**CERTIFICATION**

I hereby certify that the information contained herein is true and complete to the best of my knowledge and belief.

Name  
*Ladell Collier*  
Position  
**Geological Engineer**  
Company  
**Tenneco Oil Company**

Date  
**28 June 1984**

I hereby certify that the well location shown on this plat was plotted from field notes of actual surveys made by me or under my supervision, and that the same is true and correct to the best of my knowledge and belief.

June 8, 1984

Date Surveyed

Registered Professional Engineer and/or Land Surveyor

*John W. West*  
Certificate No. **JOHN W. WEST, 676**  
**RONALD J. EIDSON, 3239**



A.

STATE HL1-2 RECOMPLETION PROGNOSIS

1. MIRU PU.
2. Kill well with produced water.
3. TOH with rods and pump.
4. ND wellhead. NU BOP.
5. TOH with all 2-3/8" tubing (2625').
6. RU electric line unit.
7. RIH on wireline with 5-1/2" CIBP and set at 2278' KB. (NOTE: KB is 8' above GL.) Tie-in with gamma-ray and collar locator.
8. RIH with cement bailer and dump 35' of cement on CIBP. (Let cement set-up overnight.) Pressure up on casing to 500 psi to see if plug holds.
9. TIH with 2-7/8" tubing and circulate hole clean with 2% KCL completion fluid (2% KCL, Lo-Surf 259). TOH with tubing.
10. RIH with 3-1/8" casing gun (.34" holes), tie-in with collar locator and perforate 1723-1740 (1 JSPF), 1792-1795 (4 JSPF) and 1806 (1 JSPF).
11. TOH with gun. TIH with 5-1/2" Baker "Lok-Set" packer with on-off tool and with FL receptacle cut to 2.25" profile and 2-7/8" J-55 8RD tubing. Set packer at 1675' (KB).
12. RU swab assembly. Swab well.
13. Stimulate well as recommended.
14. Flow well back. When well dies, TIH with wireline and tag PBTD.
15. Bail sand if rathole amount is less than 100'.
16. TIH with 2-3/8" J-55 8RD tubing to 1860' KB with SN at 1830'. ND BOP. NU wellhead.
17. Swab well in.
18. After well cleans up, PU and GIH with 2" X 1-1/4" X 16' pump rod and 71-3/4" rods and pony rods. Install pumping tee and space out.
19. RD and release rig.

B.

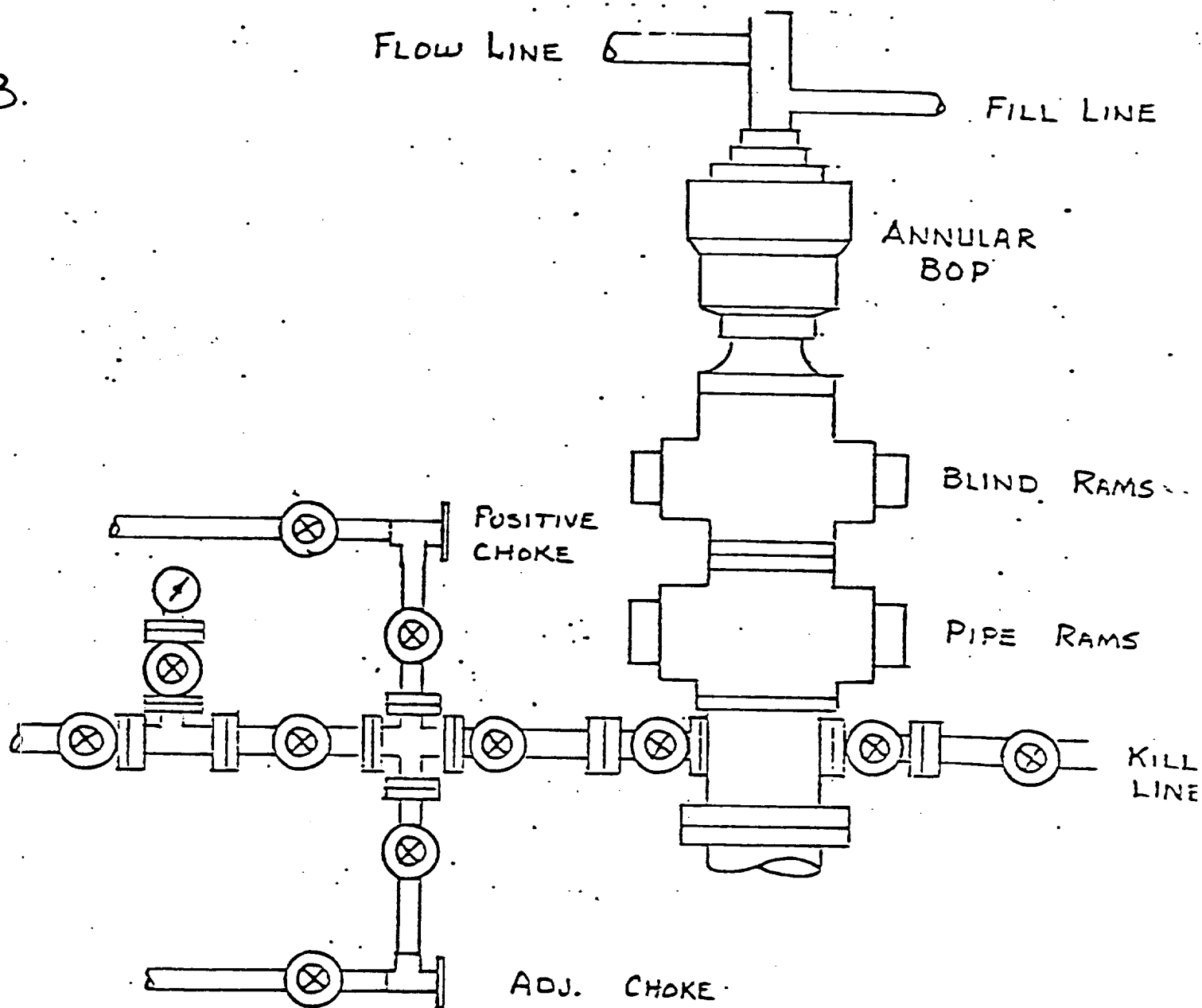

This is to be 3000 psi wp, which is adequate, that will be used on the 11" and 7 7/8" hole. This is the minimum possible BOP stack that will be used. Tenneco may choose to use more equipment and higher pressure.